

PLSS GPS Observation Sheet

Project Name SL T17S R10E (Meridian Township Range)		Township T 1 7		1/2 (2) S	N S	Range 1 0		1/2 (2)	E W	Section		Meridian (SL) US			
Contacts Name Lee M. Swasey		Source Agency JOHANSEN & TUTTLE ENGINEERING						Date 11/29/05							
Contacts Phone (435) 381-2523															
Control Station															
Name ELM GPS 12		COR		HARN		TRI		Type Other EMERY COUNTY				Accuracy Order			
USGS Quad Name OLSEN RESERVOIR UTAH		Nad27		Nad83		Datum (Nad83 (1994))		WGS84		Local		State UTAH County EMERY			
Latitude N 3 9 - 2 3 - 2 5 . 4 2 8 1 2 7							Longitude W 1 1 0 - 4 5 - 0 1 . 5 8 6 1 0								
Northing 6 9 4 7 5 8 7 . 6 3							Easting 1 8 5 2 2 5 7 . 0 6								
Units Survey Foot <input type="checkbox"/> International Foot <input checked="" type="checkbox"/> Meter <input type="checkbox"/>		Coordinate Type State Plane <input checked="" type="checkbox"/> UTM <input type="checkbox"/>													
Zone Utah North <input type="checkbox"/> Utah Central <input checked="" type="checkbox"/> Utah South <input type="checkbox"/>		Vertical Datum NGVD29 <input type="checkbox"/> NAVD88 <input checked="" type="checkbox"/>													
Ellipsoid Height 1711.15 M		FT		Geoid Height M		5671.75 FT									
Base Receiver															
Type TRIMBLE				Model 4000 SSI				Serial Number							
Logging Interval 5 SEC.		Elevation Mask 13		PDOP Mask 6		Antenna Type L1/L2 w/GROUND PLANE									
Start Time AM PM				End Time AM PM											
Antenna Height															
Session Beginning		1" M		2" M		3" M		Ave		4.780 Feet M					
Session End		1" M		2" M		3" M		Ave		M					
Rover Receiver															
Type TRIMBLE				Model 5800				Serial Number 4253117118							
Approximate Distance From Base Station Miles				Antenna Type 5800 INTERNAL						Antenna Height 6.6 FT					
Station Observation															
Observation Type <input checked="" type="checkbox"/> RTK <input type="checkbox"/> FAST STATIC <input type="checkbox"/> STATIC <input type="checkbox"/> OTHER															
First Observation															
Station Name (M1) 4 4 0 5 0 0		Description S 1/4 corner Sec. 10													
Occupation time		PDOP Best				RMS Best									
Number of Measurements 60		PDOP Worst 4.7				RMS Worst 7.5									
Second Observation															
Station Name (M2)		Description													
Occupation time		PDOP Best				RMS Best									
Number of Measurements		PDOP Worst				RMS Worst									
Inverse Distance Between M1 and M2 FT				Alternate Base Station Used				Yes No							
Monument and Markings															
Type / Size															
Stone		Pipe/Cap				Post				Other					
Size		Size 2 1/2 / 3 1/4 1969 BLM				Size				Size					
Material		Material steel / brass				Material				Material					

Sketch/Rubbing or Attach Photo of GPS Station Occupied
Show rotation of stampings/markings relative to North and describe briefly

See Emery County Land Survey Monument Record Sheet 1710440500

EMERY COUNTY LAND SURVEY MONUMENT RECORD

Date of field work: 11-29-05 County Reference No. 440500
~~1710500440~~

Type of Monument: Section Corner ✓ Quarter Corner
 Bench Mark Other

Your Description and Observation of Monument Found (Be Specific):
 1969 BLM BRASS CAP 8" ABOVE GROUND LEVEL. A SPORTSMAN CAP SETS TO THE SOUTH AS SHOWN

Description of Monument, Reference Monument or Accessories Established by You to Perpetuate the Location of this Point: SET 4 #4 REBAR AS SHOWN BELOW

Sketch showing Relative Location of Monument Accessories and Two Reference Points Stating Whether Found or Set. Show Supporting and/or Contradictory Evidence where Applicable. Include North Arrow.

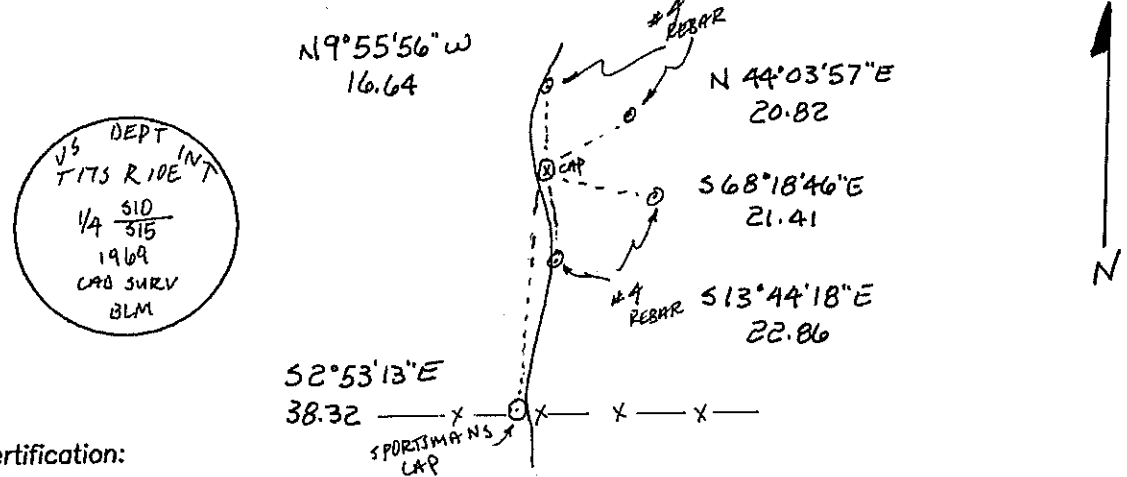

Certification:
 Firm name and/or Surveyor: Johansen & Tuttle Eng.
 Address: 90 S. 100 E. Castle Dale, Utah 84513 Phone: (435) 381-2523

This is to certify that I was in responsible charge of the surveying work described in this record and that to the best of my knowledge the information presented herein is true and correct.

Location Diagram:
 Section: 10
 Township: 17S
 Range: 10E

