

EMERY COUNTY LAND SURVEY MONUMENT RECORD

Date of field work: 6-7-01

County Reference No. 1706200460

Type of Monument: Section Corner
 Bench Mark

Quarter Corner
 Other 1/16 CORNER

Your Description and Observation of Monument Found (Be Specific):

FOUND FOREST SERVICE DISC SET IN SANDSTONE ledge

Description of Monument, Reference Monument or Accessories Established by You to Perpetuate the Location of this Point:

SET #5 REBAR NORTH, EAST, SOUTHEAST, AND SOUTH OF THE MONUMENT

Sketch showing Relative Location of Monument Accessories and Two Reference Points Stating Whether Found or Set. Show Supporting and/or Contradictory Evidence where Applicable. Include North Arrow.

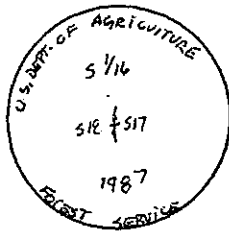
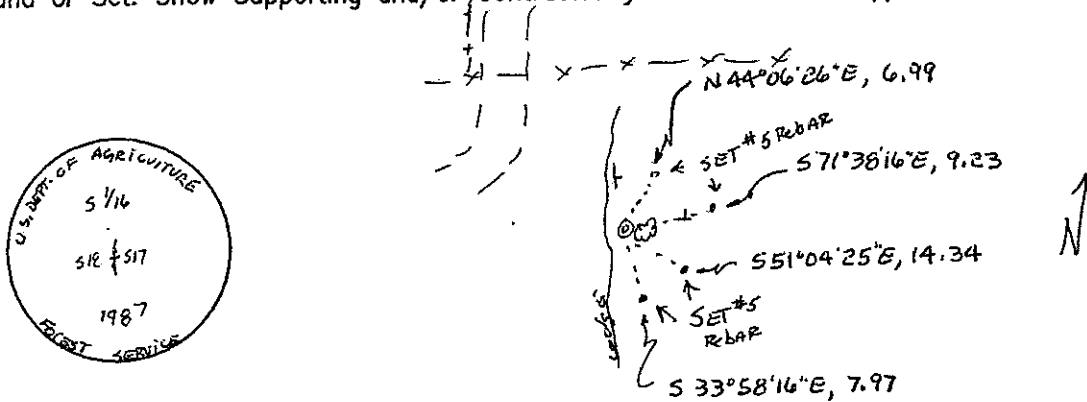

Certification:

Firm name and/or Surveyor: Johansen & Tuttle Eng.

Address: 90 S. 100 E. Castle Dale, Utah 84513 Phone: (435) 381-2523

This is to certify that I was in responsible charge of the surveying work described in this record and that to the best of my knowledge the information presented herein is true and correct.

Location Diagram:

Section: 17

Township: 17S

Range: 6E

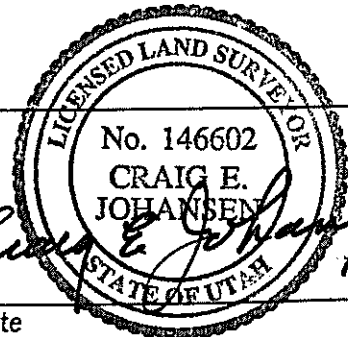
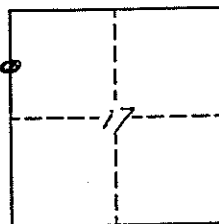

Date

11-30-01

EMERY COUNTY LAND SURVEY MONUMENT RECORD

Date of field work: 6-7-01

County Reference No. 1706200420

Type of Monument: Section Corner Quarter Corner
 Bench Mark ✓ Other 1/16 CORNER

Your Description and Observation of Monument Found (Be Specific):

Found STD ~~BE~~ FOREST SERVICE CAP, WITH A ROCK COLLAR, 15'± SOUTH OF A EAST-WEST FENCE

Description of Monument, Reference Monument or Accessories Established by You to Perpetuate the Location of this Point:

SET #5 REBAR SOUTH, WEST, NORTHWEST, AND NORTHEAST OF THE MONUMENT

Sketch showing Relative Location of Monument Accessories and Two Reference Points Stating Whether Found or Set. Show Supporting and/or Contradictory Evidence where Applicable. Include North Arrow.

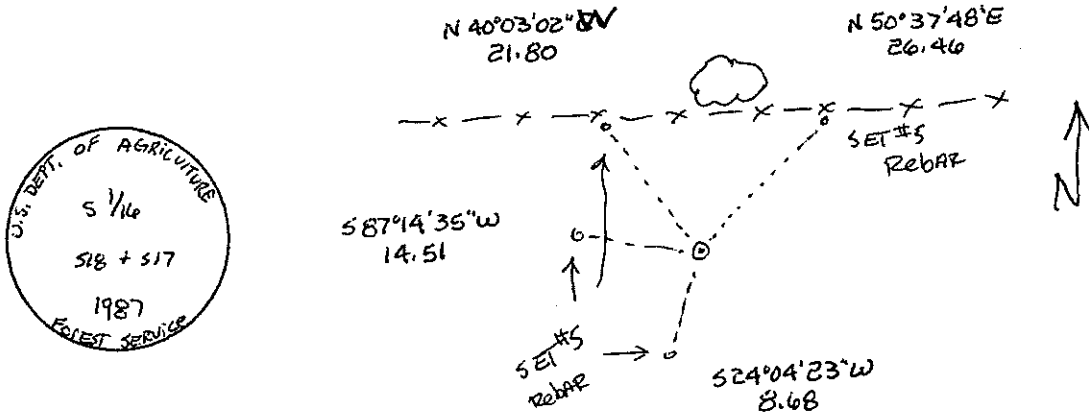

Certification:

Firm name and/or Surveyor: Johansen & Tuttle Eng.

Address: 90 S. 100 E. Castle Dale, Utah 84513 Phone: (435) 381-2523

This is to certify that I was in responsible charge of the surveying work described in this record and that to the best of my knowledge the information presented herein is true and correct.

Location Diagram:

Section: 17

Township: 17S

Range: 80E

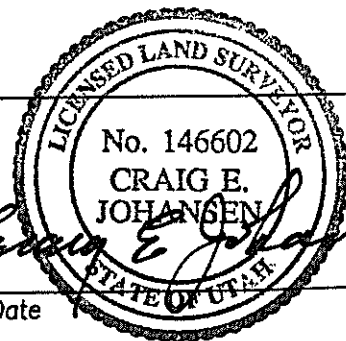
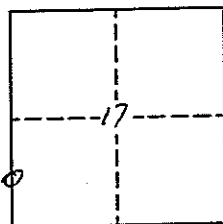

Date

11-30-01

