

EMERY COUNTY LAND SURVEY MONUMENT RECORD

Date of field work: 3-14-01

County Reference No. 1808100500

Type of Monument: Section Corner Quarter Corner
 Bench Mark Other _____

Your Description and Observation of Monument Found (Be Specific):
FOUND STD BLM CAP

Description of Monument, Reference Monument or Accessories Established by You to Perpetuate the Location of this Point:

SET A #5 REBAR NORTH, WEST, SOUTHWEST, AND SOUTHEAST OF THE MONUMENT

Sketch showing Relative Location of Monument Accessories and Two Reference Points Stating Whether Found or Set. Show Supporting and/or Contradictory Evidence where Applicable. Include North Arrow.

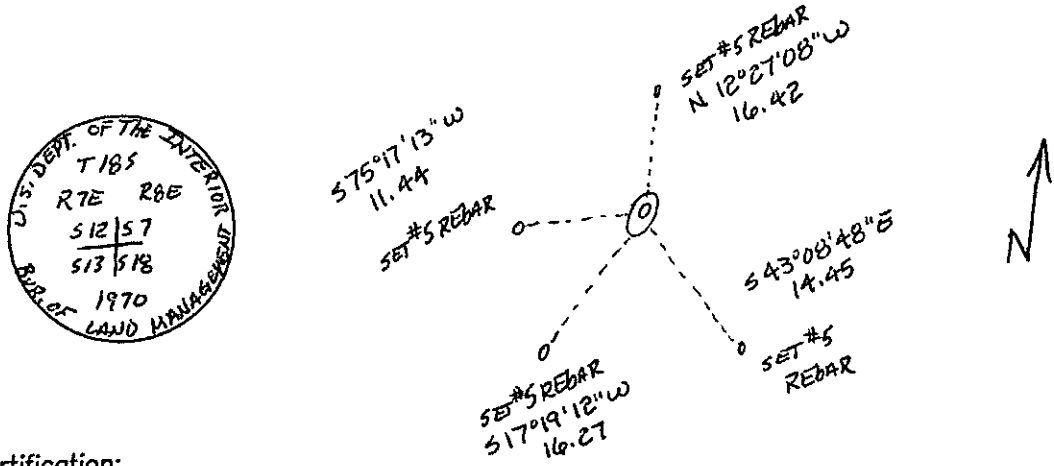

Certification:

Firm name and/or Surveyor: Johansen & Tuttle Eng.
 Address: 90 S. 100 E. Castle Dale, Utah 84513 Phone: (435) 381-2523

This is to certify that I was in responsible charge of the surveying work described in this record and that to the best of my knowledge the information presented herein is true and correct.

Location Diagram:
 Section: 17
 Township: 18S
 Range: 8E

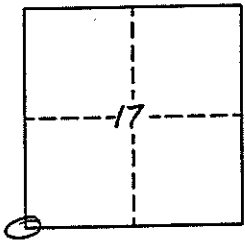

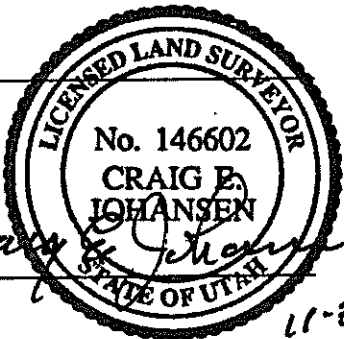
Craig E. Johansen
 Date 3-14-01