

EMERY COUNTY LAND SURVEY MONUMENT RECORD

Date of field work: 6-7-01

County Reference No. 1706120370

Type of Monument: Section Corner Quarter Corner
 Bench Mark ✓ Other 1/4 CORNER

Your Description and Observation of Monument Found (Be Specific):

FOUND STA FOREST SERVICE CAP IN A ROCK COLLAR

Description of Monument, Reference Monument or Accessories Established by You to Perpetuate the Location of this Point:

SETA #5 REBAR NORTH, NORTHWEST, WEST, AND SOUTHWEST OF THE MONUMENT

Sketch showing Relative Location of Monument Accessories and Two Reference Points Stating Whether Found or Set. Show Supporting and/or Contradictory Evidence where Applicable. Include North Arrow.

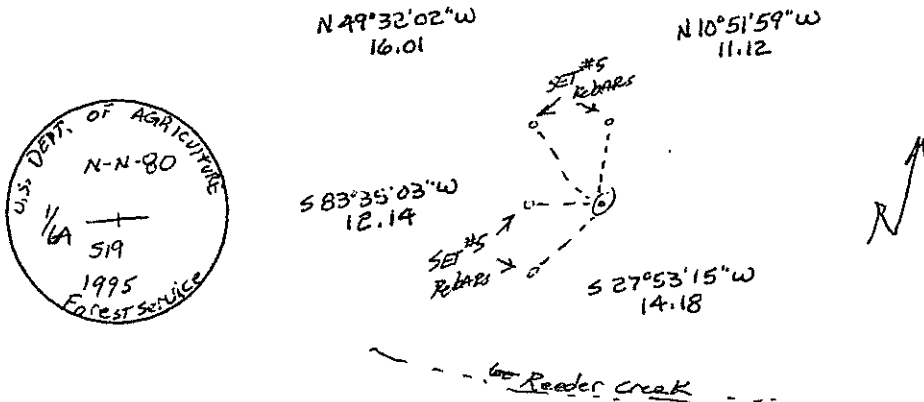

Certification:

Firm name and/or Surveyor: Johansen & Tuttle Eng.
 Address: 90 S. 100 E. Castle Dale, Utah 84513 Phone: (435) 381-2523

This is to certify that I was in responsible charge of the surveying work described in this record and that to the best of my knowledge the information presented herein is true and correct.

Location Diagram:
 Section: 19
 Township: 17S
 Range: 6E

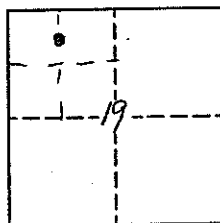

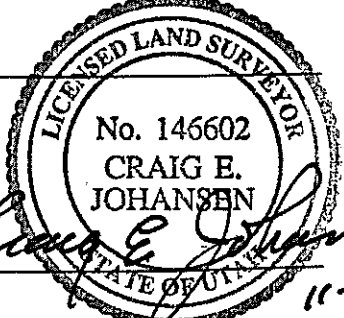
Craig E. Johansen
 Date 11-30-01

EMERY COUNTY LAND SURVEY MONUMENT RECORD

Date of field work: 10-7-01

County Reference No. 1706140300

Type of Monument: Section Corner ✓ Quarter Corner
 Bench Mark Other

Your Description and Observation of Monument Found (Be Specific):
FOUND ORIGINAL ROCK, GRANITE 9" X 9" X 9" ABOVEGROUND, 1/4 MARKED ON NORTH FACE

Description of Monument, Reference Monument or Accessories Established by You to Perpetuate the Location of this Point:

SET #5 REBAR EAST, NORTHEAST, NORTH, AND NORTHWEST OF THE MONUMENT

Sketch showing Relative Location of Monument Accessories and Two Reference Points Stating Whether Found or Set. Show Supporting and/or Contradictory Evidence where Applicable. Include North Arrow.

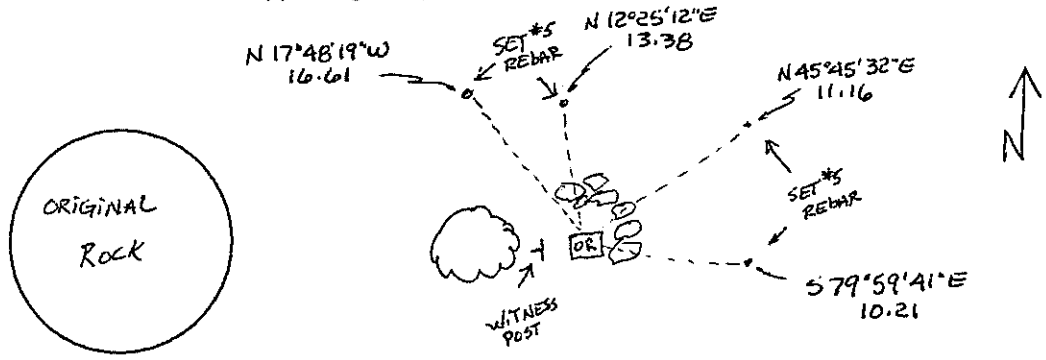

Certification:

Firm name and/or Surveyor: Johansen & Tuttle Eng.
Address: 90 S. 100 E. Castle Dale, Utah 84513 Phone: (435) 381-2523

This is to certify that I was in responsible charge of the surveying work described in this record and that to the best of my knowledge the information presented herein is true and correct.

Location Diagram:
Section: 19
Township: 17S
Range: 6E

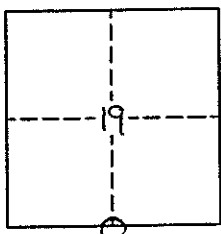

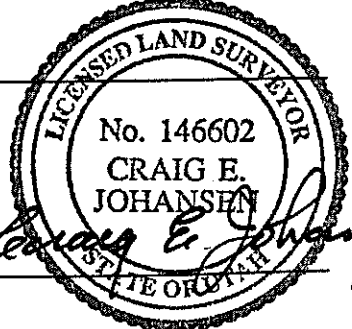

 Date 11-30-01