

EMERY COUNTY LAND SURVEY MONUMENT RECORD

Date of field work: 4-25-01

County Reference No. 1708600100

Type of Monument: Section Corner
 Bench Mark

Quarter Corner
 Other _____

Your Description and Observation of Monument Found (Be Specific):
 FOUND 1/2 IN PLASTIC CAP ON A REBAR IN THE CO. ROAD. 2 1/2" BELOW THE SURFACE
 FOUND A 6" PVC PIPE FILLED WITH CONCRETE WITH AN ARROW & 30 N MARKED ON IT.

Description of Monument, Reference Monument or Accessories Established by You to Perpetuate the Location of this Point:

- SET A STD EGS RM CAP NORTHWEST, AND NORTHEAST OF THE MONUMENT
- SET A #4 REBAR SOUTHWEST OF THE MONUMENT

Sketch showing Relative Location of Monument Accessories and Two Reference Points Stating Whether Found or Set. Show Supporting and/or Contradictory Evidence where Applicable. Include North Arrow.

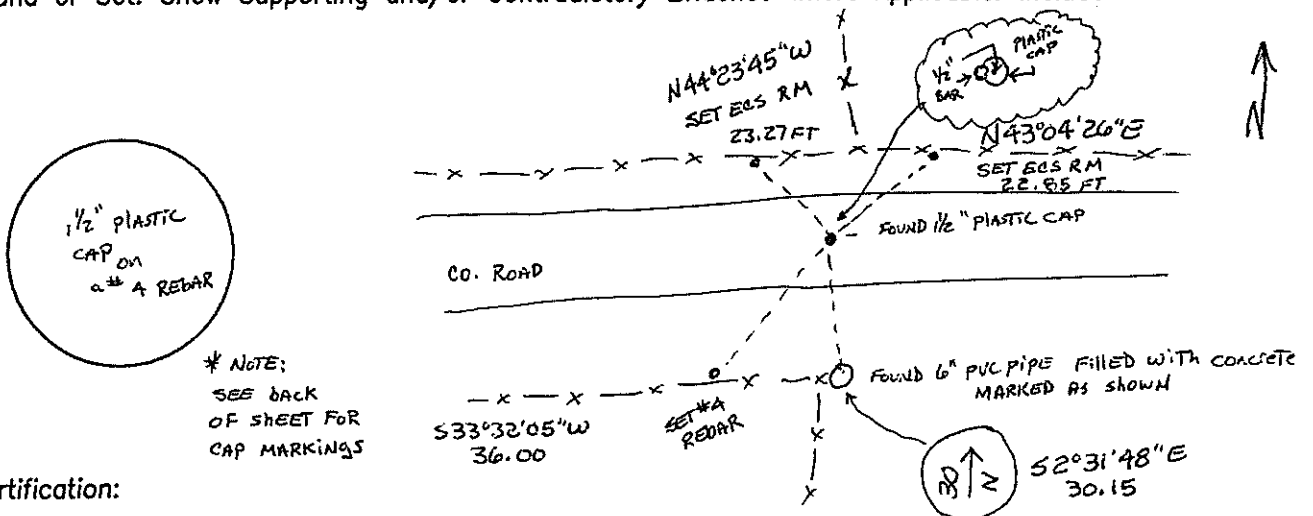

Certification:

Firm name and/or Surveyor: Johansen & Tuttle Eng.

Address: 90 S. 100 E. Castle Dale, Utah 84513 Phone: (435) 381-2523

This is to certify that I was in responsible charge of the surveying work described in this record and that to the best of my knowledge the information presented herein is true and correct.

Location Diagram:

Section: 35

Township: 17S

Range: 8E

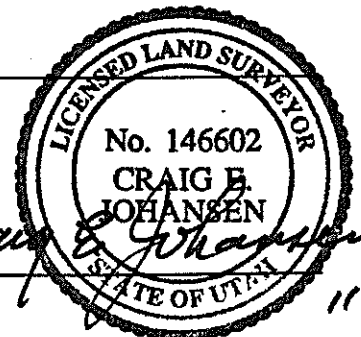
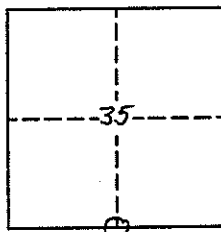

Date

11-30-00

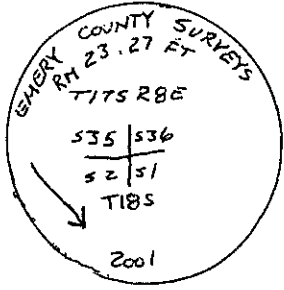

NORTH WEST RM

1708600100

SHEET 2

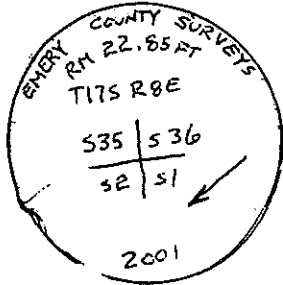

NORTHEAST RM

EMERY COUNTY LAND SURVEY MONUMENT RECORD

Date of field work: 5-7-01

County Reference No. 1708540100

Type of Monument: Section Corner Quarter Corner
 Bench Mark Other

Your Description and Observation of Monument Found (Be Specific):
NONE

Description of Monument, Reference Monument or Accessories Established by You to Perpetuate the Location of this Point:

SET A 8" x 3/8" SPIKE 2°± NORTH OF THE NORTH SHO. OF CO. ROAD BY PROPORTIONATE MEASURE
 SET A STD ECS RM CAP SOUTHEAST, AND SOUTH WEST OF THE CORNER
 SET A #4 REBAR SOUTHEAST, AND SOUTHWEST OF THE MONUMENT

Sketch showing Relative Location of Monument Accessories and Two Reference Points Stating Whether Found or Set. Show Supporting and/or Contradictory Evidence where Applicable. Include North Arrow.

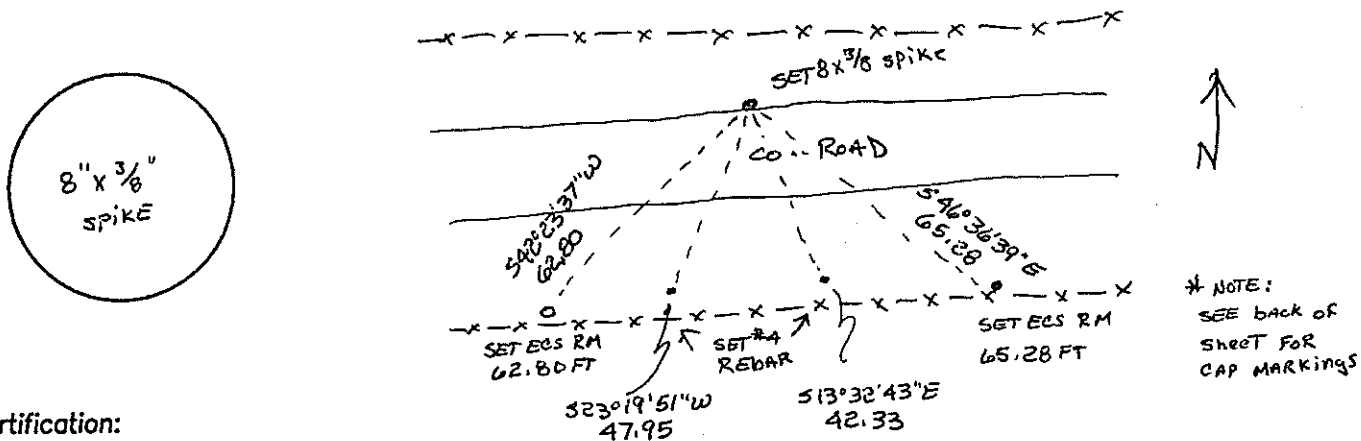

Certification:

Firm name and/or Surveyor: Johansen & Tuttle Eng.

Address: 90 S. 100 E. Castle Dale, Utah 84513 Phone: (435) 381-2523

This is to certify that I was in responsible charge of the surveying work described in this record and that to the best of my knowledge the information presented herein is true and correct.

Location Diagram:

Section: 35
 Township: 17S
 Range: 8E

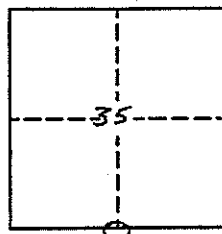

Craig E. Johansen
 Date 11-30-01

1708540100

SHEET 2

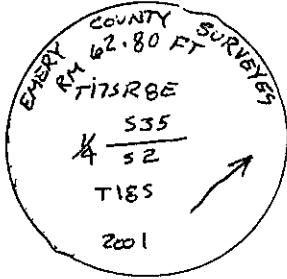

SOUTHWEST RM

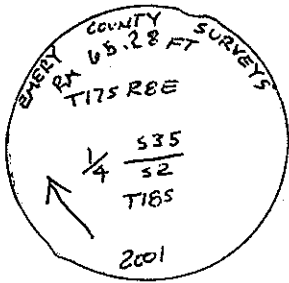

SOUTHEAST RM

UTAH LAND SURVEY MONUMENT RECORD

County EMERY

County Reference No. 1708
027500100

1. Date of Field Work: 1-5-01
2. Type of Monument:
 (Check one) Section Corner Quarter Corner
 Bench Mark Other

3. Your Description and Observation of Monument Found (Be Specific):
FOUND STD BLM CAP AT A SOUTH-EAST-FENCE CORNER

4. Description of Monument, Reference Monument or Accessories Established by You to Perpetuate the Location of this Point:
SET 2 #4 REBARS EAST, AND SOUTH OF MONUMENT

5. Sketch showing Relative Location of Monument Accessories and Two Reference Points Stating Whether Found or Set. Show Supporting and/or Contradictory Evidence where Applicable. Include North Arrow.

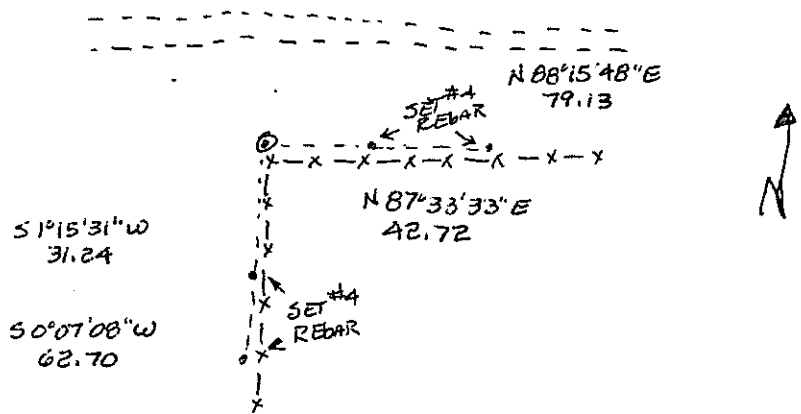

6. Certification:
 Firm Name and/or Surveyor: JOHANSEN & TUTTLE ENG Phone: 435) 381-2523
 Address: 90 S 100 E CASTLEDALE UT

This is to certify that I was in responsible charge of the surveying work described in this record and that to the best of my knowledge the information presented herein is true and correct.

7. Location Diagram:
 8. Section: 35
 9. Township: 17S
 10. Range: 8E

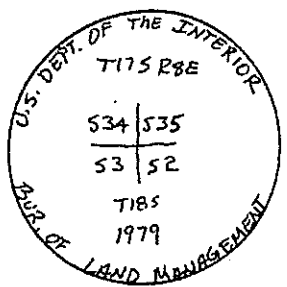
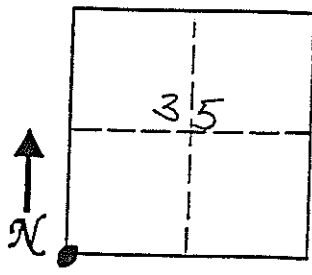

11. Monument Inscription:

12. Diagram Coordinate from Master Index for Townships: _____

Signature: _____
 Surveyor's Seal (over signature)
 Date: _____

LICENSED LAND SURVEYOR

No. 146602

CRAIG E. JOHANSEN

STATE OF UTAH

11-30-01

Report one monument per form.
 Type or use permanent black ink.
 Fill in all items.

EMERY COUNTY LAND SURVEY MONUMENT RECORD

Date of field work: 4-19-01

County Reference No. 1708500140

Type of Monument: Section Corner ✓ Quarter Corner
 Bench Mark Other

Your Description and Observation of Monument Found (Be Specific):
FOUND STD BLM CAP AT THE BASE OF A LARGE TREE ON THE NORTH SIDE

Description of Monument, Reference Monument or Accessories Established by You to Perpetuate the Location of this Point:
SET #5 REBAR NORTH, NORTHWEST, WEST, AND SOUTHWEST OF THE MONUMENT

Sketch showing Relative Location of Monument Accessories and Two Reference Points Stating Whether Found or Set. Show Supporting and/or Contradictory Evidence where Applicable. Include North Arrow.

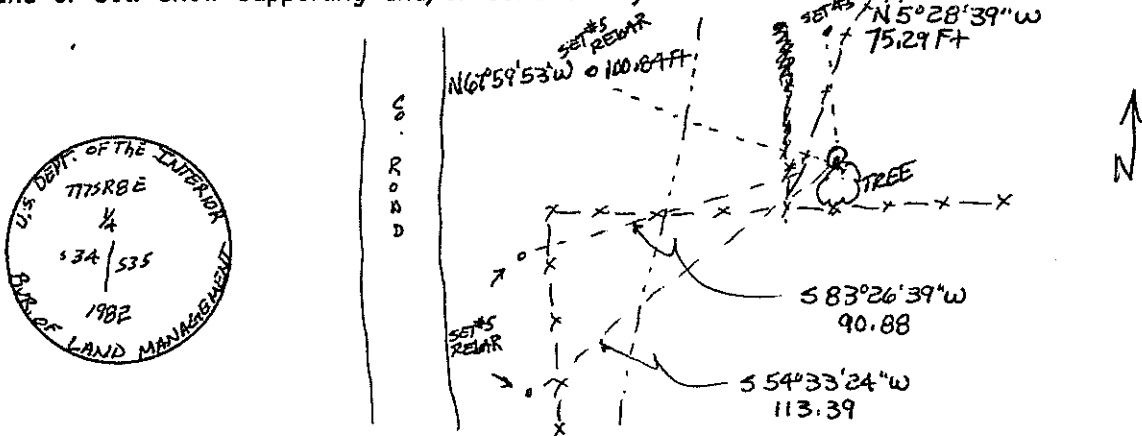

Certification:

Firm name and/or Surveyor: Johansen & Tuttle Eng.
 Address: 90 S. 100 E. Castle Dale, Utah 84513 Phone: (435) 381-2523

This is to certify that I was in responsible charge of the surveying work described in this record and that to the best of my knowledge the information presented herein is true and correct.

Location Diagram:
 Section: 35
 Township: 17S
 Range: 8E

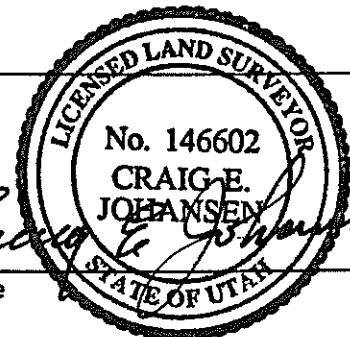
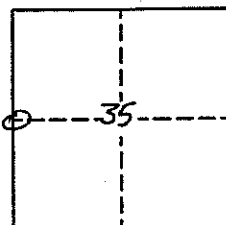

Date