

PLSS GPS Observation Sheet

Project Name SL T16S R10E <small>(Meridian Township Range)</small>				Township		½ (2)	N S	Range		½ (2)	E W	Section		Meridian																
				T	1	6	S	1	0	E				(SL)	US															
Contacts Name Lee M. Swasey				Source Agency JOHANSEN & TUTTLE ENGINEERING						Date 12/06/05																				
Contacts Phone (435) 381-2523																														
Control Station																														
Name CP-WEST				Type								Accuracy																		
				COR	HARN	TRI	Other LOCAL SURVEY					Order																		
USGS Quad Name ELMO UTAH				Datum								State UTAH																		
				Nad27	Nad83	(Nad83 1994)		WGS84	Local		County EMERY																			
Latitude							Longitude																							
N	3	9	-	2	8	-	0	8	.	2	2	8	1	8	W	1	1	0	-	4	7	-	1	5	.	1	3	2	7	7
Northing							Easting																							
6	9	7	6	1	1	2	.	8	0	1	8	4	1	5	4	5	.	4	0											
Units				Survey Foot	International Foot		Meter		Coordinate Type				State Plane		UTM															
Zone				Utah North	Utah Central		Utah South		Vertical Datum				NGVD29		NAVD88															
Ellipsoid Height				1711.15 M				FT		Geoid Height				M		5671.75 FT														
Base Receiver																														
Type TRIMBLE				Model 4000 SSI				Serial Number																						
Logging Interval		5 SEC.		Elevation Mask		13		PDOP Mask		6		Antenna Type L1/L2 w/GROUND PLANE																		
Start Time				AM		PM		End Time				AM		PM																
Antenna Height																														
Session Beginning		1 st		M		2 nd		M		3 rd		M		Ave		4.482 Feet M														
Session End		1 st		M		2 nd		M		3 rd		M		Ave		M														
Rover Receiver																														
Type TRIMBLE				Model 5800				Serial Number 4253117118																						
Approximate Distance From Base Station				Miles		Antenna Type 5800 INTERNAL				Antenna Height 6.6 FT																				
Station Observation																														
Observation Type				(RTK)		FAST STATIC		STATIC		OTHER																				
First Observation																														
Station Name (M1)		4		0		0		6		4		0		Description		E 1/4 corner Sec. 4														
Occupation time				PDOP Best				RMS Best																						
Number of Measurements				60				PDOP Worst				1.7				RMS Worst				10.0										
Second Observation																														
Station Name (M2)		Description																												
Occupation time				PDOP Best				RMS Best																						
Number of Measurements				PDOP Worst				RMS Worst																						
Inverse Distance Between M1 and M2				FT		Alternate Base Station Used				Yes		No																		
Monument and Markings																														
Type / Size																														
Stone				Pipe/Cap				Post				Other																		
Size				2½ / 3¼ 1969 BLM				Size				Size																		
Material				steel / brass				Material				Material																		

Sketch/Rubbing or Attach Photo of GPS Station Occupied
Show rotation of stampings/markings relative to North and describe briefly

See Emery County Land Survey Monument Record Sheet 1610400640

EMERY COUNTY LAND SURVEY MONUMENT RECORD

Date of field work: 12-5-05

County Reference No. 1610400640

Type of Monument: Section Corner
 Bench Mark

Quarter Corner
 Other

Your Description and Observation of Monument Found (Be Specific):

1969 BLM BRASS CAP 6" ABOVE GROUND LEVEL

Description of Monument, Reference Monument or Accessories Established by You to Perpetuate the Location of this Point: SET 4 #4 REBAR AS SHOWN BELOW

Sketch showing Relative Location of Monument Accessories and Two Reference Points Stating Whether Found or Set. Show Supporting and/or Contradictory Evidence where Applicable. Include North Arrow.

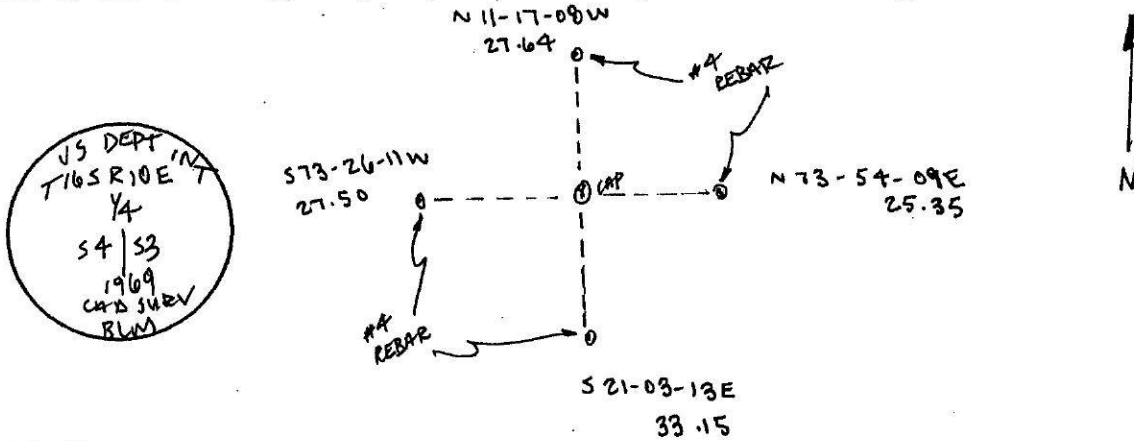

Certification:

Firm name and/or Surveyor: Johansen & Tuttle Eng.

Address: 90 S. 100 E. Castle Dale, Utah 84513 Phone: (435) 381-2523

This is to certify that I was in responsible charge of the surveying work described in this record and that to the best of my knowledge the information presented herein is true and correct.

Location Diagram:
 Section: A
 Township: 16S
 Range: 10E

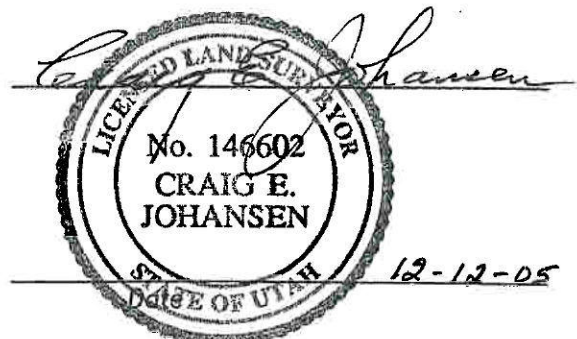
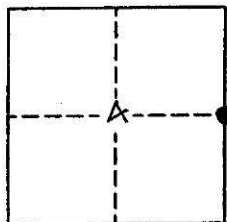

PLSS GPS Observation Sheet

Project Name SL T16S R10E <small>(Meridian Township Range)</small>				Township		½ (2)	N S	Range		½ (2)	E W	Section		Meridian																		
				T	1	6	S	1	0		E			(SL)	US																	
Contacts Name Lee M. Swasey				Source Agency JOHANSEN & TUTTLE ENGINEERING						Date 11/17/05																						
Contacts Phone (435) 381-2523																																
Control Station																																
Name ELM GPS 12				Type COR HARN TRI <u>Other</u> EMERY COUNTY						Accuracy Order																						
USGS Quad Name OLSEN RESERVOIR UTAH				Datum Nad27 Nad83 <u>(Nad83 1994)</u> WGS84 Local						State UTAH County EMERY																						
Latitude								Longitude																								
N	3	9	-	2	3	-	2	5	.	4	2	8	1	2	7	W	1	1	0	-	4	5	-	0	1	.	5	8	6	1	0	
Northing								Easting																								
6	9	4	7	5	8	7	.	6	3								1	8	5	2	2	5	7	.	0	6						
Units Survey Foot <u>International Foot</u> Meter				Coordinate Type State Plane <u>UTM</u>				Zone Utah North <u>Utah Central</u> Utah South				Vertical Datum NGVD29 <u>NAVD88</u>																				
Ellipsoid Height 1711.15 M				FT				Geoid Height M				5671.75 FT																				
Base Receiver																																
Type TRIMBLE				Model 4000 SSI				Serial Number																								
Logging Interval 5 SEC.				Elevation Mask 13				PDOP Mask 6				Antenna Type L1/L2 w/GROUND PLANE																				
Start Time				AM PM				End Time				AM PM																				
Antenna Height																																
Session Beginning				1" M				2" M				3" M				Ave 4.547 Feet M																
Session End				1" M				2" M				3" M				Ave M																
Rover Receiver																																
Type TRIMBLE				Model 5800				Serial Number 4253117118																								
Approximate Distance From Base Station				Miles				Antenna Type 5800 INTERNAL				Antenna Height 6.6 FT																				
Station Observation																																
Observation Type <u>RTK</u> FAST STATIC STATIC OTHER																																
First Observation																																
Station Name (M1)				4 0 0 6 2 0				Description S 1/16 corner Sec. 4 - Sec. 3																								
Occupation time				PDOP Best				RMS Best																								
Number of Measurements 60				PDOP Worst 3.2				RMS Worst 22.0																								
Second Observation																																
Station Name (M2)				Description																												
Occupation time				PDOP Best				RMS Best																								
Number of Measurements				PDOP Worst				RMS Worst																								
Inverse Distance Between M1 and M2				FT				Alternate Base Station Used				Yes No																				
Monument and Markings																																
Type / Size																																
Stone				Pipe/Cap				Post				Other																				
Size				Size 2½ / 3¼ 1969 BLM				Size				Size																				
Material				Material steel / brass				Material				Material																				

Sketch/Rubbing or Attach Photo of GPS Station Occupied
Show rotation of stampings/markings relative to North and describe briefly

See Emery County Land Survey Monument Record Sheet 1610400620

EMERY COUNTY LAND SURVEY MONUMENT RECORD

Date of field work: 11-17-05

County Reference No. 1610400620

Type of Monument: Section Corner
 Bench Mark

Quarter Corner
 Other 1/16 CORNER

Your Description and Observation of Monument Found (Be Specific):
 1969 BLM BRASS CAP 8" ABOVE GROUND LEVEL

Description of Monument, Reference Monument or Accessories Established by You to Perpetuate the Location of this Point: SET 4 #4 REBAR AS SHOWN BELOW

Sketch showing Relative Location of Monument Accessories and Two Reference Points Stating Whether Found or Set. Show Supporting and/or Contradictory Evidence where Applicable. Include North Arrow.

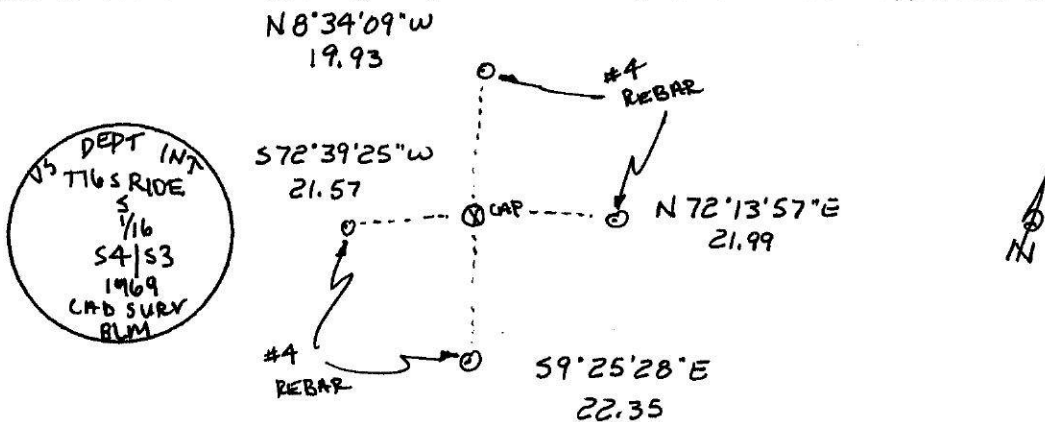

Certification:

Firm name and/or Surveyor: Johansen & Tuttle Eng.

Address: 90 S. 100 E. Castle Dale, Utah 84513 Phone: (435) 381-2523

This is to certify that I was in responsible charge of the surveying work described in this record and that to the best of my knowledge the information presented herein is true and correct.

Location Diagram:
 Section: 4
 Township: 16 S
 Range: 10 E

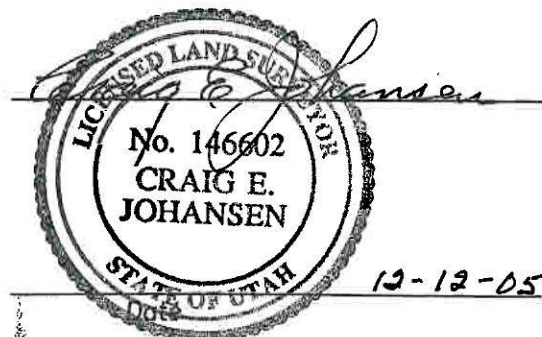
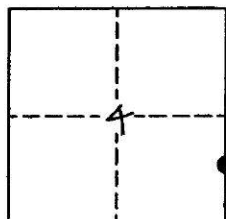

EMERY COUNTY LAND SURVEY MONUMENT RECORD

Date of field work: 11-17-05

County Reference No. 1610400600

Type of Monument: Section Corner
 Bench Mark

Quarter Corner
 Other _____

Your Description and Observation of Monument Found (Be Specific):
 1969 BLM BRASS CAP 6" ABOVE GROUND LEVEL WITH A STEEL FENCE POST ALONGSIDE

Description of Monument, Reference Monument or Accessories Established by You to Perpetuate the Location of this Point: SET 4 #4 REBAR AS SHOWN BELOW

Sketch showing Relative Location of Monument Accessories and Two Reference Points Stating Whether Found or Set. Show Supporting and/or Contradictory Evidence where Applicable. Include North Arrow.

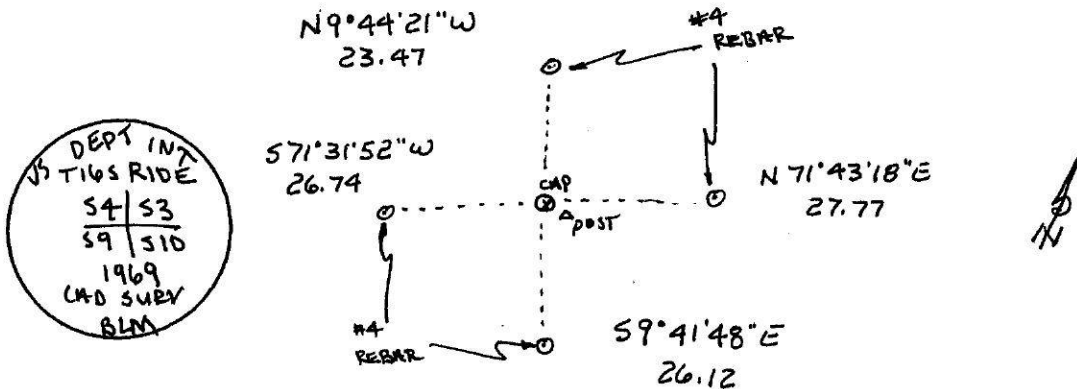

Certification:

Firm name and/or Surveyor: Johansen & Tuttle Eng.

Address: 90 S. 100 E. Castle Dale, Utah 84513 Phone: (435) 381-2523

This is to certify that I was in responsible charge of the surveying work described in this record and that to the best of my knowledge the information presented herein is true and correct.

Location Diagram:
 Section: 4
 Township: 16S
 Range: 10E

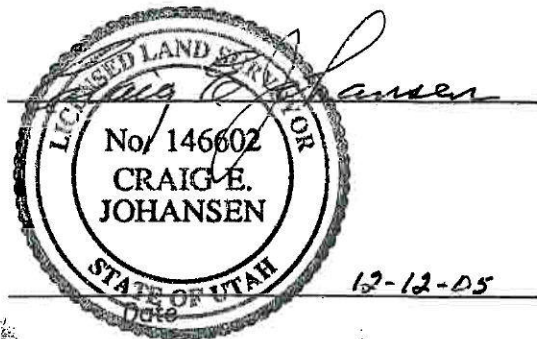
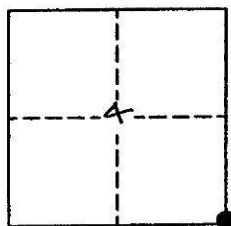

PLSS GPS Observation Sheet

Project Name SL T16S R10E <small>(Meridian Township Range)</small>		Township T 1 6		Range S 1 0		Section E		Meridian SL US	
Contacts Name Lee M. Swasey		Source Agency JOHANSEN & TUTTLE ENGINEERING				Date 12/05/05			
Contacts Phone (435) 381-2523									
Control Station									
Name CP-WEST		COR		HARN		TRI		Type <input checked="" type="radio"/> LOCAL SURVEY	
USGS Quad Name ELMO UTAH		Datum Nad27		Nad83		<input checked="" type="radio"/> Nad83 (1994)		WGS84	
						Local		Accuracy Order	
								State UTAH	
								County EMERY	
Latitude					Longitude				
N 3 9 - 2 8 - 0 8 . 2 2 8 1 8					W 1 1 0 - 4 7 - 1 5 . 1 3 2 7 7				
Northing					Easting				
6 9 7 6 1 1 2 . 8 0					1 8 4 1 5 4 5 . 4 0				
Units Survey Foot		<input checked="" type="radio"/> International Foot		Meter		Coordinate Type State Plane		UTM	
Zone Utah North		<input checked="" type="radio"/> Utah Central		Utah South		Vertical Datum NGVD29		<input checked="" type="radio"/> NAVD88	
Ellipsoid Height 1711.15 M		FT		Geoid Height M				5671.75 FT	
Base Receiver									
Type TRIMBLE		Model 4000 SSI				Serial Number			
Logging Interval 5 SEC.		Elevation Mask 13		PDOP Mask 6		Antenna Type L1/L2 w/GROUND PLANE			
Start Time		AM		PM		End Time			
Antenna Height									
Session Beginning		1"		M		2"		M	
Session End		1"		M		2"		M	
								Ave 4.482 Feet M	
								Ave M	
Rover Receiver									
Type TRIMBLE		Model 5800				Serial Number 4253117118			
Approximate Distance From Base Station		Miles		Antenna Type 5800 INTERNAL				Antenna Height 6.6 FT	
Station Observation									
Observation Type <input checked="" type="radio"/> RTK		FAST STATIC		STATIC		OTHER			
First Observation									
Station Name (M1)		3 0 0 7 0 0		Description NE corner Sec. 5					
Occupation time		PDOP Best				RMS Best			
Number of Measurements 60		PDOP Worst 1.0				RMS Worst 13.1			
Second Observation									
Station Name (M2)		Description							
Occupation time		PDOP Best				RMS Best			
Number of Measurements		PDOP Worst				RMS Worst			
Inverse Distance Between M1 and M2		FT		Alternate Base Station Used		Yes		No	
Monument and Markings									
Type / Size									
Stone		Pipe/Cap				Post		Other	
Size		Size 2½ / 3¼ 1969 BLM				Size		Size	
Material		Material steel / brass				Material		Material	

Sketch/Rubbing or Attach Photo of GPS Station Occupied
Show rotation of stampings/markings relative to North and describe briefly

See Emery County Land Survey Monument Record Sheet 1610300700

EMERY COUNTY LAND SURVEY MONUMENT RECORD

Date of field work: 12-9-05 County Reference No. 1610300700
 Type of Monument: Section Corner Quarter Corner
 Bench Mark Other _____

Your Description and Observation of Monument Found (Be Specific):
 1969 BLM BRASS CAP 12" ABOVE GROUND LEVEL WITH A STEEL POST DRIVEN
 ALONG SIDE. A 1969 BLM BRASS CAP CONTROLLING TOWNSHIP 15 SOUTH SECTION 33
 SETS TO THE EAST AS SHOWN BELOW.

Description of Monument, Reference Monument or Accessories Established by You to Perpetuate the
 Location of this Point: SET 4 #4 REBAR AS SHOWN BELOW

Sketch showing Relative Location of Monument Accessories and Two Reference Points Stating Whether
 Found or Set. Show Supporting and/or Contradictory Evidence where Applicable. Include North Arrow.

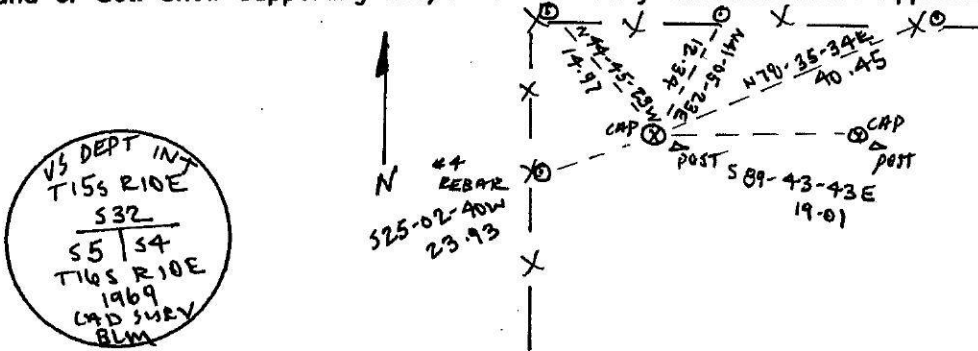

Certification:

Firm name and/or Surveyor: Johansen & Tuttle Eng.
 Address: 90 S. 100 E. Castle Dale, Utah 84513 Phone: (435) 381-2523

This is to certify that I was in responsible charge of the surveying work described in this record and that to the best of my knowledge the information presented herein is true and correct.

Location Diagram:
 Section: 4
 Township: 16S
 Range: 10E

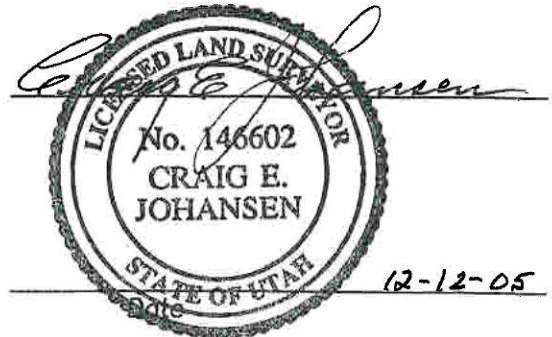
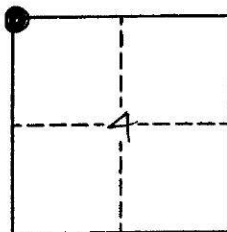

PLSS GPS Observation Sheet

Project Name SL T16S R10E (Meridian Township Range)		Township T 1 6		1/2 (2)	N S	Range 1 0		1/2 (2)	E W	Section	Meridian (SL) US																					
Contacts Name Lee M. Swasey		Source Agency JOHANSEN & TUTTLE ENGINEERING						Date 11/17/05																								
Contacts Phone (435) 381-2523																																
Control Station																																
Name ELM GPS 12		Type COR HARN TRI <input checked="" type="radio"/> Other EMERY COUNTY						Accuracy																								
USGS Quad Name OLSEN RESERVOIR UTAH		Datum Nad27 Nad83 <input checked="" type="radio"/> Nad83 (1994) WGS84 Local						Order State UTAH County EMERY																								
Latitude						Longitude																										
N	3	9	-	2	3	-	2	5	.	4	2	8	1	2	7	W	1	1	0	-	4	5	-	0	1	.	5	8	6	1	0	
Northing						Easting																										
6	9	4	7	5	8	7	.	6	3								1	8	5	2	2	5	7	.	0	6						
Units Survey Foot <input checked="" type="radio"/> International Foot Meter		Coordinate Type State Plane UTM		Zone Utah North <input checked="" type="radio"/> Utah Central Utah South		Vertical Datum NGVD29 <input checked="" type="radio"/> NAVD88		Ellipsoid Height 1711.15 M FT		Geoid Height M 5671.75 FT																						
Base Receiver																																
Type TRIMBLE		Model 4000 SSI				Serial Number																										
Logging Interval 5 SEC.		Elevation Mask 13		PDOP Mask 6		Antenna Type L1/L2 w/GROUND PLANE																										
Start Time AM PM				End Time AM PM																												
Antenna Height																																
Session Beginning		1 st M		2 nd M		3 rd M		Ave 4.547 Feet M		Session End																						
		1 st M		2 nd M		3 rd M		Ave M																								
Rover Receiver																																
Type TRIMBLE		Model 5800				Serial Number 4253117118																										
Approximate Distance From Base Station Miles				Antenna Type 5800 INTERNAL				Antenna Height 6.6 FT																								
Station Observation																																
Observation Type <input checked="" type="radio"/> RTK FAST STATIC STATIC OTHER																																
First Observation																																
Station Name (M1)		3 0 0 6 4 0		Description W 1/4 corner Sec. 4																												
Occupation time		PDOP Best				RMS Best																										
Number of Measurements 60		PDOP Worst 2.2				RMS Worst 34.6																										
Second Observation																																
Station Name (M2)		Description																														
Occupation time		PDOP Best				RMS Best																										
Number of Measurements		PDOP Worst				RMS Worst																										
Inverse Distance Between M1 and M2 FT						Alternate Base Station Used Yes No																										
Monument and Markings																																
Type / Size																																
Stone		Pipe/Cap				Post				Other																						
Size		Size 2 1/2 / 3/4 1969 BLM				Size				Size																						
Material		Material steel / brass				Material				Material																						

Sketch/Rubbing or Attach Photo of GPS Station Occupied
Show rotation of stampings/markings relative to North and describe briefly

See Emery County Land Survey Monument Record Sheet 1610300640

EMERY COUNTY LAND SURVEY MONUMENT RECORD

Date of field work: 11-17-05

County Reference No. 1610300640

Type of Monument: Section Corner ✓ Quarter Corner
 Bench Mark Other

Your Description and Observation of Monument Found (Be Specific):
 1969 BLM BRASS CAP 3" ABOVE GROUND LEVEL

Description of Monument, Reference Monument or Accessories Established by You to Perpetuate the Location of this Point: SET 4 #4 REBAR AS SHOWN BELOW
 DRIVE A 3/4" STEEL PIPE ALONGSIDE CAP.

Sketch showing Relative Location of Monument Accessories and Two Reference Points Stating Whether Found or Set. Show Supporting and/or Contradictory Evidence where Applicable. Include North Arrow.

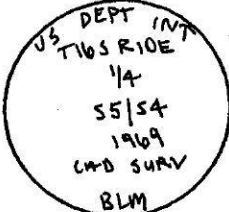
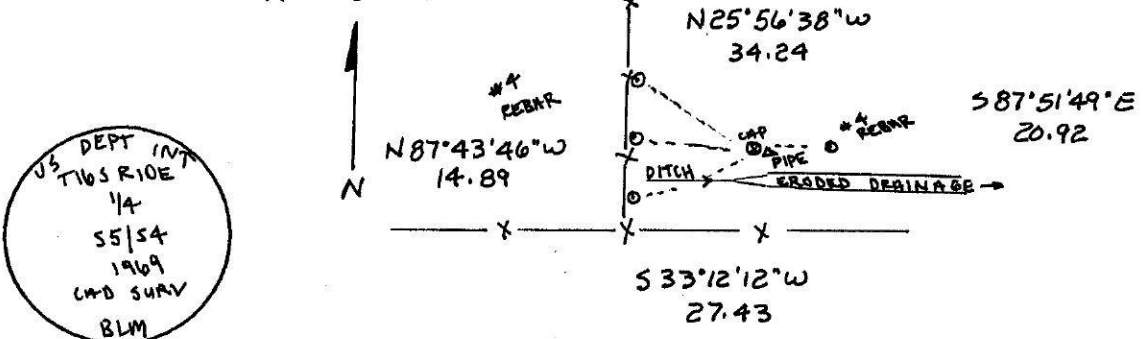

Certification:

Firm name and/or Surveyor: Johansen & Tuttle Eng.
 Address: 90 S. 100 E. Castle Dale, Utah 84513 Phone: (435) 381-2523

This is to certify that I was in responsible charge of the surveying work described in this record and that to the best of my knowledge the information presented herein is true and correct.

Location Diagram:
 Section: A
 Township: 16S
 Range: 10E

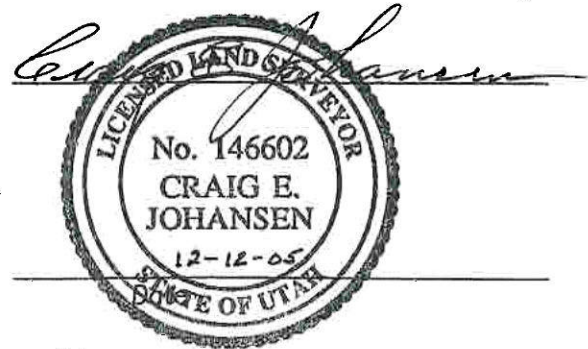
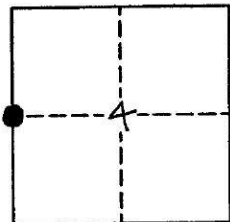

PLSS GPS Observation Sheet

Project Name SL T16S R10E <small>(Meridian Township Range)</small>		Township T 1 6		1/2 (2) N S	Range 1 0		1/2 (2) E W	Section		Meridian SL US																					
Contacts Name Lee M. Swasey		Source Agency JOHANSEN & TUTTLE ENGINEERING						Date 11/17/05																							
Contacts Phone (435) 381-2523																															
Control Station																															
Name ELM GPS 12		Type COR HARN TRI Other EMERY COUNTY						Accuracy Order																							
USGS Quad Name OLSEN RESERVOIR UTAH		Datum Nad27 Nad83 Nad83 (1994) WGS84 Local						State UTAH County EMERY																							
Latitude						Longitude																									
N	3	9	-	2	3	-	2	5	.	4	2	8	1	2	7	W	1	1	0	-	4	5	-	0	1	.	5	8	6	1	0
Northing						Easting																									
6	9	4	7	5	8	7	.	6	3							1	8	5	2	2	5	7	.	0	6						
Units Survey Foot <input type="checkbox"/> International Foot <input checked="" type="checkbox"/> Meter <input type="checkbox"/>		Coordinate Type State Plane <input type="checkbox"/> UTM <input type="checkbox"/>		Zone Utah North <input type="checkbox"/> Utah Central <input checked="" type="checkbox"/> Utah South <input type="checkbox"/>		Vertical Datum NGVD29 <input type="checkbox"/> NAVD88 <input checked="" type="checkbox"/>		Ellipsoid Height 1711.15 M		FT		Geoid Height M		5671.75 FT																	
Base Receiver																															
Type TRIMBLE		Model 4000 SSI				Serial Number																									
Logging Interval 5 SEC.		Elevation Mask 13		PDOP Mask 6		Antenna Type L1/L2 w/GROUND PLANE																									
Start Time		AM		PM		End Time		AM		PM																					
Antenna Height																															
Session Beginning		1 st		M		2 nd		M		3 rd		M		Ave		4.547 Feet		M													
Session End		1 st		M		2 nd		M		3 rd		M		Ave				M													
Rover Receiver																															
Type TRIMBLE		Model 5800				Serial Number 4253117118																									
Approximate Distance From Base Station		Miles		Antenna Type 5800 INTERNAL				Antenna Height 6.6 FT																							
Station Observation																															
Observation Type <input checked="" type="checkbox"/> RTK		<input type="checkbox"/> FAST STATIC		<input type="checkbox"/> STATIC		<input type="checkbox"/> OTHER																									
First Observation																															
Station Name (M1)		3 0 0 6 2 0		Description S 1/16 corner Sec. 5 - Sec. 4																											
Occupation time		PDOP Best				RMS Best																									
Number of Measurements 60		PDOP Worst 2.3				RMS Worst 9.3																									
Second Observation																															
Station Name (M2)		Description																													
Occupation time		PDOP Best				RMS Best																									
Number of Measurements		PDOP Worst				RMS Worst																									
Inverse Distance Between M1 and M2		FT		Alternate Base Station Used				Yes		No																					
Monument and Markings																															
Type / Size																															
Stone		Pipe/Cap				Post				Other																					
Size		Size 2 1/2 / 3 1/4 1969 BLM				Size				Size																					
Material		Material steel / brass				Material				Material																					

Sketch/Rubbing or Attach Photo of GPS Station Occupied
Show rotation of stampings/markings relative to North and describe briefly

See Emery County Land Survey Monument Record Sheet 1610300620

EMERY COUNTY LAND SURVEY MONUMENT RECORD

Date of field work: 11-17-05

County Reference No. 1610300620

Type of Monument: Section Corner
 Bench Mark

 Quarter Corner
✓ Other 1/16 CORNER

Your Description and Observation of Monument Found (Be Specific):
1969 BLM BRASS CAP 8" ABOVE GROUND LEVEL

Description of Monument, Reference Monument or Accessories Established by You to Perpetuate the Location of this Point: SET 4 #4 REBAR AS SHOWN BELOW

Sketch showing Relative Location of Monument Accessories and Two Reference Points Stating Whether Found or Set. Show Supporting and/or Contradictory Evidence where Applicable. Include North Arrow.

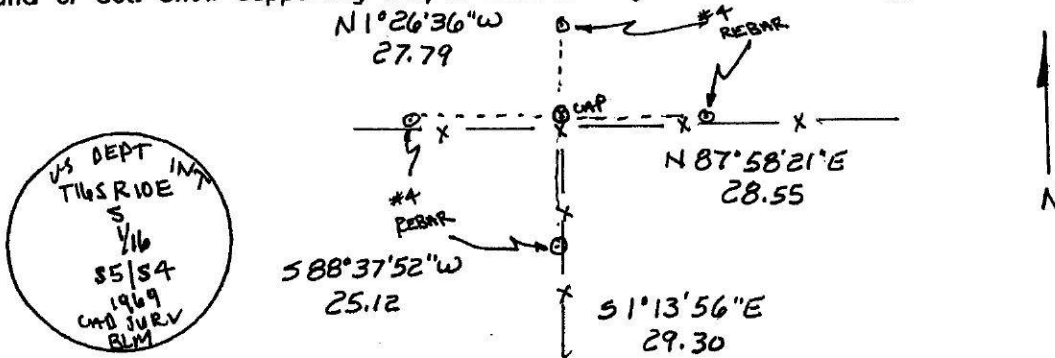

Certification:

Firm name and/or Surveyor: Johansen & Tuttle Eng.

Address: 90 S. 100 E. Castle Dale, Utah 84513

Phone: (435) 381-2523

This is to certify that I was in responsible charge of the surveying work described in this record and that to the best of my knowledge the information presented herein is true and correct.

Location Diagram:
 Section: A
 Township: 16S
 Range: 10E

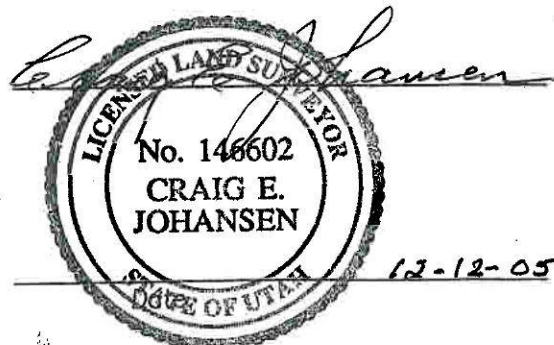
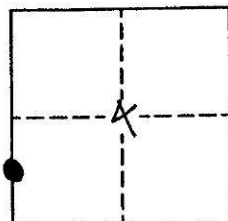

PLSS GPS Observation Sheet

Project Name SL T16S R10E <small>(Meridian Township Range)</small>				Township T 1 6		Range S 1 0		Section E		Meridian <input checked="" type="radio"/> SL <input type="radio"/> US																				
Contacts Name Lee M. Swasey				Source Agency JOHANSEN & TUTTLE ENGINEERING				Date 12/05/05																						
Contacts Phone (435) 381-2523																														
Control Station																														
Name CP-WEST				Type <input type="checkbox"/> COR <input type="checkbox"/> HARN <input type="checkbox"/> TRI <input checked="" type="checkbox"/> Other LOCAL SURVEY				Accuracy Order																						
USGS Quad Name ELMO UTAH				Datum <input type="checkbox"/> Nad27 <input type="checkbox"/> Nad83 <input checked="" type="checkbox"/> Nad83 (1994) <input type="checkbox"/> WGS84 <input type="checkbox"/> Local				State UTAH County EMERY																						
Latitude						Longitude																								
N	3	9	-	2	8	-	0	8	.	2	2	8	1	8	W	1	1	0	-	4	7	-	1	5	.	1	3	2	7	7
Northing						Easting																								
6	9	7	6	1	1	2	.	8	0	1	8	4	1	5	4	5	.	4	0											
Units Survey Foot <input type="checkbox"/> International Foot <input checked="" type="checkbox"/> Meter <input type="checkbox"/>				Coordinate Type State Plane <input checked="" type="checkbox"/> UTM <input type="checkbox"/>				Zone Utah North <input type="checkbox"/> Utah Central <input checked="" type="checkbox"/> Utah South <input type="checkbox"/>				Vertical Datum NGVD29 <input type="checkbox"/> NAVD88 <input checked="" type="checkbox"/>																		
Ellipsoid Height 1711.15 M				Geoid Height M 5671.75 FT																										
Base Receiver																														
Type TRIMBLE				Model 4000 SSI				Serial Number																						
Logging Interval 5 SEC.		Elevation Mask 13		PDOP Mask 6		Antenna Type L1/L2 w/GROUND PLANE																								
Start Time AM PM				End Time AM PM				Antenna Height																						
Session Beginning		1" M		2" M		3" M		Ave		4,482 Feet M																				
Session End		1" M		2" M		3" M		Ave		M																				
Rover Receiver																														
Type TRIMBLE				Model 5800				Serial Number 4253117118																						
Approximate Distance From Base Station				Miles				Antenna Type 5800 INTERNAL				Antenna Height 6.6 FT																		
Station Observation																														
Observation Type <input checked="" type="checkbox"/> RTK <input type="checkbox"/> FAST STATIC <input type="checkbox"/> STATIC <input type="checkbox"/> OTHER																														
First Observation																														
Station Name (M1)				Description N 1/4 corner Sec. 4																										
Occupation time				PDOP Best				RMS Best																						
Number of Measurements 60				PDOP Worst 1.7				RMS Worst 14.7																						
Second Observation																														
Station Name (M2)				Description																										
Occupation time				PDOP Best				RMS Best																						
Number of Measurements				PDOP Worst				RMS Worst																						
Inverse Distance Between M1 and M2				FT				Alternate Base Station Used Yes No																						
Monument and Markings																														
Type / Size																														
Stone			Pipe/Cap			Post			Other																					
Size			Size 2 1/2 / 3 1/4 1969 BLM			Size			Size																					
Material			Material steel / brass			Material			Material																					

Sketch/Rubbing or Attach Photo of GPS Station Occupied
Show rotation of stampings/markings relative to North and describe briefly

See Emery County Land Survey Monument Record Sheet 1610340700

EMERY COUNTY LAND SURVEY MONUMENT RECORD

Date of field work: 12-9-05

County Reference No. 10340700

Type of Monument: Section Corner ✓ Quarter Corner
 Bench Mark Other

Your Description and Observation of Monument Found (Be Specific):

1969 BLM BRASS CAP 8" ABOVE GROUND LEVEL WITH A STEEL POST DRIVEN ALONGSIDE. A 1969 BLM BRASS CAP CONTROLLING TOWNSHIP 15 SOUTH SECTION 33 SETS TO THE EAST AS SHOWN BELOW.

Description of Monument, Reference Monument or Accessories Established by You to Perpetuate the Location of this Point: SET 4 #4 REBAR AS SHOWN BELOW.

Sketch showing Relative Location of Monument Accessories and Two Reference Points Stating Whether Found or Set. Show Supporting and/or Contradictory Evidence where Applicable. Include North Arrow.

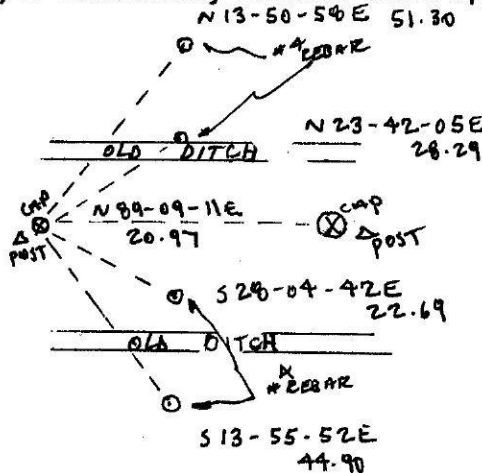
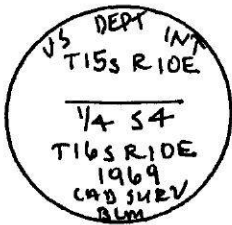

Certification:

Firm name and/or Surveyor: Johansen & Tuttle Eng.

Address: 90 S. 100 E. Castle Dale, Utah 84513 Phone: (435) 381-2523

This is to certify that I was in responsible charge of the surveying work described in this record and that to the best of my knowledge the information presented herein is true and correct.

Location Diagram:

Section: 4
 Township: 16S
 Range: 10E

