

EMERY COUNTY LAND SURVEY MONUMENT RECORD

Date of field work: 5-25-01

County Reference No. 1708360600

Type of Monument: Section Corner
 Bench Mark

Quarter Corner
 Other 1/16 CORNER

Your Description and Observation of Monument Found (Be Specific):

FOUND STD BLM CAP MARKED FOR THE E 1/16 OF S9 ONLY

Description of Monument, Reference Monument or Accessories Established by You to Perpetuate the Location of this Point:

SET #5 ROBAX NORTH, WEST, SOUTHWEST, AND SOUTHEAST OF THE MONUMENT

Sketch showing Relative Location of Monument Accessories and Two Reference Points Stating Whether Found or Set. Show Supporting and/or Contradictory Evidence where Applicable. Include North Arrow.

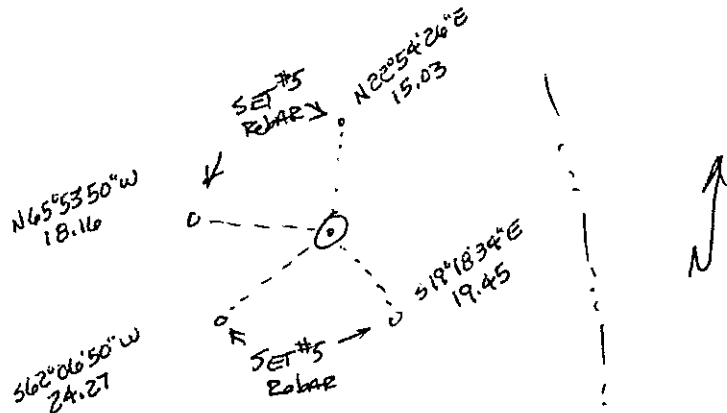
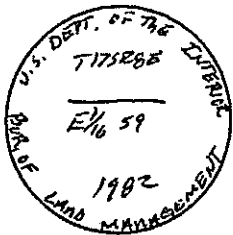

Certification:

Firm name and/or Surveyor: Johansen & Tuttle Eng.

Address: 90 S. 100 E. Castle Dale, Utah 84513

Phone: (435) 381-2523

This is to certify that I was in responsible charge of the surveying work described in this record and that to the best of my knowledge the information presented herein is true and correct.

Location Diagram:

Section: 9
 Township: 17S
 Range: 8E

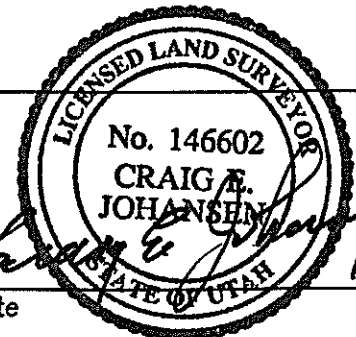
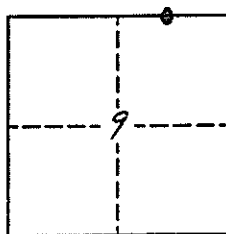

Date

11-30-01

EMERY COUNTY LAND SURVEY MONUMENT RECORD

Date of field work: 5-30-01

County Reference No. 1708360560

Type of Monument: Section Corner
 Bench Mark

Quarter Corner
 Other 1/4 CORNER

Your Description and Observation of Monument Found (Be Specific):

FOUND STD BLM CAP

Description of Monument, Reference Monument or Accessories Established by You to Perpetuate the Location of this Point:

SET #5 REBAR WEST, SOUTHWEST, SOUTH AND SOUTHEAST OF THE MONUMENT

Sketch showing Relative Location of Monument Accessories and Two Reference Points Stating Whether Found or Set. Show Supporting and/or Contradictory Evidence where Applicable. Include North Arrow.

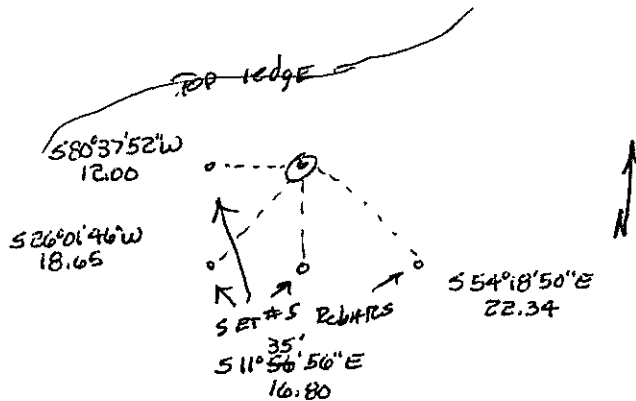

Certification:

Firm name and/or Surveyor: Johansen & Tuttle Eng.

Address: 90 S. 100 E. Castle Dale, Utah 84513 Phone: (435) 381-2523

This is to certify that I was in responsible charge of the surveying work described in this record and that to the best of my knowledge the information presented herein is true and correct.

Location Diagram:

Section: 9
 Township: 17S
 Range: 8E

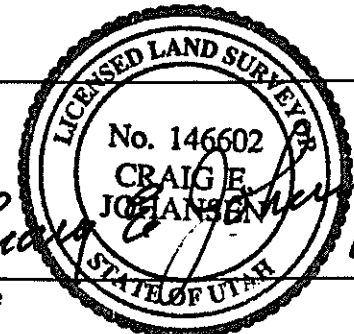
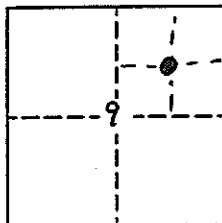

Craig E. Johansen
 Date 11-30-01

EMERY COUNTY LAND SURVEY MONUMENT RECORD

Date of field work: 5-30-01

County Reference No. 1708360540

Type of Monument: Section Corner Quarter Corner
 Bench Mark Other 1/16 CORNER

Your Description and Observation of Monument Found (Be Specific):

FOUND STD BLM CAP

Description of Monument, Reference Monument or Accessories Established by You to Perpetuate the Location of this Point:

SET #5 REBAR NORTH, NORTHWEST, WEST, AND SOUTHWEST OF THE MONUMENT

Sketch showing Relative Location of Monument Accessories and Two Reference Points Stating Whether Found or Set. Show Supporting and/or Contradictory Evidence where Applicable. Include North Arrow.

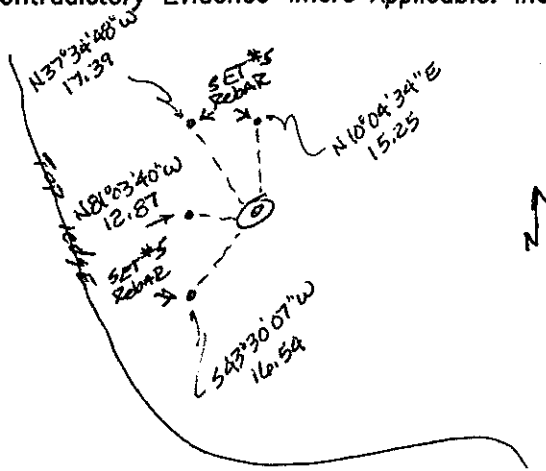

Certification:

Firm name and/or Surveyor: Johansen & Tuttle Eng.

Address: 90 S. 100 E. Castle Dale, Utah 84513 Phone: (435) 381-2523

This is to certify that I was in responsible charge of the surveying work described in this record and that to the best of my knowledge the information presented herein is true and correct.

Location Diagram:

Section: 9
 Township: 17S
 Range: 8E

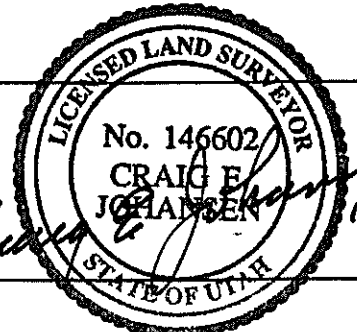
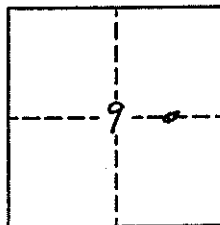

Craig E. Johansen
 Date 11-30-01

EMERY COUNTY LAND SURVEY MONUMENT RECORD

Date of field work: 5-30-01

County Reference No. 1708360520

Type of Monument: Section Corner Quarter Corner
 Bench Mark Other 1/16 CORNER

Your Description and Observation of Monument Found (Be Specific):

FOUND STD BLM CAP ON TOP OF ROADWAY CUT SLOPE

Description of Monument, Reference Monument or Accessories Established by You to Perpetuate the Location of this Point:

SET A *5 REBAR WEST, NORTHWEST, NORTH, AND NORTHEAST OF THE MONUMENT

Sketch showing Relative Location of Monument Accessories and Two Reference Points Stating Whether Found or Set. Show Supporting and/or Contradictory Evidence where Applicable. Include North Arrow.

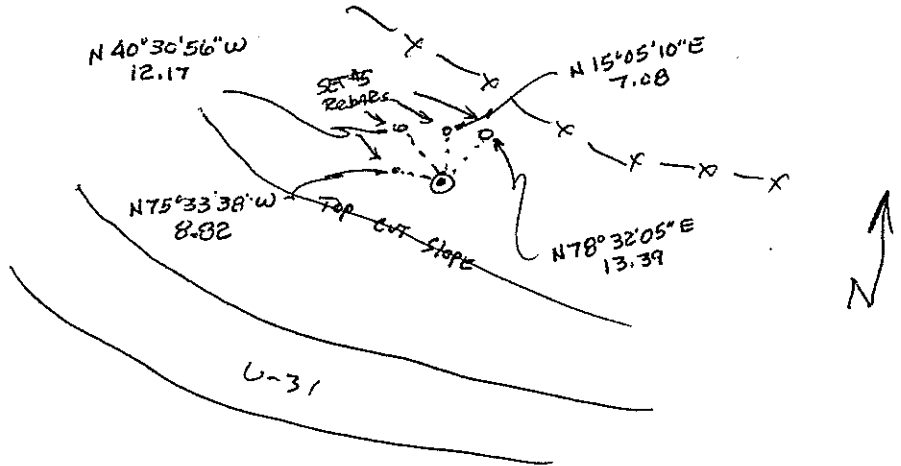
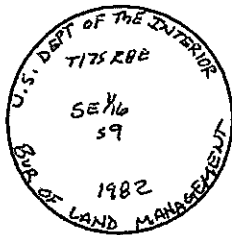

Certification:

Firm name and/or Surveyor: Johansen & Tuttle Eng.

Address: 90 S. 100 E. Castle Dale, Utah 84513 Phone: (435) 381-2523

This is to certify that I was in responsible charge of the surveying work described in this record and that to the best of my knowledge the information presented herein is true and correct.

Location Diagram:

Section: 9
 Township: 17S
 Range: 8E

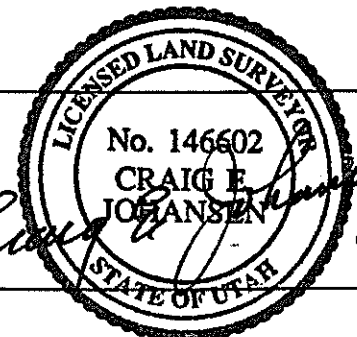
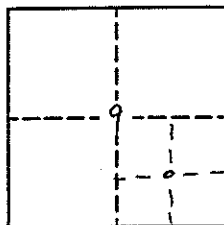

Craig E. Johansen
 Date 11-30-01

UTAH LAND SURVEY MONUMENT RECORD

County _____

County Reference No. 1708 360500

1. Date of Field Work: 5-30-01
2. Type of Monument: _____ Section Corner _____ Quarter Corner
 (Check one) _____ Bench Mark Other 1/16 CORNER

3. Your Description and Observation of Monument Found (Be Specific):
FOUND STD BLM CAP

4. Description of Monument, Reference Monument or Accessories Established by You to Perpetuate the Location of this Point:
SET 4 #5 REBARS SOUTHWEST OF THE MONUMENT

5. Sketch showing Relative Location of Monument Accessories and Two Reference Points Stating Whether Found or Set. Show Supporting and/or Contradictory Evidence where Applicable. Include North Arrow.

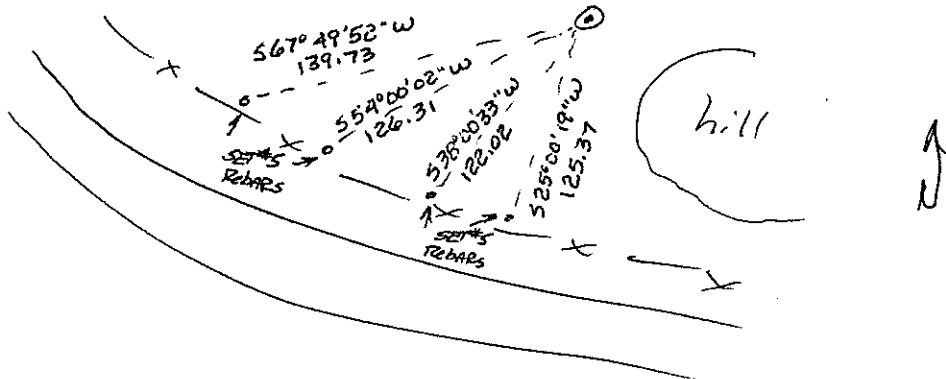

6. Certification:
 Firm Name and/or Surveyor: JOHANSEN & TUTTLE ENG Phone: 381-2523
 Address: 90 S 100 E CASTLE DALE UTAH

This is to certify that I was in responsible charge of the surveying work described in this record and that to the best of my knowledge the information presented herein is true and correct.

7. Location Diagram:
 8. Section: 9
 9. Township: 17S
 10. Range: 8E

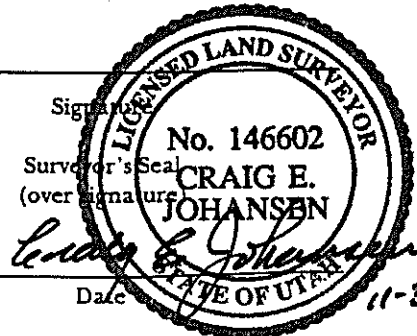
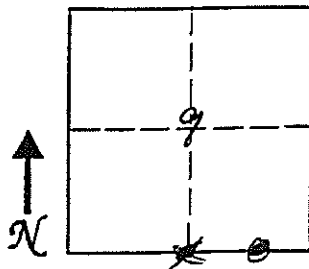
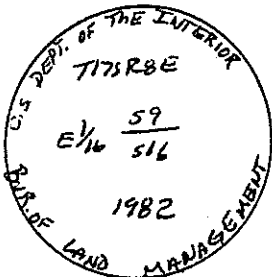

11. Monument Inscription:

12. Diagram Coordinate from Master Index for Townships: _____

Report one monument per form. Type or use permanent black ink. Fill in all items.

EMERY COUNTY LAND SURVEY MONUMENT RECORD

Date of field work: 5-24-01

County Reference No. 1708300 ⁵⁰⁵~~500~~

Type of Monument: Section Corner Quarter Corner
 Bench Mark Other _____

Your Description and Observation of Monument Found (Be Specific):
 Found STD BLM CAP MARKED FOR THE CORNERS OF S 9 & S 16
 Found STD BLM CAP MARKED FOR THE CORNERS OF S 8 & S 17 TO THE SOUTH

Description of Monument, Reference Monument or Accessories Established by You to Perpetuate the Location of this Point:
 SET #5 REBAR SOUTHWEST, SOUTH, AND SOUTHEAST OF THE MONUMENT

Sketch showing Relative Location of Monument Accessories and Two Reference Points Stating Whether Found or Set. Show Supporting and/or Contradictory Evidence where Applicable. Include North Arrow.

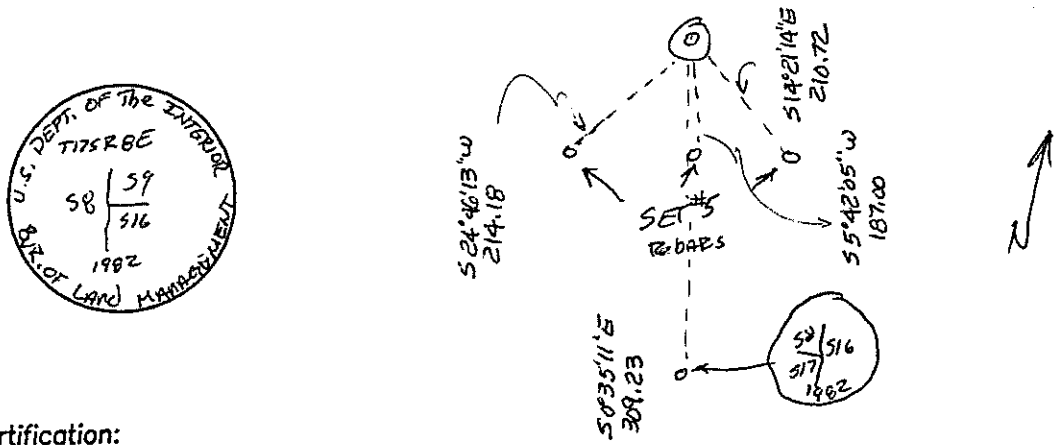

Certification:
 Firm name and/or Surveyor: Johansen & Tuttle Eng.
 Address: 90 S. 100 E. Castle Dale, Utah 84513 Phone: (435) 381-2523

This is to certify that I was in responsible charge of the surveying work described in this record and that to the best of my knowledge the information presented herein is true and correct.

Location Diagram:
 Section: 9
 Township: 17S
 Range: 8E

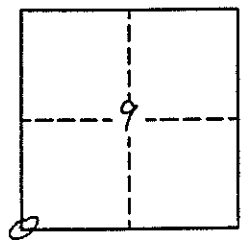

Date: _____

UTAH LAND SURVEY MONUMENT RECORD

County EMERY

County Reference No. 1708
6917 300 540

1. Date of Field Work: 1-19-01

2. Type of Monument:
(Check one)

Section Corner Quarter Corner
 Bench Mark Other

3. Your Description and Observation of Monument Found (Be Specific):

FOUND STD BLM CAP

4. Description of Monument, Reference Monument or Accessories Established by You to Perpetuate the Location of this Point:

SET #4 REBAR EAST, SOUTHEAST, SOUTH, AND SOUTHWEST OF THE MONUMENT

5. Sketch showing Relative Location of Monument Accessories and Two Reference Points Stating Whether Found or Set. Show Supporting and/or Contradictory Evidence where Applicable. Include North Arrow.

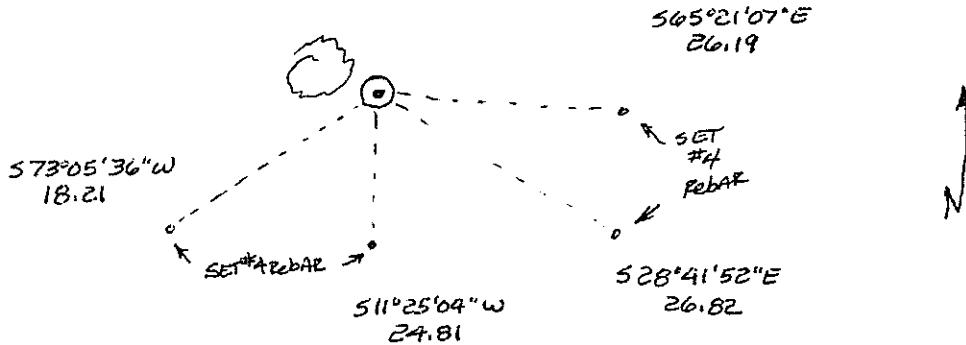

6. Certification:

Firm Name and/or Surveyor: JOHANSEN & TUTTLE ENG Phone: 381-2523
Address: 90 S 100 E CASTLE DALE UTAH

This is to certify that I was in responsible charge of the surveying work described in this record and that to the best of my knowledge the information presented herein is true and correct.

7. Location Diagram:

8. Section: 9
9. Township: 17S
10. Range: 8E

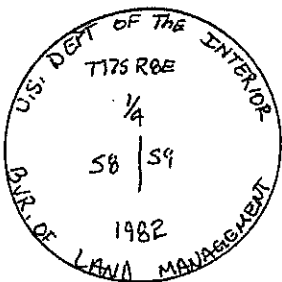
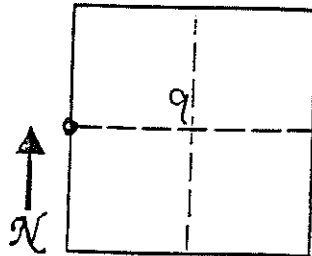

11. Monument Inscription:

Signature: _____
Surveyor's Seal (over signature) No. 146602
CRAIG E. JOHANSEN

Date: _____

12. Diagram Coordinate from Master Index for Townships: _____

Report one monument per form.
Type or use permanent black ink.
Fill in all items.

11-30-01

UTAH LAND SURVEY MONUMENT RECORD

County EMERY

County Reference No. ¹⁷⁰⁸
~~2017300560~~

1. Date of Field Work: 1-19-01

2. Type of Monument: (Check one)
 Section Corner Quarter Corner
 Bench Mark Other 1/16 CORNER

3. Your Description and Observation of Monument Found (Be Specific):
FOUND STD BLM CAP IN ORCHARD

4. Description of Monument, Reference Monument or Accessories Established by You to Perpetuate the Location of this Point:
~~None Feasible~~
NONE FEASIBLE

5. Sketch showing Relative Location of Monument Accessories and Two Reference Points Stating Whether Found or Set. Show Supporting and/or Contradictory Evidence where Applicable. Include North Arrow.

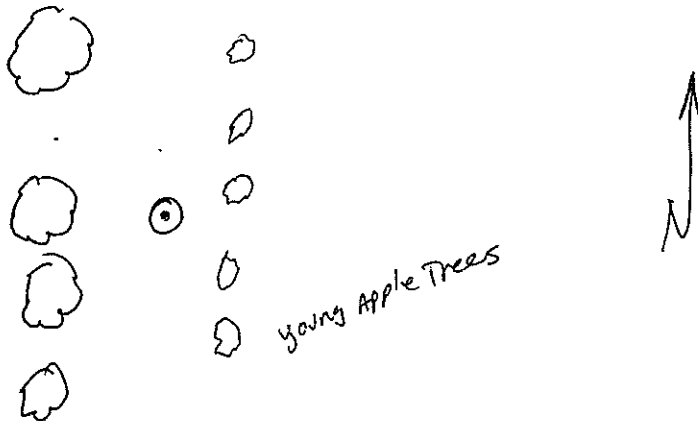

6. Certification:

Firm Name and/or Surveyor: JOHANSEN & TUTTLE ENG Phone: 381-2523
 Address: 905 100E CASTLE DALE UTAH

This is to certify that I was in responsible charge of the surveying work described in this record and that to the best of my knowledge the information presented herein is true and correct.

7. Location Diagram:
 8. Section: 9
 9. Township: 17S
 10. Range: 8E

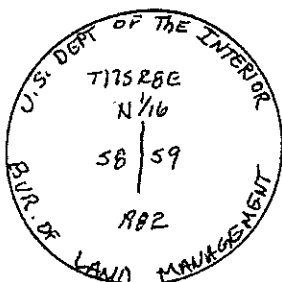
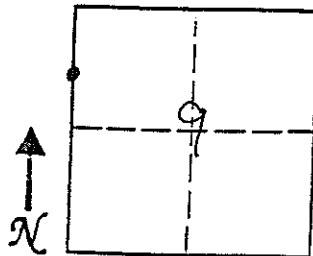

11. Monument Inscription:

12. Diagram Coordinate from Master Index for Townships: _____

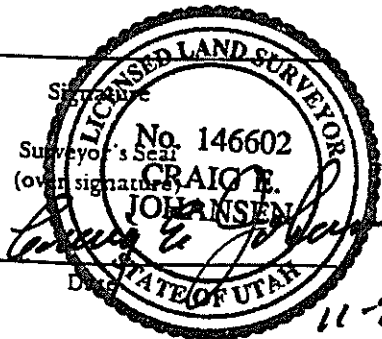

Report one monument per form.
 Type or use permanent black ink.
 Fill in all items.

11-30-01

UTAH LAND SURVEY MONUMENT RECORD

County _____

County Reference No. 1708340500

1. Date of Field Work: 5-30-01

2. Type of Monument: _____ Section Corner Quarter Corner
 (Check one) _____ Bench Mark _____ Other _____

3. Your Description and Observation of Monument Found (Be Specific):

FIND STD BLM CAP

4. Description of Monument, Reference Monument or Accessories Established by You to Perpetuate the Location of this Point:

SET #5 REBAR WEST, SOUTHWEST, SOUTH, AND SOUTHEAST OF THE MONUMENT

5. Sketch showing Relative Location of Monument Accessories and Two Reference Points Stating Whether Found or Set. Show Supporting and/or Contradictory Evidence where Applicable. Include North Arrow.

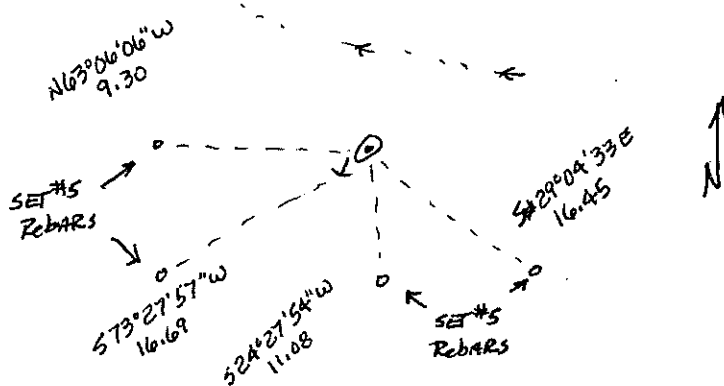

6. Certification:

Firm Name and/or Surveyor: JOHANSEN'S TUTTLE ENG Phone: 381-2523
 Address: 90 S 100 E CASTLE DALE UTAH

This is to certify that I was in responsible charge of the surveying work described in this record and that to the best of my knowledge the information presented herein is true and correct.

7. Location Diagram:
 8. Section: 9
 9. Township: 17S
 10. Range: 8E

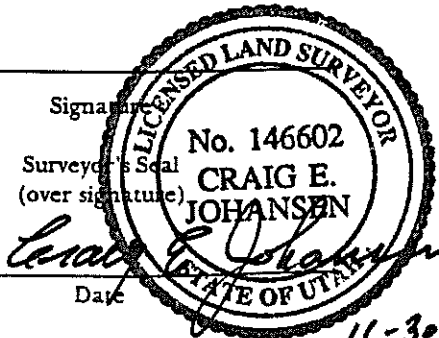
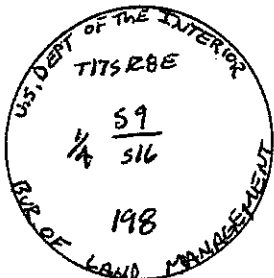
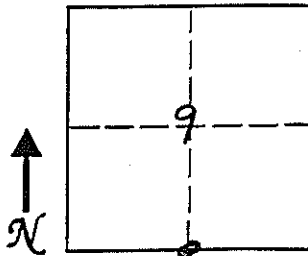

11. Monument Inscription:

12. Diagram Coordinate from Master Index for Townships: _____

Report one monument per form. Type or use permanent black ink. Fill in all items.

UTAH LAND SURVEY MONUMENT RECORD

County EMERY

County Reference No. 1708340520

1. Date of Field Work: 5-30-01

2. Type of Monument:
 (Check one) Section Corner Quarter Corner
 Bench Mark Other 1/16 CORNER

3. Your Description and Observation of Monument Found (Be Specific):

FOUND STD. BLM CAP ON TOP OF HILL

4. Description of Monument, Reference Monument or Accessories Established by You to Perpetuate the Location of this Point:

SET #5 REBAR WEST, SOUTHWEST, SOUTH, AND SOUTHEAST OF THE MONUMENT

5. Sketch showing Relative Location of Monument Accessories and Two Reference Points Stating Whether Found or Set. Show Supporting and/or Contradictory Evidence where Applicable. Include North Arrow.

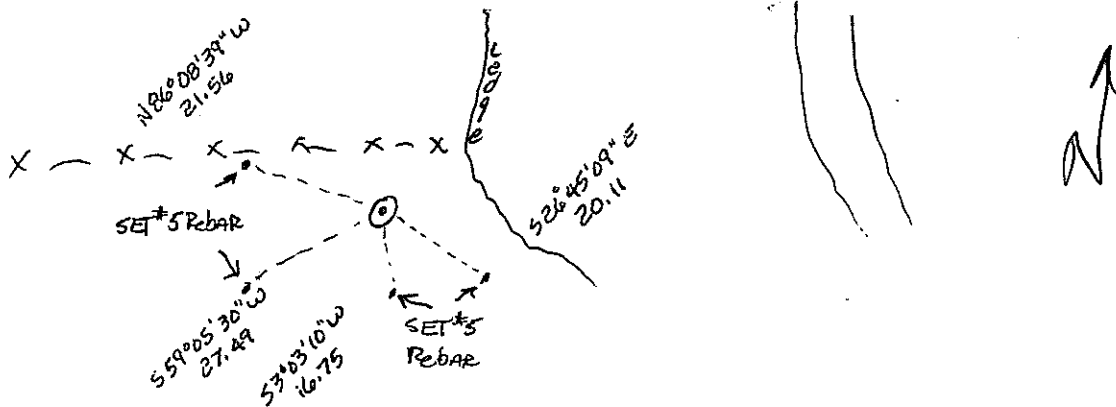

6. Certification:

Firm Name and/or Surveyor: JOHANSEN & TUTTLE ENG Phone: 381-2523
 Address: 90 S 100 E CASTLE DALE UTAH

This is to certify that I was in responsible charge of the surveying work described in this record and that to the best of my knowledge the information presented herein is true and correct.

7. Location Diagram:

8. Section: 9

9. Township: 17S

10. Range: 8E

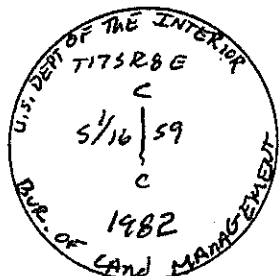
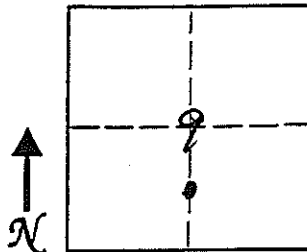

11. Monument Inscription:

12. Diagram Coordinate from Master Index for Townships: _____

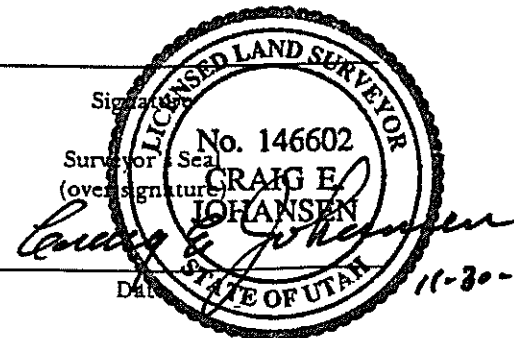

Report one monument per form. Type or use permanent black ink. Fill in all items.

EMERY COUNTY LAND SURVEY MONUMENT RECORD

Date of field work: 5-25-01

County Reference No. 1708340500

Type of Monument: Section Corner
 Bench Mark

Quarter Corner
 Other 1/16 CORNER

Your Description and Observation of Monument Found (Be Specific):

FOUND STD BLM CAP 30'± SOUTH OF A EAST-WEST FENCE

Description of Monument, Reference Monument or Accessories Established by You to Perpetuate the Location of this Point:

SET #5 REBAR NORTH-EAST, NORTH, AND TWO NORTHWEST OF THE MONUMENT

Sketch showing Relative Location of Monument Accessories and Two Reference Points Stating Whether Found or Set. Show Supporting and/or Contradictory Evidence where Applicable. Include North Arrow.

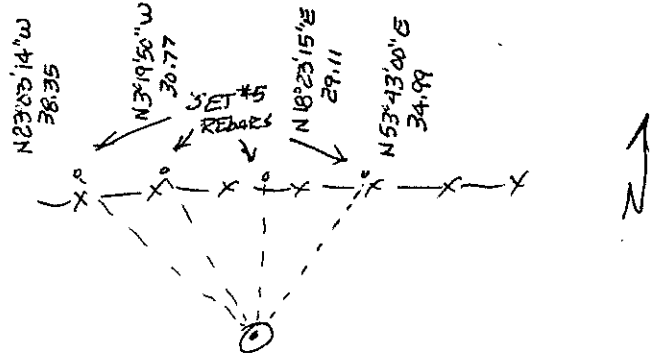
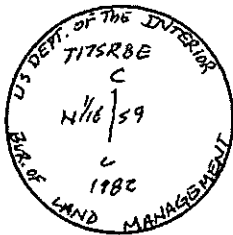

Certification:

Firm name and/or Surveyor: Johansen & Tuttle Eng.

Address: 90 S. 100 E. Castle Dale, Utah 84513 Phone: (435) 381-2523

This is to certify that I was in responsible charge of the surveying work described in this record and that to the best of my knowledge the information presented herein is true and correct.

Location Diagram:

Section: 9
 Township: 17S
 Range: 8E

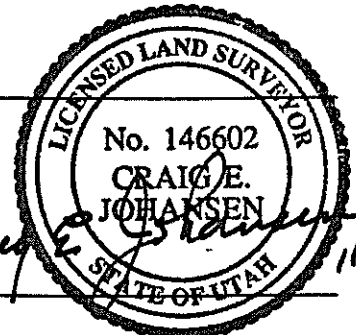
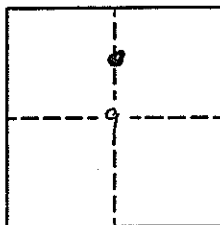

Craig E. Johansen
 Date 11-30-01

EMERY COUNTY LAND SURVEY MONUMENT RECORD

Date of field work: 5-25-01

County Reference No. 1708340⁶⁰⁰~~500~~

Type of Monument: Section Corner ✓ Quarter Corner
 Bench Mark Other

Your Description and Observation of Monument Found (Be Specific):

FOUND STD BLM CAP MARKED FOR THE 1/4 OF S 9
 FOUND STD BLM CAP MARKED FOR THE 1/4 OF S 4 TO THE EAST

Description of Monument, Reference Monument or Accessories Established by You to Perpetuate the Location of this Point:

SET A #5 REBAR NORTH, NORTHWEST, AND SOUTHWEST OF THE MONUMENT

Sketch showing Relative Location of Monument Accessories and Two Reference Points Stating Whether Found or Set. Show Supporting and/or Contradictory Evidence where Applicable. Include North Arrow.

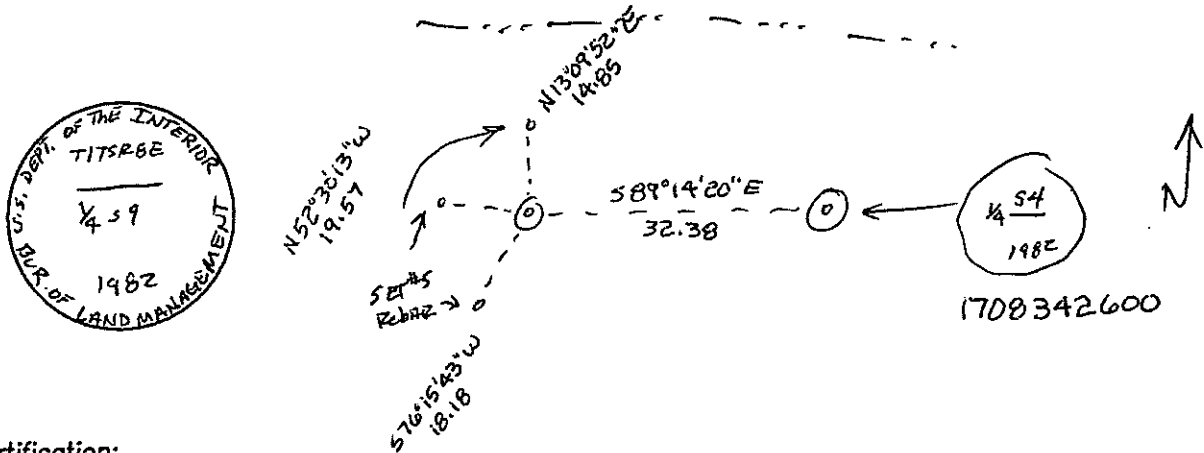

Certification:

Firm name and/or Surveyor: Johansen & Tuttle Eng.
 Address: 90 S. 100 E. Castle Dale, Utah 84513 Phone: (435) 381-2523

This is to certify that I was in responsible charge of the surveying work described in this record and that to the best of my knowledge the information presented herein is true and correct.

Location Diagram:

Section: 9
 Township: 17S
 Range: 8E

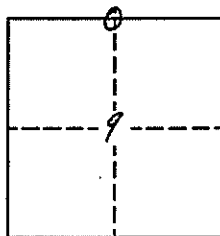

Date: 11-30-01

EMERY COUNTY LAND SURVEY MONUMENT RECORD

Date of field work: 5-25-01

County Reference No. 1708320600

Type of Monument: _____ Section Corner
 _____ Bench Mark

_____ Quarter Corner
 Other 1/16 CORNER

Your Description and Observation of Monument Found (Be Specific):

FOUND STD BLM CAP ON TOP OF RIDGE

Description of Monument, Reference Monument or Accessories Established by You to Perpetuate the Location of this Point:

SET #5 REBAR NORTH, WEST, SOUTHWEST, AND SOUTHEAST OF THE MONUMENT

Sketch showing Relative Location of Monument Accessories and Two Reference Points Stating Whether Found or Set. Show Supporting and/or Contradictory Evidence where Applicable. Include North Arrow.

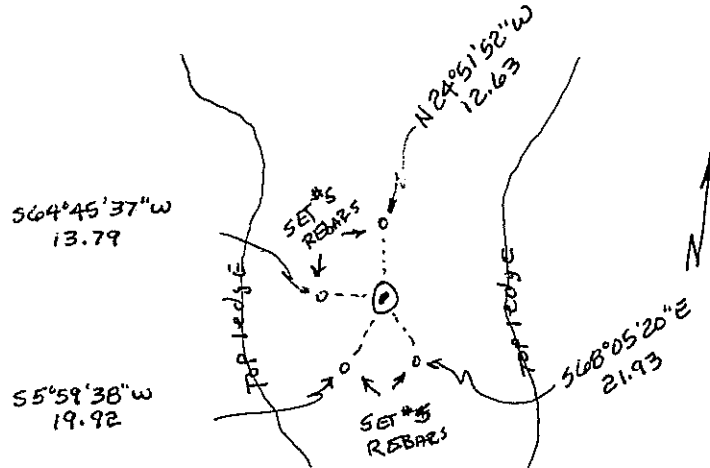
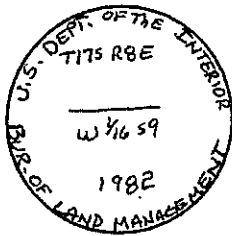

Certification:

Firm name and/or Surveyor: Johansen & Tuttle Eng.

Address: 90 S. 100 E. Castle Dale, Utah 84513 Phone: (435) 381-2523

This is to certify that I was in responsible charge of the surveying work described in this record and that to the best of my knowledge the information presented herein is true and correct.

Location Diagram:

Section: 9
 Township: 17S
 Range: 8E

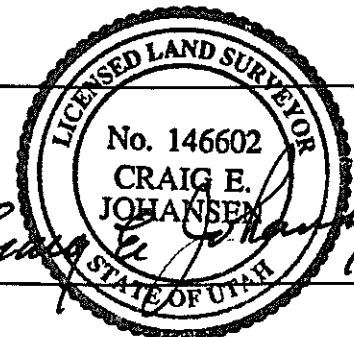
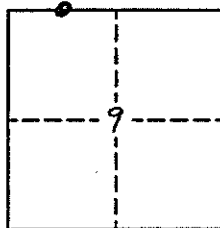

Craig E. Johansen
 Date 11-30-01

UTAH LAND SURVEY MONUMENT RECORD

County EMERY

1708
County Reference No. 987320560

1. Date of Field Work: 1-19-01

2. Type of Monument:
(Check one)

Section Corner Quarter Corner
 Bench Mark Other 1/16 CORNER

3. Your Description and Observation of Monument Found (Be Specific):

FOUND STD BLM CAP IN AMOUND OF STONE

4. Description of Monument, Reference Monument or Accessories Established by You to Perpetuate the Location of this Point:

SET #4 REBAR EAST, SOUTH EAST, SOUTH, & SOUTHWEST OF THE MONUMENT

5. Sketch showing Relative Location of Monument Accessories and Two Reference Points Stating Whether Found or Set. Show Supporting and/or Contradictory Evidence where Applicable. Include North Arrow.

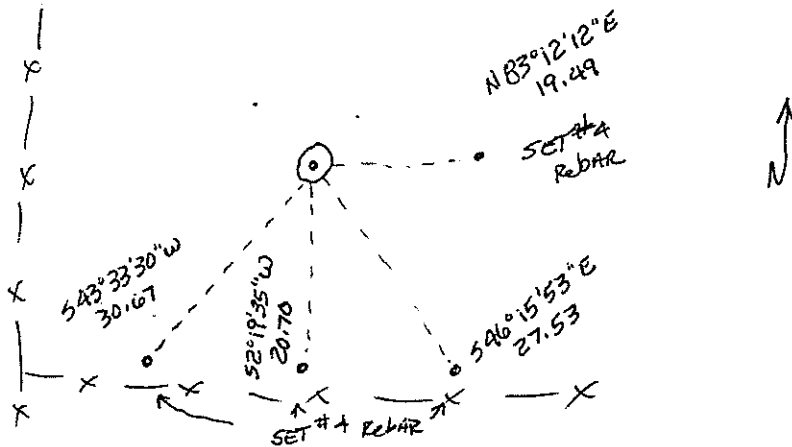

6. Certification:

Firm Name and/or Surveyor: JOHANSEN & TUTTLE ENG Phone: 381-2523
 Address: 905 100E CASTLE DALE UTAH

This is to certify that I was in responsible charge of the surveying work described in this record and that to the best of my knowledge the information presented herein is true and correct.

7. Location Diagram:

8. Section: 9

9. Township: 17S

10. Range: 8E

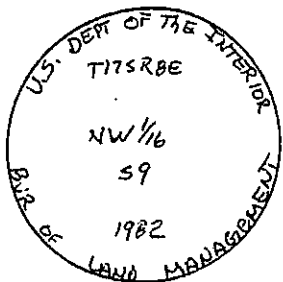
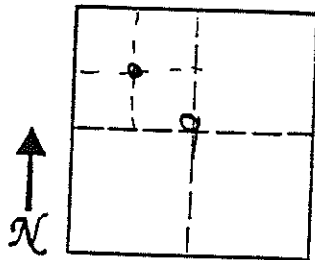

11. Monument Inscription:

12. Diagram Coordinate from Master Index for Townships: _____

Signature: _____
 Surveyor's Seal (over signature)
 Date: 11-30-01

Report one monument per form.
Type or use permanent black ink.
Fill in all items.

EMERY COUNTY LAND SURVEY MONUMENT RECORD

Date of field work: 5-23-01

County Reference No. 1708300580

Type of Monument: Section Corner
 Bench Mark

Quarter Corner
 Other _____

Your Description and Observation of Monument Found (Be Specific):

FOUND STD BLM CAP MARKED FOR THE CORNER OF 8 & 9

FOUND STD BLM CAP MARKED FOR THE CORNER OF 4 & 5 TO THE EAST

Description of Monument, Reference Monument or Accessories Established by You to Perpetuate the Location of this Point:

SET TWO #4 REBARS SOUTH EAST, and one NORTH EAST OF THE MONUMENT

Sketch showing Relative Location of Monument Accessories and Two Reference Points Stating Whether Found or Set. Show Supporting and/or Contradictory Evidence where Applicable. Include North Arrow.

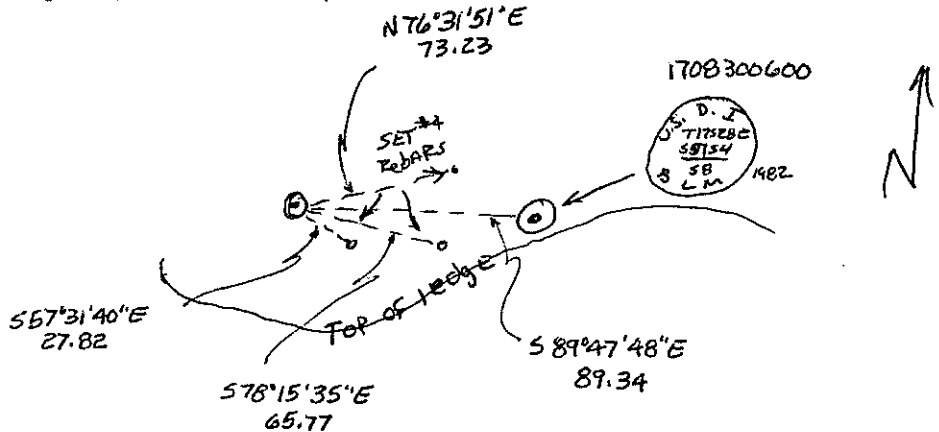
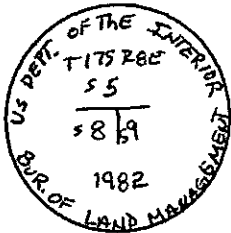

Certification:

Firm name and/or Surveyor: Johansen & Tuttle Eng.

Address: 90 S. 100 E. Castle Dale, Utah 84513 Phone: (435) 381-2523

This is to certify that I was in responsible charge of the surveying work described in this record and that to the best of my knowledge the information presented herein is true and correct.

Location Diagram:

Section: 9
 Township: 17S
 Range: 8E

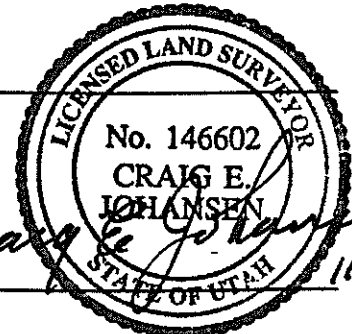
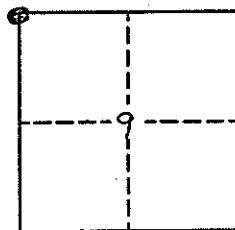

Date