

Emery County 2000 Point ID System

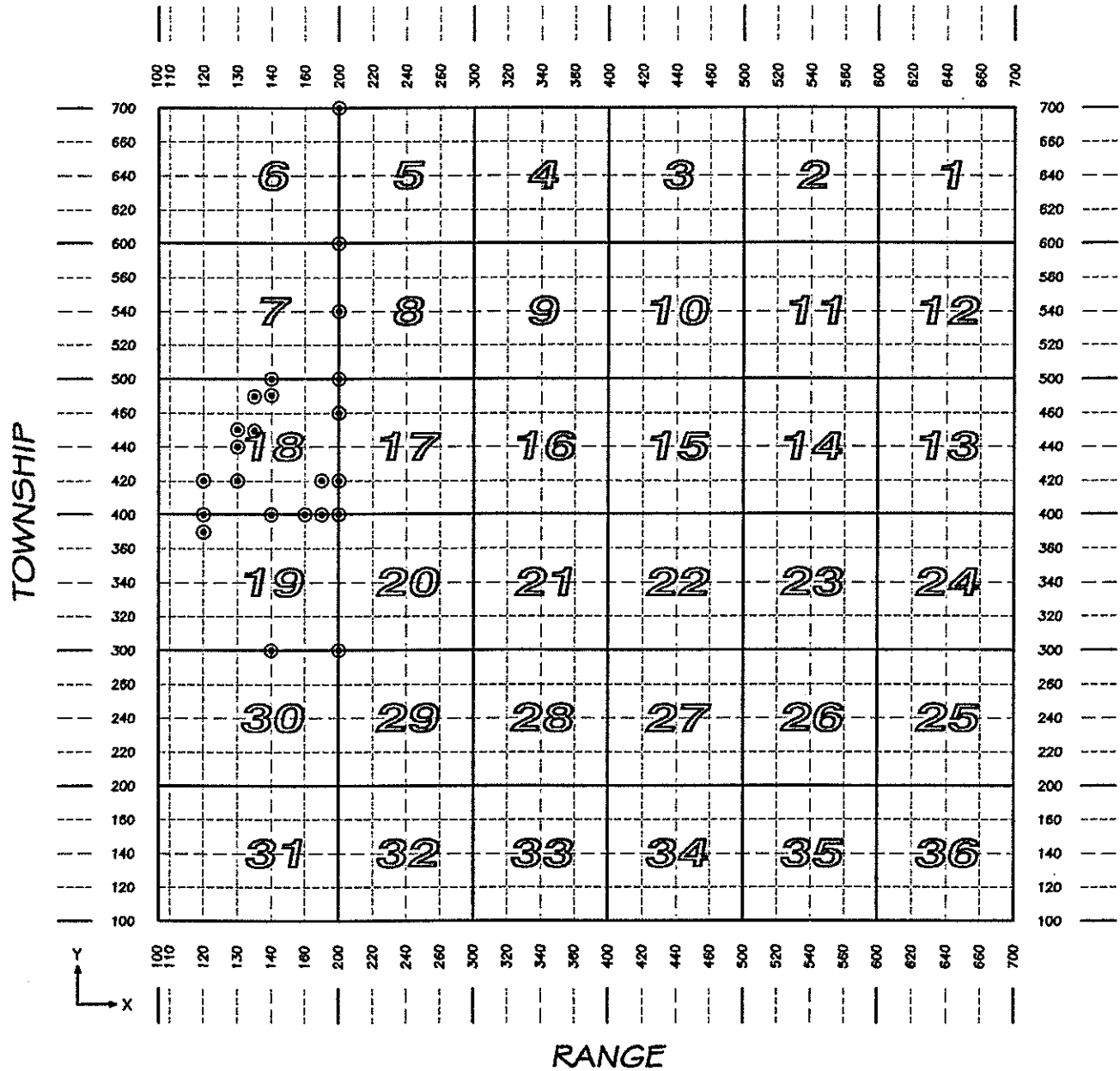

T R X Y
 1706440400 = S 1/4, Sec.15, T 17 S, R 6 E.

1706

T. 17 S. R. 6 E. SLM

© MONUMENT RECORD FILED

November 2001

EMERY COUNTY SECTION CORNERS						1706
NAD 83 (1994) State Plane Coordinate Data, Central Zone						2000 id system
TOWNSHIP 17 SOUTH, RANGE 6 EAST						
INTERNATIONAL FEET						POSITION
SECTION CODE	NORTHING	EASTING	ELEV.	LATITUDE	LONGITUDE	
1706120370	6926976.75	1698557.64	7420.53	N 39° 20' 09.8316	W 111° 17' 40.0256	
1706120400	6927631.98	1698561.55	7466.01	N 39° 20' 16.3079	W 111° 17' 39.9567	
1706120420	6928947.97	1698568.93	7595.43	N 39° 20' 29.3151	W 111° 17' 39.8243	
1706130420	6928953.38	1699878.87	7341.30	N 39° 20' 29.3384	W 111° 17' 23.1499	
1706130440	6930273.67	1699882.98	7402.67	N 39° 20' 42.3882	W 111° 17' 23.0580	
1706130450	6930930.05	1699885.15	7460.17	N 39° 20' 48.8758	W 111° 17' 23.0108	
1706135450	6930935.17	1700538.51	7362.28	N 39° 20' 48.9112	W 111° 17' 14.6933	
1706135470	6932245.92	1700541.03	7443.28	N 39° 21' 01.8667	W 111° 17' 14.6216	
1706140300	6922381.45	1701180.63	7196.04	N 39° 19' 24.3504	W 111° 17' 06.7807	
1706140400	6927635.86	1701186.72	7242.95	N 39° 20' 16.2853	W 111° 17' 06.5425	
1706140470	6932250.47	1701193.26	7395.95	N 39° 21' 01.8962	W 111° 17' 06.3181	
1706140500	6932905.88	1701193.50	7435.47	N 39° 21' 08.3743	W 111° 17' 06.2950	
1706160400	6927653.43	1702505.70	7163.48	N 39° 20' 16.4273	W 111° 16' 49.7535	
1706170400	6927662.26	1703164.59	7188.72	N 39° 20' 16.4985	W 111° 16' 41.3667	
1706170420	6928979.25	1703160.28	7252.03	N 39° 20' 29.5158	W 111° 16' 41.3800	
1706200300	6922405.21	1703828.81	7038.52	N 39° 19' 24.5210	W 111° 16' 33.0800	
1706200400	6927670.58	1703823.25	7367.25	N 39° 20' 16.5645	W 111° 16' 32.9828	
1706200420	6928985.02	1703816.81	7316.25	N 39° 20' 29.5566	W 111° 16' 33.0228	
1706200460	6931612.90	1703806.67	7309.91	N 39° 20' 55.5310	W 111° 16' 33.0680	
1706200500	6932926.59	1703799.50	7290.07	N 39° 21' 08.5158	W 111° 16' 33.1174	
1706200540	6935562.40	1703787.89	7388.54	N 39° 21' 34.5686	W 111° 16' 33.1811	
1706200600	6938198.51	1703776.66	7520.51	N 39° 22' 00.6244	W 111° 16' 33.2400	
1706200700	6942802.75	1703760.22	7686.71	N 39° 22' 46.1334	W 111° 16' 33.3025	

EMERY COUNTY LAND SURVEY MONUMENT RECORD

Date of field work: 6-8-01

County Reference No. 1706200600

Type of Monument: Section Corner
 Bench Mark

Quarter Corner
 Other _____

Your Description and Observation of Monument Found (Be Specific):

Found STD BLM CAP Along A North-South Fence

Description of Monument, Reference Monument or Accessories Established by You to Perpetuate the Location of this Point:

Set #5 Rebar South, East, and 2 North of The Monument

Sketch showing Relative Location of Monument Accessories and Two Reference Points Stating Whether Found or Set. Show Supporting and/or Contradictory Evidence where Applicable. Include North Arrow.

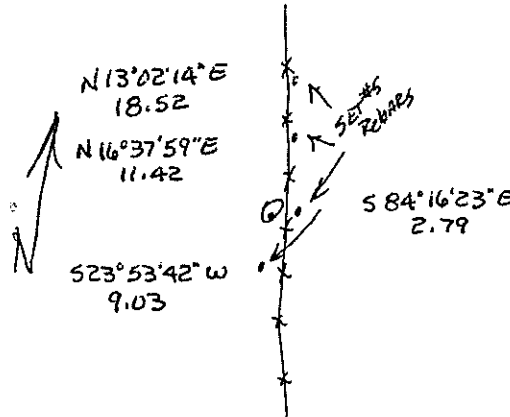

Certification:

Firm name and/or Surveyor: Johansen & Tuttle Eng.

Address: 90 S. 100 E. Castle Dale, Utah 84513 Phone: (435) 381-2523

This is to certify that I was in responsible charge of the surveying work described in this record and that to the best of my knowledge the information presented herein is true and correct.

Location Diagram:

Section: 5
 Township: 17S
 Range: 6E

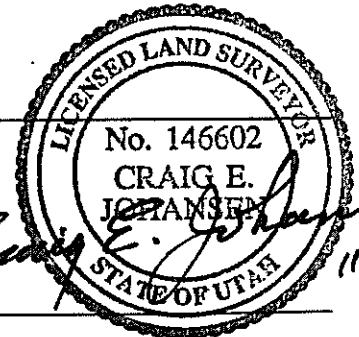
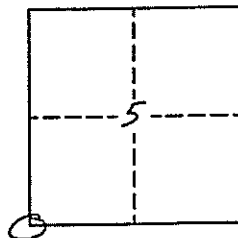

Date

EMERY COUNTY LAND SURVEY MONUMENT RECORD

Date of field work: 6-8-01

County Reference No. 1706200700 CC

Type of Monument: Section Corner
 Bench Mark

Quarter Corner
 Other Closing CORNER

Your Description and Observation of Monument Found (Be Specific):

FOUND STD BLM CAP WITH A COLLAR OF ROCK

Description of Monument, Reference Monument or Accessories Established by You to Perpetuate the Location of this Point:

SET #5 REBAR NORTH, WEST, SOUTHWEST, AND SOUTHEAST OF THE MONUMENT

Sketch showing Relative Location of Monument Accessories and Two Reference Points Stating Whether Found or Set. Show Supporting and/or Contradictory Evidence where Applicable. Include North Arrow.

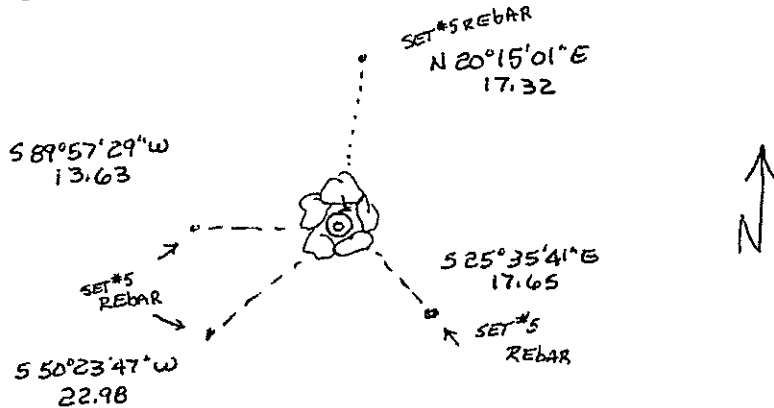
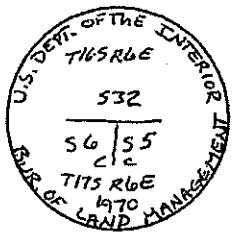

Certification:

Firm name and/or Surveyor: Johansen & Tuttle Eng.

Address: 90 S. 100 E. Castle Dale, Utah 84513 Phone: (435) 381-2523

This is to certify that I was in responsible charge of the surveying work described in this record and that to the best of my knowledge the information presented herein is true and correct.

Location Diagram:

Section: 5

Township: 17S

Range: 6E

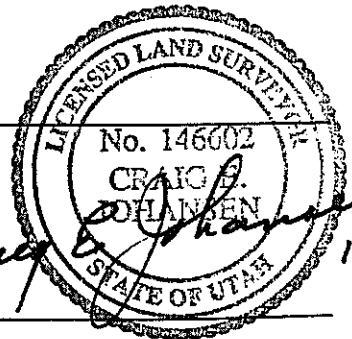
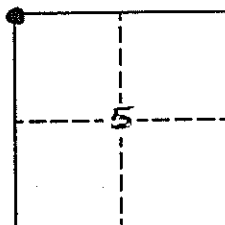

Date

EMERY COUNTY LAND SURVEY MONUMENT RECORD

Date of field work: 6-7-01

County Reference No. 1706200500

Type of Monument: Section Corner _____ Quarter Corner
 _____ Bench Mark _____ Other _____

Your Description and Observation of Monument Found (Be Specific):

FOUND STD BLM CAP ON WEST SIDE OF RIVER

Description of Monument, Reference Monument or Accessories Established by You to Perpetuate the Location of this Point:

SET A #5 REBAR EAST AND SOUTHEAST OF THE MONUMENT

Sketch showing Relative Location of Monument Accessories and Two Reference Points Stating Whether Found or Set. Show Supporting and/or Contradictory Evidence where Applicable. Include North Arrow.



* NOTE: SEE BACK OF SHEET FOR LOCATION

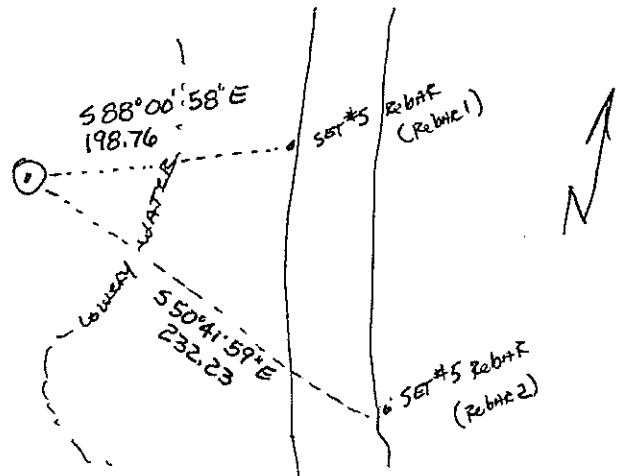

Certification:

Firm name and/or Surveyor: Johansen & Tuttle Eng.
 Address: 90 S. 100 E. Castle Dale, Utah 84513 Phone: (435) 381-2523

This is to certify that I was in responsible charge of the surveying work described in this record and that to the best of my knowledge the information presented herein is true and correct.

Location Diagram:
 Section: _____
 Township: _____
 Range: _____

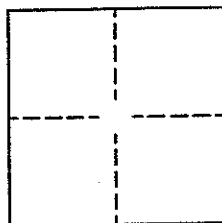

Craig E. Johansen
 Date 11-30-01

EMERY COUNTY LAND SURVEY MONUMENT RECORD

Date of field work: 6-11-01

County Reference No. 1706140500

Type of Monument: Section Corner ✓ Quarter Corner
 Bench Mark Other

Your Description and Observation of Monument Found (Be Specific):

Found #A REBAR IN A ROCK MOUND

Description of Monument, Reference Monument or Accessories Established by You to Perpetuate the Location of this Point:

NONE

Sketch showing Relative Location of Monument Accessories and Two Reference Points Stating Whether Found or Set. Show Supporting and/or Contradictory Evidence where Applicable. Include North Arrow.

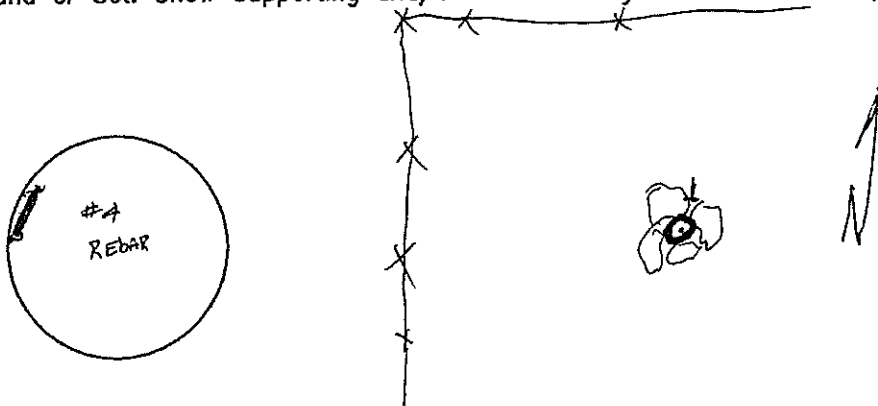

Certification:

Firm name and/or Surveyor: Johansen & Tuttle Eng.

Address: 90 S. 100 E. Castle Dale, Utah 84513 Phone: (435) 381-2523

This is to certify that I was in responsible charge of the surveying work described in this record and that to the best of my knowledge the information presented herein is true and correct.

Location Diagram:

Section: 7

Township: 17S

Range: ~~6E~~ 6E

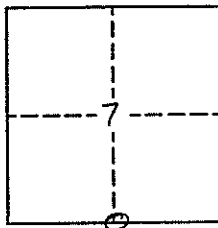

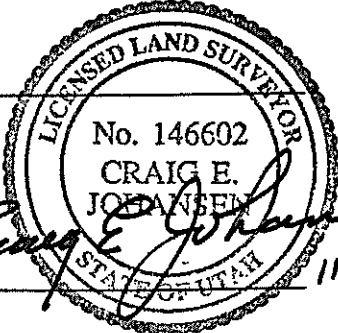
Craig E. Johansen
 Date 11-30-01

EMERY COUNTY LAND SURVEY MONUMENT RECORD

Date of field work: 6-8-01

County Reference No. 1706200540

Type of Monument: Section Corner Quarter Corner
 Bench Mark Other

Your Description and Observation of Monument Found (Be Specific):

FOUND STD FOREST SERVICE CAP

Description of Monument, Reference Monument or Accessories Established by You to Perpetuate the Location of this Point:

SET #5 REBAR NORTH, EAST, SOUTHEAST, AND SOUTHWEST OF THE MONUMENT

Sketch showing Relative Location of Monument Accessories and Two Reference Points Stating Whether Found or Set. Show Supporting and/or Contradictory Evidence where Applicable. Include North Arrow.

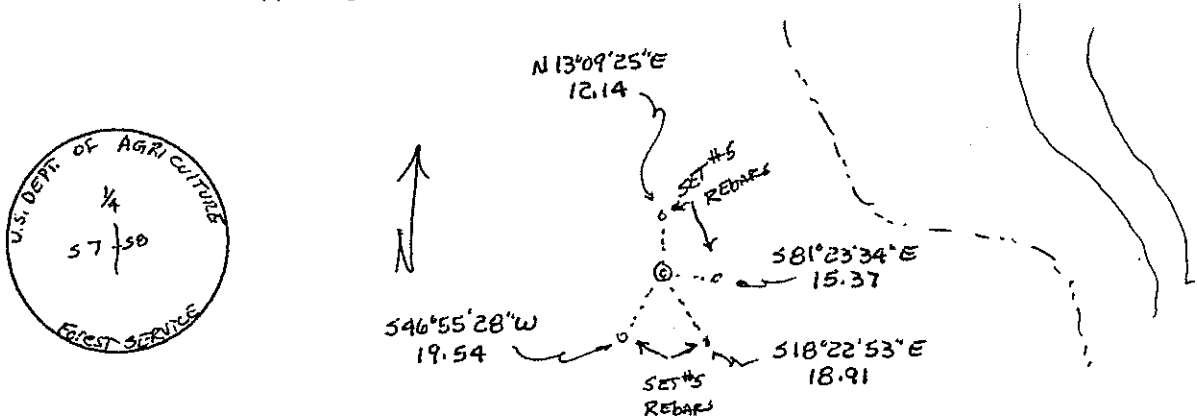

Certification:

Firm name and/or Surveyor: Johansen & Tuttle Eng.
 Address: 90 S. 100 E. Castle Dale, Utah 84513 Phone: (435) 381-2523

This is to certify that I was in responsible charge of the surveying work described in this record and that to the best of my knowledge the information presented herein is true and correct.

Location Diagram:

Section: 8
 Township: 17S
 Range: 6E

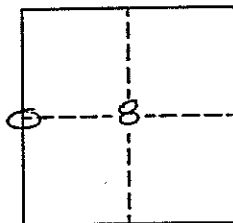

 Date 11-30-01

UTAH LAND SURVEY MONUMENT RECORD

County EMERY

County Reference No. 0717100540

1. Date of Field Work: 11/12/09

2. Type of Monument: (Check one)
 Section Corner Quarter Corner
 Bench Mark Other

3. Your Description and Observation of Monument Found (Be Specific):
1968 BRASS CAP IN MOUND OF STONE

4. Description of Monument, Reference Monument or Accessories Established by You to Perpetuate the Location of this Point: FLAGGED

5. Sketch showing Relative Location of Monument Accessories and Two Reference Points Stating Whether Found or Set. Show Supporting and/or Contradictory Evidence where Applicable. Include North Arrow.

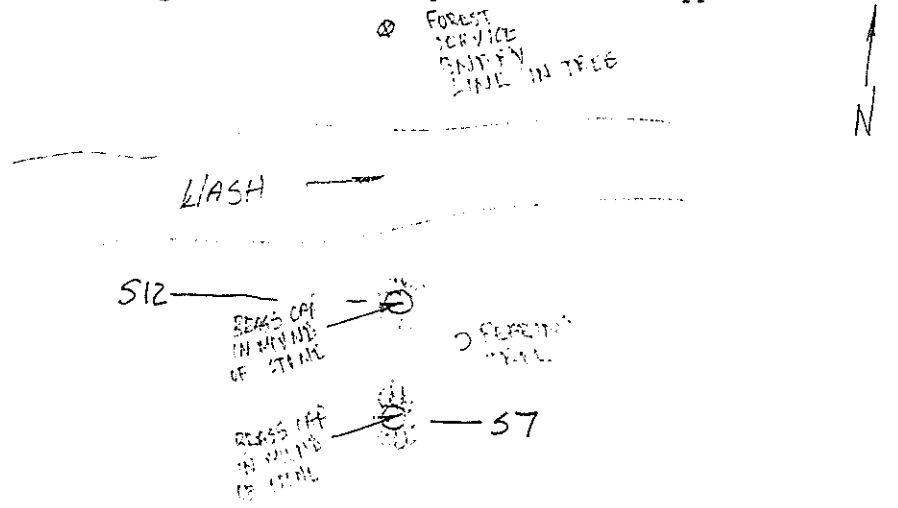

6. Certification:

Firm Name and/or Surveyor: _____ Phone: _____
Address: _____

This is to certify that I was in responsible charge of the surveying work described in this record and that to the best of my knowledge the information presented herein is true and correct.

7. Location Diagram:
8. Section: 12
9. Township: 17S
10. Range: 7E

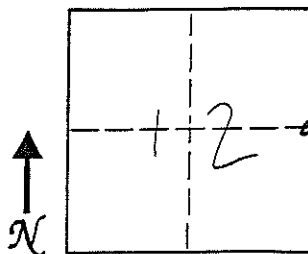

John M. Swasey
No. 163634
Signature M. SWASEY
Surveyor's Seal
(over signature)
STATE OF UTAH
20/Dec/09
Date

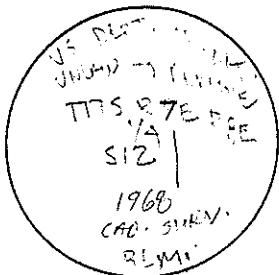

11. Monument Inscription:

12. Diagram Coordinate from Master Index for Townships: _____

Report one monument per form. Type or use permanent black ink. Fill in all items.

EMERY COUNTY LAND SURVEY MONUMENT RECORD

Date of field work: 6-7-01

County Reference No. 1706200460

Type of Monument: Section Corner
 Bench Mark

Quarter Corner
 Other 1/16 CORNER

Your Description and Observation of Monument Found (Be Specific):

FOUND FOREST SERVICE DISC SET IN SANDSTONE ledge

Description of Monument, Reference Monument or Accessories Established by You to Perpetuate the Location of this Point:

SET #5 REBAR NORTH, EAST, SOUTHEAST, AND SOUTH OF THE MONUMENT

Sketch showing Relative Location of Monument Accessories and Two Reference Points Stating Whether Found or Set. Show Supporting and/or Contradictory Evidence where Applicable. Include North Arrow.

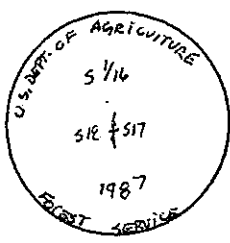
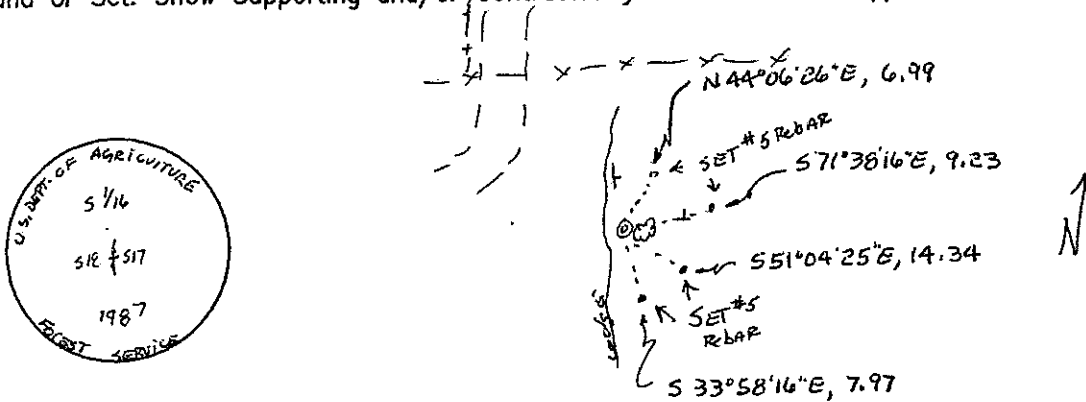

Certification:

Firm name and/or Surveyor: Johansen & Tuttle Eng.

Address: 90 S. 100 E. Castle Dale, Utah 84513 Phone: (435) 381-2523

This is to certify that I was in responsible charge of the surveying work described in this record and that to the best of my knowledge the information presented herein is true and correct.

Location Diagram:

Section: 17
 Township: 17S
 Range: 6E

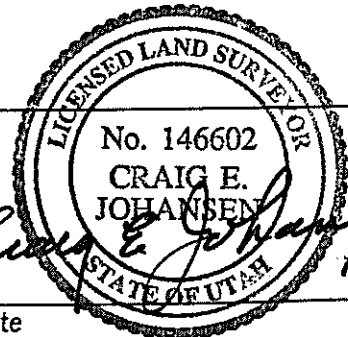
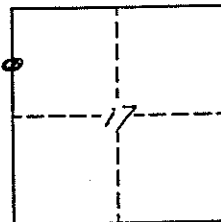

Date

11-30-01

EMERY COUNTY LAND SURVEY MONUMENT RECORD

Date of field work: 6-7-01

County Reference No. 1706200420

Type of Monument: Section Corner Quarter Corner
 Bench Mark ✓ Other 1/16 CORNER

Your Description and Observation of Monument Found (Be Specific):

Found STD ~~BE~~ FOREST SERVICE CAP, WITH A ROCK COLLAR, 15'± SOUTH OF A EAST-WEST FENCE

Description of Monument, Reference Monument or Accessories Established by You to Perpetuate the Location of this Point:

SET A#5 REBAR SOUTH, WEST, NORTHWEST, AND NORTHEAST OF THE MONUMENT

Sketch showing Relative Location of Monument Accessories and Two Reference Points Stating Whether Found or Set. Show Supporting and/or Contradictory Evidence where Applicable. Include North Arrow.

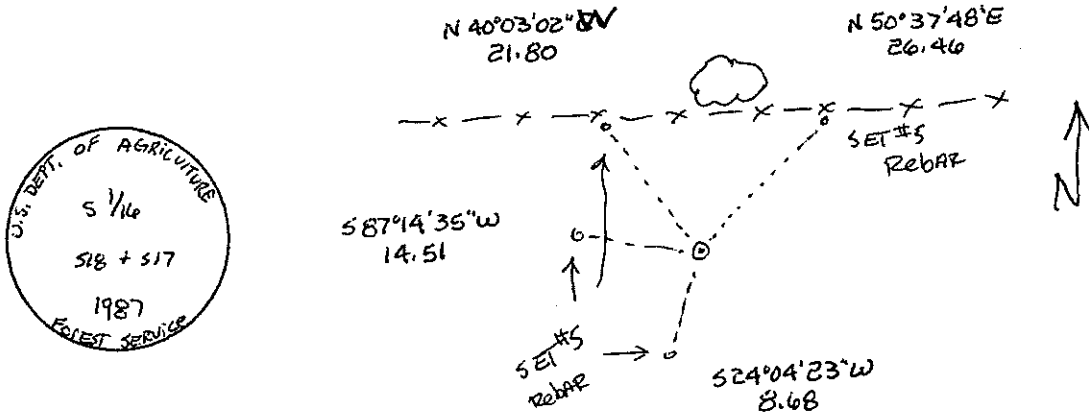

Certification:

Firm name and/or Surveyor: Johansen & Tuttle Eng.
 Address: 90 S. 100 E. Castle Dale, Utah 84513 Phone: (435) 381-2523

This is to certify that I was in responsible charge of the surveying work described in this record and that to the best of my knowledge the information presented herein is true and correct.

Location Diagram:

Section: 17
 Township: 17S
 Range: 80E

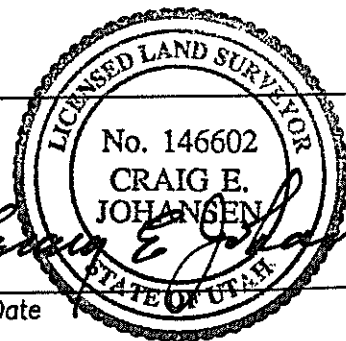
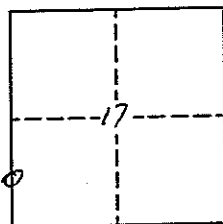

Date

11-30-01

EMERY COUNTY LAND SURVEY MONUMENT RECORD

Date of field work: 6-7-01

County Reference No. 1706200400

Type of Monument: Section Corner Quarter Corner
 Bench Mark Other _____

Your Description and Observation of Monument Found (Be Specific):

FOUND STD. BLM CAP on hillside
 FOUND 18" dia PINION BT NORTHEAST of the MONUMENT
 FOUND 18" dia cedar BT SOUTHEAST of the MONUMENT

Description of Monument, Reference Monument or Accessories Established by You to Perpetuate the Location of this Point:

SET #5 REBAR SOUTHEAST, EAST, NORTHEAST, AND NORTH of the MONUMENT

Sketch showing Relative Location of Monument Accessories and Two Reference Points Stating Whether Found or Set. Show Supporting and/or Contradictory Evidence where Applicable. Include North Arrow.

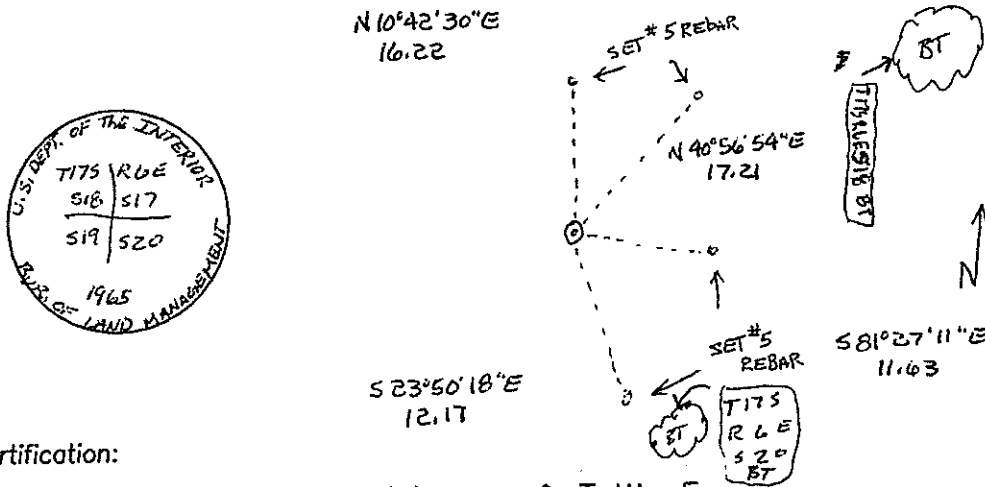

Certification:

Firm name and/or Surveyor: Johansen & Tuttle Eng.
 Address: 90 S. 100 E. Castle Dale, Utah 84513 Phone: (435) 381-2523

This is to certify that I was in responsible charge of the surveying work described in this record and that to the best of my knowledge the information presented herein is true and correct.

Location Diagram:
 Section: 17
 Township: 17S
 Range: 6E

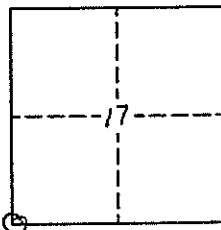

Craig E. Johansen
 Date 11-30-01

EMERY COUNTY LAND SURVEY MONUMENT RECORD

Date of field work: 6-11-01

County Reference No. 1706136470

Type of Monument: Section Corner Quarter Corner
 Bench Mark Other 1/4 CORNER

Your Description and Observation of Monument Found (Be Specific):

FOUND STD. ~~STONE~~
 FOREST SERVICE CAP

Description of Monument, Reference Monument or Accessories Established by You to Perpetuate the Location of this Point:

SET #5 REBAR North, Northwest, West, AND Southwest of The MONUMENT

Sketch showing Relative Location of Monument Accessories and Two Reference Points Stating Whether Found or Set. Show Supporting and/or Contradictory Evidence where Applicable. Include North Arrow.

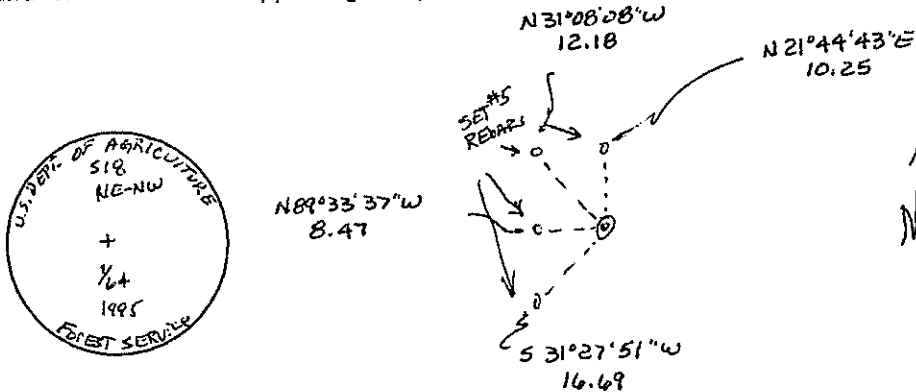

Certification:

Firm name and/or Surveyor: Johansen & Tuttle Eng.
 Address: 90 S. 100 E. Castle Dale, Utah 84513 Phone: (435) 381-2523

This is to certify that I was in responsible charge of the surveying work described in this record and that to the best of my knowledge the information presented herein is true and correct.

Location Diagram:

Section: 18
 Township: 17S
 Range: 6E

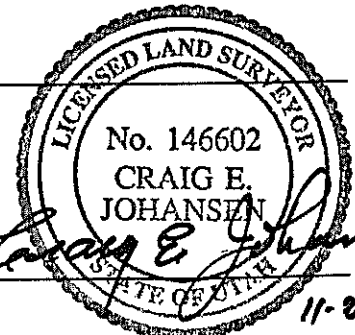
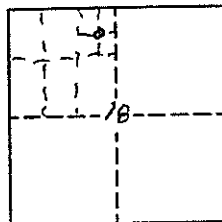

Date

11-20-01

EMERY COUNTY LAND SURVEY MONUMENT RECORD

Date of field work: 6-11-01

County Reference No. 1706135450

Type of Monument: Section Corner Quarter Corner
 Bench Mark Other 1/64 CORNER

Your Description and Observation of Monument Found (Be Specific):

Found STD FOREST SERVICE CAP

Description of Monument, Reference Monument or Accessories Established by You to Perpetuate the Location of this Point:

SET #5 REBAR NORTH, NORTHWEST, WEST, AND SOUTHWEST OF THE MONUMENT

Sketch showing Relative Location of Monument Accessories and Two Reference Points Stating Whether Found or Set. Show Supporting and/or Contradictory Evidence where Applicable. Include North Arrow.

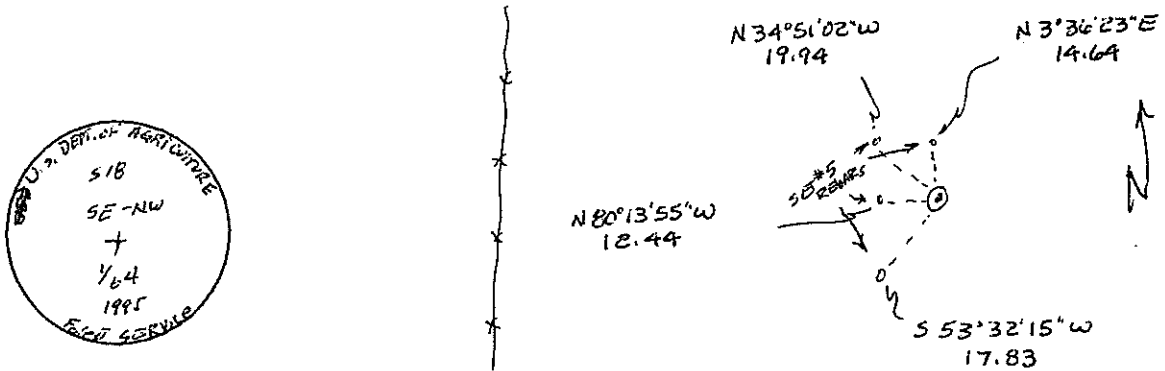

Certification:

Firm name and/or Surveyor: Johansen & Tuttle Eng.
 Address: 90 S. 100 E. Castle Dale, Utah 84513 Phone: (435) 381-2523

This is to certify that I was in responsible charge of the surveying work described in this record and that to the best of my knowledge the information presented herein is true and correct.

Location Diagram:

Section: 18
 Township: 17S
 Range: 6E

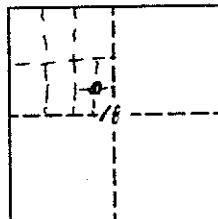

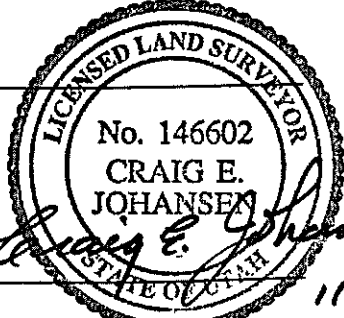
Craig E. Johansen
 Date 11-30-01

EMERY COUNTY LAND SURVEY MONUMENT RECORD

Date of field work: 6-11-01

County Reference No. 1706130450

Type of Monument: Section Corner Quarter Corner
 Bench Mark Other 1/64 CORNER

Your Description and Observation of Monument Found (Be Specific):

Found STD ~~cap~~ CAP
 Forest Serv.

Description of Monument, Reference Monument or Accessories Established by You to Perpetuate the Location of this Point:

SET A'S REBAR NORTH, NORTHWEST, WEST, AND SOUTHWEST OF THE MONUMENT

Sketch showing Relative Location of Monument Accessories and Two Reference Points Stating Whether Found or Set. Show Supporting and/or Contradictory Evidence where Applicable. Include North Arrow.

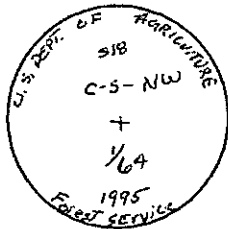
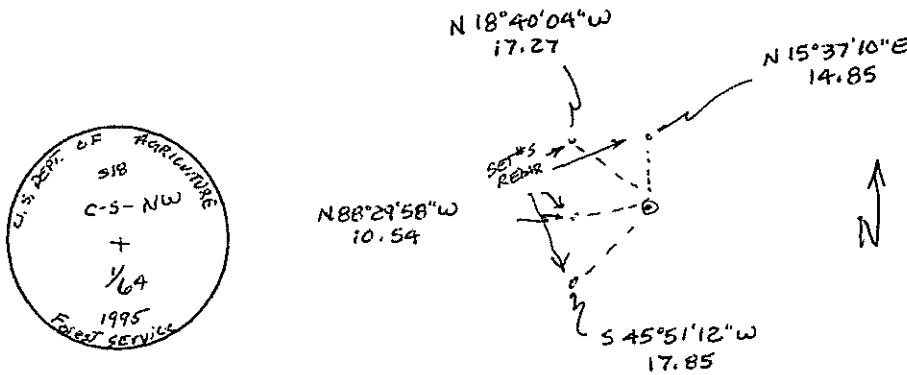

Certification:

Firm name and/or Surveyor: Johansen & Tuttle Eng.
 Address: 90 S. 100 E. Castle Dale, Utah 84513 Phone: (435) 381-2523

This is to certify that I was in responsible charge of the surveying work described in this record and that to the best of my knowledge the information presented herein is true and correct.

Location Diagram:

Section: 16
 Township: 17S
 Range: 6E

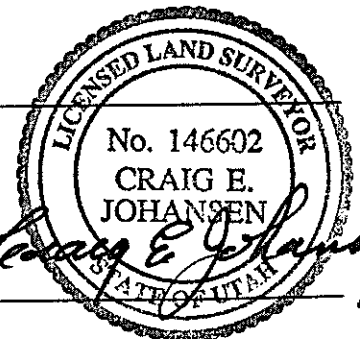
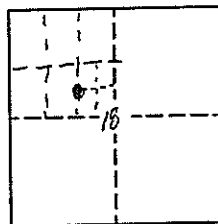

Date

11-30-01

EMERY COUNTY LAND SURVEY MONUMENT RECORD

Date of field work: 6-11-01

County Reference No. 1706 130 440

Type of Monument: Section Corner Quarter Corner
 Bench Mark Other 1/16 CORNER

Your Description and Observation of Monument Found (Be Specific):

FOUND STD FOREST SERVICE CAP

Description of Monument, Reference Monument or Accessories Established by You to Perpetuate the Location of this Point:

SET # 5 REBAR NORTH, NORTHWEST, WEST, AND SOUTHWEST OF THE MONUMENT

Sketch showing Relative Location of Monument Accessories and Two Reference Points Stating Whether Found or Set. Show Supporting and/or Contradictory Evidence where Applicable. Include North Arrow.

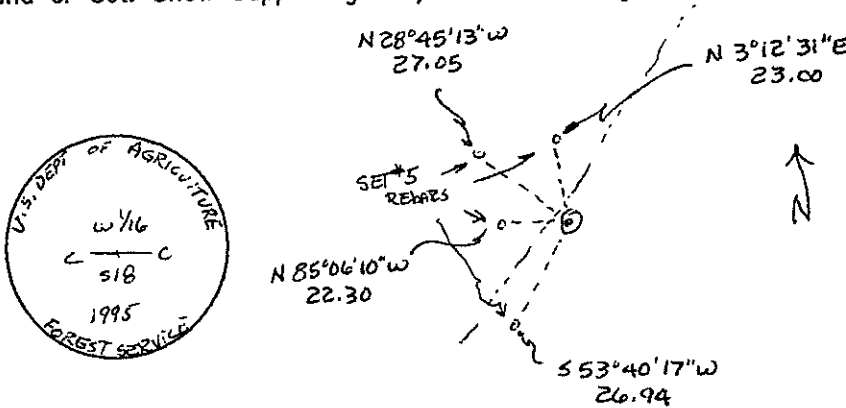

Certification:

Firm name and/or Surveyor: Johansen & Tuttle Eng.
 Address: 90 S. 100 E. Castle Dale, Utah 84513 Phone: (435) 381-2523

This is to certify that I was in responsible charge of the surveying work described in this record and that to the best of my knowledge the information presented herein is true and correct.

Location Diagram:

Section: 18
 Township: 17S
 Range: 6E

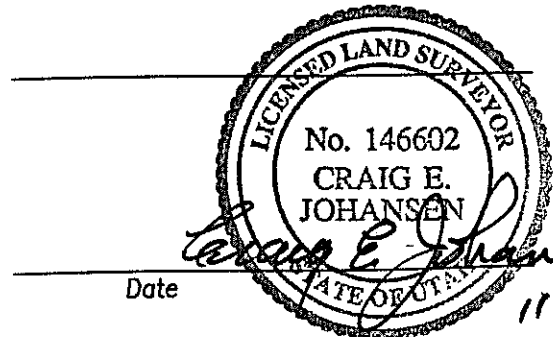
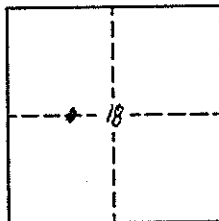

Date

11-30-01

EMERY COUNTY LAND SURVEY MONUMENT RECORD

Date of field work: 1-11-01

County Reference No. 1706130420

Type of Monument: Section Corner Quarter Corner
 Bench Mark Other 1/16 CORNER

Your Description and Observation of Monument Found (Be Specific):
 FOUND STD FOREST SERVICE CAP

Description of Monument, Reference Monument or Accessories Established by You to Perpetuate the Location of this Point:

SET #5 REBAR NORTH, NORTHWEST, WEST, AND SOUTHWEST OF THE MONUMENT

Sketch showing Relative Location of Monument Accessories and Two Reference Points Stating Whether Found or Set. Show Supporting and/or Contradictory Evidence where Applicable. Include North Arrow.

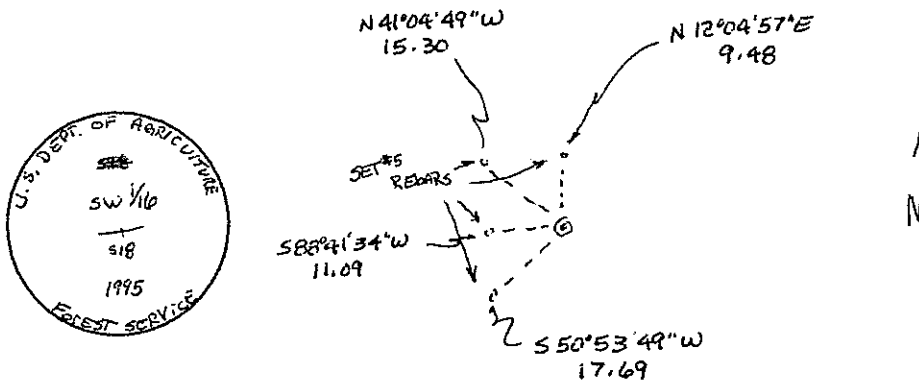

Certification:

Firm name and/or Surveyor: Johansen & Tuttle Eng.
 Address: 90 S. 100 E. Castle Dale, Utah 84513 Phone: (435) 381-2523

This is to certify that I was in responsible charge of the surveying work described in this record and that to the best of my knowledge the information presented herein is true and correct.

Location Diagram:

Section: 18
 Township: 17S
 Range: 6E

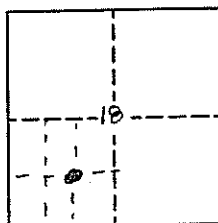

* SECTION 18 IS LOTS

Craig E. Johansen
 Date 11-30-01

EMERY COUNTY LAND SURVEY MONUMENT RECORD

Date of field work: 10-11-01

County Reference No. 1706120420

Type of Monument: _____ Section Corner _____ Quarter Corner
 _____ Bench Mark _____ Other ✓ 1/16 CORNER

Your Description and Observation of Monument Found (Be Specific):

Found STD Forest service CAP

Description of Monument, Reference Monument or Accessories Established by You to Perpetuate the Location of this Point:

*SETA *S REBAR NORTH, NORTHEAST, EAST, AND SOUTHEAST OF THE MONUMENT*

Sketch showing Relative Location of Monument Accessories and Two Reference Points Stating Whether Found or Set. Show Supporting and/or Contradictory Evidence where Applicable. Include North Arrow.

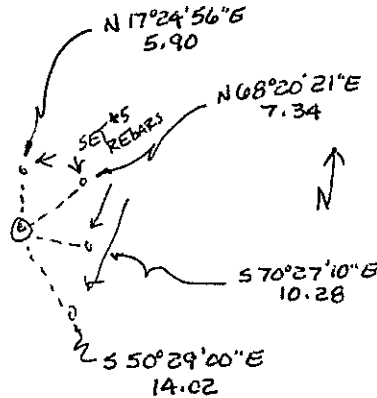

Certification:

Firm name and/or Surveyor: Johansen & Tuttle Eng.
 Address: 90 S. 100 E. Castle Dale, Utah 84513 Phone: (435) 381-2523

This is to certify that I was in responsible charge of the surveying work described in this record and that to the best of my knowledge the information presented herein is true and correct.

Location Diagram:

Section: 18
 Township: 17S
 Range: 6E

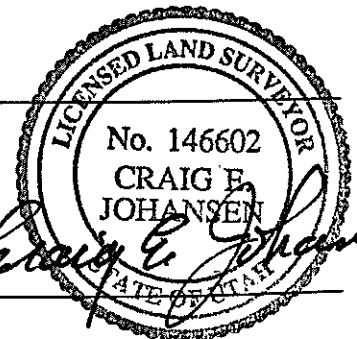
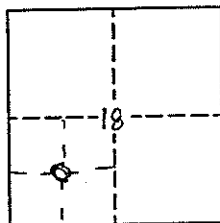

Date

11-30-01

EMERY COUNTY LAND SURVEY MONUMENT RECORD

Date of field work: 6-1-01

County Reference No. 1706120400

Type of Monument: Section Corner Quarter Corner
 Bench Mark X Other 1/16 CORNER

Your Description and Observation of Monument Found (Be Specific):

FOUND STANDARD FOREST SERVICE CAP

Description of Monument, Reference Monument or Accessories Established by You to Perpetuate the Location of this Point:

SET A PK NAIL N - S - SW - W IN LARGE BOULDERS

Sketch showing Relative Location of Monument Accessories and Two Reference Points Stating Whether Found or Set. Show Supporting and/or Contradictory Evidence where Applicable. Include North Arrow.

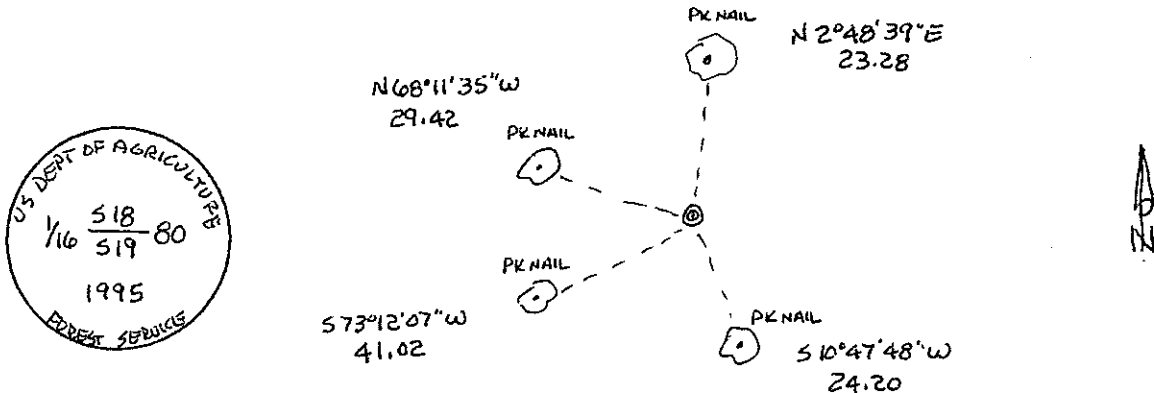

Certification:

Firm name and/or Surveyor: Johansen & Tuttle Eng.
 Address: 90 S. 100 E. Castle Dale, Utah 84513 Phone: (435) 381-2523

This is to certify that I was in responsible charge of the surveying work described in this record and that to the best of my knowledge the information presented herein is true and correct.

Location Diagram:

Section: 18
 Township: 17S
 Range: 6E

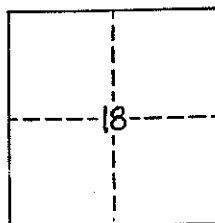

Craig E. Johansen
 Date 11-30-01

EMERY COUNTY LAND SURVEY MONUMENT RECORD

Date of field work: 6-7-01

County Reference No. 1706120370

Type of Monument: Section Corner Quarter Corner
 Bench Mark ✓ Other 1/4 CORNER

Your Description and Observation of Monument Found (Be Specific):

FOUND STA FOREST SERVICE CAP IN A ROCK COLLAR

Description of Monument, Reference Monument or Accessories Established by You to Perpetuate the Location of this Point:

SETA #5 REBAR NORTH, NORTHWEST, WEST, AND SOUTHWEST OF THE MONUMENT

Sketch showing Relative Location of Monument Accessories and Two Reference Points Stating Whether Found or Set. Show Supporting and/or Contradictory Evidence where Applicable. Include North Arrow.

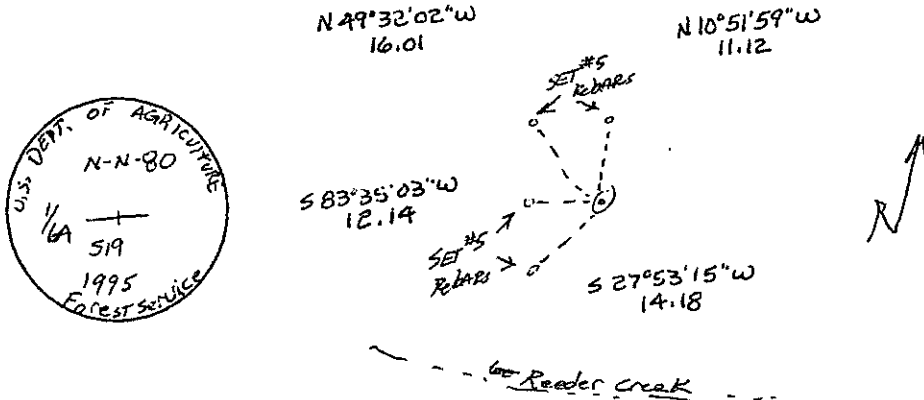

Certification:

Firm name and/or Surveyor: Johansen & Tuttle Eng.
 Address: 90 S. 100 E. Castle Dale, Utah 84513 Phone: (435) 381-2523

This is to certify that I was in responsible charge of the surveying work described in this record and that to the best of my knowledge the information presented herein is true and correct.

Location Diagram:
 Section: 19
 Township: 17S
 Range: 6E

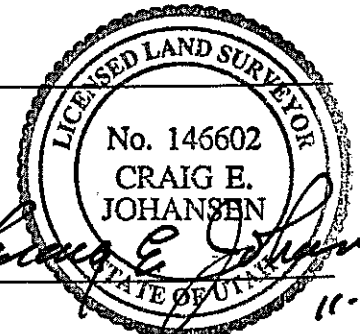
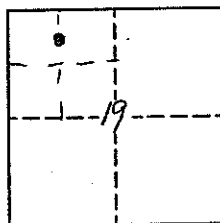

Date

11-30-01

EMERY COUNTY LAND SURVEY MONUMENT RECORD

Date of field work: 6-11-01 County Reference No. 1706140470

Type of Monument: Section Corner Quarter Corner
 Bench Mark Other 1/64 CORNER

Your Description and Observation of Monument Found (Be Specific):
FOUND STD FOREST SERVICE CAP

Description of Monument, Reference Monument or Accessories Established by You to Perpetuate the Location of this Point:

SET #5 REBAR NORTH, NORTHWEST, WEST, AND SOUTHWEST OF THE MONUMENT

Sketch showing Relative Location of Monument Accessories and Two Reference Points Stating Whether Found or Set. Show Supporting and/or Contradictory Evidence where Applicable. Include North Arrow.

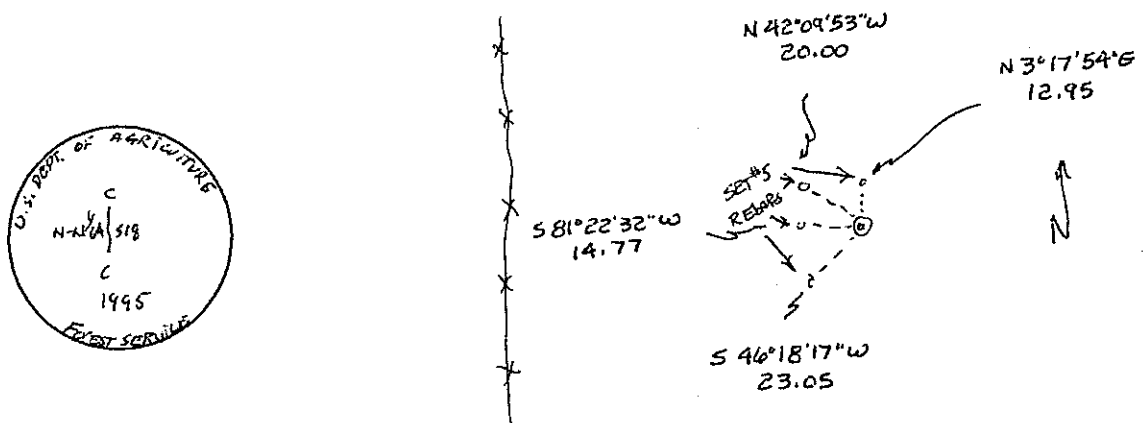

Certification:

Firm name and/or Surveyor: Johansen & Tuttle Eng.
 Address: 90 S. 100 E. Castle Dale, Utah 84513 Phone: (435) 381-2523

This is to certify that I was in responsible charge of the surveying work described in this record and that to the best of my knowledge the information presented herein is true and correct.

Location Diagram:
 Section: 18
 Township: 17S
 Range: 6E

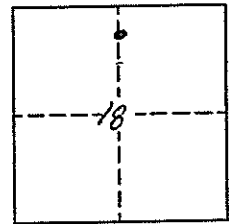

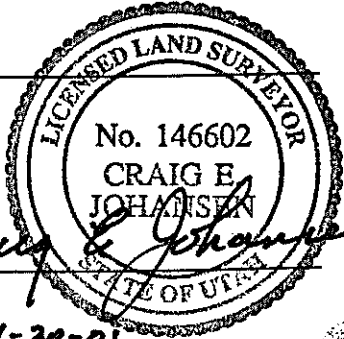
Craig E. Johansen
 Date 11-30-01

EMERY COUNTY LAND SURVEY MONUMENT RECORD

Date of field work: 6-7-01

County Reference No. 1706160400

Type of Monument: Section Corner Quarter Corner
 Bench Mark ✓ Other 1/16 CORNER

Your Description and Observation of Monument Found (Be Specific):

FOUND STD FOREST SERVICE CAP

Description of Monument, Reference Monument or Accessories Established by You to Perpetuate the Location of this Point:

NONE FEASIBLE

Sketch showing Relative Location of Monument Accessories and Two Reference Points Stating Whether Found or Set. Show Supporting and/or Contradictory Evidence where Applicable. Include North Arrow.

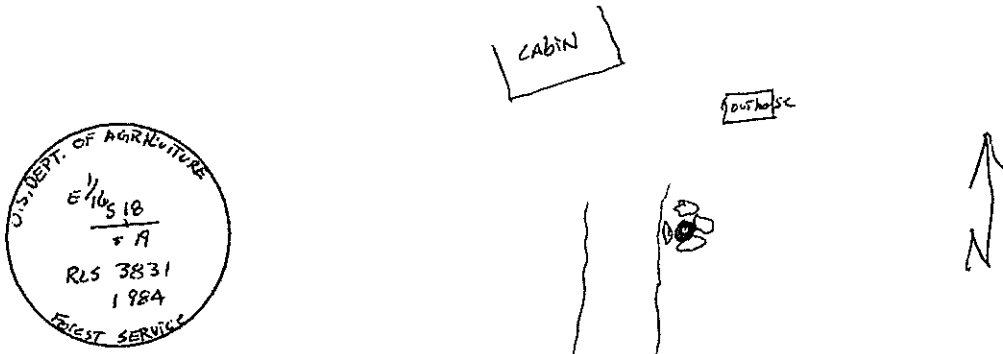

Certification:

Firm name and/or Surveyor: Johansen & Tuttle Eng.
 Address: 90 S. 100 E. Castle Dale, Utah 84513 Phone: (435) 381-2523

This is to certify that I was in responsible charge of the surveying work described in this record and that to the best of my knowledge the information presented herein is true and correct.

Location Diagram:

Section: 18
 Township: 17S
 Range: 16E

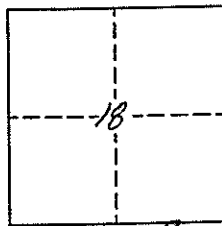

Date 11-30-01

EMERY COUNTY LAND SURVEY MONUMENT RECORD

Date of field work: 6-4-01

County Reference No. 1706170400

Type of Monument: Section Corner Quarter Corner
 Bench Mark ✓ Other 1/4 CORNER

Your Description and Observation of Monument Found (Be Specific):

FOUND STD FOREST SERVICE CAP 4" below The ground

Description of Monument, Reference Monument or Accessories Established by You to Perpetuate the Location of this Point:

SET 4" REBAR NORTHWEST, NORTHEAST, EAST, AND SOUTHEAST OF THE MONUMENT

Sketch showing Relative Location of Monument Accessories and Two Reference Points Stating Whether Found or Set. Show Supporting and/or Contradictory Evidence where Applicable. Include North Arrow.

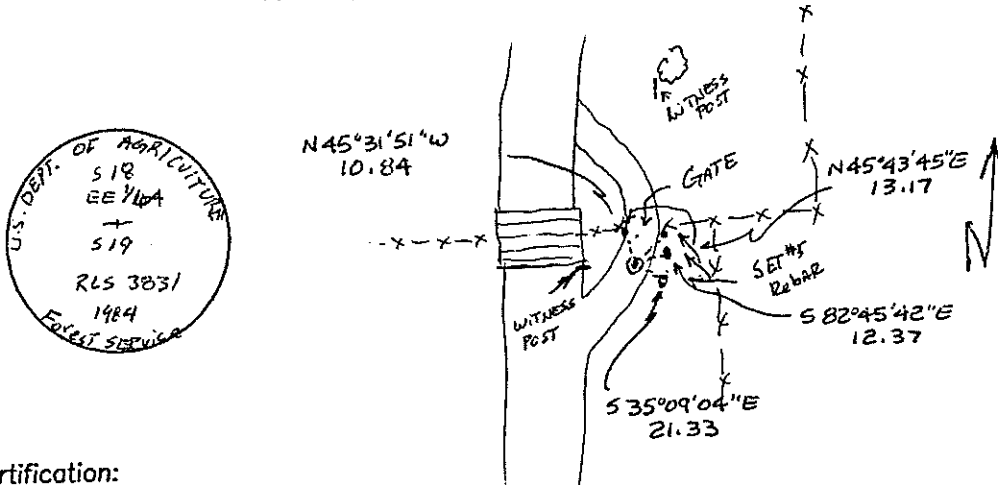

Certification:

Firm name and/or Surveyor: Johansen & Tuttle Eng.
 Address: 90 S. 100 E. Castle Dale, Utah 84513 Phone: (435) 381-2523

This is to certify that I was in responsible charge of the surveying work described in this record and that to the best of my knowledge the information presented herein is true and correct.

Location Diagram:

Section: 18
 Township: 17S
 Range: 6E

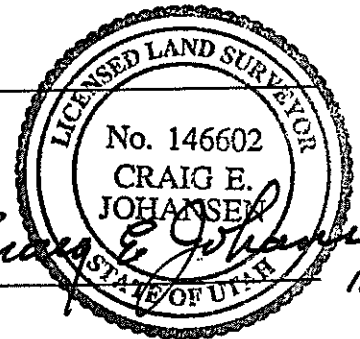
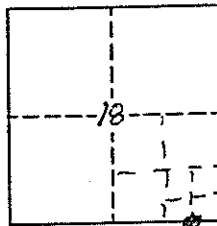

Date

11-30-01

EMERY COUNTY LAND SURVEY MONUMENT RECORD

Date of field work: 6-7-01

County Reference No. 1706170420

Type of Monument: Section Corner Quarter Corner
 Bench Mark Other 1/4 CORNER

Your Description and Observation of Monument Found (Be Specific):

FOUND STD FOREST SERVICE CAP

Description of Monument, Reference Monument or Accessories Established by You to Perpetuate the Location of this Point:

SET A #5 REBAR NORTHEAST, NORTH, NORTHWEST, AND WEST OF THE MONUMENT

Sketch showing Relative Location of Monument Accessories and Two Reference Points Stating Whether Found or Set. Show Supporting and/or Contradictory Evidence where Applicable. Include North Arrow.

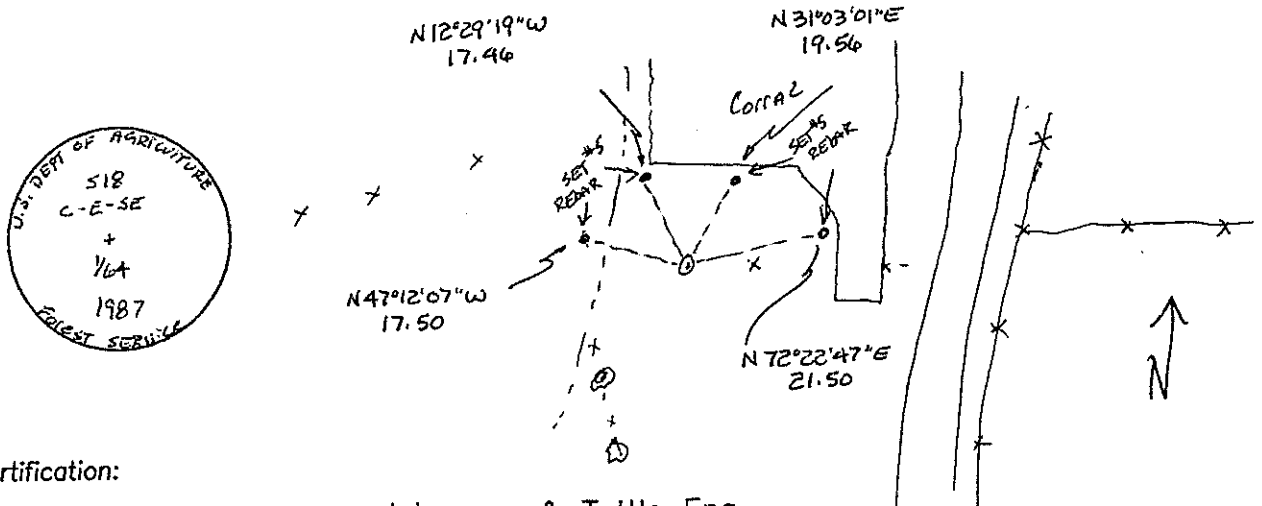

Certification:

Firm name and/or Surveyor: Johansen & Tuttle Eng.
 Address: 90 S. 100 E. Castle Dale, Utah 84513 Phone: (435) 381-2523

This is to certify that I was in responsible charge of the surveying work described in this record and that to the best of my knowledge the information presented herein is true and correct.

Location Diagram:

Section: 18
 Township: 17S
 Range: 6E

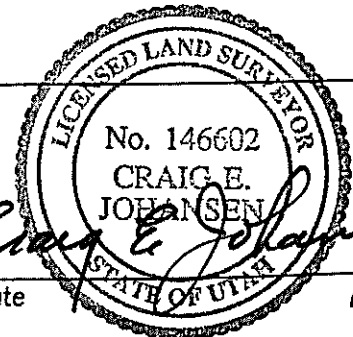
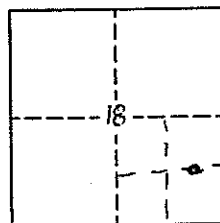

Craig E. Johansen

Date 11-30-01

EMERY COUNTY LAND SURVEY MONUMENT RECORD

Date of field work: 6-4-01

County Reference No. 1706200300

Type of Monument: Section Corner Quarter Corner
 Bench Mark Other _____

Your Description and Observation of Monument Found (Be Specific):

FOUND STANDARD USFS CAP

FOUND 18" PINION BEARING TREE NORTHWEST OF MONUMENT

Description of Monument, Reference Monument or Accessories Established by You to Perpetuate the Location of this Point:

SET A #5 REBAR N - NE - E - SE OF MONUMENT

Sketch showing Relative Location of Monument Accessories and Two Reference Points Stating Whether Found or Set. Show Supporting and/or Contradictory Evidence where Applicable. Include North Arrow.

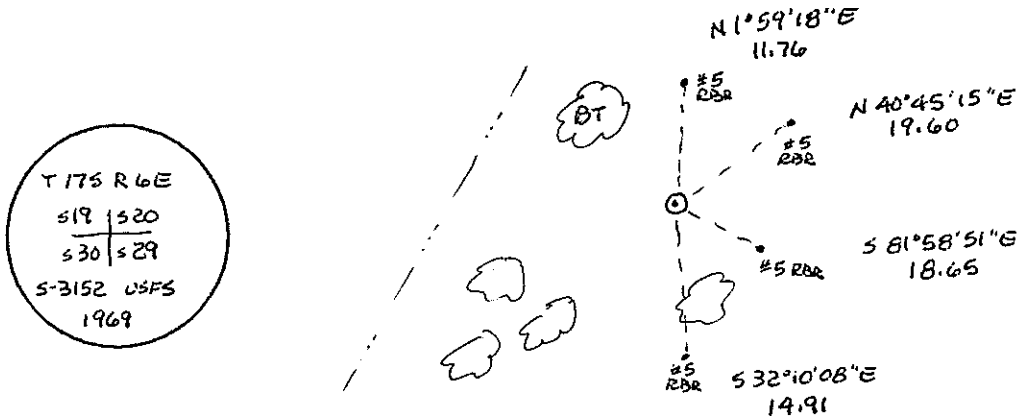

Certification:

Firm name and/or Surveyor: Johansen & Tuttle Eng.

Address: 90 S. 100 E. Castle Dale, Utah 84513 Phone: (435) 381-2523

This is to certify that I was in responsible charge of the surveying work described in this record and that to the best of my knowledge the information presented herein is true and correct.

Location Diagram:

Section: 20

Township: 17S

Range: 6E

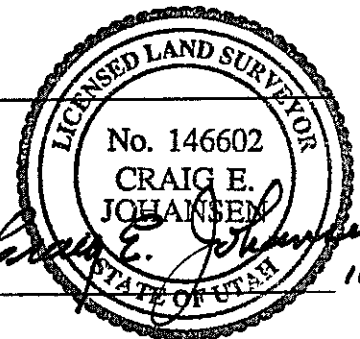
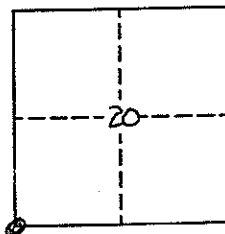

Date

11-30-01

UTAH LAND SURVEY MONUMENTS MASTER INDEX

TOWNSHIP 17 South RANGE 6 East, 5LR of M.

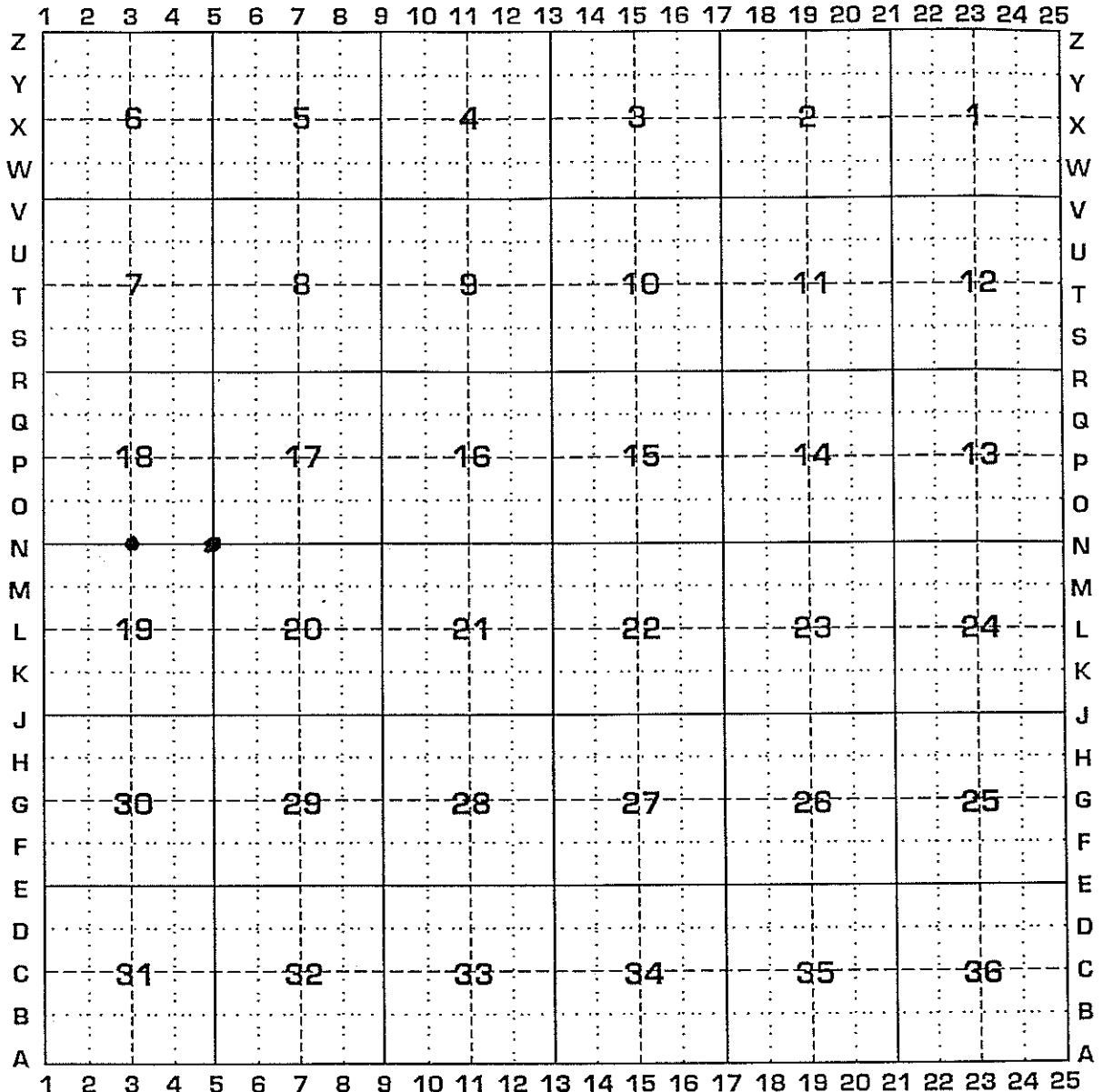

↑
N
Scale
1" = 1 Mile

● **Legend**
Location of Monument.
Record filed under this township.

EXPLANATION

Each monument record is identified by an numerical-alphabetical index or coordinate number which is related to the township diagram above. For example, the quarter corner common to Sections 4 and 5 would have the coordinate number 9-X.

Monuments which are not located at intersecting lines on the above diagram are identified by reference to the nearest decimal division of the spaces, with the decimal values increasing to the right and upward; e.g. 1.7-C, 8-M.3, 6.2-T.5.

A monument which is common to adjoining townships will be identified by the coordinates in the township in which the record is to be filed, except in the case where a county boundary coincides with a township line, in which case an appropriate coordinate number shall be used for each county involved.

Within each township file, the records shall be inserted in numerical-alphabetical order from top to bottom.

NOTICE

There may be more than one record for a monument. DO NOT REMOVE OLD RECORD when filing new one.

UTAH LAND SURVEY MONUMENT RECORD

County Emery

County Reference No. N 3

1. Date of Field Work: May 11, 2001

2. Type of Monument: Section Corner Quarter Corner
(Check one) Bench Mark Other _____

3. Your Description and Observation of Monument Found (Be Specific):

Brass Cap on pipe in East West fence

4. Description of Monument, Reference Monument or Accessories Established by You to Perpetuate the Location of this Point:

5. Sketch showing Relative Location of Monument Accessories and Two Reference Points Stating Whether Found or Set. Show Supporting and/or Contradictory Evidence where Applicable. Include North Arrow.

6. Certification:

Firm Name and/or Surveyor: Bruce T. S. Ware Phone: 637-2620
Address: 2223 N. 1200 W. Helper, Utah 84526

This is to certify that I was in responsible charge of the surveying work described in this record and that to the best of my knowledge the information presented herein is true and correct.

7. Location Diagram:

8. Section: 18

9. Township: 17 S

10. Range: 6 E

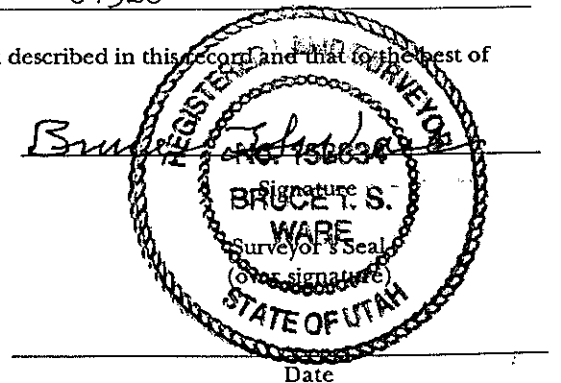
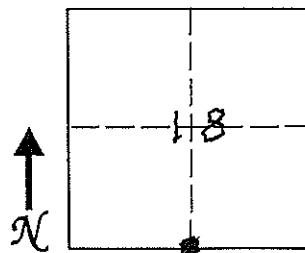
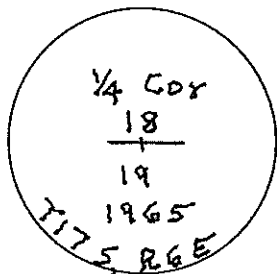

11. Monument Inscription:

12. Diagram Coordinate from Master Index for Townships: N 3

Report one monument per form. Type or use permanent black ink. Fill in all items.

UTAH LAND SURVEY MONUMENT RECORD

County Emery

County Reference No. N 5

1. Date of Field Work: May 11, 2001

2. Type of Monument: Section Corner Quarter Corner
(Check one) Bench Mark Other _____

3. Your Description and Observation of Monument Found (Be Specific):

Brass Cap on pipe with Alum post

4. Description of Monument, Reference Monument or Accessories Established by You to Perpetuate the Location of this Point:

5. Sketch showing Relative Location of Monument Accessories and Two Reference Points Stating Whether Found or Set. Show Supporting and/or Contradictory Evidence where Applicable. Include North Arrow.

6. Certification:

Firm Name and/or Surveyor: Bruce T. S. Ware Phone: 637-2620
Address: 2223 N. 1200 W. Helper, Utah 84526

This is to certify that I was in responsible charge of the surveying work described in this record and that to the best of my knowledge the information presented herein is true and correct.

7. Location Diagram:

8. Section: 18

9. Township: 17 S

10. Range: 6 E

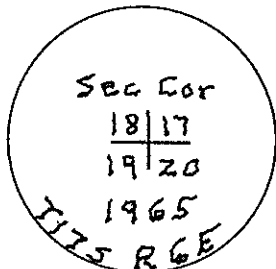

11. Monument Inscription:

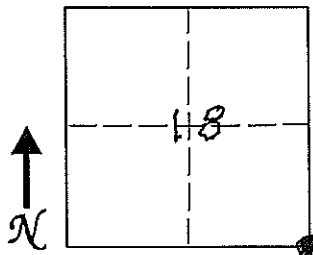

12. Diagram Coordinate from Master Index for Townships: N 5

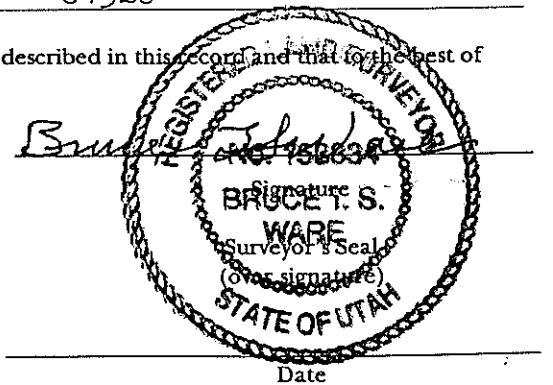

Report one monument per form. Type or use permanent black ink. Fill in all items.