

**COTTONWOOD CREEK
CONSOLIDATION
IRRIGATION COMPANY**

CANAL LOCATIONS

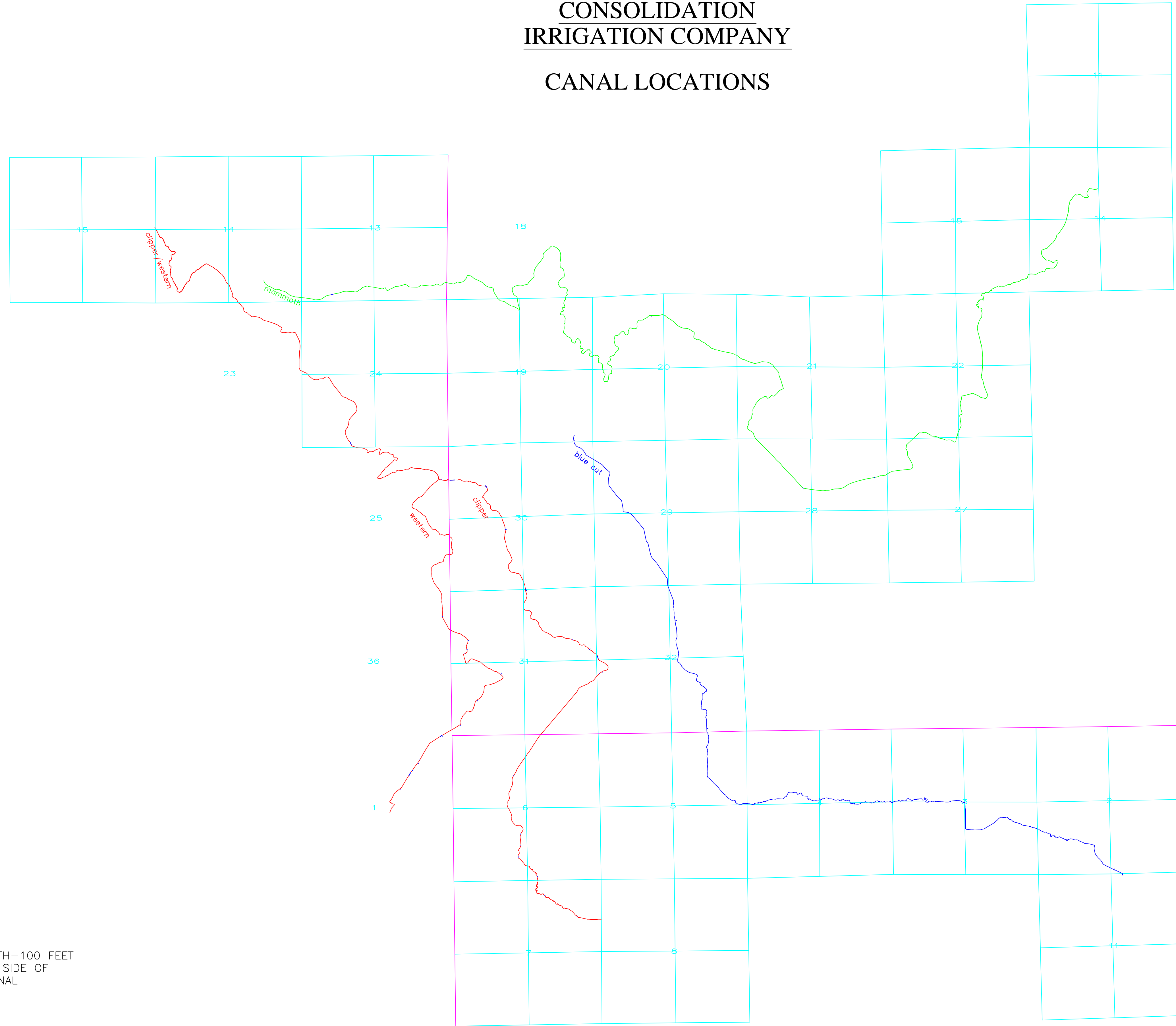

SCALE: 1"=2000'

NOTE:
RIGHT OF WAY WIDTH-100 FEET
50 FEET ON EACH SIDE OF
CENTERLINE OF CANAL

THIS DRAWING IS TO BE USED FOR THIS PROJECT AND THIS PROJECT ONLY UNLESS AUTHORIZED BY THE PROJECT ENGINEER AT JOHANSEN & TUTTLE ENGINEERS, INC.

| DESIGNED | HRT | CHECKED | 4-10 | CEJ | 4-10 |
|----------|-----|---------|------|---------|------|
| | DMF | | 4-10 | CHECKED | CEJ |
| | BHT | | 4-10 | CHECKED | LMS |
| | LMS | | 4-10 | CHECKED | CEJ |

BY: _____ DATE: _____

Johansen & Tuttle ENGINEERING INC.
 BOX 487, CASTLE DALE, UTAH 84513 (435) 381-2523
 FAX (435) 381-2522 EMAIL JT@etv.net

**COTTONWOOD CREEK
CONSOLIDATION
IRRIGATION COMPANY**

CANAL LOCATION

FIGURE NO.
1