



# EMERY COUNTY LAND SURVEY MONUMENT RECORD

Date of field work: 11-12-02

County Reference No. 2115700670

Type of Monument:            Section Corner            Quarter Corner  
           Bench Mark   X   Other 1/16 CORNER

Your Description and Observation of Monument Found ( Be Specific ):  
 FOUND STD. 1974 BLM BRASS CAP 6" ABOVE GROUND  
 ORANGE "T" BAR POST BY MARKER

Description of Monument, Reference Monument or Accessories Established by You to Perpetuate the Location of this Point:

SET A, #4 REBAR N, S, E, W OF MONUMENT

Sketch showing Relative Location of Monument Accessories and Two Reference Points Stating Whether Found or Set. Show Supporting and/or Contradictory Evidence where Applicable. Include North Arrow.

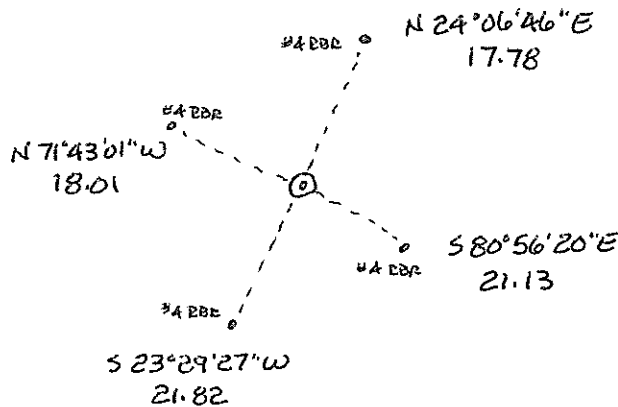
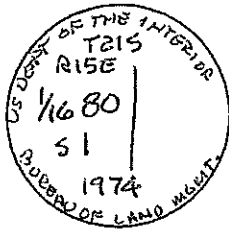

Certification:

Firm name and/or Surveyor: Johansen & Tuttle Eng.  
 Address: 90 S. 100 E. Castle Dale, Utah 84513 Phone: (435) 381-2523

This is to certify that I was in responsible charge of the surveying work described in this record and that to the best of my knowledge the information presented herein is true and correct.

Location Diagram:  
 Section: 1  
 Township: 21 S  
 Range: 15 E

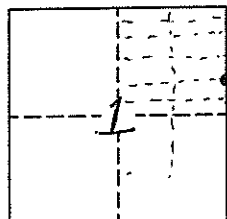

*Craig E. Johansen*  
 LICENSED LAND SURVEYOR  
 No. 146602  
 CRAIG E. JOHANSEN  
 STATE OF UTAH

11-27-02  
 Date

# EMERY COUNTY LAND SURVEY MONUMENT RECORD

Date of field work: 11-12-02

County Reference No. 2115760690

Type of Monument:            Section Corner            Quarter Corner  
           Bench Mark            X Other 1/16 CORNER

Your Description and Observation of Monument Found ( Be Specific ):  
 FOUND STD. 1974 BLM BRASS CAP 6" ABOVE GROUND  
 ORANGE "T" BAR POST BY MARKER

Description of Monument, Reference Monument or Accessories Established by You to Perpetuate the Location of this Point:

SET 4, #4 REBAR N, S, E, W OF MONUMENT

Sketch showing Relative Location of Monument Accessories and Two Reference Points Stating Whether Found or Set. Show Supporting and/or Contradictory Evidence where Applicable. Include North Arrow.

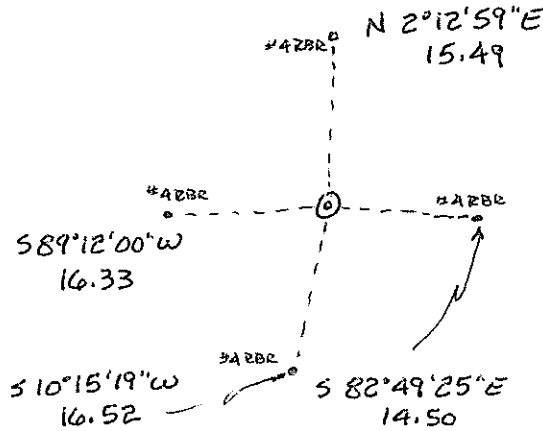
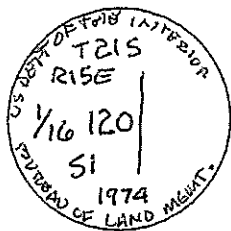

Certification:

Firm name and/or Surveyor: Johansen & Tuttle Eng.  
 Address: 90 S. 100 E. Castle Dale, Utah 84513 Phone: (435) 381-2523

This is to certify that I was in responsible charge of the surveying work described in this record and that to the best of my knowledge the information presented herein is true and correct.

Location Diagram:  
 Section: 1  
 Township: 215  
 Range: 15E

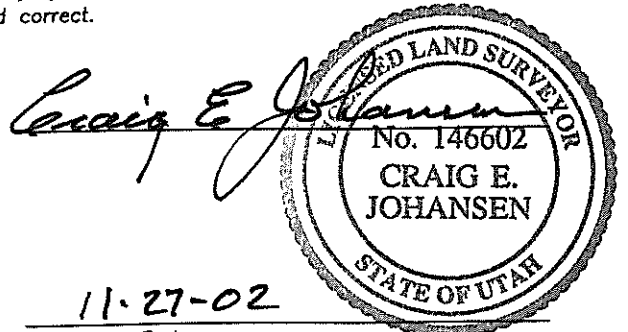
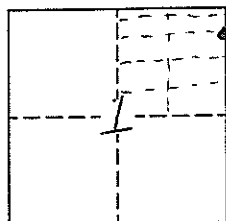

11-27-02  
 Date