

EMERY COUNTY LAND SURVEY MONUMENT RECORD

Date of field work: 7-3-03

County Reference No. 211654D50D

Type of Monument: _____ Section Corner Quarter Corner
 _____ Bench Mark _____ Other _____

Your Description and Observation of Monument Found (Be Specific):

16" x 6" x 4" RED SANDSTONE MARKED \perp LYING ON GROUND WITH A STEEL FENCE POST DRIVEN ON WEST SIDE

Description of Monument, Reference Monument or Accessories Established by You to Perpetuate the Location of this Point: SET 4 #4 REBAR AS SHOWN

Sketch showing Relative Location of Monument Accessories and Two Reference Points Stating Whether Found or Set. Show Supporting and/or Contradictory Evidence where Applicable. Include North Arrow.

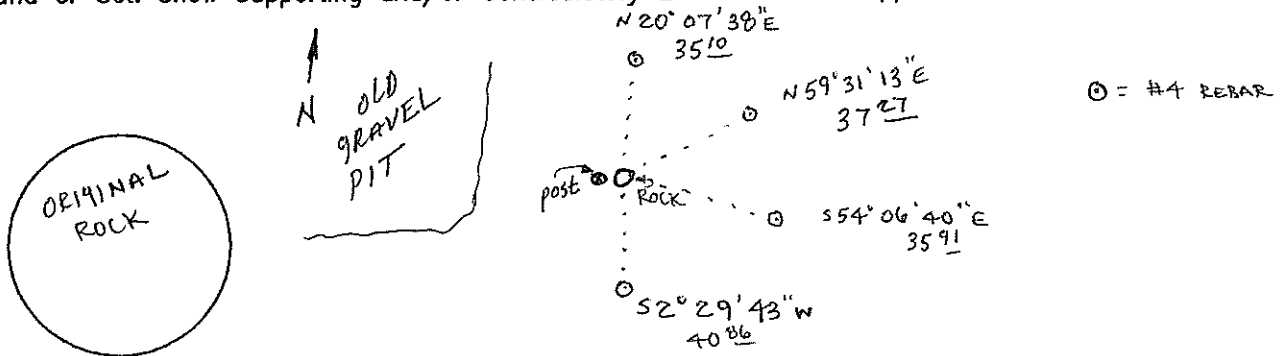

Certification:

Firm name and/or Surveyor: Johansen & Tuttle Eng.

Address: 90 S. 100 E. Castle Dale, Utah 84513 Phone: (435) 381-2523

This is to certify that I was in responsible charge of the surveying work described in this record and that to the best of my knowledge the information presented herein is true and correct.

Location Diagram:

Section: 11
 Township: 21S
 Range: 16E

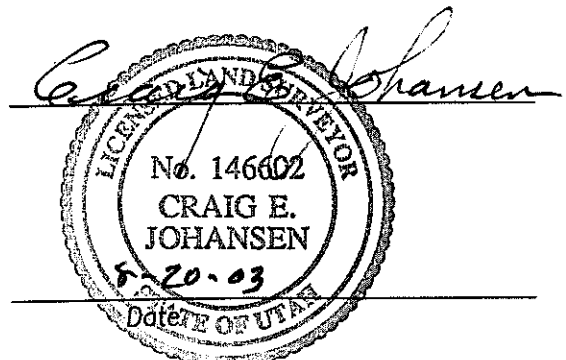
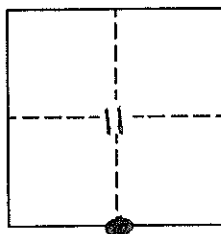

EMERY COUNTY LAND SURVEY MONUMENT RECORD

Date of field work: 7-3-03

County Reference No. 2116540600

Type of Monument: Section Corner Quarter Corner
 Bench Mark Other

Your Description and Observation of Monument Found (Be Specific):
PLASTIC SURVEY CAP (#3115) WITH MOUND OF STONE @ INTERSECTION OF FENCELINE.

Description of Monument, Reference Monument or Accessories Established by You to Perpetuate the Location of this Point: PLACED A #4 REBAR AS SHOWN

Sketch showing Relative Location of Monument Accessories and Two Reference Points Stating Whether Found or Set. Show Supporting and/or Contradictory Evidence where Applicable. Include North Arrow.

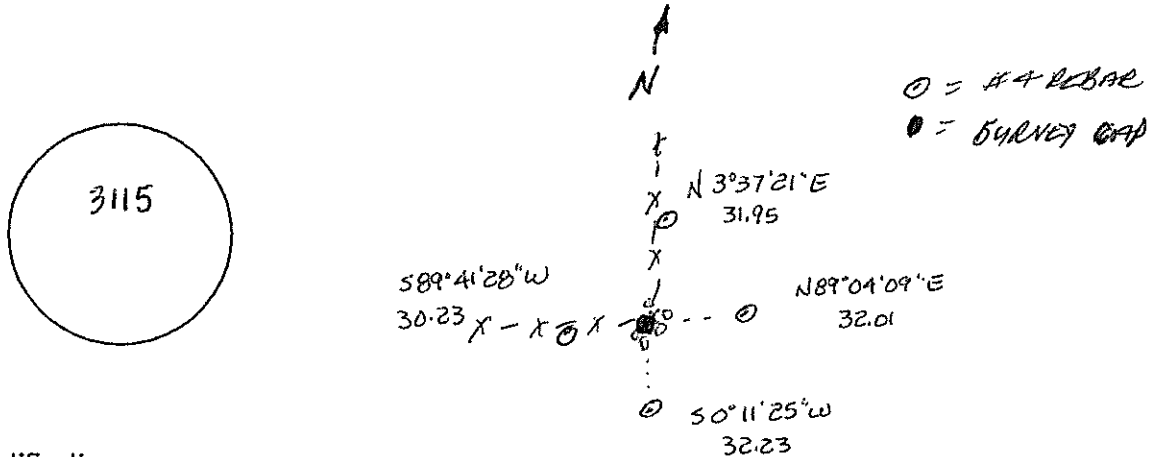

Certification:

Firm name and/or Surveyor: Johansen & Tuttle Eng.
 Address: 90 S. 100 E. Castle Dale, Utah 84513 Phone: (435) 381-2523

This is to certify that I was in responsible charge of the surveying work described in this record and that to the best of my knowledge the information presented herein is true and correct.

Location Diagram:
 Section: 11
 Township: 21S
 Range: 16E

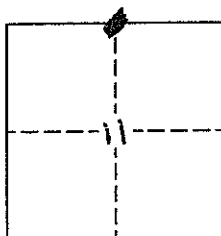

Craig E. Johansen

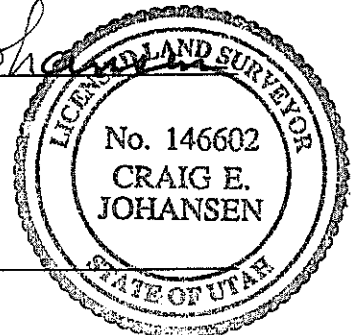

8-20-03
 Date