

EMERY COUNTY LAND SURVEY MONUMENT RECORD

Date of field work: 7-1-03

County Reference No. 2116640400

Type of Monument: _____ Section Corner
 _____ Bench Mark

Quarter Corner
 _____ Other _____

Your Description and Observation of Monument Found (Be Specific):

PLASTIC SURVEY CAP (NOT LEGIBLE) ON #5 REBAR WITH A MOUND OF STONE ALONGSIDE AND A 4"X4" POST DRIVEN ALONGSIDE

Description of Monument, Reference Monument or Accessories Established by You to Perpetuate the Location of this Point: *SET 4 REBAR AS SHOWN*

Sketch showing Relative Location of Monument Accessories and Two Reference Points Stating Whether Found or Set. Show Supporting and/or Contradictory Evidence where Applicable. Include North Arrow.

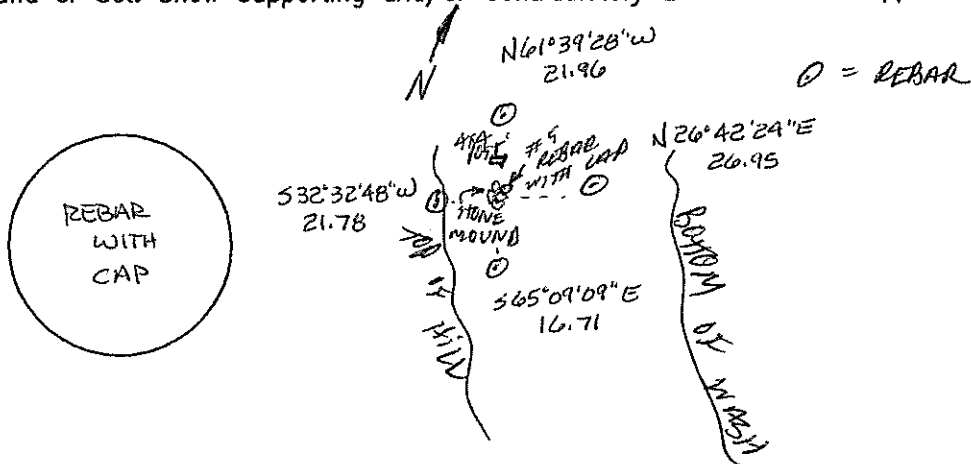

Certification:

Firm name and/or Surveyor: Johansen & Tuttle Eng.

Address: 90 S. 100 E. Castle Dale, Utah 84513 Phone: (435) 381-2523

This is to certify that I was in responsible charge of the surveying work described in this record and that to the best of my knowledge the information presented herein is true and correct.

Location Diagram:

Section: 13
 Township: 21S
 Range: 16E

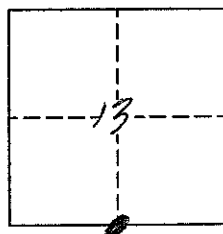

Craig E. Johansen

 8-20-03

 Date

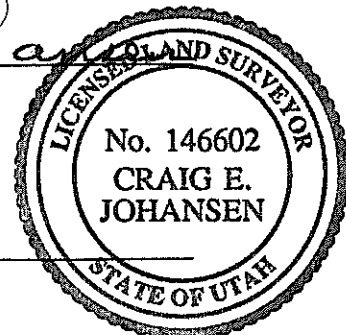

EMERY COUNTY LAND SURVEY MONUMENT RECORD

Date of field work: 7-1-03

County Reference No. 2116700400

Type of Monument: Section Corner
 Bench Mark

Quarter Corner
 Other _____

Your Description and Observation of Monument Found (Be Specific):
8" x 12" SANDSTONE 12" ABOVE GROUND WITH 3 EVIDENT NOTCH'S ON THE S.E. CORNER.

Description of Monument, Reference Monument or Accessories Established by You to Perpetuate the Location of this Point: SET A REBAR AS SHOWN.

Sketch showing Relative Location of Monument Accessories and Two Reference Points Stating Whether Found or Set. Show Supporting and/or Contradictory Evidence where Applicable. Include North Arrow.

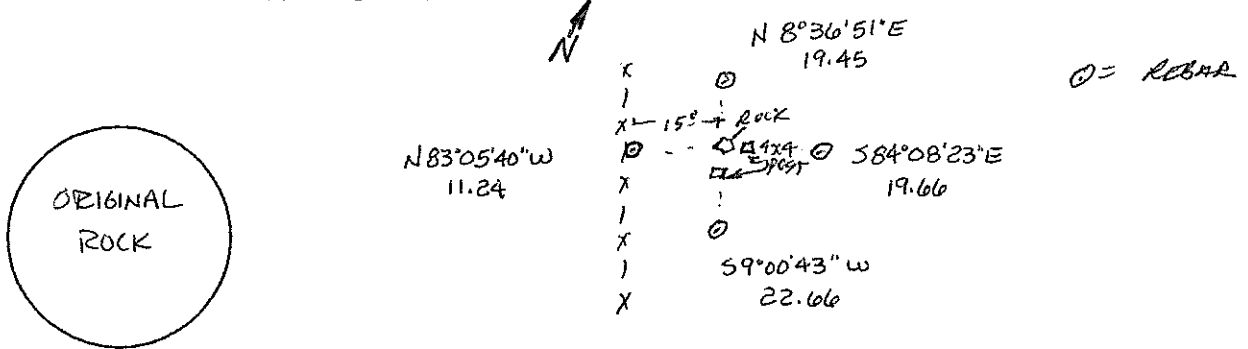

Certification:

Firm name and/or Surveyor: Johansen & Tuttle Eng.
 Address: 90 S. 100 E. Castle Dale, Utah 84513 Phone: (435) 381-2523

This is to certify that I was in responsible charge of the surveying work described in this record and that to the best of my knowledge the information presented herein is true and correct.

Location Diagram:
 Section: 13
 Township: 21S
 Range: 16E

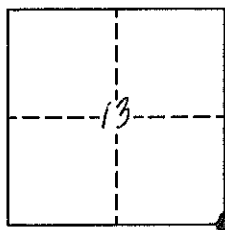

Craig E. Johansen

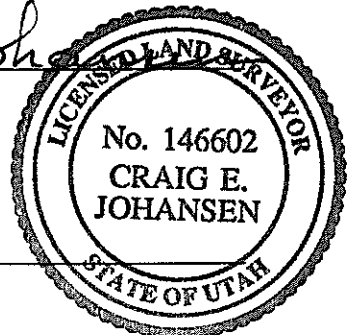

8-20-03
 Date

EMERY COUNTY LAND SURVEY MONUMENT RECORD

Date of field work: 7-1-03

County Reference No. 2116700440

Type of Monument: _____ Section Corner Quarter Corner
 _____ Bench Mark _____ Other _____

Your Description and Observation of Monument Found (Be Specific):
#5 REBAR PLANTED ALONGSIDE A MOUND OF STONE

Description of Monument, Reference Monument or Accessories Established by You to Perpetuate the Location of this Point: PLACED A REBAR AS SHOWN.

Sketch showing Relative Location of Monument Accessories and Two Reference Points Stating Whether Found or Set. Show Supporting and/or Contradictory Evidence where Applicable. Include North Arrow.

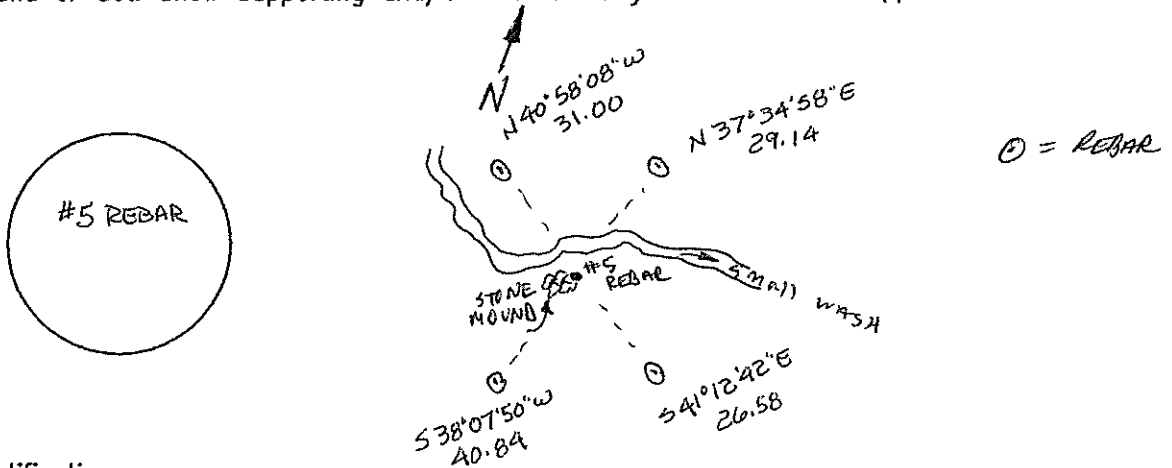

Certification:

Firm name and/or Surveyor: Johansen & Tuttle Eng.
 Address: 90 S. 100 E. Castle Dale, Utah 84513 Phone: (435) 381-2523

This is to certify that I was in responsible charge of the surveying work described in this record and that to the best of my knowledge the information presented herein is true and correct.

Location Diagram:
 Section: 13
 Township: 21S
 Range: 16E

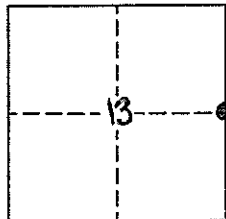

Craig E. Johansen
 LICENSED LAND SURVEYOR
 No. 146602
 CRAIG E. JOHANSEN
 STATE OF UTAH
8-20-03
 Date

EMERY COUNTY LAND SURVEY MONUMENT RECORD

Date of field work: 7-2-03

County Reference No. 2116700500

Type of Monument: Section Corner Quarter Corner
 Bench Mark Other _____

Your Description and Observation of Monument Found (Be Specific):
 PLASTIC SURVEY CAP ON #5 REBAR - CAP IS UNLEGIBLE WITH 4x4 STUB POST ALONGSIDE AND SMALL MOUND OF STONE. A STEEL FENCE POST IS LYING ON GROUND BY CAP.

Description of Monument, Reference Monument or Accessories Established by You to Perpetuate the Location of this Point: PLACED 4 #4 REBAR AS SHOWN

Sketch showing Relative Location of Monument Accessories and Two Reference Points Stating Whether Found or Set. Show Supporting and/or Contradictory Evidence where Applicable. Include North Arrow.

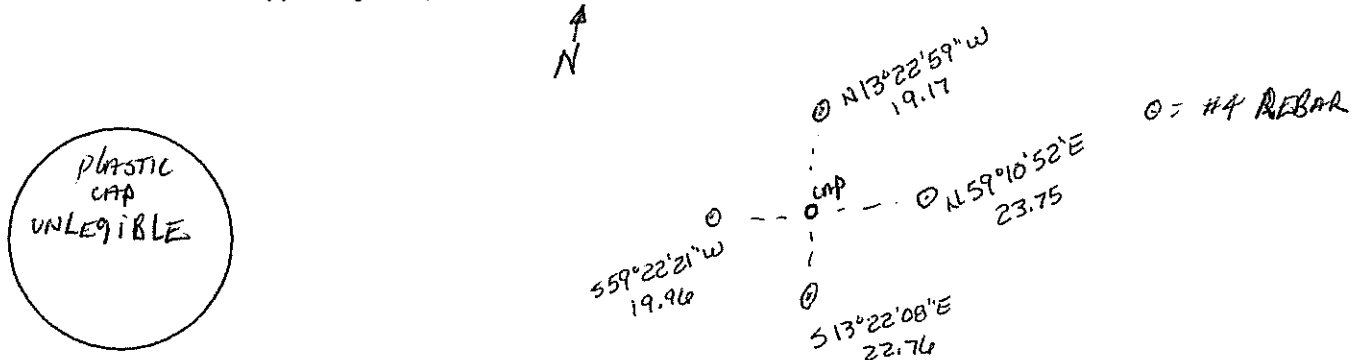

Certification:

Firm name and/or Surveyor: Johansen & Tuttle Eng.
 Address: 90 S. 100 E. Castle Dale, Utah 84513 Phone: (435) 381-2523

This is to certify that I was in responsible charge of the surveying work described in this record and that to the best of my knowledge the information presented herein is true and correct.

Location Diagram:
 Section: 13
 Township: 21S
 Range: 16E

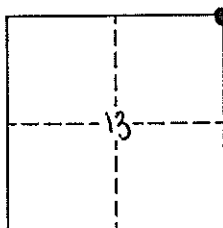

Craig E. Johansen

 8-20-03
 Date