

EMERY COUNTY LAND SURVEY MONUMENT RECORD

Date of field work: 7-1-03

County Reference No. 2117 100 400

Type of Monument: Section Corner
 Bench Mark

Quarter Corner
 Other _____

Your Description and Observation of Monument Found (Be Specific):
6" x 12" SANDSTONE 12" OUT OF GROUND WITH C.C. NOTCHED IN EAST SIDE

Description of Monument, Reference Monument or Accessories Established by You to Perpetuate the Location of this Point: SET A REBAR AS SHOWN.

Sketch showing Relative Location of Monument Accessories and Two Reference Points Stating Whether Found or Set. Show Supporting and/or Contradictory Evidence where Applicable. Include North Arrow.

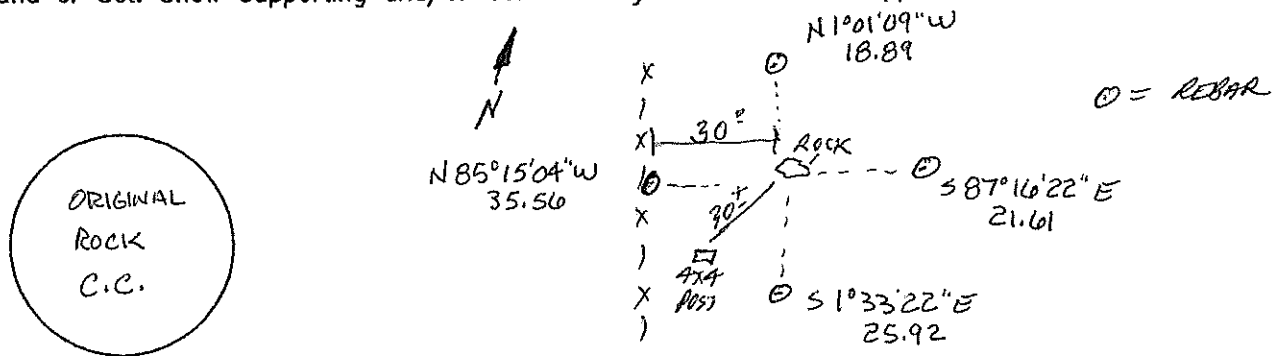

Certification:

Firm name and/or Surveyor: Johansen & Tuttle Eng.

Address: 90 S. 100 E. Castle Dale, Utah 84513 Phone: (435) 381-2523

This is to certify that I was in responsible charge of the surveying work described in this record and that to the best of my knowledge the information presented herein is true and correct.

Location Diagram:

Section: 18
 Township: 21S
 Range: 17E

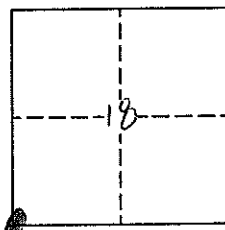

Craig E. Johansen
 LICENSED LAND SURVEYOR
 No. 146602
 CRAIG E. JOHANSEN
 STATE OF UTAH
8-20-03
 Date

EMERY COUNTY LAND SURVEY MONUMENT RECORD

Date of field work: 7-22-03

County Reference No. 2117100440

Type of Monument: Section Corner ✓ Quarter Corner
 Bench Mark Other

Your Description and Observation of Monument Found (Be Specific):
SET 2" Alum. EMERY COUNTY SURVEYS CAP

Description of Monument, Reference Monument or Accessories Established by You to Perpetuate the Location of this Point: SET 4 #9 REBAR AS SHOWN.
BUILT STONE MOUND AROUND CAP.

Sketch showing Relative Location of Monument Accessories and Two Reference Points Stating Whether Found or Set. Show Supporting and/or Contradictory Evidence where Applicable. Include North Arrow.

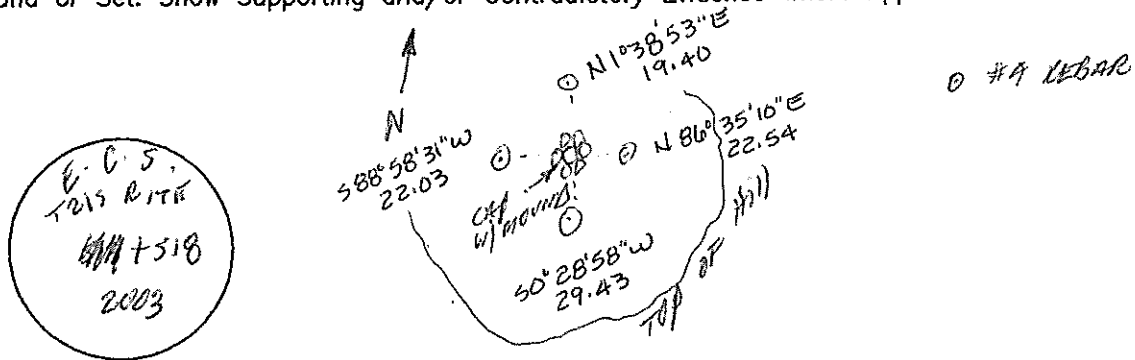

Certification:

Firm name and/or Surveyor: Johansen & Tuttle Eng.
 Address: 90 S. 100 E. Castle Dale, Utah 84513 Phone: (435) 381-2523

This is to certify that I was in responsible charge of the surveying work described in this record and that to the best of my knowledge the information presented herein is true and correct.

Location Diagram:
 Section: 18
 Township: 21S
 Range: 17E

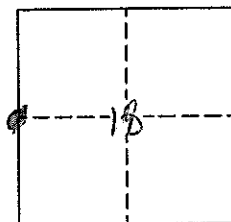

Craig E. Johansen

8-20-03
 Date

EMERY COUNTY LAND SURVEY MONUMENT RECORD

Date of field work: 7-22-03

County Reference No. 2117100500

Type of Monument: Section Corner Quarter Corner
 Bench Mark Other _____

Your Description and Observation of Monument Found (Be Specific):
SET 2" ALUM EMERY CO. SURVEYS CAP 1" ABOVE GROUND

Description of Monument, Reference Monument or Accessories Established by You to Perpetuate the Location of this Point: SET A #4 REBAR AS SHOWN

Sketch showing Relative Location of Monument Accessories and Two Reference Points Stating Whether Found or Set. Show Supporting and/or Contradictory Evidence where Applicable. Include North Arrow.

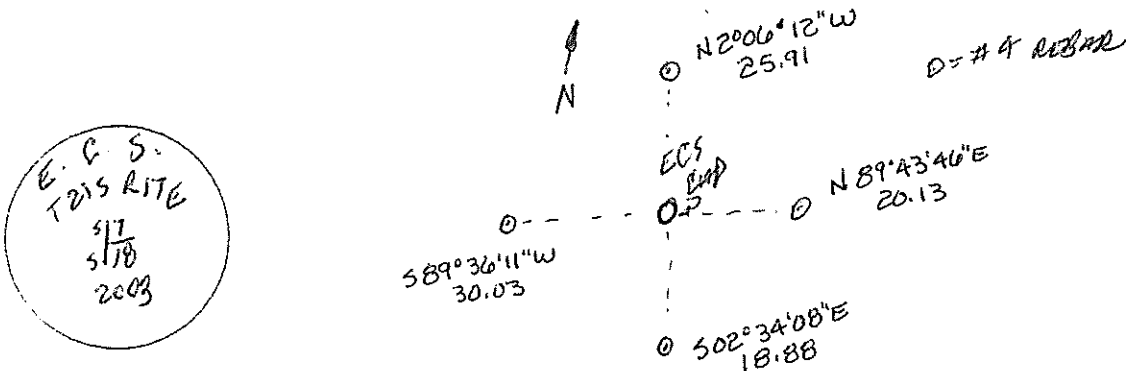

Certification:

Firm name and/or Surveyor: Johansen & Tuttle Eng.
 Address: 90 S. 100 E. Castle Dale, Utah 84513 Phone: (435) 381-2523

This is to certify that I was in responsible charge of the surveying work described in this record and that to the best of my knowledge the information presented herein is true and correct.

Location Diagram:
 Section: 18
 Township: 21S
 Range: 17E

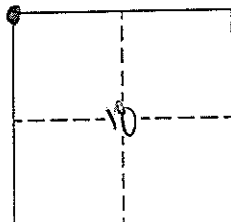

Craig E. Johansen

8-20-03
 Date

EMERY COUNTY LAND SURVEY MONUMENT RECORD

Date of field work: 7-22-03

County Reference No. 2117140400

Type of Monument: Section Corner
 Bench Mark

Quarter Corner
 Other _____

Your Description and Observation of Monument Found (Be Specific):

4" x 4" POST 1⁰ ABOVE GROUND

Description of Monument, Reference Monument or Accessories Established by You to Perpetuate the Location of this Point: SET A #4 REBAR AS SHOWN

Sketch showing Relative Location of Monument Accessories and Two Reference Points Stating Whether Found or Set. Show Supporting and/or Contradictory Evidence where Applicable. Include North Arrow.

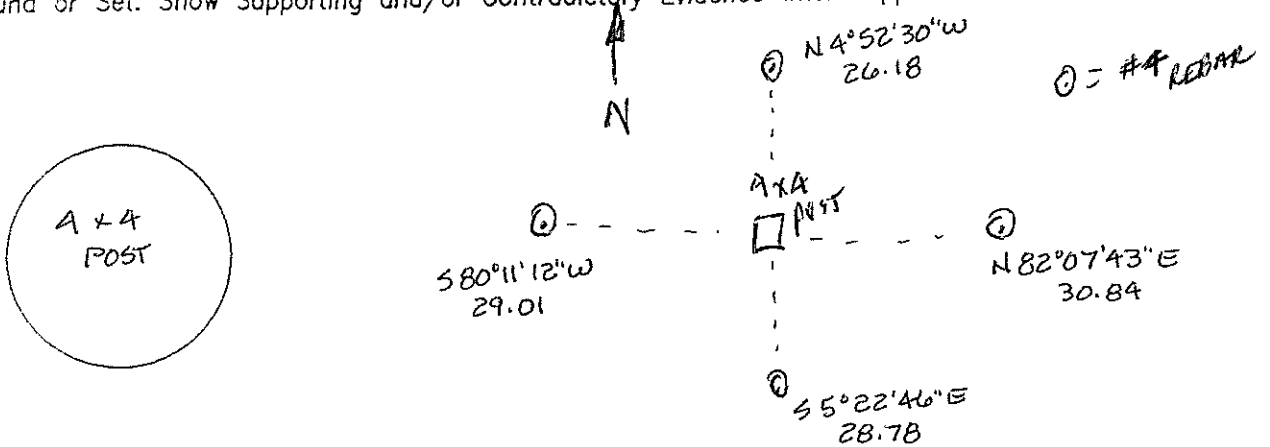

Certification:

Firm name and/or Surveyor: Johansen & Tuttle Eng.

Address: 90 S. 100 E. Castle Dale, Utah 84513 Phone: (435) 381-2523

This is to certify that I was in responsible charge of the surveying work described in this record and that to the best of my knowledge the information presented herein is true and correct.

Location Diagram:

Section: 10
 Township: 21S
 Range: 17E

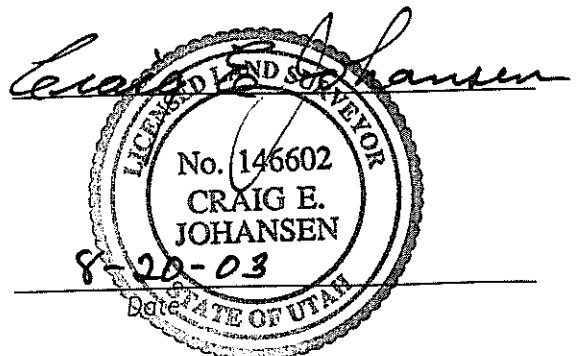
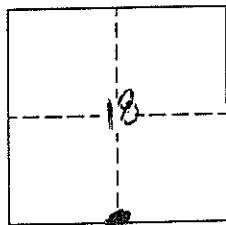

EMERY COUNTY LAND SURVEY MONUMENT RECORD

Date of field work: 7-22-03

County Reference No. 2117140440

Type of Monument: Section Corner
 Bench Mark

Quarter Corner
 Other CENTER OF SECTION

Your Description and Observation of Monument Found (Be Specific):

SET 2" EM. CO. SURVEYS ALUM. CAP

Description of Monument, Reference Monument or Accessories Established by You to Perpetuate the Location of this Point: SET A #4 REBAR AS SHOWN

BUILT STONE MOUNDS AROUND CAP

Sketch showing Relative Location of Monument Accessories and Two Reference Points Stating Whether Found or Set. Show Supporting and/or Contradictory Evidence where Applicable. Include North Arrow.

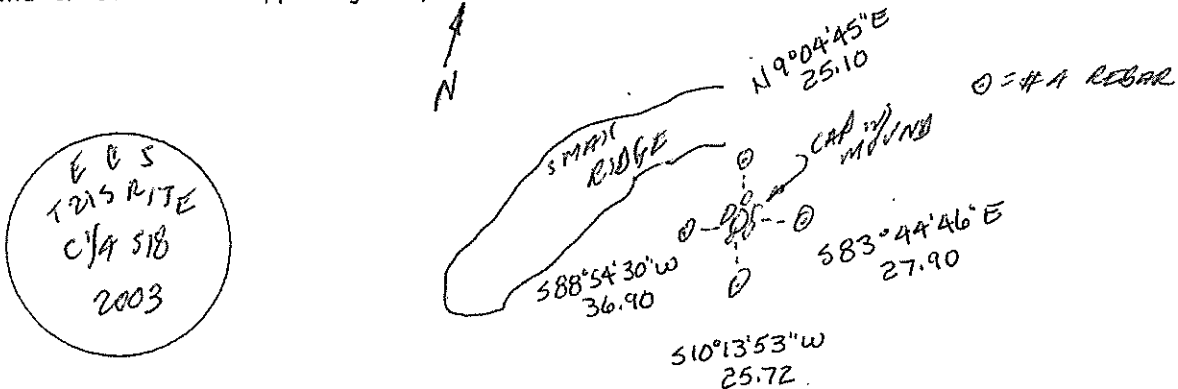

Certification:

Firm name and/or Surveyor: Johansen & Tuttle Eng.

Address: 90 S. 100 E. Castle Dale, Utah 84513 Phone: (435) 381-2523

This is to certify that I was in responsible charge of the surveying work described in this record and that to the best of my knowledge the information presented herein is true and correct.

Location Diagram:

Section: 19
 Township: 23S
 Range: 17E

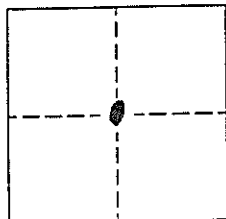

Craig E. Johansen
 LICENSED LAND SURVEYOR
 No. 146602
 CRAIG E. JOHANSEN
8-20-03
 Date

EMERY COUNTY LAND SURVEY MONUMENT RECORD

Date of field work: 7-22-03

County Reference No. 2117200400

Type of Monument:

Section Corner
 Bench Mark

Quarter Corner
 Other _____

Your Description and Observation of Monument Found (Be Specific):

SET 2" EM. CD. SURVEYS ALUM. CAP.

Description of Monument, Reference Monument or Accessories Established by You to Perpetuate the Location of this Point: SET A #4 REBAR AS SHOWN

BUILT STONE MOUND AROUND CAP.

Sketch showing Relative Location of Monument Accessories and Two Reference Points Stating Whether Found or Set. Show Supporting and/or Contradictory Evidence where Applicable. Include North Arrow.

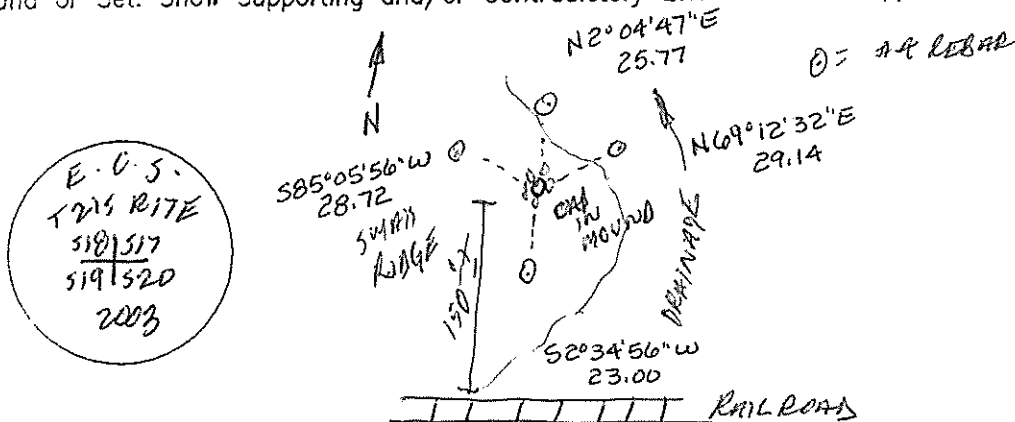

Certification:

Firm name and/or Surveyor: Johansen & Tuttle Eng.

Address: 90 S. 100 E. Castle Dale, Utah 84513

Phone: (435) 381-2523

This is to certify that I was in responsible charge of the surveying work described in this record and that to the best of my knowledge the information presented herein is true and correct.

Location Diagram:

Section: 19
 Township: 22S
 Range: 17E

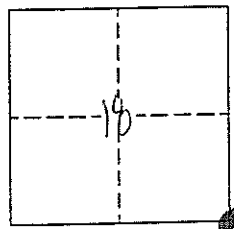

Craig E. Johansen
 LICENSED LAND SURVEYOR
 No. 146602
 CRAIG E. JOHANSEN
 STATE OF UTAH
 Date: 7-20-03

EMERY COUNTY LAND SURVEY MONUMENT RECORD

Date of field work: 7-22-03

County Reference No. 2117200440

Type of Monument: Section Corner Quarter Corner
 Bench Mark Other _____

Your Description and Observation of Monument Found (Be Specific):

SET 2" EM. CO. SURVEYS ALUM. CAP.

Description of Monument, Reference Monument or Accessories Established by You to Perpetuate the Location of this Point: SET 4 #4 REBAR AS SHOWN

BUILT STONE MOUNDS AROUND CAP.

Sketch showing Relative Location of Monument Accessories and Two Reference Points Stating Whether Found or Set. Show Supporting and/or Contradictory Evidence where Applicable. Include North Arrow.

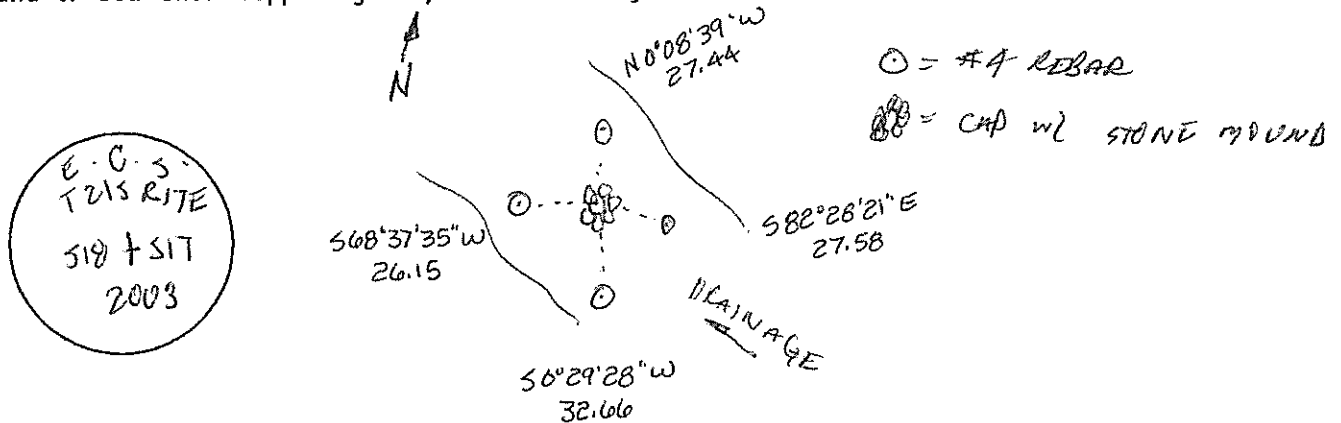

Certification:

Firm name and/or Surveyor: Johansen & Tuttle Eng.

Address: 90 S. 100 E. Castle Dale, Utah 84513 Phone: (435) 381-2523

This is to certify that I was in responsible charge of the surveying work described in this record and that to the best of my knowledge the information presented herein is true and correct.

Location Diagram:

Section: 18

Township: 21S

Range: 17E

