

EMERY COUNTY LAND SURVEY MONUMENT RECORD

Date of field work: 3-8-01

County Reference No. 190800400

Type of Monument: Section Corner Quarter Corner
 Bench Mark Other _____

Your Description and Observation of Monument Found (Be Specific):
FOUND TWO ELS RM CAPS

Description of Monument, Reference Monument or Accessories Established by You to Perpetuate the Location of this Point:

MEASURED AND SET A 8" X 3/8" SPIKE IN THE ROAD FOR THE CORNER
SET #4 REBAR SOUTHWEST, AND SOUTHWEST OF THE CORNER

Sketch showing Relative Location of Monument Accessories and Two Reference Points Stating Whether Found or Set. Show Supporting and/or Contradictory Evidence where Applicable. Include North Arrow.

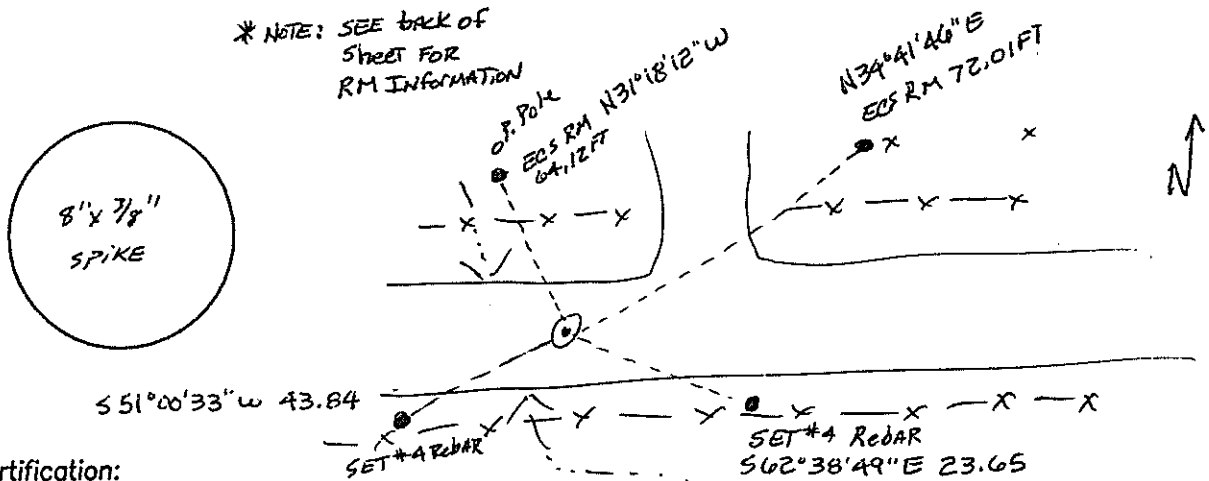

Certification:

Firm name and/or Surveyor: Johansen & Tuttle Eng.
 Address: 90 S. 100 E. Castle Dale, Utah 84513 Phone: (435) 381-2523

This is to certify that I was in responsible charge of the surveying work described in this record and that to the best of my knowledge the information presented herein is true and correct.

Location Diagram:
 Section: 18
 Township: 19S
 Range: 8E

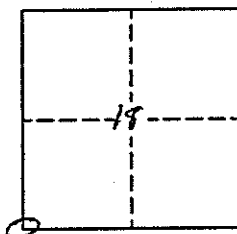

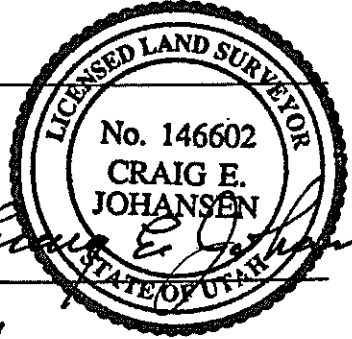

Craig E. Johansen
 Date 11-30-01

1908100400

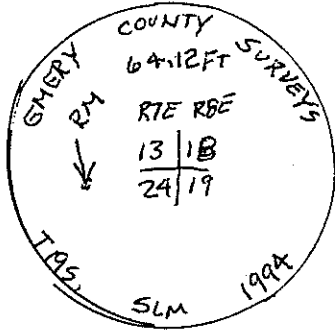
SHEET 2

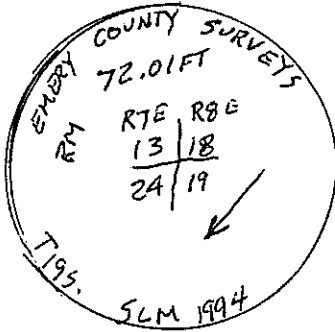

NORTH WEST RM



NORTH EAST RM

UTAH LAND SURVEY MONUMENT RECORD

County EMERY

1908
County Reference No. 0679 10 440

1. Date of Field Work: 1-24-01

2. Type of Monument:
(Check one)

Section Corner Quarter Corner
 Bench Mark Other

3. Your Description and Observation of Monument Found (Be Specific):
FOUND STD BLM CAP AT A EAST-WEST SOUTH FENCE CORNER

4. Description of Monument, Reference Monument or Accessories Established by You to Perpetuate the Location of this Point:
SET A #4 REBAR NORTH, NORTHWEST, AND TWO NORTHEAST OF THE MONUMENT

5. Sketch showing Relative Location of Monument Accessories and Two Reference Points Stating Whether Found or Set. Show Supporting and/or Contradictory Evidence where Applicable. Include North Arrow.

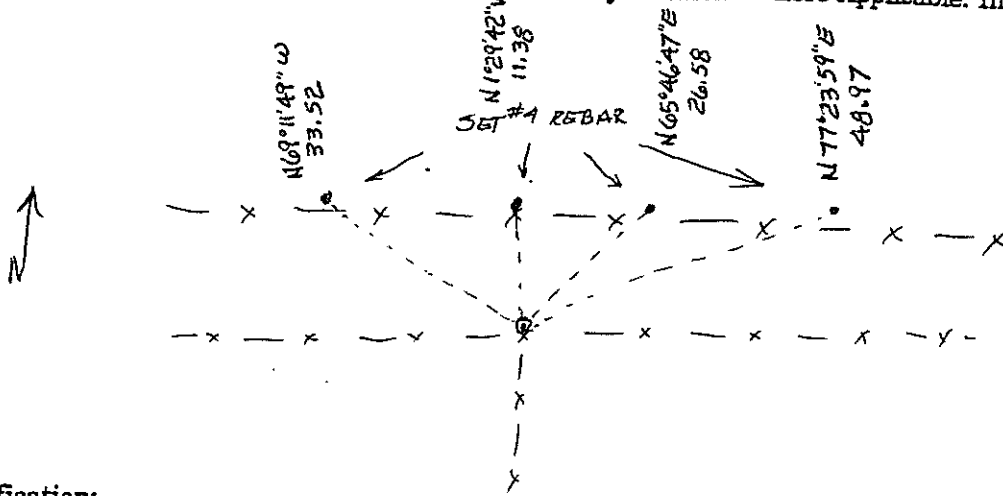

6. Certification:

Firm Name and/or Surveyor: JOHANSEN & TUTTLE ENG Phone: 435) 381-2523
 Address: 905 100E CASTLE DALE UTAH

This is to certify that I was in responsible charge of the surveying work described in this record and that to the best of my knowledge the information presented herein is true and correct.

7. Location Diagram:

8. Section: 18
 9. Township: 19S
 10. Range: 8E

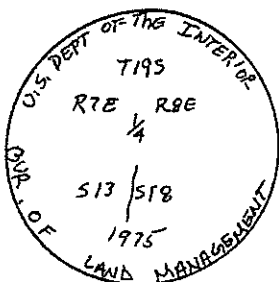
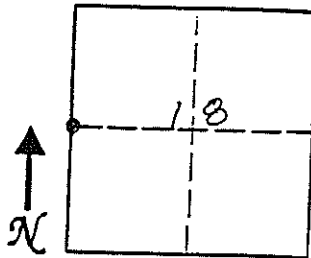

11. Monument Inscription:

12. Diagram Coordinate from Master Index for Townships: _____

LICENSED LAND SURVEYOR

No. 146602

CRAIG E. JOHANSEN

STATE OF UTAH

Signature: _____
 Surveyor's Seal (over signature)
 Date: 11-30-01

Report one monument per form.
 Type or use permanent black ink.
 Fill in all items.

EMERY COUNTY LAND SURVEY MONUMENT RECORD

Date of field work: 3-8-01

County Reference No. 1908140400

Type of Monument: _____ Section Corner Quarter Corner
 _____ Bench Mark _____ Other _____

Your Description and Observation of Monument Found (Be Specific):
 FOUND STD BLM CAP ALONG A EAST-WEST FENCE

Description of Monument, Reference Monument or Accessories Established by You to Perpetuate the Location of this Point:

SET A #4 REBAR EAST, NORTH, AND TWO WEST OF THE MONUMENT

Sketch showing Relative Location of Monument Accessories and Two Reference Points Stating Whether Found or Set. Show Supporting and/or Contradictory Evidence where Applicable. Include North Arrow.

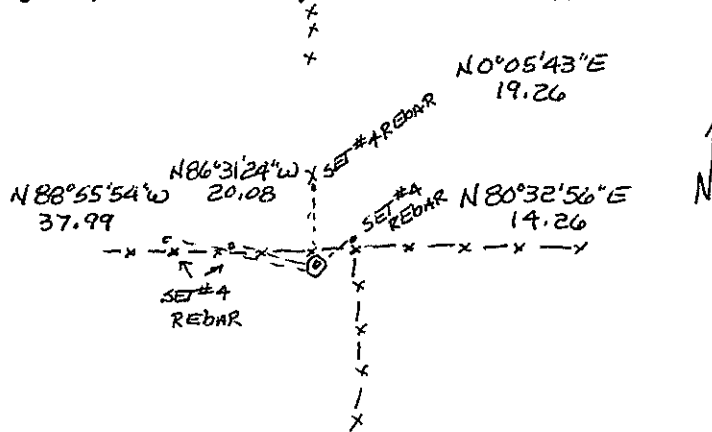

Certification:

Firm name and/or Surveyor: Johansen & Tuttle Eng.
 Address: 90 S. 100 E. Castle Dale, Utah 84513 Phone: (435) 381-2523

This is to certify that I was in responsible charge of the surveying work described in this record and that to the best of my knowledge the information presented herein is true and correct.

Location Diagram:

Section: 18
 Township: 19S
 Range: 8E

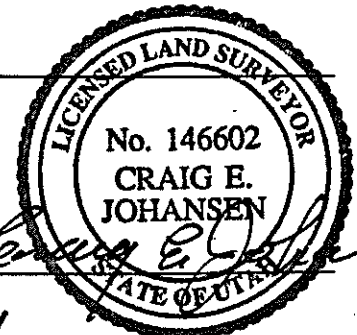
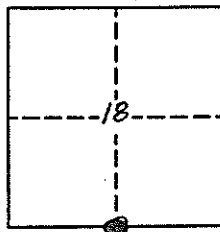

Date 11-30-01