

EMERY COUNTY LAND SURVEY MONUMENT RECORD

Date of field work: 11-19-02

County Reference No. 2016200400

Type of Monument: Section Corner Quarter Corner
 Bench Mark Other _____

Your Description and Observation of Monument Found (Be Specific):

*ORIGINAL ROCK BURIED IN A MOUND OF STONE W/ 4" EXPOSED.
 ROCK IS MARKED W/ 19/20 ON WEST SIDE ; 18/17 ON EAST SIDE
 X MARKED ON TOP*

Description of Monument, Reference Monument or Accessories Established by You to Perpetuate the Location of this Point: *SET 4 #4 REBAR @ N, S, E, W.*

Sketch showing Relative Location of Monument Accessories and Two Reference Points Stating Whether Found or Set. Show Supporting and/or Contradictory Evidence where Applicable. Include North Arrow.

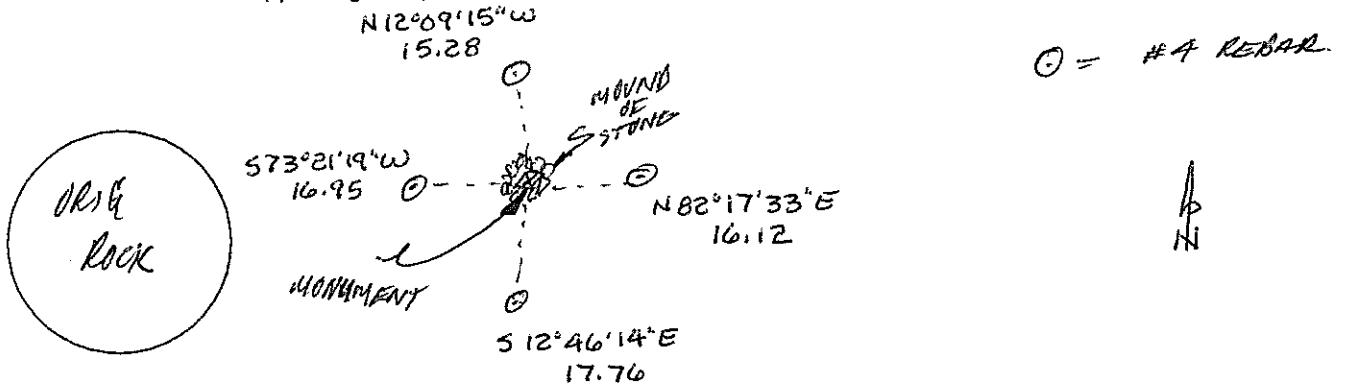

Certification:

Firm name and/or Surveyor: Johansen & Tuttle Eng.
 Address: 90 S. 100 E. Castle Dale, Utah 84513 Phone: (435) 381-2523

This is to certify that I was in responsible charge of the surveying work described in this record and that to the best of my knowledge the information presented herein is true and correct.

Location Diagram:
 Section: 20
 Township: 20S
 Range: 16E

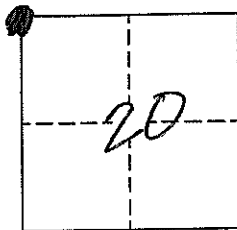

Craig E. Johansen

 Date 11-27-02