

# EMERY COUNTY LAND SURVEY MONUMENT RECORD

Date of field work: 11-17-04

County Reference No. 2106400296

Type of Monument: X Section Corner      \_\_\_\_\_ Quarter Corner  
 \_\_\_\_\_ Bench Mark                                      \_\_\_\_\_ Other \_\_\_\_\_

Your Description and Observation of Monument Found ( Be Specific ):

1918 USGLOS CAP 12" ABOVE GROUND WITH A FOREST SERVICE SIGN TO THE WEST AND NORTH

Description of Monument, Reference Monument or Accessories Established by You to Perpetuate the Location of this Point: SET A #4 REBAR AS SHOWN BELOW

Sketch showing Relative Location of Monument Accessories and Two Reference Points Stating Whether Found or Set. Show Supporting and/or Contradictory Evidence where Applicable. Include North Arrow.

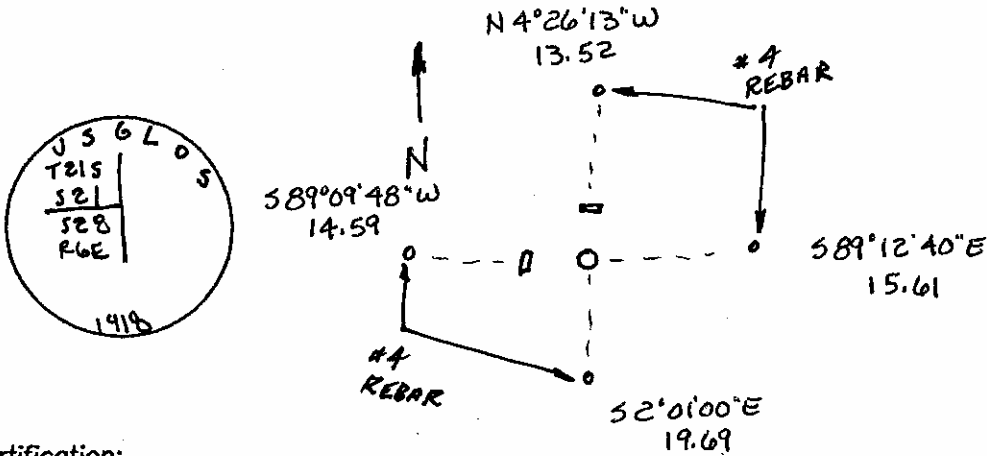

Certification:

Firm name and/or Surveyor: Johansen & Tuttle Eng.

Address: 90 S. 100 E. Castle Dale, Utah 84513 Phone: (435) 381-2523

This is to certify that I was in responsible charge of the surveying work described in this record and that to the best of my knowledge the information presented herein is true and correct.

Location Diagram:

Section: 21

Township: 21 S

Range: 6 E

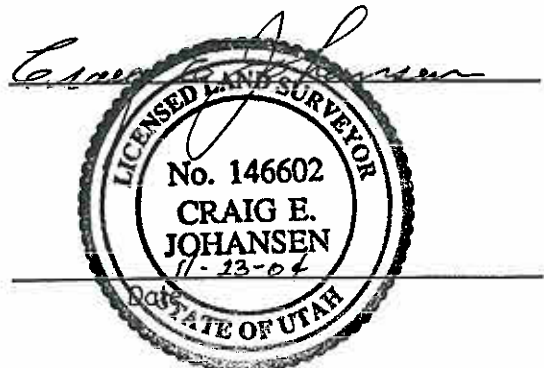
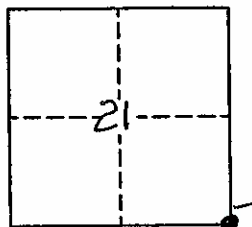

# EMERY COUNTY LAND SURVEY MONUMENT RECORD

Date of field work: 11-15-04

County Reference No. 2106400336

Type of Monument:                     Section Corner            X Quarter Corner  
             Bench Mark                                     Other                                 

Your Description and Observation of Monument Found ( Be Specific ):  
 1919 USGLOS CAP @ GROUND LEVEL WITH A FOREST SERVICE SIGN TO THE WEST  
 AND TO THE SOUTH

Description of Monument, Reference Monument or Accessories Established by You to Perpetuate the  
 Location of this Point: SET 4 #4 REBAR AS SHOWN BELOW

Sketch showing Relative Location of Monument Accessories and Two Reference Points Stating Whether  
 Found or Set. Show Supporting and/or Contradictory Evidence where Applicable. Include North Arrow.

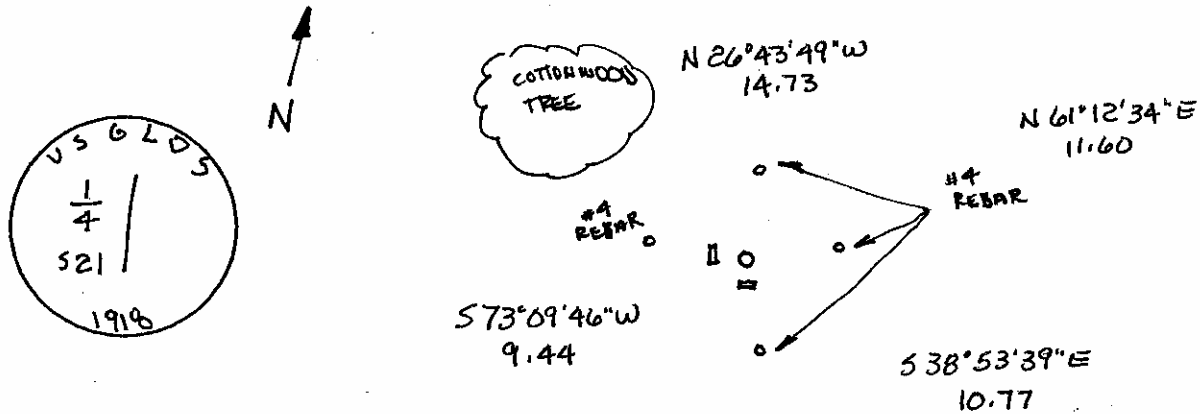

**Certification:**

Firm name and/or Surveyor: Johansen & Tuttle Eng.  
 Address: 90 S. 100 E. Castle Dale, Utah 84513 Phone: (435) 381-2523

This is to certify that I was in responsible charge of the surveying work described in this record and that to the best of my knowledge the information presented herein is true and correct.

**Location Diagram:**

Section: 21  
 Township: 21 S  
 Range: 6 E

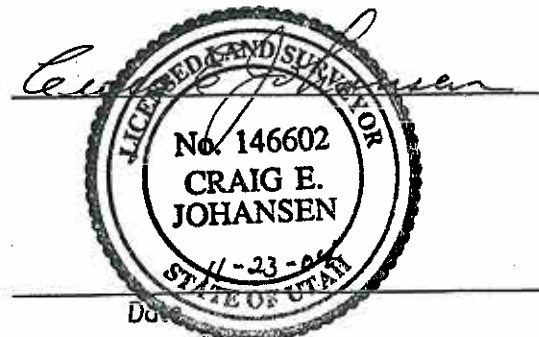
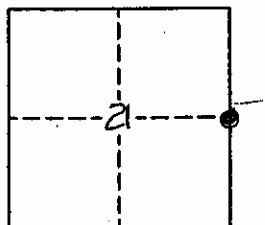

# EMERY COUNTY LAND SURVEY MONUMENT RECORD

Date of field work: 11-18-04

County Reference No. 2106 <sup>4003526</sup> ~~500360~~

Type of Monument:          Section Corner          Quarter Corner  
         Bench Mark   ✓   Other   1/16  

Your Description and Observation of Monument Found ( Be Specific ):  
 1996 FOREST SERVICE CAP IN A STONE MOUND WITH FOREST SERVICE SIGNS TO  
 THE NORTH AND WEST

Description of Monument, Reference Monument or Accessories Established by You to Perpetuate the  
 Location of this Point: SET 4 #4 REBAR AS SHOWN BELOW.

Sketch showing Relative Location of Monument Accessories and Two Reference Points Stating Whether  
 Found or Set. Show Supporting and/or Contradictory Evidence where Applicable. Include North Arrow.

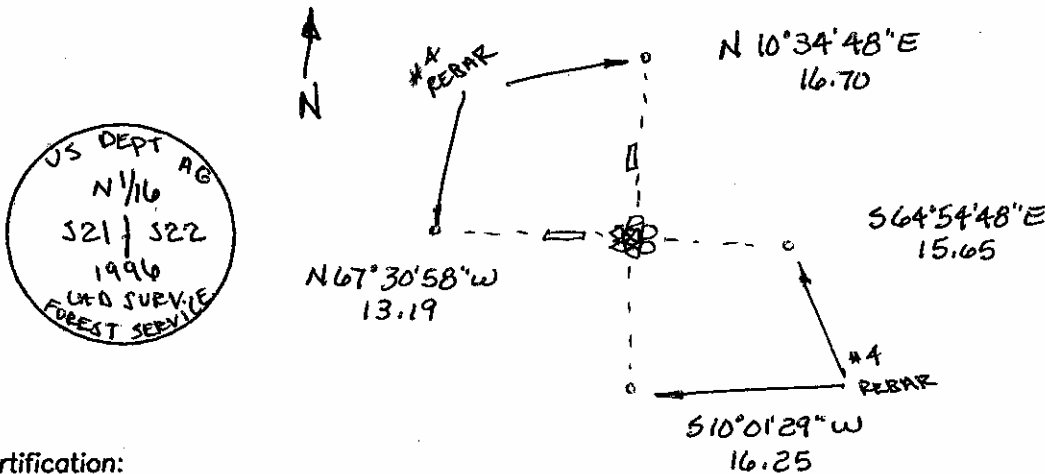

Certification:

Firm name and/or Surveyor: Johansen & Tuttle Eng.  
 Address: 90 S. 100 E. Castle Dale, Utah 84513 Phone: (435) 381-2523

This is to certify that I was in responsible charge of the surveying work described in this record and that to the best of my knowledge the information presented herein is true and correct.

Location Diagram:  
 Section:   21    
 Township:   21S    
 Range:   6E  

