

# EMERY COUNTY LAND SURVEY MONUMENT RECORD

Date of field work: 7-10-03

County Reference No. 2117400300

Type of Monument:  Section Corner  
 Bench Mark

Quarter Corner  
 Other \_\_\_\_\_

Your Description and Observation of Monument Found ( Be Specific ):

4" x 4" POST 18" ABOVE GROUND WITH SMALL MOUND OF STONE

Description of Monument, Reference Monument or Accessories Established by You to Perpetuate the Location of this Point: SET 4 #4 REBAR AS SHOWN

Sketch showing Relative Location of Monument Accessories and Two Reference Points Stating Whether Found or Set. Show Supporting and/or Contradictory Evidence where Applicable. Include North Arrow.

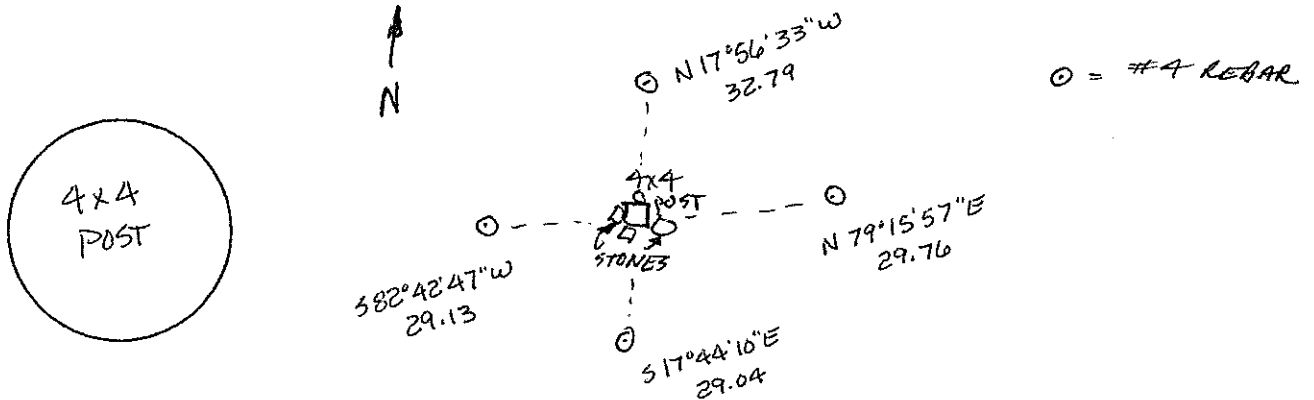

Certification:

Firm name and/or Surveyor: Johansen & Tuttle Eng.

Address: 90 S. 100 E. Castle Dale, Utah 84513

Phone: (435) 381-2523

This is to certify that I was in responsible charge of the surveying work described in this record and that to the best of my knowledge the information presented herein is true and correct.

Location Diagram:

Section: 22

Township: 21S

Range: 17E

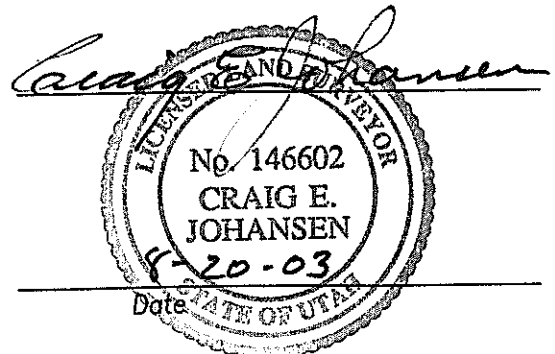
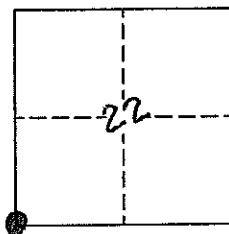

# EMERY COUNTY LAND SURVEY MONUMENT RECORD

Date of field work: 7-10-03

County Reference No. 2117400340

Type of Monument:            Section Corner         Quarter Corner  
           Bench Mark            Other                                   

Your Description and Observation of Monument Found ( Be Specific ):  
4" x 4" POST 1' ABOVE GROUND WITH 4" x 4" POST ALONGSIDE

Description of Monument, Reference Monument or Accessories Established by You to Perpetuate the Location of this Point: SET 4 #4 REBAR AS SHOWN

Sketch showing Relative Location of Monument Accessories and Two Reference Points Stating Whether Found or Set. Show Supporting and/or Contradictory Evidence where Applicable. Include North Arrow.

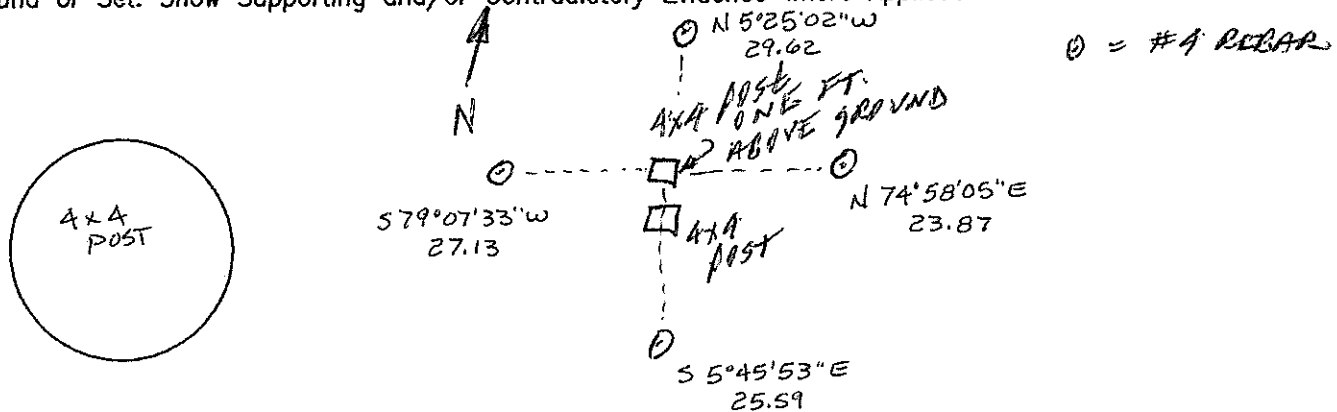

Certification:

Firm name and/or Surveyor: Johansen & Tuttle Eng.  
 Address: 90 S. 100 E. Castle Dale, Utah 84513 Phone: (435) 381-2523

This is to certify that I was in responsible charge of the surveying work described in this record and that to the best of my knowledge the information presented herein is true and correct.

Location Diagram:

Section: 22  
 Township: 21S  
 Range: 17E

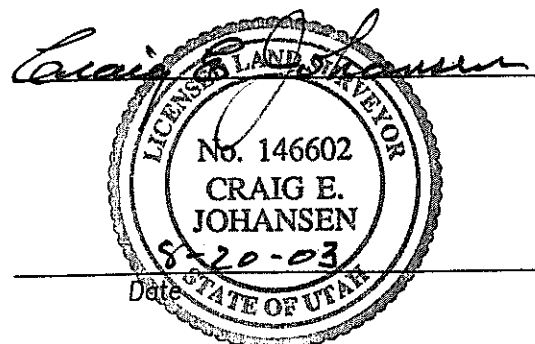
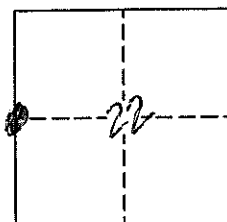

# EMERY COUNTY LAND SURVEY MONUMENT RECORD

Date of field work: 7-30-03

County Reference No. 2117440300

Type of Monument:  Section Corner  Quarter Corner  
 Bench Mark  Other \_\_\_\_\_

Your Description and Observation of Monument Found ( Be Specific ):  
SET EM. CO. ALUM. CAP

Description of Monument, Reference Monument or Accessories Established by You to Perpetuate the Location of this Point: SET A #4 REBAR AS SHOWN  
BUILT STONE MOUNDS AROUND CAP

Sketch showing Relative Location of Monument Accessories and Two Reference Points Stating Whether Found or Set. Show Supporting and/or Contradictory Evidence where Applicable. Include North Arrow.

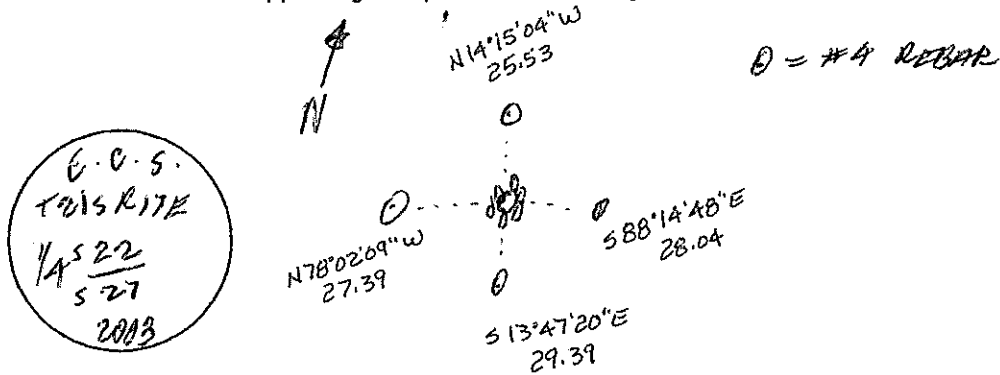

Certification:

Firm name and/or Surveyor: Johansen & Tuttle Eng.  
 Address: 90 S. 100 E. Castle Dale, Utah 84513 Phone: (435) 381-2523

This is to certify that I was in responsible charge of the surveying work described in this record and that to the best of my knowledge the information presented herein is true and correct.

Location Diagram:  
 Section: 22  
 Township: 21S  
 Range: 17E

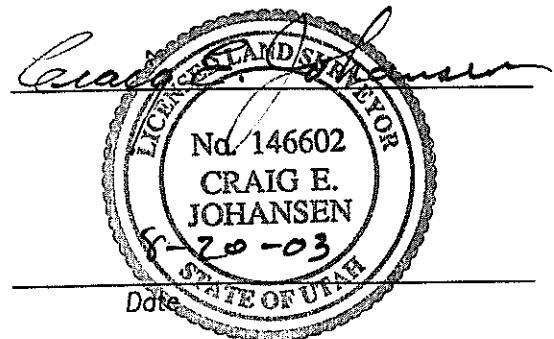
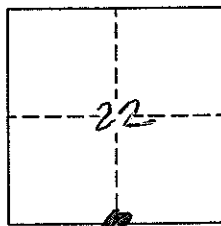

# EMERY COUNTY LAND SURVEY MONUMENT RECORD

Date of field work: 7-30-03

County Reference No. 2117500340

Type of Monument:  Section Corner  Quarter Corner  
 Bench Mark  Other \_\_\_\_\_

Your Description and Observation of Monument Found ( Be Specific ):

*SET EM. CO. SURVEYS CAP*

Description of Monument, Reference Monument or Accessories Established by You to Perpetuate the Location of this Point: *SET A #4 REBAR AS SHOWN*

*BUILT STONE MOUND AROUND CAP*

Sketch showing Relative Location of Monument Accessories and Two Reference Points Stating Whether Found or Set. Show Supporting and/or Contradictory Evidence where Applicable. Include North Arrow.

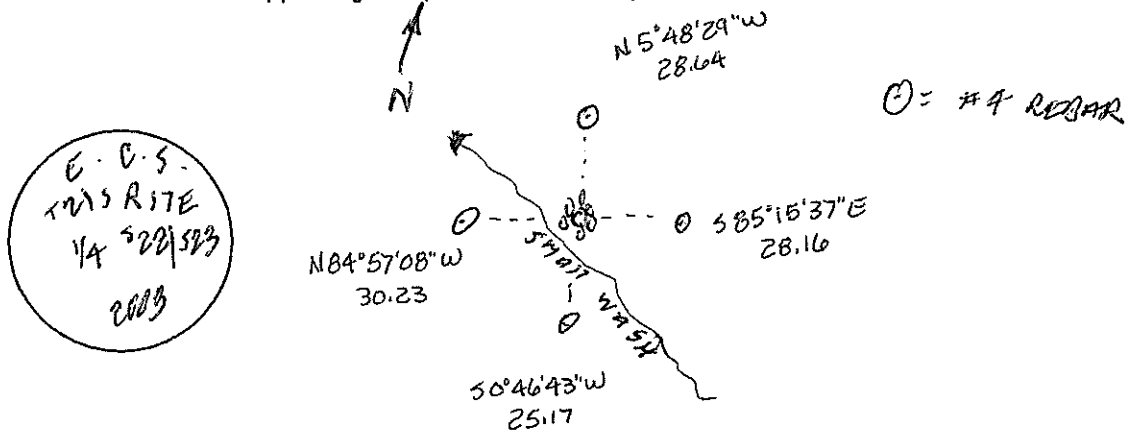

Certification:

Firm name and/or Surveyor: Johansen & Tuttle Eng.

Address: 90 S. 100 E. Castle Dale, Utah 84513 Phone: (435) 381-2523

This is to certify that I was in responsible charge of the surveying work described in this record and that to the best of my knowledge the information presented herein is true and correct.

Location Diagram:

Section: 22  
 Township: 21S  
 Range: 17E

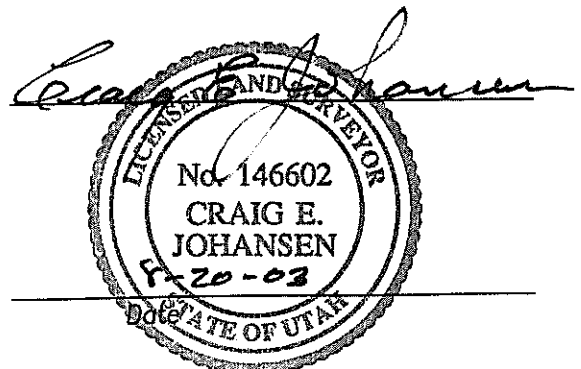
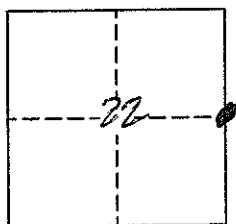

# EMERY COUNTY LAND SURVEY MONUMENT RECORD

Date of field work: 7-30-03

County Reference No. 2117500400

Type of Monument:  Section Corner  Quarter Corner  
 Bench Mark  Other \_\_\_\_\_

Your Description and Observation of Monument Found ( Be Specific ):

SET EM. CO. SURVEYS UAA

Description of Monument, Reference Monument or Accessories Established by You to Perpetuate the Location of this Point: SET A #4 REBAR AS SHOWN

BUILT STONE MOUND AROUND UAA

Sketch showing Relative Location of Monument Accessories and Two Reference Points Stating Whether Found or Set. Show Supporting and/or Contradictory Evidence where Applicable. Include North Arrow.

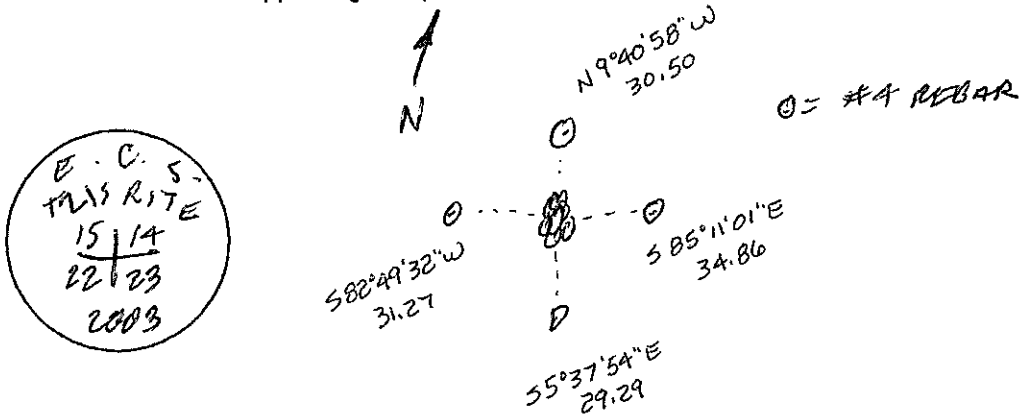

Certification:

Firm name and/or Surveyor: Johansen & Tuttle Eng.

Address: 90 S. 100 E. Castle Dale, Utah 84513 Phone: (435) 381-2523

This is to certify that I was in responsible charge of the surveying work described in this record and that to the best of my knowledge the information presented herein is true and correct.

Location Diagram:

Section: 22  
 Township: 25S  
 Range: 17E

