

EMERY COUNTY LAND SURVEY MONUMENT RECORD

Date of field work: 11-17-04

County Reference No. 2106400300

Type of Monument: X Section Corner _____ Quarter Corner
 _____ Bench Mark _____ Other _____

Your Description and Observation of Monument Found (Be Specific):
 1918 USGLOS CAP 15" ABOVE GROUND IN A STONE MOUND.
 A FOREST SERVICE SIGN IS ON THE NORTH SIDE OF CAP

Description of Monument, Reference Monument or Accessories Established by You to Perpetuate the Location of this Point: SET A #4 REBAR AS SHOWN BELOW

Sketch showing Relative Location of Monument Accessories and Two Reference Points Stating Whether Found or Set. Show Supporting and/or Contradictory Evidence where Applicable. Include North Arrow.

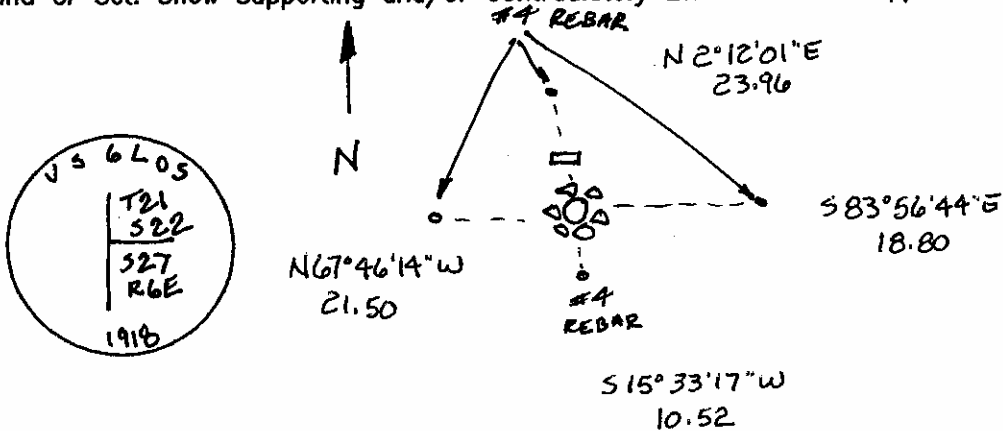

Certification:

Firm name and/or Surveyor: Johansen & Tuttle Eng.
 Address: 90 S. 100 E. Castle Dale, Utah 84513 Phone: (435) 381-2523

This is to certify that I was in responsible charge of the surveying work described in this record and that to the best of my knowledge the information presented herein is true and correct.

Location Diagram:
 Section: 22
 Township: 21S
 Range: 6E

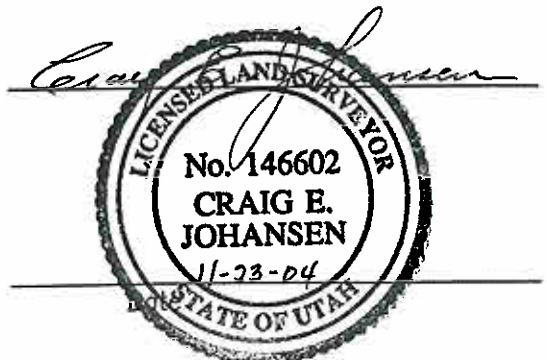
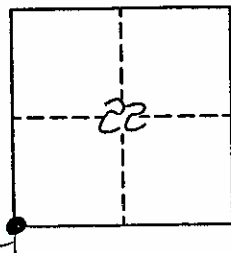

EMERY COUNTY LAND SURVEY MONUMENT RECORD

Date of field work: 11-15-04

County Reference No. 2106400340

Type of Monument: _____ Section Corner Quarter Corner
_____ Bench Mark _____ Other _____

Your Description and Observation of Monument Found (Be Specific):

1918 USGLOS CAP BURIED 8" WITH A FOREST SERVICE SIGN POST ON THE NORTH SIDE

Description of Monument, Reference Monument or Accessories Established by You to Perpetuate the Location of this Point: SET 4 #4 REBAR AS SHOWN BELOW

Sketch showing Relative Location of Monument Accessories and Two Reference Points Stating Whether Found or Set. Show Supporting and/or Contradictory Evidence where Applicable. Include North Arrow.

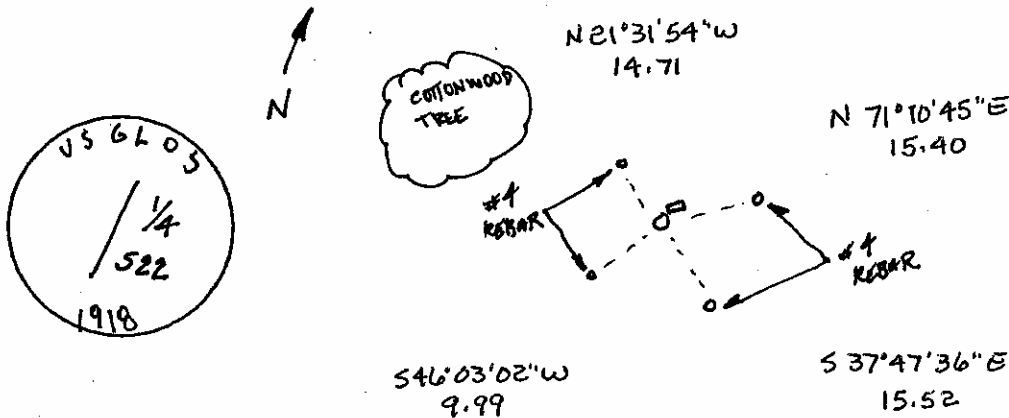

Certification:

Firm name and/or Surveyor: Johansen & Tuttle Eng.

Address: 90 S. 100 E. Castle Dale, Utah 84513 Phone: (435) 381-2523

This is to certify that I was in responsible charge of the surveying work described in this record and that to the best of my knowledge the information presented herein is true and correct.

Location Diagram:

Section: 22

Township: 21 S

Range: 6 E

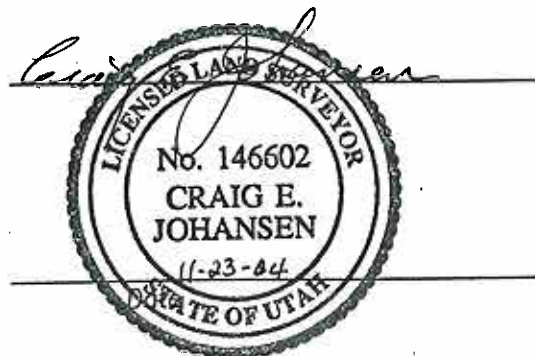
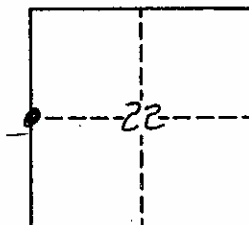

EMERY COUNTY LAND SURVEY MONUMENT RECORD

Date of field work: 11-15-04

County Reference No. 2106440300

Type of Monument: _____ Section Corner
_____ Bench Mark

Quarter Corner
_____ Other _____

Your Description and Observation of Monument Found (Be Specific):
1918 USGLOS CAP 10" ABOVE GROUND

Description of Monument, Reference Monument or Accessories Established by You to Perpetuate the Location of this Point: SET 4 #4 REBAR AS SHOWN BELOW

Sketch showing Relative Location of Monument Accessories and Two Reference Points Stating Whether Found or Set. Show Supporting and/or Contradictory Evidence where Applicable. Include North Arrow.

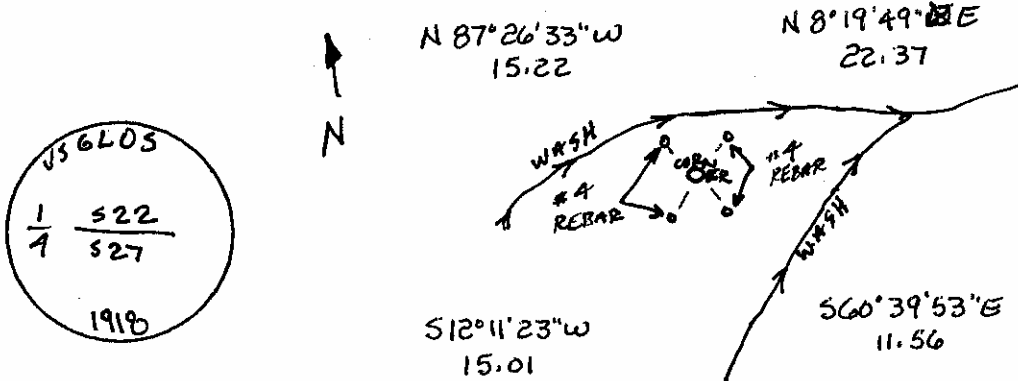

Certification:

Firm name and/or Surveyor: Johansen & Tuttle Eng.

Address: 90 S. 100 E. Castle Dale, Utah 84513 Phone: (435) 381-2523

This is to certify that I was in responsible charge of the surveying work described in this record and that to the best of my knowledge the information presented herein is true and correct.

Location Diagram:

Section: 22
Township: 21S
Range: 6E

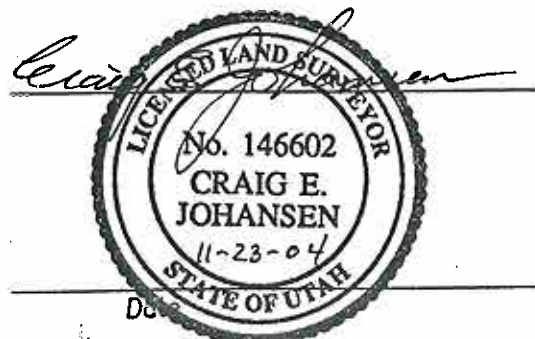
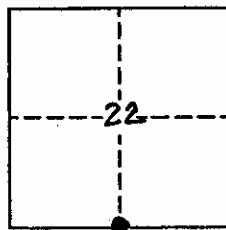

EMERY COUNTY LAND SURVEY MONUMENT RECORD

Date of field work: 10-19-04

County Reference No. 2106 500 300

Type of Monument: Section Corner
 Bench Mark

Quarter Corner
 Other _____

Your Description and Observation of Monument Found (Be Specific):
1978 BLM CAP 4" ABOVE GROUND WITH A STONE MOUND ON THE SOUTH SIDE OF MONUMENT

Description of Monument, Reference Monument or Accessories Established by You to Perpetuate the Location of this Point: SET 4 #5 REBAR (RBR) AS SHOWN BELOW.

Sketch showing Relative Location of Monument Accessories and Two Reference Points Stating Whether Found or Set. Show Supporting and/or Contradictory Evidence where Applicable. Include North Arrow.

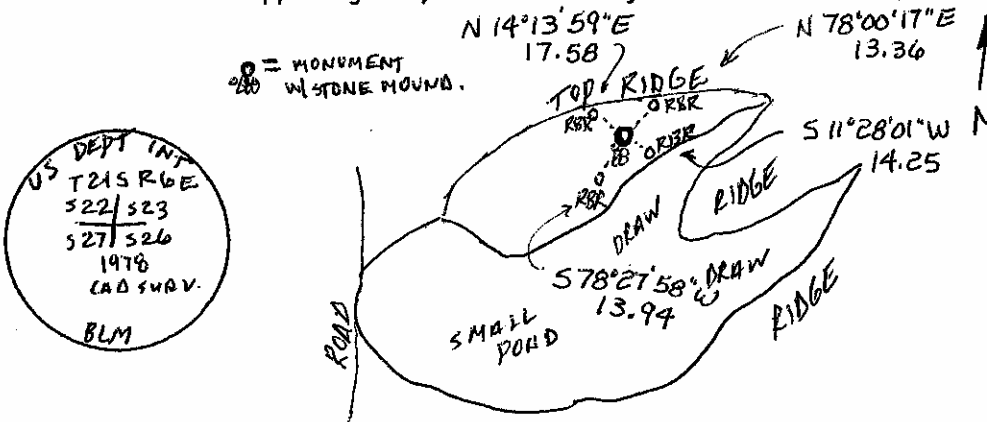

Certification:

Firm name and/or Surveyor: Johansen & Tuttle Eng.

Address: 90 S. 100 E. Castle Dale, Utah 84513 Phone: (435) 381-2523

This is to certify that I was in responsible charge of the surveying work described in this record and that to the best of my knowledge the information presented herein is true and correct.

Location Diagram:

Section: 22
 Township: 21S
 Range: 6E

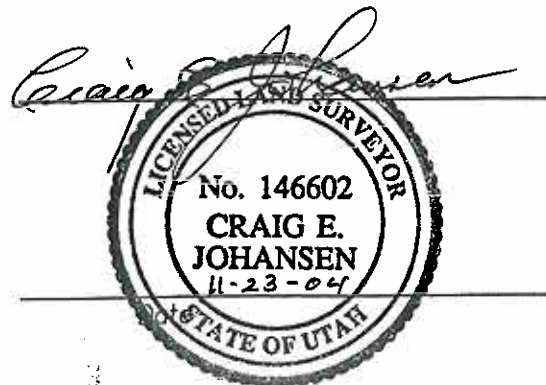
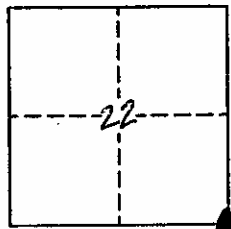

EMERY COUNTY LAND SURVEY MONUMENT RECORD

Date of field work: 10-19-04

County Reference No. 2106500340

Type of Monument: _____ Section Corner
_____ Bench Mark

Quarter Corner
_____ Other _____

Your Description and Observation of Monument Found (Be Specific):

1918 USGLO CAP BURIED 8" UNDER GROUND WITH A STEEL FENCE POST DRIVEN ALONG SIDE.

Description of Monument, Reference Monument or Accessories Established by You to Perpetuate the Location of this Point: SET 4 #5 REBAR AS SHOWN BELOW.

Sketch showing Relative Location of Monument Accessories and Two Reference Points Stating Whether Found or Set. Show Supporting and/or Contradictory Evidence where Applicable. Include North Arrow.

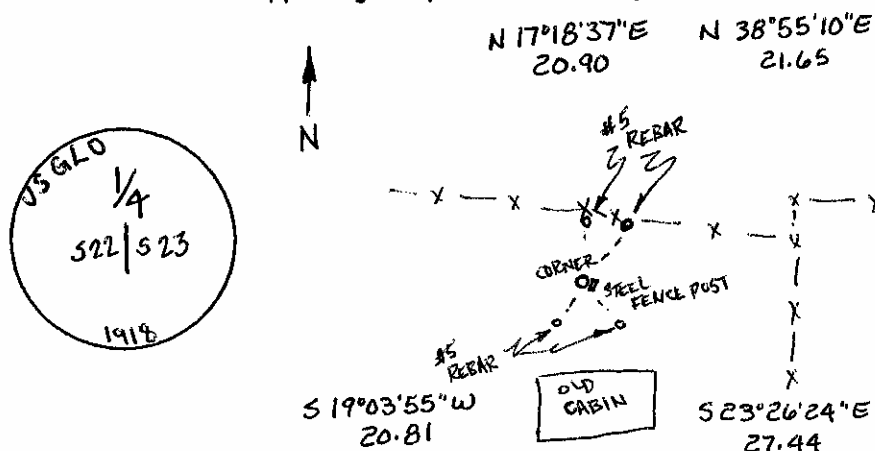

Certification:

Firm name and/or Surveyor: Johansen & Tuttle Eng.

Address: 90 S. 100 E. Castle Dale, Utah 84513 Phone: (435) 381-2523

This is to certify that I was in responsible charge of the surveying work described in this record and that to the best of my knowledge the information presented herein is true and correct.

Location Diagram:

Section: 22
Township: 21S
Range: 6E

