





# EMERY COUNTY LAND SURVEY MONUMENT RECORD

Date of field work: 11-17-04

County Reference No. 2106600300

Type of Monument:             Section Corner                                     Quarter Corner  
     Bench Mark     Other \_\_\_\_\_

Your Description and Observation of Monument Found ( Be Specific ):  
1918 USGLOS CAP 12" ABOVE GROUND WITH A STONE TO THE NORTHEAST

Description of Monument, Reference Monument or Accessories Established by You to Perpetuate the Location of this Point: SET A #4 REBAR AS SHOWN BELOW

Sketch showing Relative Location of Monument Accessories and Two Reference Points Stating Whether Found or Set. Show Supporting and/or Contradictory Evidence where Applicable. Include North Arrow.

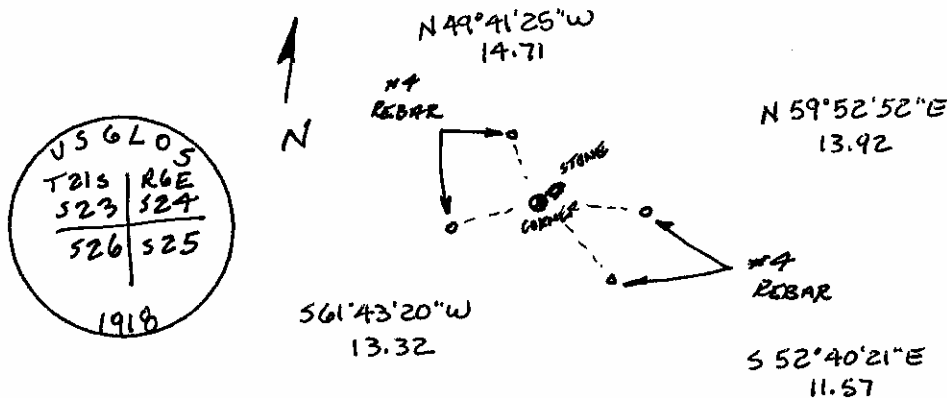

Certification:

Firm name and/or Surveyor: Johansen & Tuttle Eng.  
 Address: 90 S. 100 E. Castle Dale, Utah 84513 Phone: (435) 381-2523

This is to certify that I was in responsible charge of the surveying work described in this record and that to the best of my knowledge the information presented herein is true and correct.

Location Diagram:  
 Section: 23  
 Township: 21S  
 Range: 6E

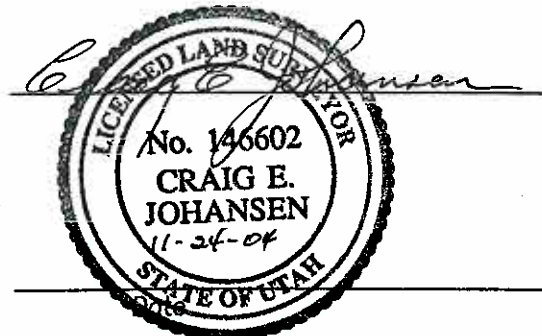
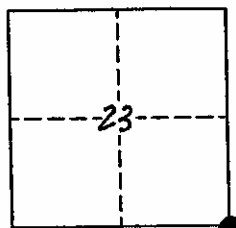

# EMERY COUNTY LAND SURVEY MONUMENT RECORD

Date of field work: 11-15-04

County Reference No. 2106600340

Type of Monument:  Section Corner  Quarter Corner  
 Bench Mark  Other \_\_\_\_\_

Your Description and Observation of Monument Found ( Be Specific ):  
1918 USGLOS CAP 6" ABOVE GROUND

Description of Monument, Reference Monument or Accessories Established by You to Perpetuate the Location of this Point: SET 4 #4 REBAR AS SHOWN BELOW

Sketch showing Relative Location of Monument Accessories and Two Reference Points Stating Whether Found or Set. Show Supporting and/or Contradictory Evidence where Applicable. Include North Arrow.

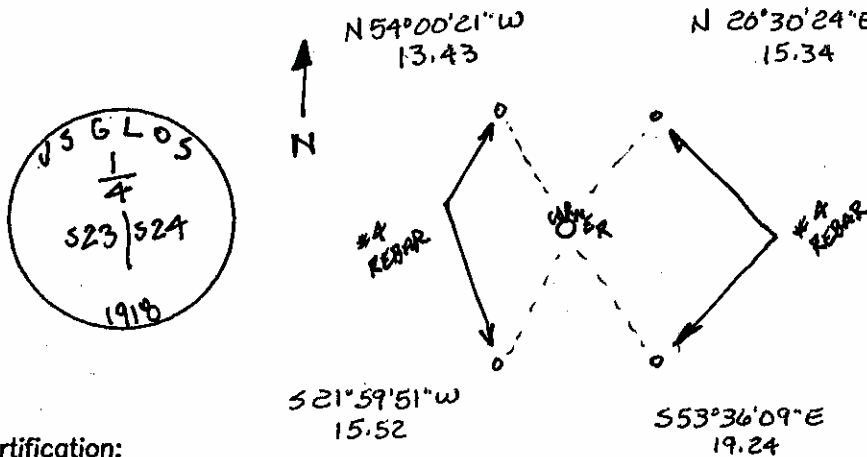

Certification:

Firm name and/or Surveyor: Johansen & Tuttle Eng.  
 Address: 90 S. 100 E. Castle Dale, Utah 84513 Phone: (435) 381-2523

This is to certify that I was in responsible charge of the surveying work described in this record and that to the best of my knowledge the information presented herein is true and correct.

Location Diagram:  
 Section: 23  
 Township: 21S  
 Range: 6E

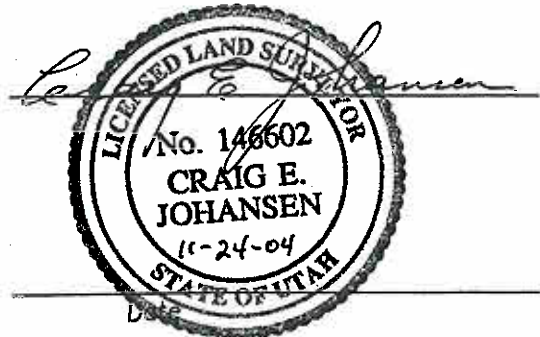
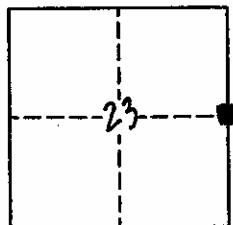

# EMERY COUNTY LAND SURVEY MONUMENT RECORD

Date of field work: 11-15-04

County Reference No. 2106600700

Type of Monument:

Section Corner  
 Bench Mark

Quarter Corner  
 Other \_\_\_\_\_

Your Description and Observation of Monument Found ( Be Specific ):

1918 USGLOS CAP 8" ABOVE GROUND IN A STONE MOUND  
 WITH A CEDAR POST PLANTED ON NORTH SIDE

Description of Monument, Reference Monument or Accessories Established by You to Perpetuate the Location of this Point: SET 4 #4 REBAR AS SHOWN BELOW

Sketch showing Relative Location of Monument Accessories and Two Reference Points Stating Whether Found or Set. Show Supporting and/or Contradictory Evidence where Applicable. Include North Arrow.

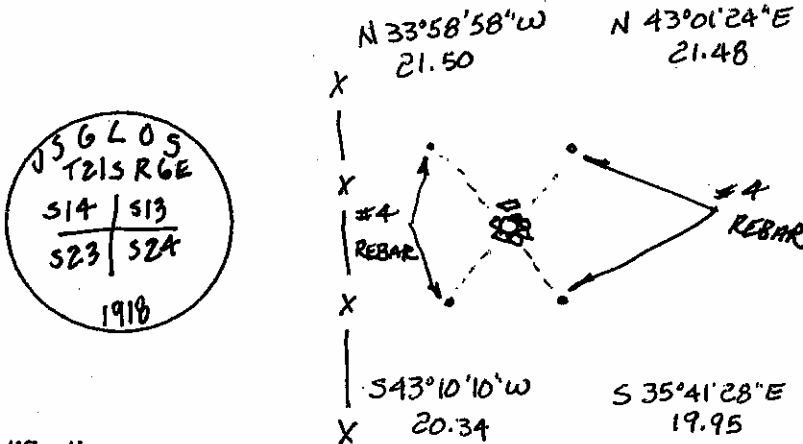

Certification:

Firm name and/or Surveyor: Johansen & Tuttle Eng.

Address: 90 S. 100 E. Castle Dale, Utah 84513 Phone: (435) 381-2523

This is to certify that I was in responsible charge of the surveying work described in this record and that to the best of my knowledge the information presented herein is true and correct.

Location Diagram:

Section: 23  
 Township: 21S  
 Range: 6E

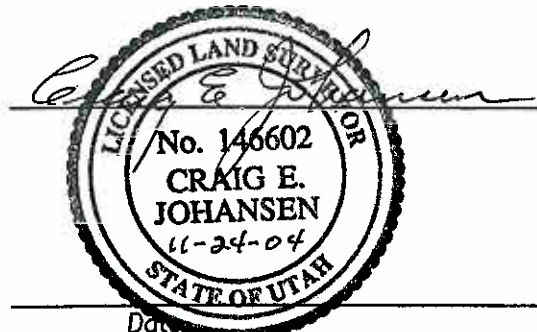
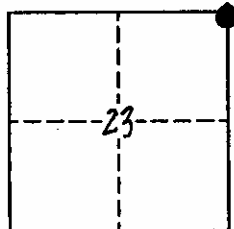

Date: \_\_\_\_\_