

EMERY COUNTY LAND SURVEY MONUMENT RECORD

Date of field work: 11-1-04

County Reference No. 2206540300

Type of Monument: _____ Section Corner Quarter Corner
 _____ Bench Mark _____ Other _____

Your Description and Observation of Monument Found (Be Specific):
1978 BLM CAP 6" ABOVE GROUND

Description of Monument, Reference Monument or Accessories Established by You to Perpetuate the Location of this Point: SET 4 #4 REBAR AS SHOWN BELOW

Sketch showing Relative Location of Monument Accessories and Two Reference Points Stating Whether Found or Set. Show Supporting and/or Contradictory Evidence where Applicable. Include North Arrow.

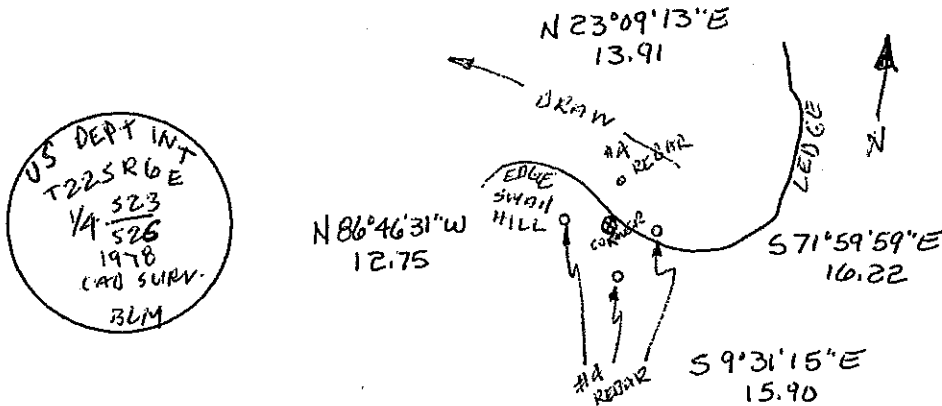

Certification:

Firm name and/or Surveyor: Johansen & Tuttle Eng.

Address: 90 S. 100 E. Castle Dale, Utah 84513 Phone: (435) 381-2523

This is to certify that I was in responsible charge of the surveying work described in this record and that to the best of my knowledge the information presented herein is true and correct.

Location Diagram:

Section: 7B
 Township: 22S
 Range: 6E

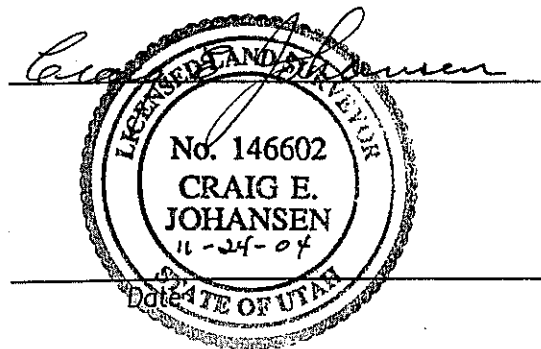
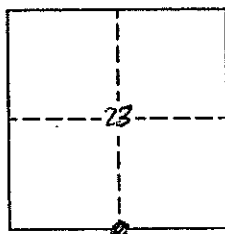

EMERY COUNTY LAND SURVEY MONUMENT RECORD

Date of field work: 10-22-04

County Reference No. 22.06.540400

Type of Monument: Section Corner ✓ Quarter Corner
 Bench Mark Other

Your Description and Observation of Monument Found (Be Specific):
 FOUND 2 REFERENCE MARKERS AS SHOWN BELOW

Description of Monument, Reference Monument or Accessories Established by You to Perpetuate the Location of this Point: SET 2' #4 REBAR AS SHOWN BELOW.
 SET 8" SPIKE AT INTERSECTION OF REF. MARKERS.

Sketch showing Relative Location of Monument Accessories and Two Reference Points Stating Whether Found or Set. Show Supporting and/or Contradictory Evidence where Applicable. Include North Arrow.

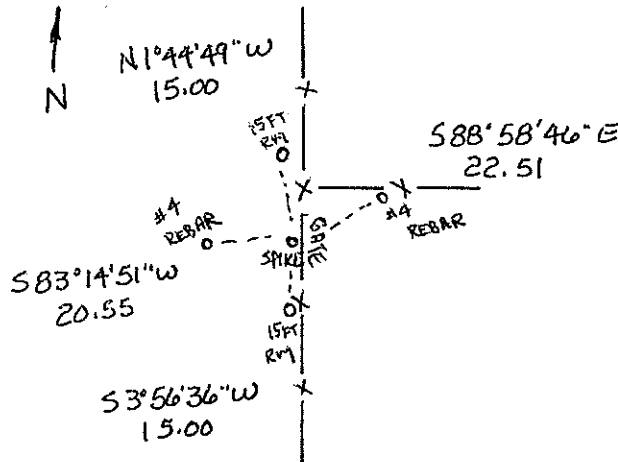
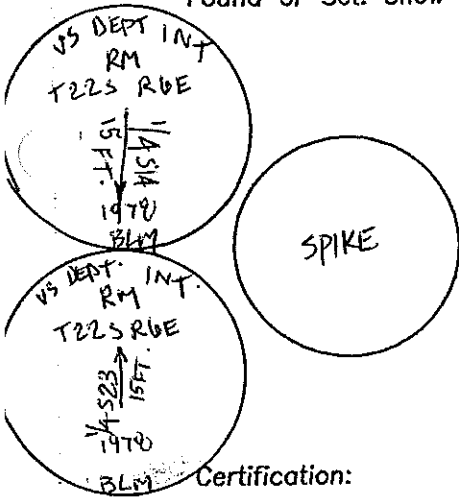

Certification:

Firm name and/or Surveyor: Johansen & Tuttle Eng.
 Address: 90 S. 100 E. Castle Dale, Utah 84513 Phone: (435) 381-2523

This is to certify that I was in responsible charge of the surveying work described in this record and that to the best of my knowledge the information presented herein is true and correct.

Location Diagram:
 Section: 23
 Township: 22S
 Range: 6E

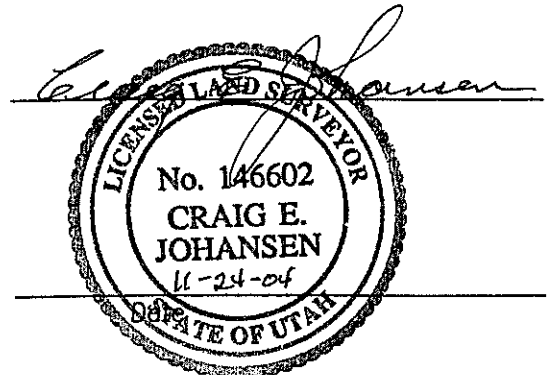
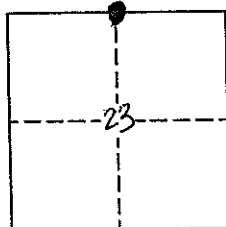

EMERY COUNTY LAND SURVEY MONUMENT RECORD

Date of field work: 11-1-04

County Reference No. 2206560300

Type of Monument: Section Corner Quarter Corner
 Bench Mark Other 1/16

Your Description and Observation of Monument Found (Be Specific):
1978 BLM CAP IN LARGE STONE MOUND

Description of Monument, Reference Monument or Accessories Established by You to Perpetuate the Location of this Point: SET 4 #4 REBAR AS SHOWN BELOW

Sketch showing Relative Location of Monument Accessories and Two Reference Points Stating Whether Found or Set. Show Supporting and/or Contradictory Evidence where Applicable. Include North Arrow.

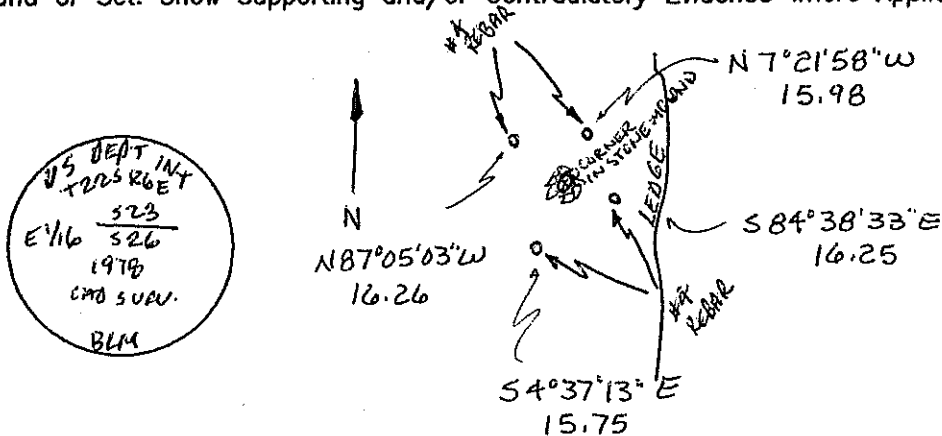

Certification:

Firm name and/or Surveyor: Johansen & Tuttle Eng.
 Address: 90 S. 100 E. Castle Dale, Utah 84513 Phone: (435) 381-2523

This is to certify that I was in responsible charge of the surveying work described in this record and that to the best of my knowledge the information presented herein is true and correct.

Location Diagram:
 Section: 23
 Township: 22S
 Range: 16E

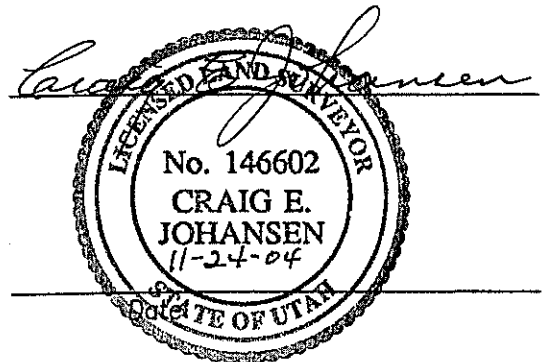
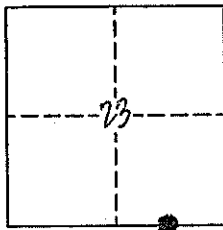

EMERY COUNTY LAND SURVEY MONUMENT RECORD

Date of field work: 11-16-04

County Reference No. 2206600300

Type of Monument: Section Corner
 Bench Mark

Quarter Corner
 Other _____

Your Description and Observation of Monument Found (Be Specific):
1978 BLM CAP IN A LARGE STONE MOUND.

Description of Monument, Reference Monument or Accessories Established by You to Perpetuate the Location of this Point: SET 4 #4 REBAR AS SHOWN BELOW.

Sketch showing Relative Location of Monument Accessories and Two Reference Points Stating Whether Found or Set. Show Supporting and/or Contradictory Evidence where Applicable. Include North Arrow.

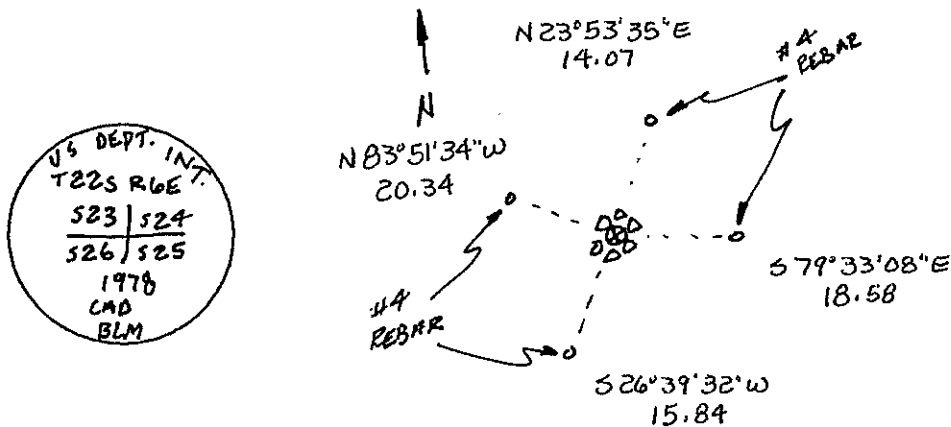

Certification:

Firm name and/or Surveyor: Johansen & Tuttle Eng.

Address: 90 S. 100 E. Castle Dale, Utah 84513 Phone: (435) 381-2523

This is to certify that I was in responsible charge of the surveying work described in this record and that to the best of my knowledge the information presented herein is true and correct.

Location Diagram:
 Section: 23
 Township: 22S
 Range: 6E

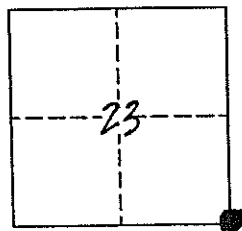

Craig E. Johansen

 Date: 11-24-04

EMERY COUNTY LAND SURVEY MONUMENT RECORD

Date of field work: 11-17-04

County Reference No. 2206600320

Type of Monument: Section Corner Quarter Corner
 Bench Mark X Other 1/16

Your Description and Observation of Monument Found (Be Specific):

FOUND STANDARD BLM BRASS CAP IN ROCK MOUND ON STEEP TALUS SLOPE

Description of Monument, Reference Monument or Accessories Established by You to Perpetuate the Location of this Point:

SET #4 REBAR AS SHOWN

Sketch showing Relative Location of Monument Accessories and Two Reference Points Stating Whether Found or Set. Show Supporting and/or Contradictory Evidence where Applicable. Include North Arrow.

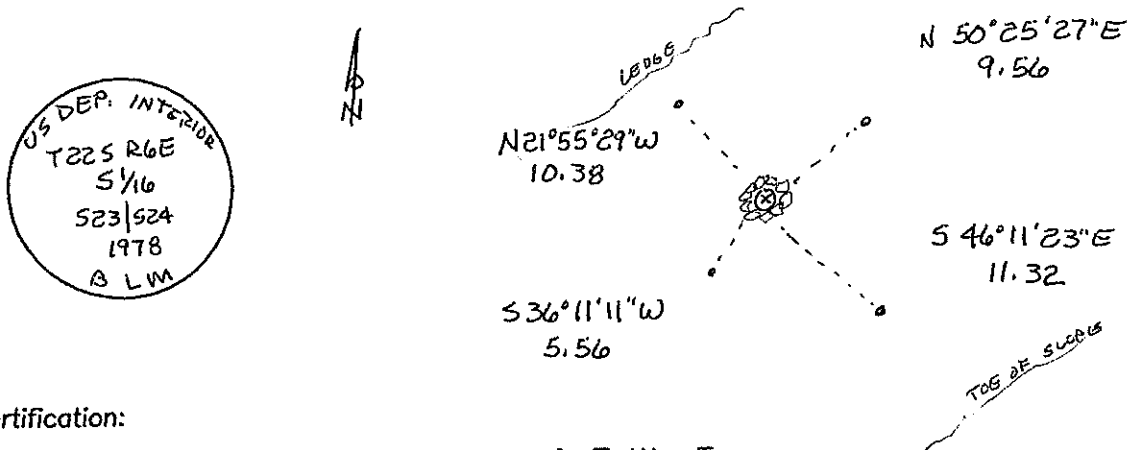

Certification:

Firm name and/or Surveyor: Johansen & Tuttle Eng.

Address: 90 S. 100 E. Castle Dale, Utah 84513 Phone: (435) 381-2523

This is to certify that I was in responsible charge of the surveying work described in this record and that to the best of my knowledge the information presented herein is true and correct.

Location Diagram:

Section: 23

Township: 22 S

Range: 6 E

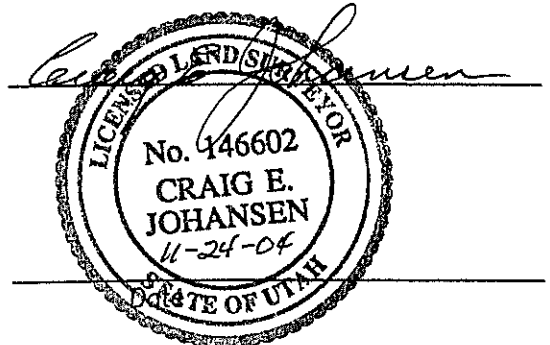
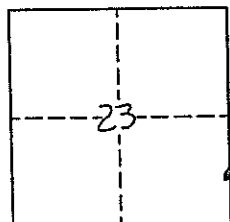

EMERY COUNTY LAND SURVEY MONUMENT RECORD

Date of field work: 11-1-04

County Reference No. 2206600340

Type of Monument: Section Corner ✓ Quarter Corner
 Bench Mark Other

Your Description and Observation of Monument Found (Be Specific):

1970 BLM CAP IN A STONE MOUND

Description of Monument, Reference Monument or Accessories Established by You to Perpetuate the Location of this Point: SET 4 #4 REBAR AS SHOWN BELOW

Sketch showing Relative Location of Monument Accessories and Two Reference Points Stating Whether Found or Set. Show Supporting and/or Contradictory Evidence where Applicable. Include North Arrow.

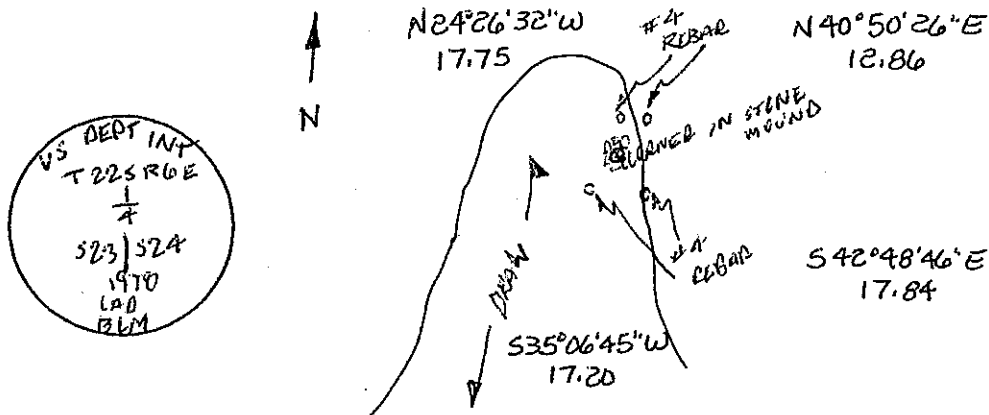

Certification:

Firm name and/or Surveyor: Johansen & Tuttle Eng.

Address: 90 S. 100 E. Castle Dale, Utah 84513 Phone: (435) 381-2523

This is to certify that I was in responsible charge of the surveying work described in this record and that to the best of my knowledge the information presented herein is true and correct.

Location Diagram:

Section: 23

Township: 22S

Range: 6E

