

# EMERY COUNTY LAND SURVEY MONUMENT RECORD

Date of field work: 11-11-02

County Reference No. 2115700340

Type of Monument:            Section Corner   X   Quarter Corner  
           Bench Mark            Other                                   

Your Description and Observation of Monument Found ( Be Specific ):

FOUND STD. 1974 BLM BRASS CAP 8" ABOVE GROUND

Description of Monument, Reference Monument or Accessories Established by You to Perpetuate the Location of this Point:

SET 4, #4 REBAR N.S.E.W OF MONUMENT

Sketch showing Relative Location of Monument Accessories and Two Reference Points Stating Whether Found or Set. Show Supporting and/or Contradictory Evidence where Applicable. Include North Arrow.

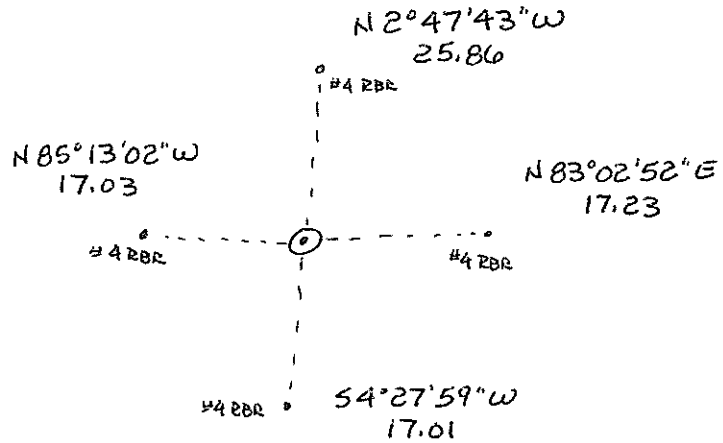
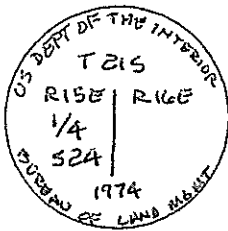

Certification:

Firm name and/or Surveyor: Johansen & Tuttle Eng.  
 Address: 90 S. 100 E. Castle Dale, Utah 84513 Phone: (435) 381-2523

This is to certify that I was in responsible charge of the surveying work described in this record and that to the best of my knowledge the information presented herein is true and correct.

Location Diagram:  
 Section: 24  
 Township: 21 S  
 Range: 15 E

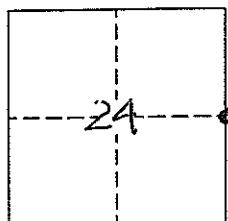

*Craig E. Johansen*  
 \_\_\_\_\_  
11-27-02  
 Date

# EMERY COUNTY LAND SURVEY MONUMENT RECORD

Date of field work: 11-11-02

County Reference No. 2115700400

Type of Monument: X Section Corner  
 \_\_\_\_\_ Bench Mark

\_\_\_\_\_ Quarter Corner  
 \_\_\_\_\_ Other \_\_\_\_\_

Your Description and Observation of Monument Found ( Be Specific ):

FOUND STD. 1974 BLM BRASS CAP w/ STEEL FENCE POST ALONGSIDE

Description of Monument, Reference Monument or Accessories Established by You to Perpetuate the Location of this Point:

SET 4, #4 REBAR N, S, E, W OF MONUMENT

Sketch showing Relative Location of Monument Accessories and Two Reference Points Stating Whether Found or Set. Show Supporting and/or Contradictory Evidence where Applicable. Include North Arrow.

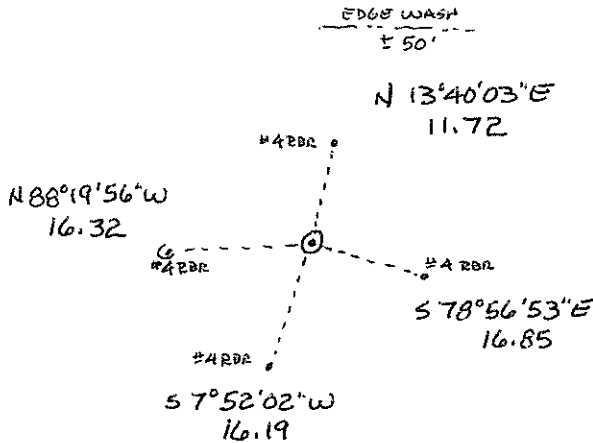
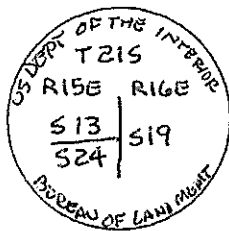

Certification:

Firm name and/or Surveyor: Johansen & Tuttle Eng.

Address: 90 S. 100 E. Castle Dale, Utah 84513 Phone: (435) 381-2523

This is to certify that I was in responsible charge of the surveying work described in this record and that to the best of my knowledge the information presented herein is true and correct.

Location Diagram:

Section: 24  
 Township: 21S  
 Range: 15E

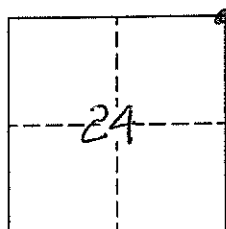

*Craig E. Johansen*  
 LICENSED LAND SURVEYOR  
 No. 146602  
 CRAIG E. JOHANSEN  
 STATE OF UTAH  
11-27-02  
 Date