

EMERY COUNTY LAND SURVEY MONUMENT RECORD

Date of field work: 2-27-01 County Reference No. 1908400200
 Type of Monument: ✓ Section Corner _____ Quarter Corner _____
 _____ Bench Mark _____ Other _____

Your Description and Observation of Monument Found (Be Specific):

FOUND STD. BLM CAP IN A EAST-WEST FENCE

Description of Monument, Reference Monument or Accessories Established by You to Perpetuate the Location of this Point:

SET #4 REBAR NORTH, WEST, SOUTHWEST, AND SOUTHWEST OF THE MONUMENT

Sketch showing Relative Location of Monument Accessories and Two Reference Points Stating Whether Found or Set. Show Supporting and/or Contradictory Evidence where Applicable. Include North Arrow.

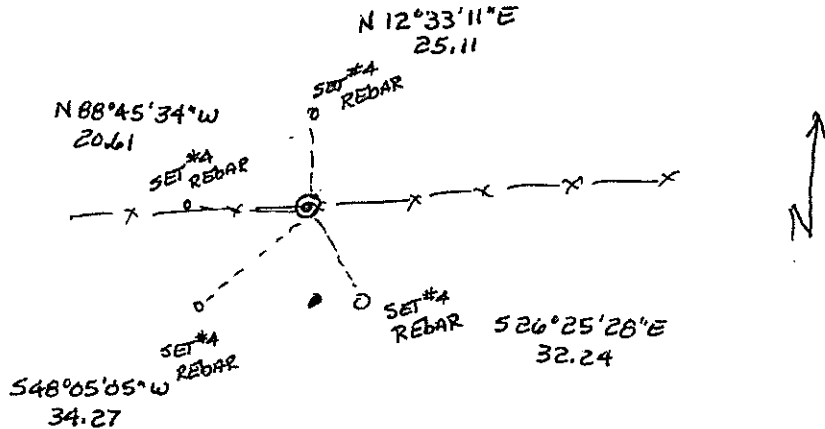
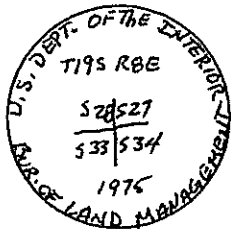

Certification:

Firm name and/or Surveyor: JOHANSEN & TUTTLE ENG. I'
 Address: 90 S 100 E CASTLE DALE UTAH Phone: 435)381-2523

This is to certify that I was in responsible charge of the surveying work described in this record and that to the best of my knowledge the information presented herein is true and correct.

Location Diagram:
 Section: 27
 Township: 19S
 Range: 8E

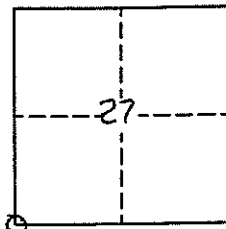

Craig E. Johansen
 11-30-01
 Date _____

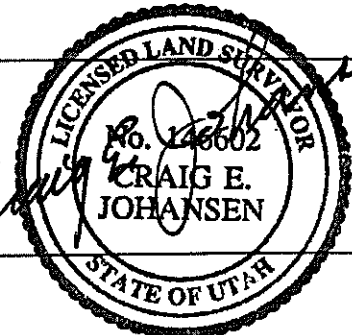

UTAH LAND SURVEY MONUMENT RECORD

County EMERY

County Reference No. 1908 400 340

1. Date of Field Work: 3-2-01

2. Type of Monument:

(Check one)

Section Corner

Bench Mark

Quarter Corner

Other

3. Your Description and Observation of Monument Found (Be Specific):

FOUND STD BLM CAP ALONG A NORTH-SOUTH FENCE

4. Description of Monument, Reference Monument or Accessories Established by You to Perpetuate the Location of this Point:

SET #2 #4 REBARS NORTH, AND SOUTH OF THE MONUMENT

5. Sketch showing Relative Location of Monument Accessories and Two Reference Points Stating Whether Found or Set. Show Supporting and/or Contradictory Evidence where Applicable. Include North Arrow.

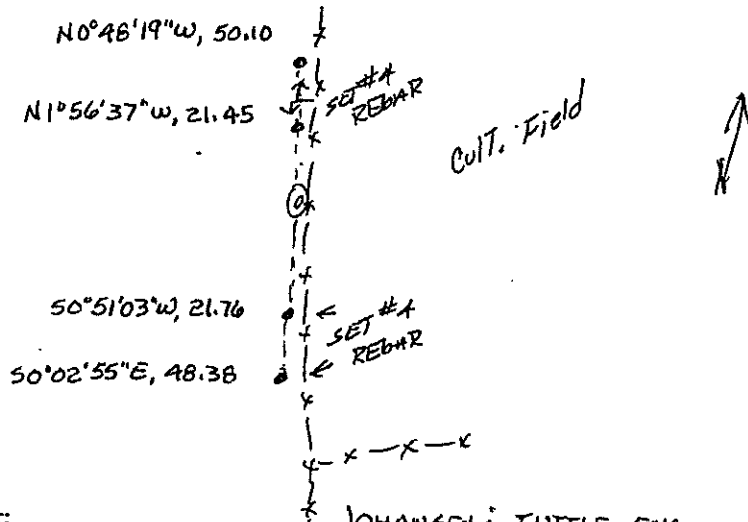

6. Certification:

Firm Name and/or Surveyor:

Address:

JOHANSEN & TUTTLE ENG Phone: 435) 381-2523
90 S 100 E CASTLE DALE UTAH

This is to certify that I was in responsible charge of the surveying work described in this record and that to the best of my knowledge the information presented herein is true and correct.

7. Location Diagram:

8. Section: 27

9. Township: 19 S

10. Range: 8 E

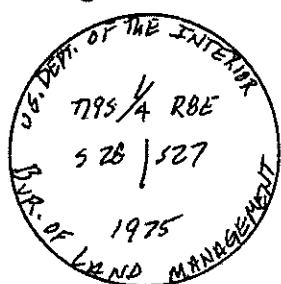
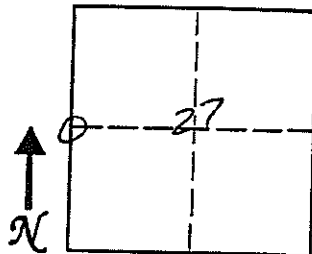

11. Monument Inscription:

12. Diagram Coordinate from Master Index for Townships: _____

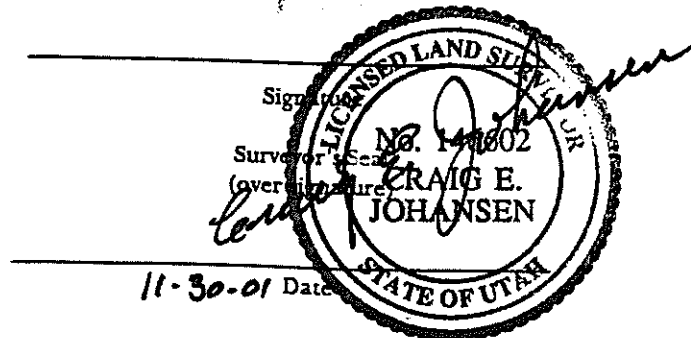

11-30-01 Date

Report one monument per form.
 Type or use permanent black ink.
 Fill in all items.

EMERY COUNTY LAND SURVEY MONUMENT RECORD

Date of field work: 2-27-01 County Reference No. 1908440200

Type of Monument: _____ Section Corner Quarter Corner
 _____ Bench Mark _____ Other _____

Your Description and Observation of Monument Found (Be Specific):

FOUND STD BLM CAP

Description of Monument, Reference Monument or Accessories Established by You to Perpetuate the Location of this Point:

SET #4 REBAR WEST, NORTHWEST, NORTH, AND NORTHEAST OF THE MONUMENT

Sketch showing Relative Location of Monument Accessories and Two Reference Points Stating Whether Found or Set. Show Supporting and/or Contradictory Evidence where Applicable. Include North Arrow.

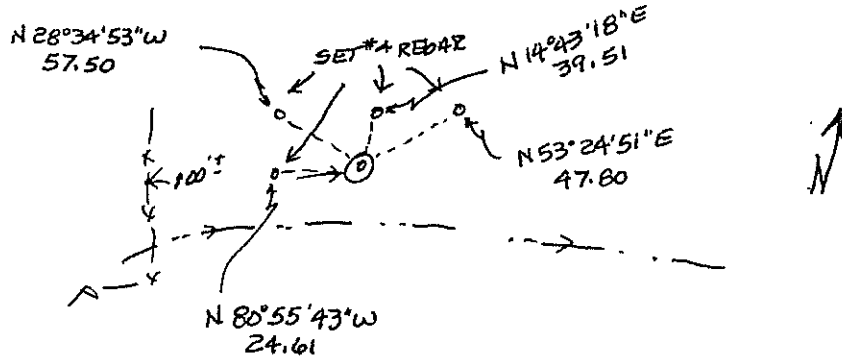
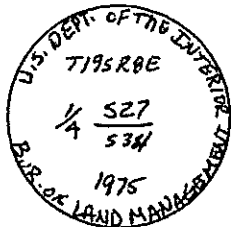

Certification:

Firm name and/or Surveyor: JOHANSEN & TUTTLE ENG

Address: 90 S 100 E CASTLE DALE UTAH Phone: (435) 381-2523

This is to certify that I was in responsible charge of the surveying work described in this record and that to the best of my knowledge the information presented herein is true and correct.

Location Diagram:

Section: 27
 Township: 19S
 Range: 8E

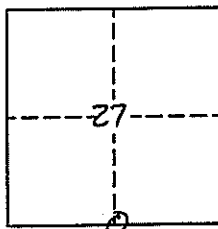

Travis E. Johansen
 Date _____