

EMERY COUNTY LAND SURVEY MONUMENT RECORD

Date of field work: 4-07-97 County Reference No. 0919700700
 Type of Monument: X Section Corner _____ Quarter Corner _____
 _____ Bench Mark _____ Other _____

Your Description and Observation of Monument Found (Be Specific):

Found Standard BLM Cap, 2.0' North of a mound of stone.

Description of Monument, Reference Monument or Accessories Established by You to Perpetuate the Location of this Point:

Set #5 rebar North, Southwest, Southeast, and West of Monument

Sketch showing Relative Location of Monument Accessories and Two Reference Points Stating Whether Found or Set. Show Supporting and/or Contradictory Evidence where Applicable. Include North Arrow.

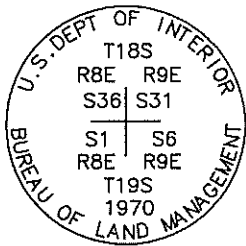

0919700700
 NW COR S 6
 T19S R9E SLM
 STD. BLM CAP

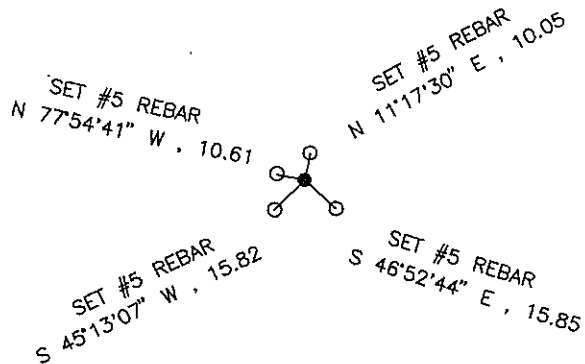

Certification:

Firm name and/or Surveyor: Johansen & Tuttle Eng. Craig E. Johansen
 Address: 90 South 100 East, Castle Dale, Utah 84513 Phone: (435) 381-2523

This is to certify that I was in responsible charge of the surveying work described in this record and that to the best of my knowledge the information presented herein is true and correct.

Location Diagram:
 Section: 6
 Township: 19 S.
 Range: 9 E.

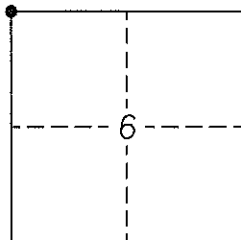

Craig E. Johansen
 Craig E. Johansen

20 Nov. 1998
 Date

