



STATE OF UTAH

MONUMENT RECORD SHEET



BLM Point Name		Contact Name	License Number	Date
Corner Of Section		Map View Photo or Sketch		
Township Range Section				
Base and Meridian				
State	County			
Geographic Coordinates				
Latitude (DMS)				
Longitude (DMS)				
Ellipsoid Height				
Grid Coordinates				
Northing				
Easting				
Horizontal Units				
Ortho Elevation				
Coordinate System	Zone	Monument Area Photo		Monument Close-up Photo
Datum	NGS Adjustment			
Vertical Units		Monument Description		
Vertical Datum				
Monument Status		Additional Notes		
Disclaimer				

The state of Utah makes no guarantees, representations, or warranties of any kind, expressed or implied, as to the content, accuracy, timeliness, or completeness of any of the data. Unless otherwise noted all images are oriented north and are not to scale. The data is provided on an "as is, where is" basis. The State assumes no obligation or liability for its use by any persons.

PLSS Monument Preservation Sheet

Township Range Section Meridian																					
BLM Point ID													Date	7/28/2011							
U	T	2	6	0	2	2	0	S	0	0	6	0			E	0	_	2	0	0	5
Meridian		Township		N S	Range		E W	Section		Corner											
<input checked="" type="checkbox"/> Salt Lake	<input type="checkbox"/> Uintah	2	2	S	0	6	E	0	7	<input type="checkbox"/> NW	<input type="checkbox"/> NE	<input type="checkbox"/> SE	<input type="checkbox"/> SW								
Contact's Name		Lee M. Swasey						State		Utah											
Contact's Phone		435-381-2523						<input type="checkbox"/> N 1/4		<input checked="" type="checkbox"/> E 1/4	<input type="checkbox"/> S 1/4	<input type="checkbox"/> W 1/4									
License #		163634-2201						County		Emery											
Source Agency		Johansen & Tuttle Engineering Inc.						<input type="checkbox"/> WC	<input type="checkbox"/> RC	<input type="checkbox"/> MC	<input type="checkbox"/> Other										

PLSS Monument Coordinates																															
Datum				NGS National Spatial Reference System Adjustment																											
<input type="checkbox"/> NAD27	<input checked="" type="checkbox"/> NAD83	<input type="checkbox"/> WGS84		<input type="checkbox"/> NAD83 1986	<input type="checkbox"/> NAD83 1994 (OPUS)	<input type="checkbox"/> NAD83 2007	<input checked="" type="checkbox"/> NAD83 1994 (HARN)																								
Latitude (DMS)							Longitude (DMS)																								
N	3	8	-	5	5	-	0	1	.	3	0	2	0	0	W	1	1	1	-	1	6	-	4	8	.	7	3	4	5	2	
Northing							Easting																								
6	7	7	4	3	6	5	.	0	2							1	7	0	2	9	6	2	.	0	4						
Units <input type="checkbox"/> Survey Foot <input checked="" type="checkbox"/> International Foot <input type="checkbox"/> Meter							Coordinate Type <input checked="" type="checkbox"/> State Plane <input type="checkbox"/> UTM (Zone 12N)																								
Zone <input type="checkbox"/> Utah North <input checked="" type="checkbox"/> Utah Central <input type="checkbox"/> Utah South							Vertical Datum <input type="checkbox"/> NGVD29 <input checked="" type="checkbox"/> NAVD88																								
Ellipsoid Height M 6353.00 FT							Elevation M 6410.52 FT																								

Monument and Markings			
Type / Size			
Stone	Pipe/Cap	Post	Other
Size	Size 1" \ 2 1/2"	Size	Size
Material	Material iron \ brass	Material	Material

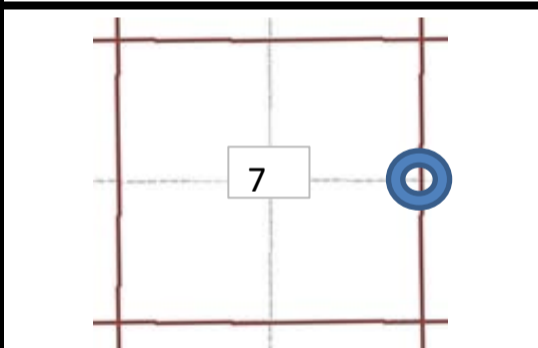
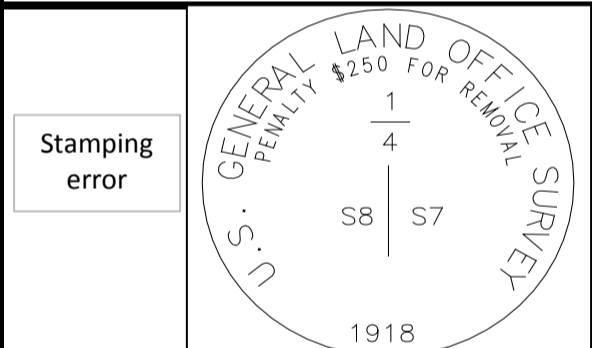
Surveyor Seal	Section Location Diagram	Monument Inscription
		
Signature & Date		Stamping error

Description and Observation of Monument

Found 1918 GLO brass cap, 15" above ground in mound of stone
 Set #4 rebar: N 58°50'06" E, 25.87'; S 00°09'22" E, 36.70'; S 56°30'29" W, 46.54'; N 40°55'53" W, 20.33'

Sketch/Rubbing or Attach Photo of GPS Station Occupied
 Show rotation of stampings/markings relative to North and describe briefly



NOTE STAMPING ERROR

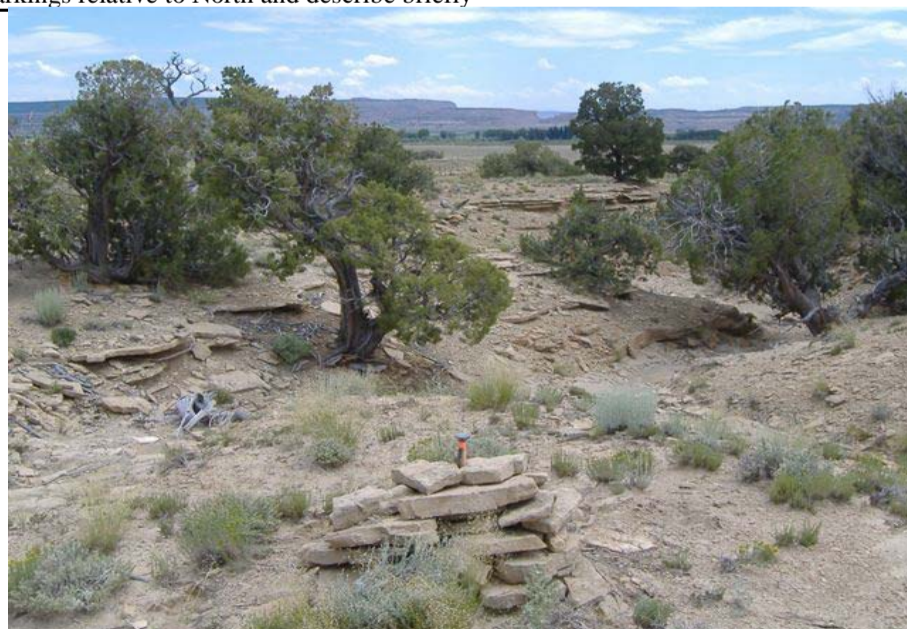

LOOKING SOUTH