

# EMERY COUNTY LAND SURVEY MONUMENT RECORD

Date of field work: 2-15-01

County Reference No. 2007 0700 240500

Type of Monument: \_\_\_\_\_  
 \_\_\_\_\_

Section Corner   
 Bench Mark \_\_\_\_\_

Quarter Corner \_\_\_\_\_  
 Other \_\_\_\_\_

Your Description and Observation of Monument Found ( Be Specific ):

FOUND STD BLK RM, 35.0 FT NORTH of MAG NAIL

FOUND MAG NAIL in the ROAD FOR THE CORNER

Description of Monument, Reference Monument or Accessories Established by You to Perpetuate the Location of this Point:

SET A EGS RM CAP 64.45 FT, SOUTH WEST OF THE CORNER

SET A #4 REBAR NORTH WEST, AND SOUTHWEST OF THE CORNER

Sketch showing Relative Location of Monument Accessories and Two Reference Points Stating Whether Found or Set. Show Supporting and/or Contradictory Evidence where Applicable. Include North Arrow.

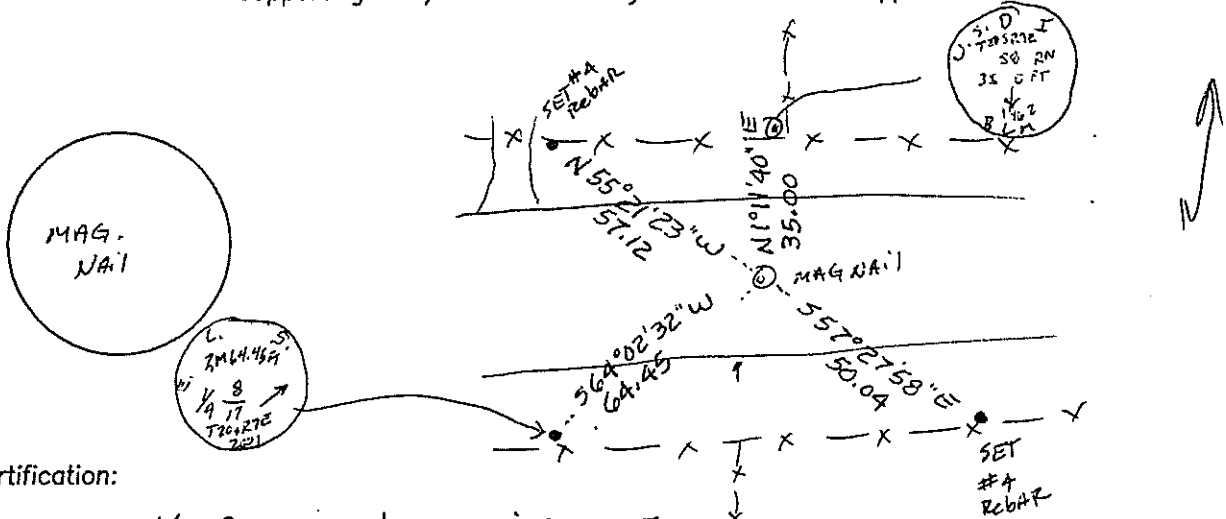

Certification:

Firm name and/or Surveyor: JOHANSEN & TUTTLE ENG

Address: 90 S 100 E CASTLE DALE UTAH Phone: 435-381-2523

This is to certify that I was in responsible charge of the surveying work described in this record and that to the best of my knowledge the information presented herein is true and correct.

Location Diagram:

Section: 8  
 Township: 20 S  
 Range: 7 E

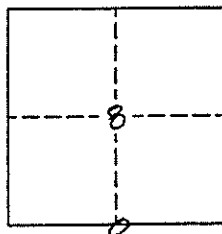

Date \_\_\_\_\_

# UTAH LAND SURVEY MONUMENT RECORD

County EMERY

2007  
County Reference No. 0730 200540

1. Date of Field Work: 1-29-01

2. Type of Monument:  
(Check one)

Section Corner       Quarter Corner  
 Bench Mark         Other

3. Your Description and Observation of Monument Found (Be Specific):

FOUND STD BLM CAP in a EAST-WEST FENCE

4. Description of Monument, Reference Monument or Accessories Established by You to Perpetuate the Location of this Point:

SET 2 #4 REBARS EAST, AND NORTHWEST OF THE MONUMENT

5. Sketch showing Relative Location of Monument Accessories and Two Reference Points Stating Whether Found or Set. Show Supporting and/or Contradictory Evidence where Applicable. Include North Arrow.

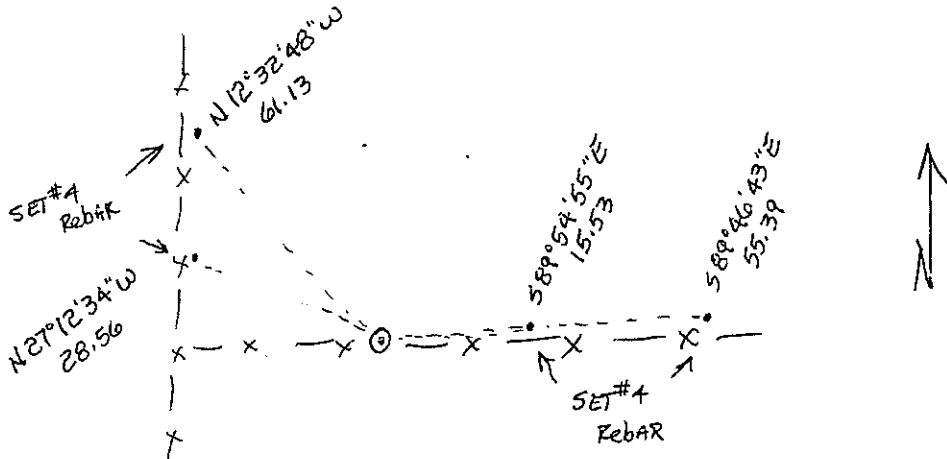

6. Certification:

Firm Name and/or Surveyor: JOHANSEN & TUTTLE ENG Phone: 435-381-2523  
 Address: 90 S. 100 E CASTLE DALE, UTAH

This is to certify that I was in responsible charge of the surveying work described in this record and that to the best of my knowledge the information presented herein is true and correct.

7. Location Diagram:

8. Section: 8

9. Township: 20 S

10. Range: 7 E

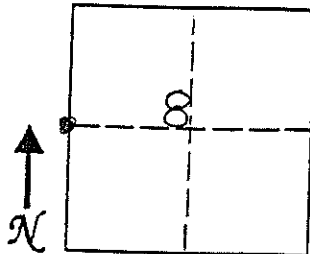

Signature: \_\_\_\_\_  
 Surveyor's Seal (over signature)  
**CRAIG E. JOHANSEN**  
 LICENSED LAND SURVEYOR  
 No. 146602  
 STATE OF UTAH  
 Date: 11-30-01



11. Monument Inscription:

12. Diagram Coordinate from Master Index for Townships: \_\_\_\_\_

Report one monument per form.  
Type or use permanent black ink.  
Fill in all items.

# EMERY COUNTY LAND SURVEY MONUMENT RECORD

Date of field work: 2-12-01

County Reference No. 2007 0720 200500

Type of Monument: ✓  
 \_\_\_\_\_  
 \_\_\_\_\_

Section Corner \_\_\_\_\_  
 Bench Mark \_\_\_\_\_

Quarter Corner \_\_\_\_\_  
 Other \_\_\_\_\_

Your Description and Observation of Monument Found ( Be Specific ):

*FOUND STD GLO CAP AT A NORTH-WEST FENCE CORNER*

Description of Monument, Reference Monument or Accessories Established by You to Perpetuate the Location of this Point:

*SET #4 REBAR NORTH, NORTHWEST, AND 2 WEST OF THE MONUMENT*

Sketch showing Relative Location of Monument Accessories and Two Reference Points Stating Whether Found or Set. Show Supporting and/or Contradictory Evidence where Applicable. Include North Arrow.

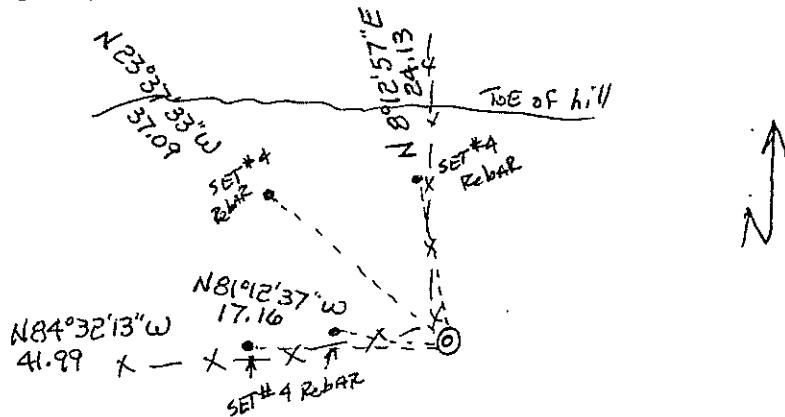
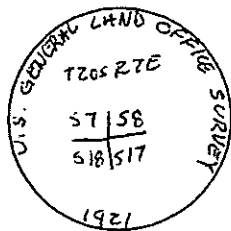

Certification:

Firm name and/or Surveyor: JOHANSEN & TUTTLE ENG

Address: 905 100 E CASTLE DALE UTAH

Phone: 435-381-2523

This is to certify that I was in responsible charge of the surveying work described in this record and that to the best of my knowledge the information presented herein is true and correct.

Location Diagram:

Section: 8  
 Township: 20 S  
 Range: 7E

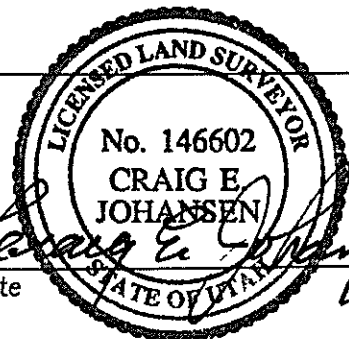
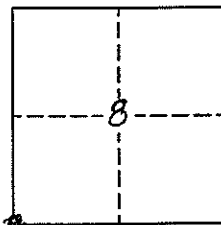

Date

11-30-01

# UTAH LAND SURVEY MONUMENT RECORD

County EMERY

County Reference No. 9720540500

1. Date of Field Work: 12-9-99

2. Type of Monument:  Section Corner  Quarter Corner  
 (Check one)  Bench Mark  Other \_\_\_\_\_

3. Your Description and Observation of Monument Found (Be Specific):  
MAG NAIL IN ROADWAY W/ 2 REFERENCE MARKERS FOUND  
& POSITIONS SHOWN BELOW

4. Description of Monument, Reference Monument or Accessories Established by You to Perpetuate the Location of this Point: UNCOVERED REFERENCE MARKERS (BURIED BY WATERLINE WORK)

5. Sketch showing Relative Location of Monument Accessories and Two Reference Points Stating Whether Found or Set. Show Supporting and/or Contradictory Evidence where Applicable. Include North Arrow.

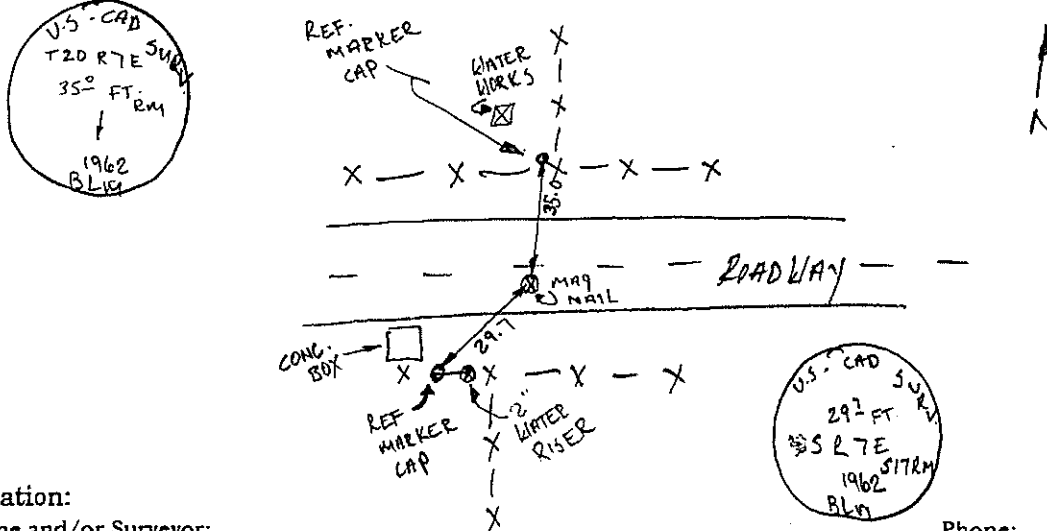

6. Certification:  
 Firm Name and/or Surveyor: \_\_\_\_\_ Phone: \_\_\_\_\_  
 Address: \_\_\_\_\_

This is to certify that I was in responsible charge of the surveying work described in this record and that to the best of my knowledge the information presented herein is true and correct.

7. Location Diagram:  
 8. Section: B  
 9. Township: 20S  
 10. Range: 7E

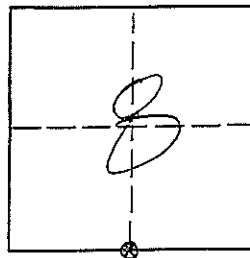

*Lee M. Swasey*  
 LICENSED LAND SURVEYOR  
 No. 163634  
 Signature  
**LEE M. SWASEY**  
 Surveyor  
 (over signature)  
 STATE OF UTAH  
20/Dec/99  
 Date

11. Monument Inscription:

12. Diagram Coordinate from Master Index for Townships: \_\_\_\_\_

Report one monument per form.  
 Type or use permanent black ink.  
 Fill in all items.

# UTAH LAND SURVEY MONUMENT RECORD

County EMERY

County Reference No. 0720540/600

1. Date of Field Work: 12-9-99

2. Type of Monument:   
 (Check one)   
 Section Corner  Quarter Corner   
 Bench Mark  Other \_\_\_\_\_

3. Your Description and Observation of Monument Found (Be Specific):   
1921 BRASS CAP IN MOUND OF STONE

4. Description of Monument, Reference Monument or Accessories Established by You to Perpetuate the Location of this Point:   
FLAGGED

5. Sketch showing Relative Location of Monument Accessories and Two Reference Points Stating Whether Found or Set. Show Supporting and/or Contradictory Evidence where Applicable. Include North Arrow.

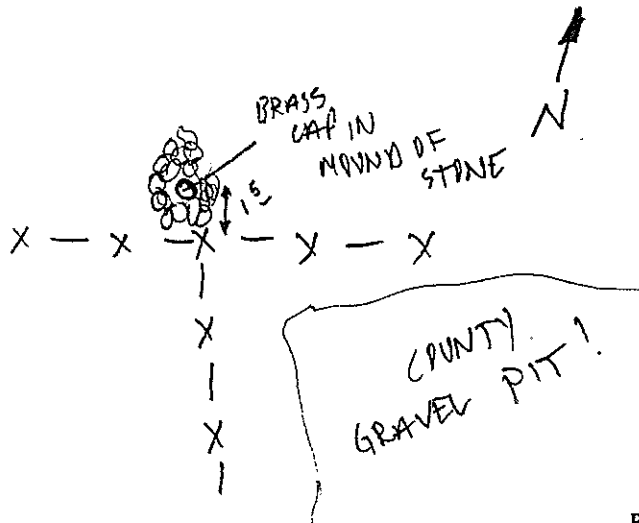

6. Certification:   
 Firm Name and/or Surveyor: \_\_\_\_\_ Phone: \_\_\_\_\_   
 Address: \_\_\_\_\_

This is to certify that I was in responsible charge of the surveying work described in this record and that to the best of my knowledge the information presented herein is true and correct.

7. Location Diagram:   
 8. Section: 9   
 9. Township: 20S   
 10. Range: 7E

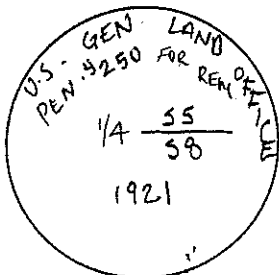
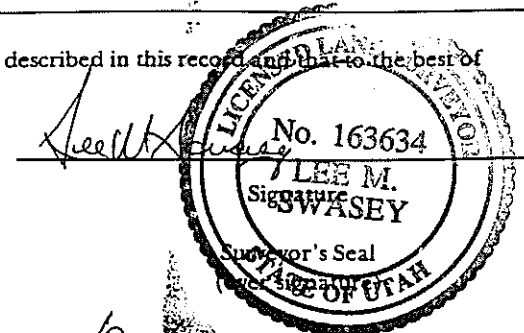
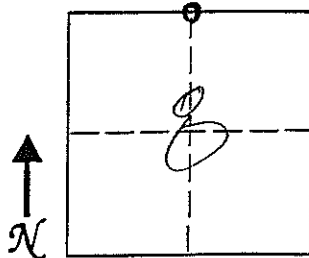

11. Monument Inscription:

12. Diagram Coordinate from Master Index for Townships: \_\_\_\_\_

Report one monument per form.   
 Type or use permanent black ink.   
 Fill in all items.

20/Dec/99 Date

# UTAH LAND SURVEY MONUMENT RECORD

County EMERY

County Reference No. 0700600540

1. Date of Field Work: 12/9/99

2. Type of Monument:  Section Corner  Quarter Corner  
 (Check one)  Bench Mark  Other

3. Your Description and Observation of Monument Found (Be Specific):  
1962 BRASS CAP DIRECTLY IN FENCE LINE 12" EAST OF FENCE CORNER  
IRRIG. LINE RUNS EAST/WEST 10" SOUTH OF CORNER!

4. Description of Monument, Reference Monument or Accessories Established by You to Perpetuate the Location of this Point: FLAGGED

5. Sketch showing Relative Location of Monument Accessories and Two Reference Points Stating Whether Found or Set. Show Supporting and/or Contradictory Evidence where Applicable. Include North Arrow.

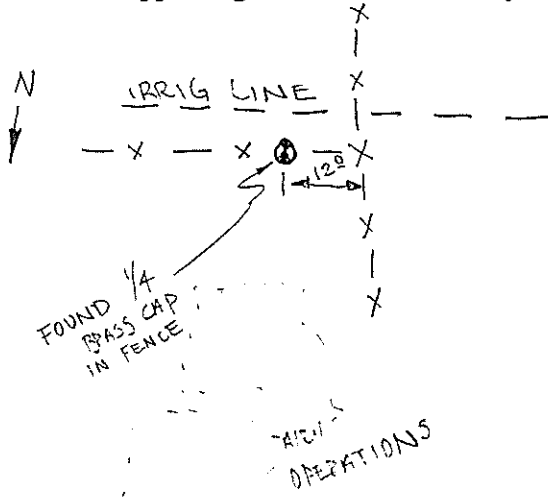

6. Certification:  
 Firm Name and/or Surveyor: \_\_\_\_\_ Phone: \_\_\_\_\_  
 Address: \_\_\_\_\_

This is to certify that I was in responsible charge of the surveying work described in this record and that to the best of my knowledge the information presented herein is true and correct.

7. Location Diagram:  
 8. Section: B  
 9. Township: 20S  
 10. Range: 7E

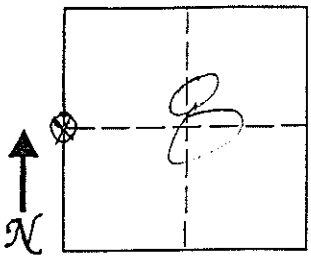
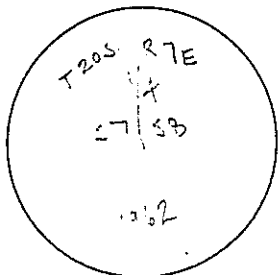

Lee M. Swasey

20/Dec/99

Date

11. Monument Inscription: \_\_\_\_\_

12. Diagram Coordinate from Master Index for Townships: \_\_\_\_\_

Report one monument per form. Type or use permanent black ink. Fill in all items.

# UTAH LAND SURVEY MONUMENT RECORD

County EMERY

County Reference No. 07206006DD

1. Date of Field Work: 11/11/99

2. Type of Monument:  Section Corner  Quarter Corner  
 Bench Mark  Other

3. Your Description and Observation of Monument Found (Be Specific):  
 FOUND REMAINS OF STAINL NO CAP PRESENT - METAL DETECTOR SHOWED PRESENCE OF STEEL - DUG DOWN 9" ; FOUND CORRODED 1 1/2" DIA. TUBE FILLED W/ CONCRETE

4. Description of Monument, Reference Monument or Accessories Established by You to Perpetuate the Location of this Point: RE-BUILT LARGE MOUND OF STONE

5. Sketch showing Relative Location of Monument Accessories and Two Reference Points Stating Whether Found or Set. Show Supporting and/or Contradictory Evidence where Applicable. Include North Arrow.

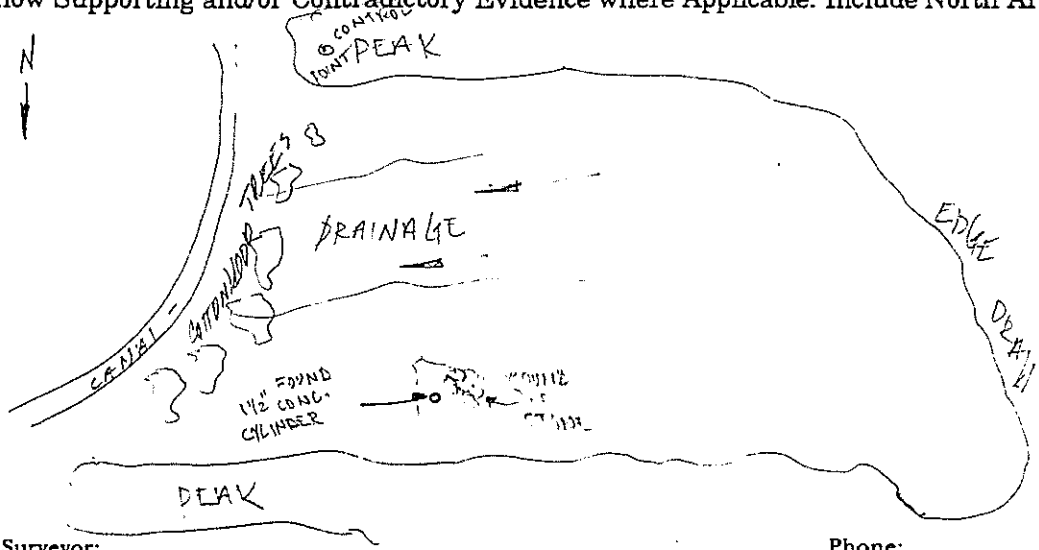

6. Certification:  
 Firm Name and/or Surveyor: \_\_\_\_\_ Phone: \_\_\_\_\_  
 Address: \_\_\_\_\_

This is to certify that I was in responsible charge of the surveying work described in this record and that to the best of my knowledge the information presented herein is true and correct.

7. Location Diagram:  
 8. Section: 2  
 9. Township: 20S  
 10. Range: 7E

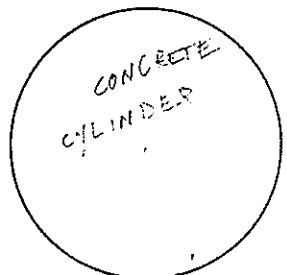
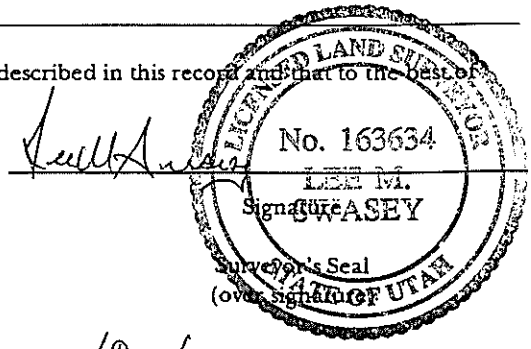
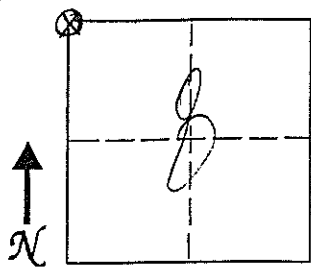

11. Monument Inscription: \_\_\_\_\_

12. Diagram Coordinate from Master Index for Townships: \_\_\_\_\_

20/Dec/99 Date

Report one monument per form. Type or use permanent black ink. Fill in all items.