

# Emery County 2000 Point ID System

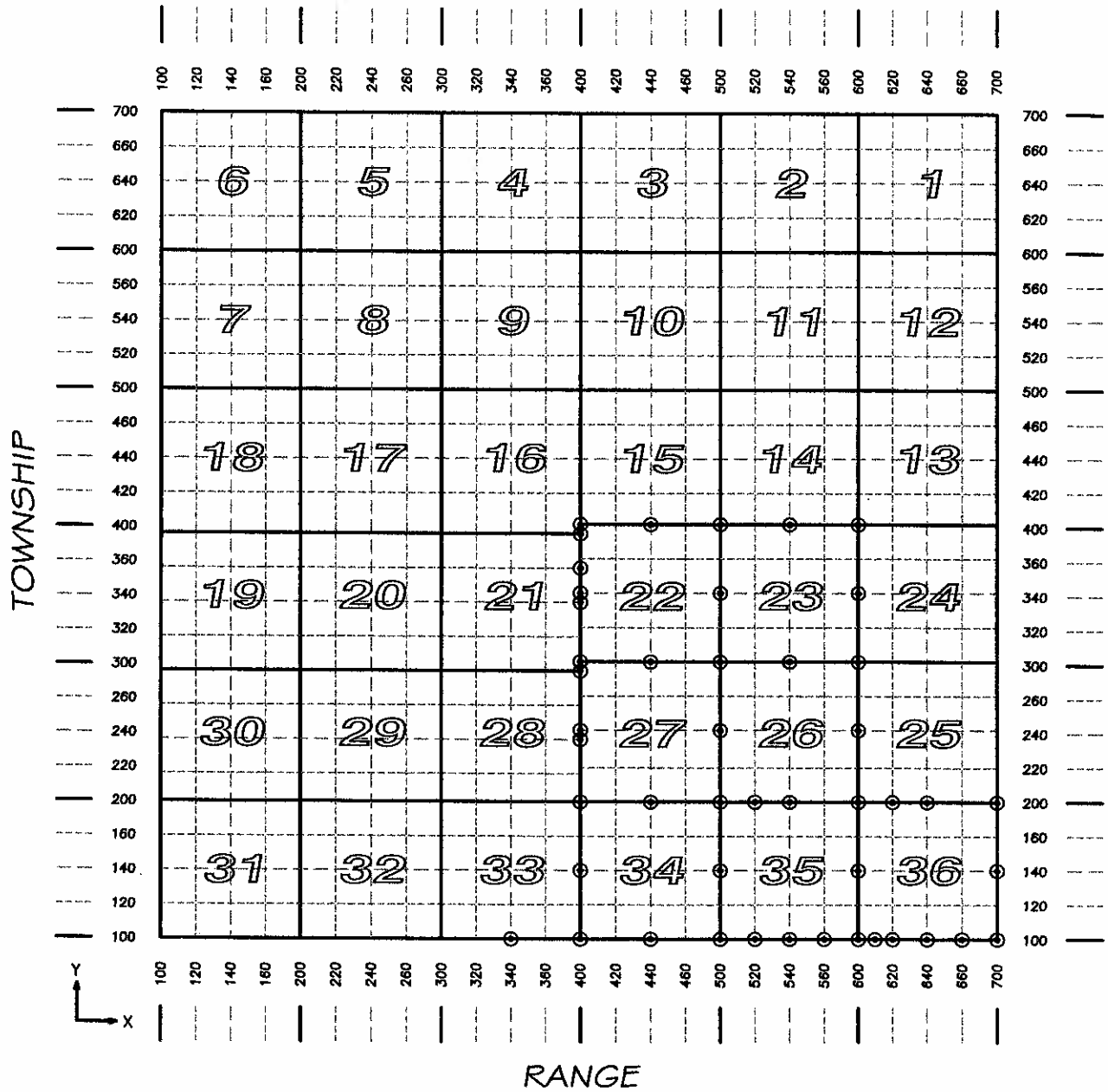

T R X Y  
 2106440400 = S 1/4, Sec. 15, T 21 S, R 6 E.

2106

T. 21 S. R. 6 E. SLM

⊙ MONUMENT RECORD FILED

△ SEE ADJOINING SHEET

**EMERY COUNTY SECTION CORNERS**  
**NAD 83 (1994) State Plane Coordinate Data, Central Zone**  
**TOWNSHIP 21 SOUTH, RANGE 6 EAST**

SECTION CODE	INTERNATIONAL FEET			ELEV.	POSITION	
	NORTHING	EASTING			LATITUDE	LONGITUDE
2106340100	6782636.69	1710893.72	6482.95	N	38° 56' 22.8533	W 111° 15' 08.0957
2106400100	6782645.25	1713535.16	6375.00	N	38° 56' 22.8643	W 111° 14' 34.6659
2106400140	6785256.74	1713505.79	6345.53	N	38° 56' 48.6768	W 111° 14' 34.9427
2106400200	6787873.36	1713476.20	6408.80	N	38° 57' 14.5400	W 111° 14' 35.2221
2106400236	6790513.03	1713468.09	0.00	N	38° 57' 40.6305	W 111° 14' 35.2288
2106400236 WC	6790455.52	1713468.39	6694.94	N	38° 57' 40.0621	W 111° 14' 35.2271
2106400240	6790538.40	1713468.13	0.00	N	38° 57' 40.8813	W 111° 14' 35.2273
2106400240 WC	6790678.36	1713467.71	6690.14	N	38° 57' 42.2646	W 111° 14' 35.2276
2106400296	6793152.71	1713459.98	6642.22	N	38° 58' 06.7211	W 111° 14' 35.2355
2106400300	6793203.44	1713460.07	6643.90	N	38° 58' 07.2225	W 111° 14' 35.2325
2106400336	6795789.29	1713451.37	6391.71	N	38° 58' 32.7811	W 111° 14' 35.2486
2106400340	6795840.67	1713451.52	6390.17	N	38° 58' 33.2890	W 111° 14' 35.2448
2106400356	6797108.66	1713447.78	6619.27	N	38° 58' 45.8218	W 111° 14' 35.2461
2106400396	6798428.03	1713443.36	6513.24	N	38° 58' 58.8625	W 111° 14' 35.2541
2106400400	6798558.85	1713441.05	6531.50	N	38° 59' 00.1555	W 111° 14' 35.2786
2106440100	6782665.00	1716164.54	6304.15	N	38° 56' 22.9834	W 111° 14' 01.3884
2106440200	6787856.38	1716096.97	6350.17	N	38° 57' 14.2965	W 111° 14' 02.0480
2106440300	6793211.87	1716011.15	6423.54	N	38° 58' 07.2322	W 111° 14' 02.9329
2106440400	6798564.82	1715959.26	6434.02	N	38° 59' 00.1418	W 111° 14' 03.3885
2106500100	6782685.64	1718804.07	6206.38	N	38° 56' 23.1084	W 111° 13' 27.9823
2106500140	6785172.57	1718746.67	6240.69	N	38° 56' 47.6907	W 111° 13' 28.6118
2106500200	6787849.84	1718721.66	6299.65	N	38° 57' 14.1533	W 111° 13' 28.8241
2106500240	6790528.05	1718682.53	6344.61	N	38° 57' 40.6257	W 111° 13' 29.2151
2106500300	6793215.47	1718653.56	6387.25	N	38° 58' 07.1888	W 111° 13' 29.4772
2106500340	6795878.82	1718601.66	0.00	N	38° 58' 33.5147	W 111° 13' 30.0306
2106500400	6798575.22	1718593.37	6597.45	N	38° 59' 00.1659	W 111° 13' 30.0306
2106520100	6782694.82	1720125.76	6210.71	N	38° 56' 23.1586	W 111° 13' 11.2549
2106520200	6787887.73	1720049.57	6278.51	N	38° 57' 14.4871	W 111° 13' 12.0134
2106540100	6782705.44	1721446.74	6194.70	N	38° 56' 23.2223	W 111° 12' 54.5365

2106540200	6787960.97	1721371.84	6275.70	N	38° 57' 15.1697	W	111° 12' 55.2727
2106540300	6793255.34	1721309.51	6273.44	N	38° 58' 07.5007	W	111° 12' 55.8486
2106540400	6798585.02	1721283.80	6381.70	N	38° 59' 00.1796	W	111° 12' 55.9595
2106560100	6782715.86	1722800.73	6178.82	N	38° 56' 23.2823	W	111° 12' 37.4003
2106600100	6782726.51	1724153.65	6293.27	N	38° 56' 23.3439	W	111° 12' 20.2776
2106600140	6785366.68	1724093.34	6346.67	N	38° 56' 49.4410	W	111° 12' 20.9309
2106600200	6788007.36	1724034.55	6191.83	N	38° 57' 15.5431	W	111° 12' 21.5652
2106600240	6790649.22	1723994.49	6237.55	N	38° 57' 41.6563	W	111° 12' 21.9624
2106600300	6793289.71	1723954.55	6315.15	N	38° 58' 07.7559	W	111° 12' 22.3582
2106600340	6795944.33	1723939.38	6334.94	N	38° 58' 33.9944	W	111° 12' 22.4399
2106600400	6798595.20	1723923.03	6405.57	N	38° 59' 00.1959	W	111° 12' 22.5367
2106612100 AM	6782717.68	1724948.69	6174.23	N	38° 56' 23.2307	W	111° 12' 10.2161
2106620100	6782722.07	1725457.45	6139.17	N	38° 56' 23.2573	W	111° 12' 03.7772
2106620200	6788027.02	1725362.65	6216.56	N	38° 57' 15.6939	W	111° 12' 04.7527
2106640100	6782717.71	1726761.33	6175.35	N	38° 56' 23.1708	W	111° 11' 47.2758
2106640200	6788047.07	1726690.37	6411.67	N	38° 57' 15.8479	W	111° 11' 47.9451
2106660100	6782712.35	1728066.24	6337.92	N	38° 56' 23.0737	W	111° 11' 30.7614
2106700100	6782707.66	1729370.38	6299.72	N	38° 56' 22.9826	W	111° 11' 14.2567
2106700140	6785396.31	1729356.70	0.00	N	38° 56' 49.5574	W	111° 11' 14.3109
2106700140WC	6785402.91	1729356.67	6333.82	N	38° 56' 49.6226	W	111° 11' 14.3110
2106700200	6788086.21	1729344.34	6320.69	N	38° 57' 16.1445	W	111° 11' 14.3483

EMERY COUNTY SECTION CORNERS								
NAD 83 CONVERSION DATA								
2106								
TOWNSHIP	RANGE	SECTION	ROTATION ANGLE	COMBINED FACTOR GROUND TO GRID	INVERSE GRID TO GROUND			
T. 21 S.	R. 6 E.	1						
		2						
		3						
		4						
		5						
		6						
		7						
		8						
		9						
		10						
		11						
		12						
		13						
		14						
		15						
		16						
		17						
		18						
		19						
		20						
		21						
				22	0° 10' 13"	0.99970437	1.00029572	2004
				23	0° 10' 56"	0.99970861	1.00029147	2004
				24				
				25				
				26	0° 10' 56"	0.99971668	1.00028340	2004
				27	0° 10' 13"	0.99970939	1.00029069	2004
				28				
				29				
				30				
				31				
				32				
				33				
				34	0° 10' 14"	0.99971934	1.00028074	2004
				35	0° 10' 57"	0.99972219	1.00027789	2004
				36	0° 11' 40"	0.99972021	1.00027987	2004

# EMERY COUNTY LAND SURVEY MONUMENT RECORD

Date of field work: 11-11-04

County Reference No. 2106340100

Type of Monument:  Section Corner  
 Bench Mark

Quarter Corner  
 Other \_\_\_\_\_

Your Description and Observation of Monument Found ( Be Specific ):

1918 USGLOS CAP 12" ABOVE GROUND WITH A STONE MOUND TO THE NORTH

Description of Monument, Reference Monument or Accessories Established by You to Perpetuate the Location of this Point: SET  $\uparrow$  #4 REBAR AS SHOWN BELOW

Sketch showing Relative Location of Monument Accessories and Two Reference Points Stating Whether Found or Set. Show Supporting and/or Contradictory Evidence where Applicable. Include North Arrow.

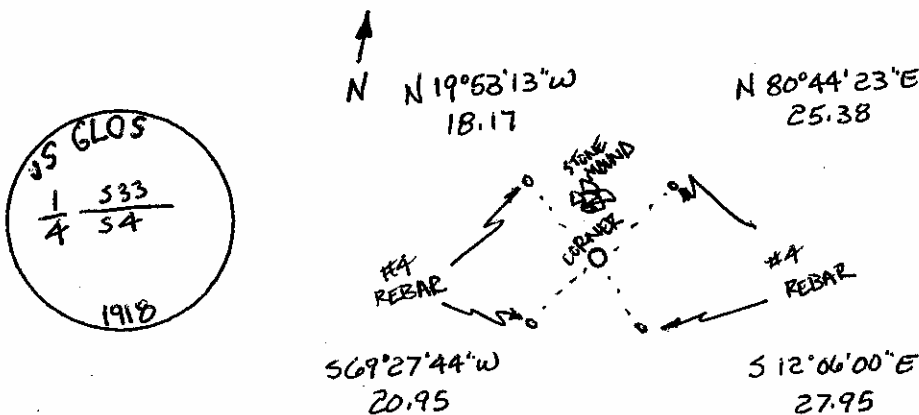

Certification:

Firm name and/or Surveyor: Johansen & Tuttle Eng.

Address: 90 S. 100 E. Castle Dale, Utah 84513 Phone: (435) 381-2523

This is to certify that I was in responsible charge of the surveying work described in this record and that to the best of my knowledge the information presented herein is true and correct.

Location Diagram:

Section: 33

Township: 21S

Range: 06E

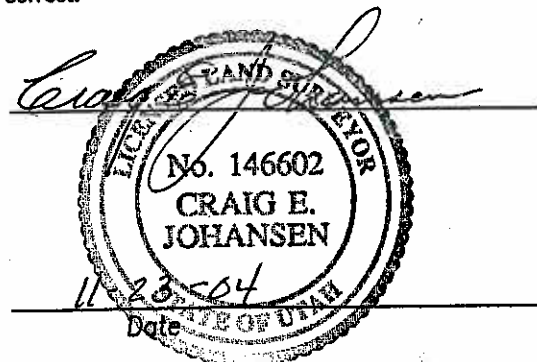
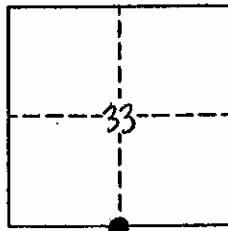

# EMERY COUNTY LAND SURVEY MONUMENT RECORD

Date of field work: 10-20-04

County Reference No. 2106400100

Type of Monument:  Section Corner  
 Bench Mark

Quarter Corner  
 Other \_\_\_\_\_

Your Description and Observation of Monument Found ( Be Specific ):  
 1918 USGLOS CAP 12" ABOVE GROUND IN A STONE MOUND

Description of Monument, Reference Monument or Accessories Established by You to Perpetuate the Location of this Point: SET 4 #4 REBAR (RBR) AS SHOWN BELOW.

Sketch showing Relative Location of Monument Accessories and Two Reference Points Stating Whether Found or Set. Show Supporting and/or Contradictory Evidence where Applicable. Include North Arrow.

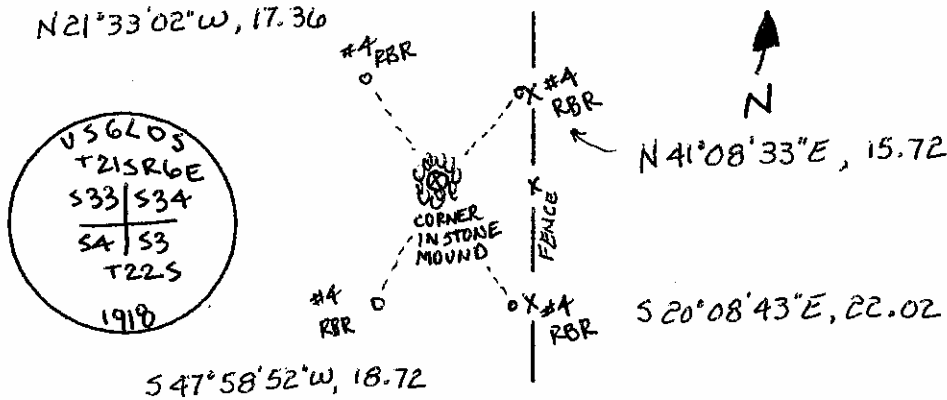

**Certification:**

Firm name and/or Surveyor: Johansen & Tuttle Eng.

Address: 90 S. 100 E. Castle Dale, Utah 84513 Phone: (435) 381-2523

This is to certify that I was in responsible charge of the surveying work described in this record and that to the best of my knowledge the information presented herein is true and correct.

Location Diagram:  
 Section: 33  
 Township: 21S  
 Range: 6E

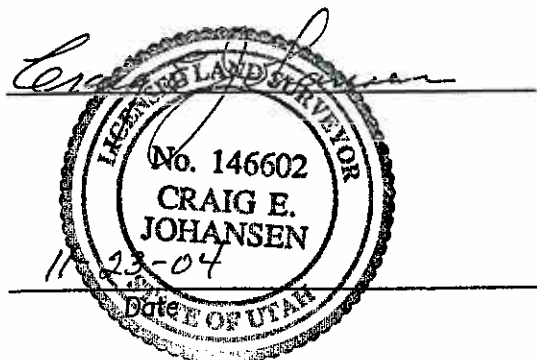
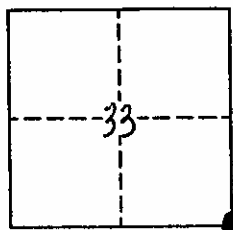

# EMERY COUNTY LAND SURVEY MONUMENT RECORD

Date of field work: 11-18-04

County Reference No. 2106400140

Type of Monument:            Section Corner   ✓   Quarter Corner  
           Bench Mark            Other   

Your Description and Observation of Monument Found ( Be Specific ):  
1919 USGLOS CAP 5" UNDERGROUND WITH A 10" SURVEY MARKER SPIKE ALONGSIDE CAP IS BENT TO THE NORTH

Description of Monument, Reference Monument or Accessories Established by You to Perpetuate the Location of this Point: SET 2 #4 REBAR AND 2 REFERENCE MARKER CAPS AS SHOWN BELOW.

Sketch showing Relative Location of Monument Accessories and Two Reference Points Stating Whether Found or Set. Show Supporting and/or Contradictory Evidence where Applicable. Include North Arrow.

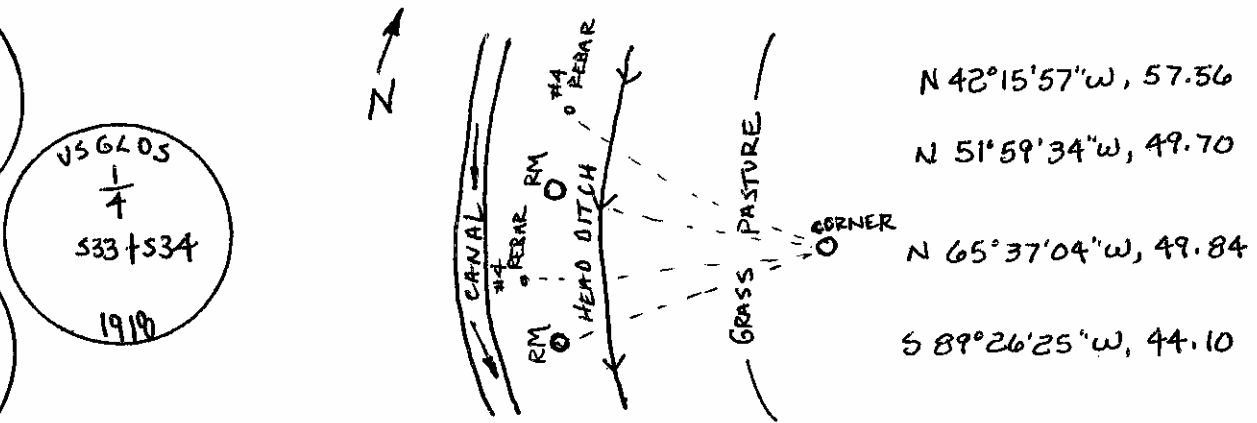
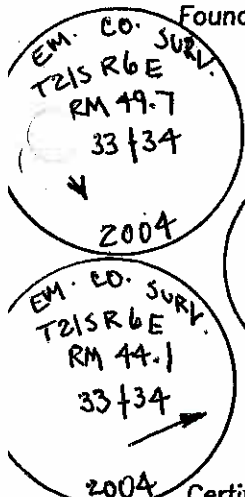

Certification:

Firm name and/or Surveyor: Johansen & Tuttle Eng.  
Address: 90 S. 100 E. Castle Dale, Utah 84513 Phone: (435) 381-2523

This is to certify that I was in responsible charge of the surveying work described in this record and that to the best of my knowledge the information presented herein is true and correct.

Location Diagram:  
Section: 33  
Township: 21S  
Range: 6E

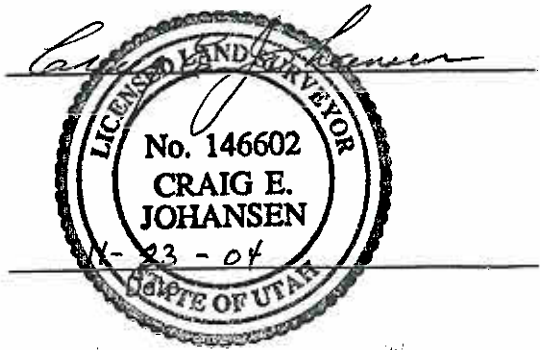
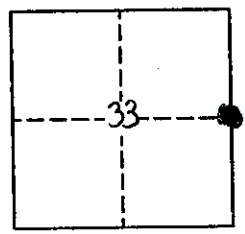

# EMERY COUNTY LAND SURVEY MONUMENT RECORD

Date of field work: 11-11-04

County Reference No. 2106400200

Type of Monument:  Section Corner  
 Bench Mark

Quarter Corner  
 Other \_\_\_\_\_

Your Description and Observation of Monument Found ( Be Specific ):  
 1919 USGLOS CAP 12' ABOVE GROUND WITH A STONE MOUND TO THE WEST

Description of Monument, Reference Monument or Accessories Established by You to Perpetuate the Location of this Point: SET 4 #4 REBAR AS SHOWN BELOW

Sketch showing Relative Location of Monument Accessories and Two Reference Points Stating Whether Found or Set. Show Supporting and/or Contradictory Evidence where Applicable. Include North Arrow.

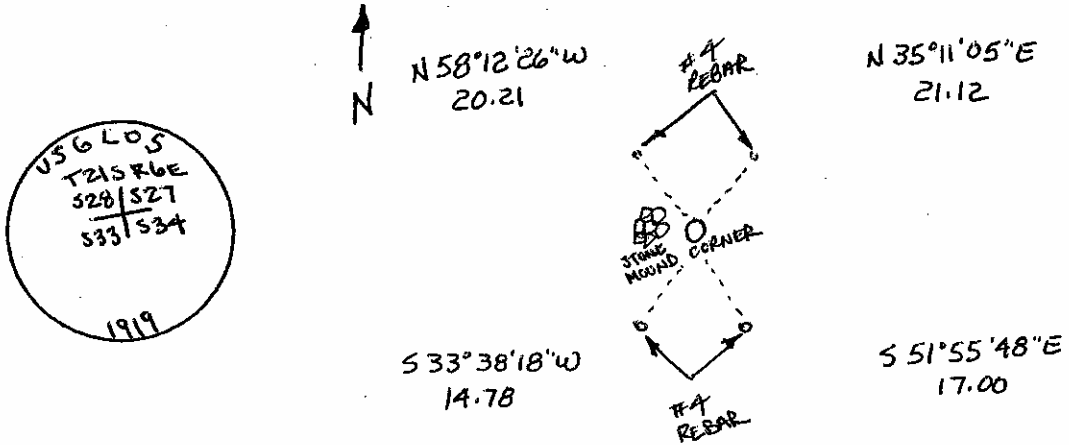

Certification:

Firm name and/or Surveyor: Johansen & Tuttle Eng.  
 Address: 90 S. 100 E. Castle Dale, Utah 84513 Phone: (435) 381-2523

This is to certify that I was in responsible charge of the surveying work described in this record and that to the best of my knowledge the information presented herein is true and correct.

Location Diagram:  
 Section: 28  
 Township: 21S  
 Range: 6E

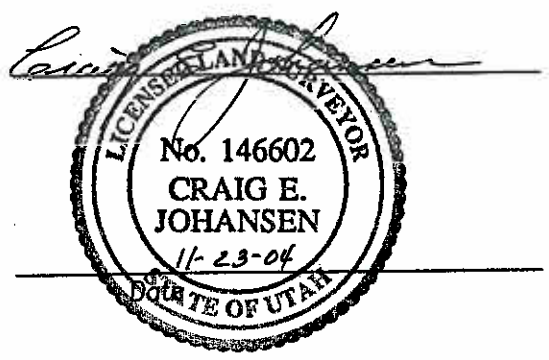
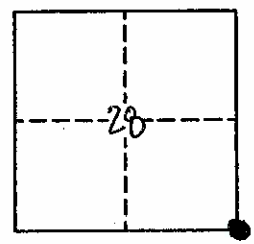



# EMERY COUNTY LAND SURVEY MONUMENT RECORD

Date of field work: 11-18-04

County Reference No. 2106400236

Type of Monument:        Section Corner        Quarter Corner  
       Bench Mark   ✓   Other WITNESS CORNER

Your Description and Observation of Monument Found ( Be Specific ):  
 1919 USGLOS PIPE AND CAP LAYING IN BOTTOM OF WASH.

Description of Monument, Reference Monument or Accessories Established by You to Perpetuate the Location of this Point: RESET MONUMENT AS A WITNESS CORNER AND SET 4 #4 REBAR AS SHOWN BELOW. BUILT STONE MOUND AROUND CORNER.

Sketch showing Relative Location of Monument Accessories and Two Reference Points Stating Whether Found or Set. Show Supporting and/or Contradictory Evidence where Applicable. Include North Arrow.

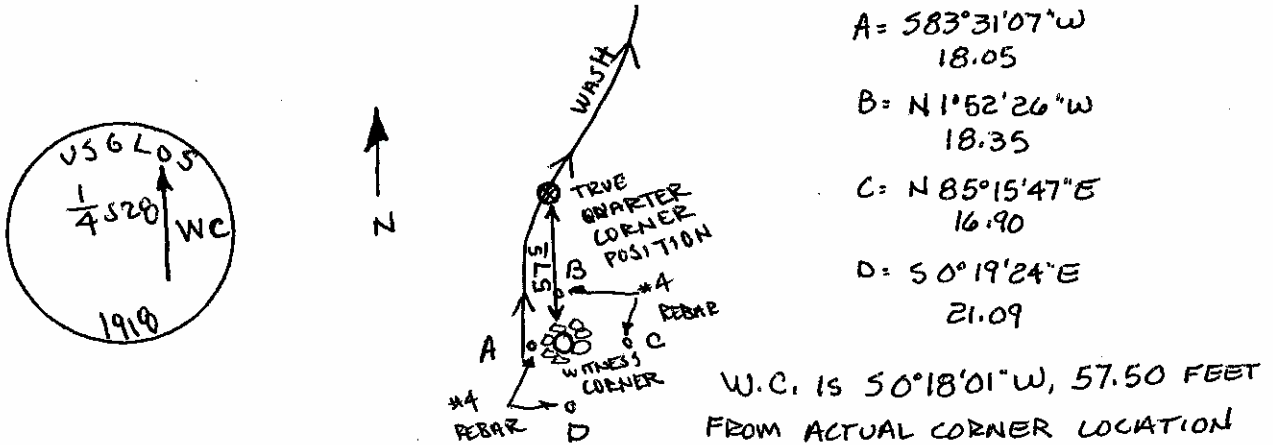

- A = 583°31'07"W  
18.05
- B = N1°52'26"W  
18.35
- C = N85°15'47"E  
16.90
- D = S0°19'24"E  
21.09

W.C. IS 50°18'01"W, 57.50 FEET FROM ACTUAL CORNER LOCATION

Certification:

Firm name and/or Surveyor: Johansen & Tuttle Eng.  
 Address: 90 S. 100 E. Castle Dale, Utah 84513 Phone: (435) 381-2523

This is to certify that I was in responsible charge of the surveying work described in this record and that to the best of my knowledge the information presented herein is true and correct.

Location Diagram:  
 Section: 28  
 Township: 21S  
 Range: 6E

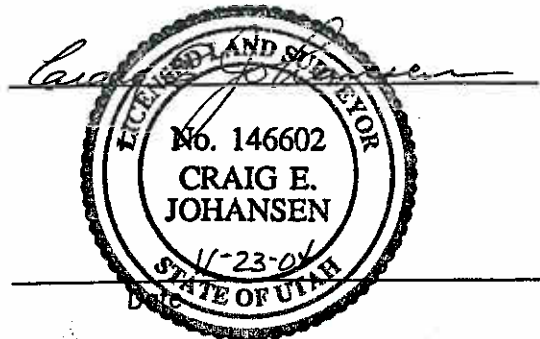
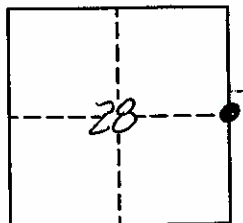

# EMERY COUNTY LAND SURVEY MONUMENT RECORD

Date of field work: 11-19-04

County Reference No. 2106400240

Type of Monument:            Section Corner  
           Bench Mark

           Quarter Corner  
 Other WITNESS CORNER

Your Description and Observation of Monument Found ( Be Specific ):

1919 USGLOS PIPE AND CAP LAYING IN BOTTOM OF WASH

Description of Monument, Reference Monument or Accessories Established by You to Perpetuate the Location of this Point: RESET MONUMENT AS A WITNESS CORNER AND SET 4 #4 REBAR AS SHOWN BELOW. BUILT STONE MOUND TO THE EAST OF MONUMENT

Sketch showing Relative Location of Monument Accessories and Two Reference Points Stating Whether Found or Set. Show Supporting and/or Contradictory Evidence where Applicable. Include North Arrow.

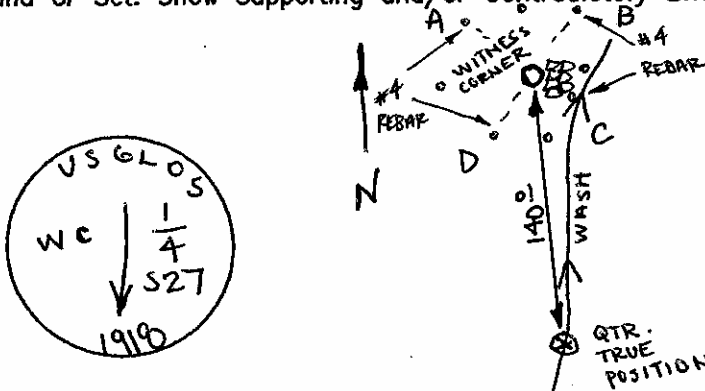

A = N 27° 01' 29" W  
18.12

B = N 57° 47' 00" E  
15.09

C = S 25° 41' 55" E  
18.96

D = S 57° 01' 17" W  
17.69

W.C. IS N 0° 10' 13" W, 140.00 FEET FROM ACTUAL CORNER LOCATION

Certification:

Firm name and/or Surveyor: Johansen & Tuttle Eng.

Address: 90 S. 100 E. Castle Dale, Utah 84513 Phone: (435) 381-2523

This is to certify that I was in responsible charge of the surveying work described in this record and that to the best of my knowledge the information presented herein is true and correct.

Location Diagram:

Section: 27

Township: 21S

Range: 6E

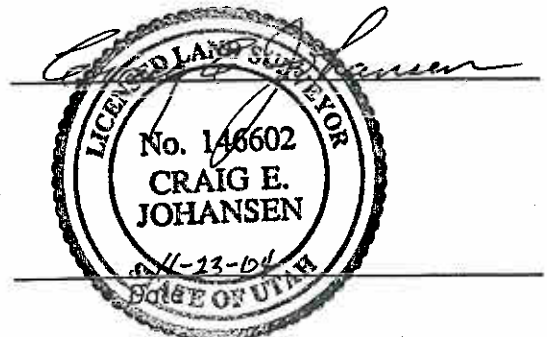
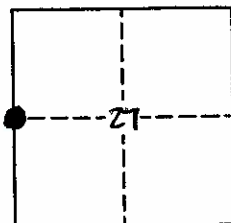

# EMERY COUNTY LAND SURVEY MONUMENT RECORD

Date of field work: 11-17-04

County Reference No. 2106400296

Type of Monument: X Section Corner  
 \_\_\_\_\_ Bench Mark

\_\_\_\_\_ Quarter Corner  
 \_\_\_\_\_ Other \_\_\_\_\_

Your Description and Observation of Monument Found ( Be Specific ):

1918 USGLOS CAP 12" ABOVE GROUND WITH A FOREST SERVICE SIGN TO THE WEST AND NORTH

Description of Monument, Reference Monument or Accessories Established by You to Perpetuate the Location of this Point: SET A #4 REBAR AS SHOWN BELOW

Sketch showing Relative Location of Monument Accessories and Two Reference Points Stating Whether Found or Set. Show Supporting and/or Contradictory Evidence where Applicable. Include North Arrow.

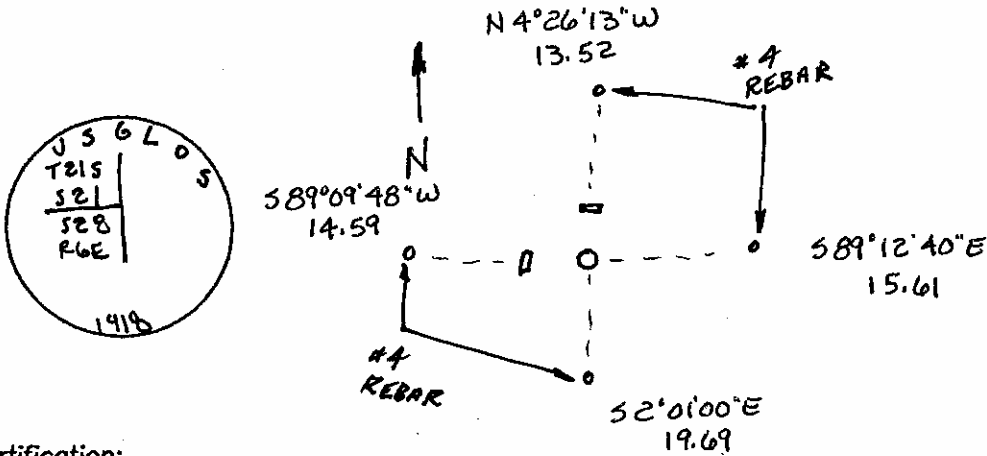

Certification:

Firm name and/or Surveyor: Johansen & Tuttle Eng.

Address: 90 S. 100 E. Castle Dale, Utah 84513 Phone: (435) 381-2523

This is to certify that I was in responsible charge of the surveying work described in this record and that to the best of my knowledge the information presented herein is true and correct.

Location Diagram:

Section: 21

Township: 21 S

Range: 6 E

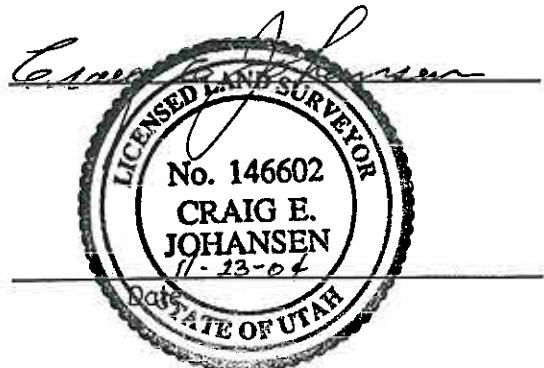
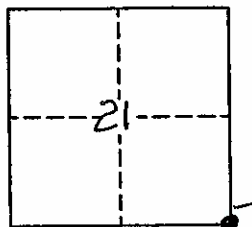

# EMERY COUNTY LAND SURVEY MONUMENT RECORD

Date of field work: 11-17-04

County Reference No. 2106400300

Type of Monument: X Section Corner               Quarter Corner  
         Bench Mark                                               Other                                 

Your Description and Observation of Monument Found ( Be Specific ):  
 1918 USGLOS CAP 15" ABOVE GROUND IN A STONE MOUND.  
 A FOREST SERVICE SIGN IS ON THE NORTH SIDE OF CAP

Description of Monument, Reference Monument or Accessories Established by You to Perpetuate the Location of this Point: SET 4 #4 REBAR AS SHOWN BELOW

Sketch showing Relative Location of Monument Accessories and Two Reference Points Stating Whether Found or Set. Show Supporting and/or Contradictory Evidence where Applicable. Include North Arrow.

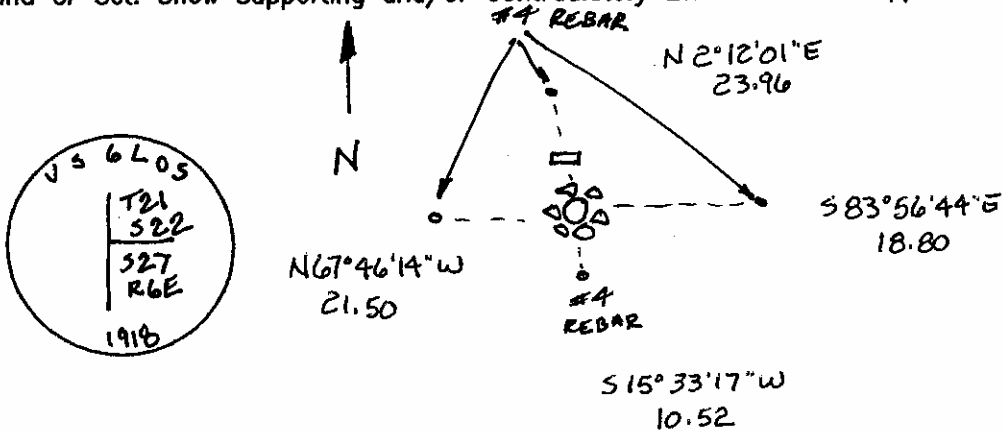

**Certification:**

Firm name and/or Surveyor: Johansen & Tuttle Eng.  
 Address: 90 S. 100 E. Castle Dale, Utah 84513 Phone: (435) 381-2523

This is to certify that I was in responsible charge of the surveying work described in this record and that to the best of my knowledge the information presented herein is true and correct.

Location Diagram:  
 Section: 22  
 Township: 21S  
 Range: 6E

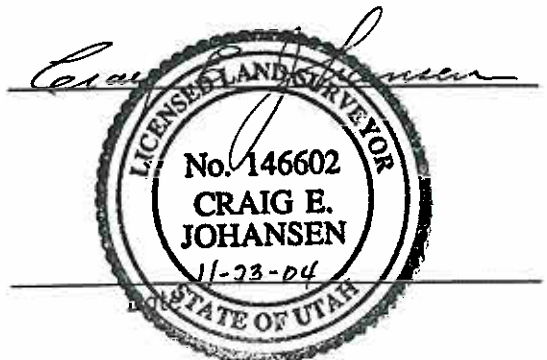
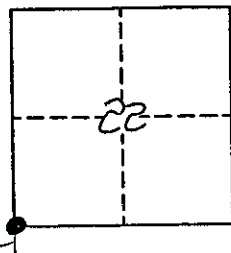

# EMERY COUNTY LAND SURVEY MONUMENT RECORD

Date of field work: 11-15-04

County Reference No. 2106400336

Type of Monument:                             Section Corner                      X   Quarter Corner  
             Bench Mark                             Other   

Your Description and Observation of Monument Found ( Be Specific ):  
 1919 USGLOS CAP @ GROUND LEVEL WITH A FOREST SERVICE SIGN TO THE WEST  
 AND TO THE SOUTH

Description of Monument, Reference Monument or Accessories Established by You to Perpetuate the  
 Location of this Point: SET 4 #4 REBAR AS SHOWN BELOW

Sketch showing Relative Location of Monument Accessories and Two Reference Points Stating Whether  
 Found or Set. Show Supporting and/or Contradictory Evidence where Applicable. Include North Arrow.

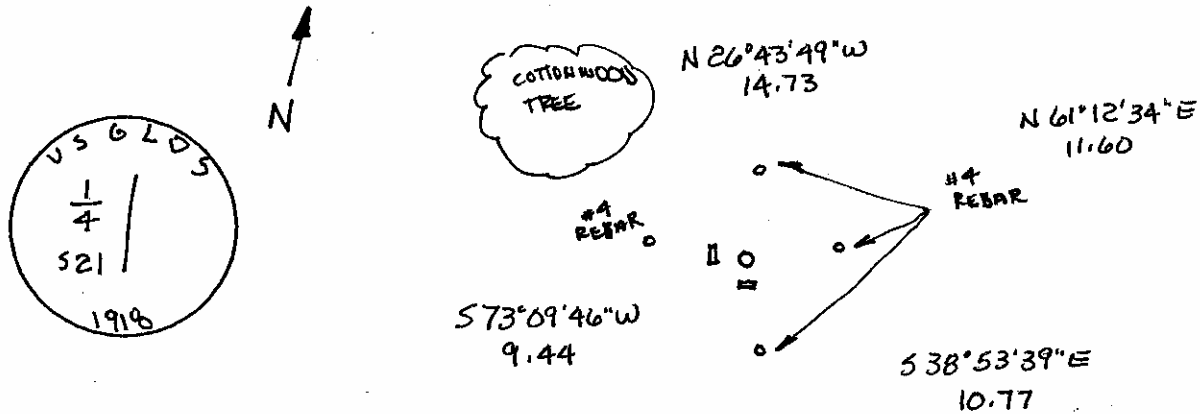

**Certification:**

Firm name and/or Surveyor: Johansen & Tuttle Eng.  
 Address: 90 S. 100 E. Castle Dale, Utah 84513 Phone: (435) 381-2523

This is to certify that I was in responsible charge of the surveying work described in this record and that to the best of my knowledge the information presented herein is true and correct.

**Location Diagram:**

Section: 21  
 Township: 21 S  
 Range: 6 E

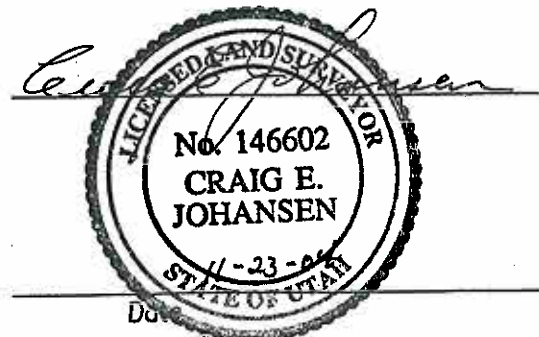
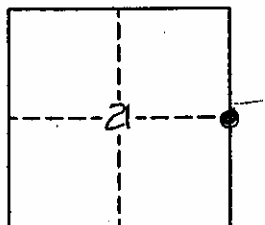



# EMERY COUNTY LAND SURVEY MONUMENT RECORD

Date of field work: 11-18-04

County Reference No. 2106 <sup>4003526</sup> ~~500360~~

Type of Monument:            Section Corner            Quarter Corner  
           Bench Mark   ✓   Other   1/16  

Your Description and Observation of Monument Found ( Be Specific ):  
 1996 FOREST SERVICE CAP IN A STONE MOUND WITH FOREST SERVICE SIGNS TO  
 THE NORTH AND WEST

Description of Monument, Reference Monument or Accessories Established by You to Perpetuate the  
 Location of this Point: SET 4 #4 REBAR AS SHOWN BELOW.

Sketch showing Relative Location of Monument Accessories and Two Reference Points Stating Whether  
 Found or Set. Show Supporting and/or Contradictory Evidence where Applicable. Include North Arrow.

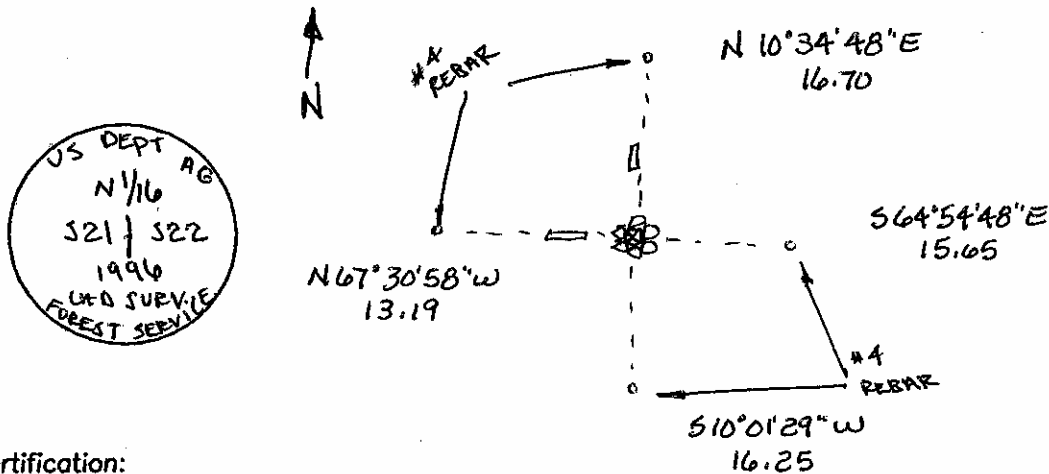

Certification:

Firm name and/or Surveyor: Johansen & Tuttle Eng.  
 Address: 90 S. 100 E. Castle Dale, Utah 84513 Phone: (435) 381-2523

This is to certify that I was in responsible charge of the surveying work described in this record and that to the best of my knowledge the information presented herein is true and correct.

Location Diagram:  
 Section: 21  
 Township: 21S  
 Range: 6E

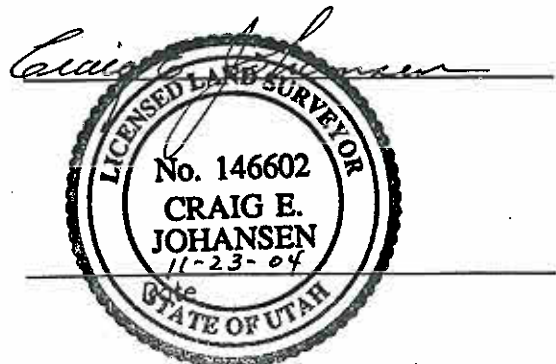
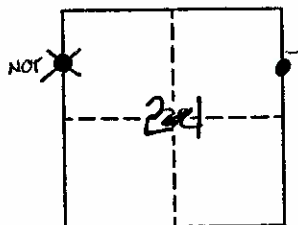

# EMERY COUNTY LAND SURVEY MONUMENT RECORD

Date of field work: 11-15-04

County Reference No. 2106400396

Type of Monument: X Section Corner  
 \_\_\_\_\_ Bench Mark

\_\_\_\_\_ Quarter Corner  
 \_\_\_\_\_ Other \_\_\_\_\_

Your Description and Observation of Monument Found ( Be Specific ):

1918 USGLOS CAP 6" ABOVE GROUND WITH A STONE MOUND TO THE NORTH  
 AND FOREST SERVICE SIGN TO THE NORTH

Description of Monument, Reference Monument or Accessories Established by You to Perpetuate the Location of this Point: SET A #5 REBAR AS SHOWN BELOW

Sketch showing Relative Location of Monument Accessories and Two Reference Points Stating Whether Found or Set. Show Supporting and/or Contradictory Evidence where Applicable. Include North Arrow.

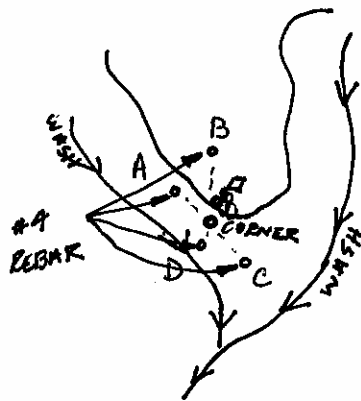
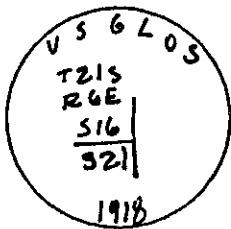

N ↑  
 A = N 75° 56' 31" W  
 15.22  
 B = N 4° 41' 06" E  
 16.93  
 C = S 67° 55' 39" E  
 15.35  
 D = S 9° 58' 21" W  
 12.00

Certification:

Firm name and/or Surveyor: Johansen & Tuttle Eng.

Address: 90 S. 100 E. Castle Dale, Utah 84513 Phone: (435) 381-2523

This is to certify that I was in responsible charge of the surveying work described in this record and that to the best of my knowledge the information presented herein is true and correct.

Location Diagram:

Section: 16  
 Township: 21S  
 Range: 6E

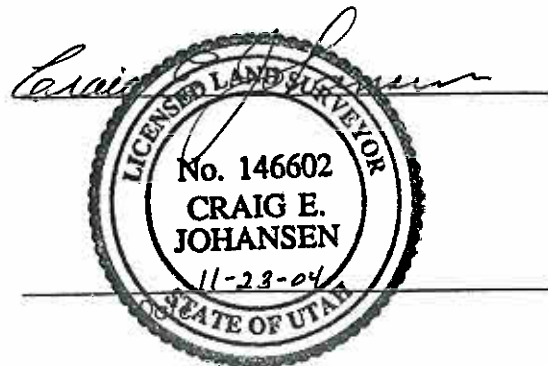
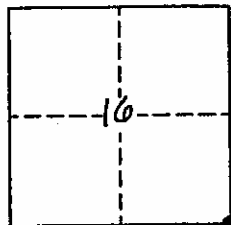



# EMERY COUNTY LAND SURVEY MONUMENT RECORD

Date of field work: 11-15-04 County Reference No. 2106400400

Type of Monument: X Section Corner        Quarter Corner  
       Bench Mark        Other       

Your Description and Observation of Monument Found ( Be Specific ):  
1919 US GLOS CAP IN FENCELINE WITH A STONE MOUND

Description of Monument, Reference Monument or Accessories Established by You to Perpetuate the Location of this Point: SET 4 #5 REBAR AS SHOWN BELOW

Sketch showing Relative Location of Monument Accessories and Two Reference Points Stating Whether Found or Set. Show Supporting and/or Contradictory Evidence where Applicable. Include North Arrow.

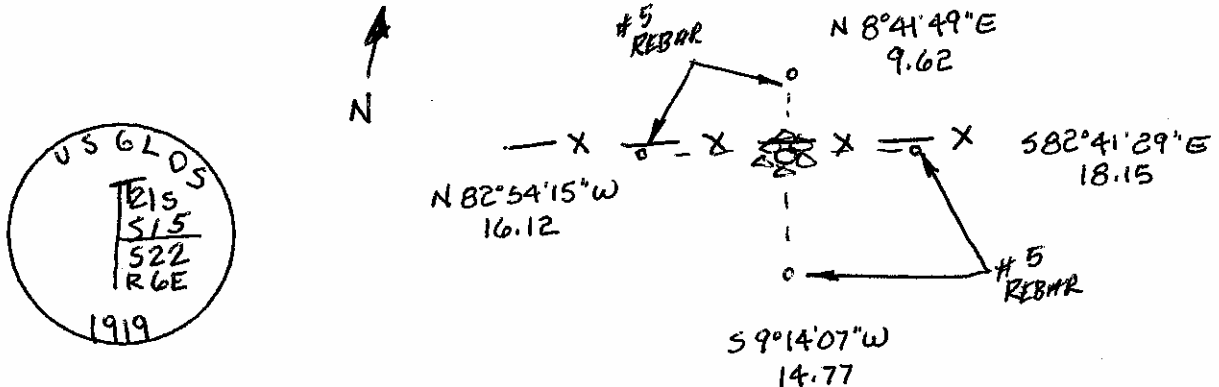

**Certification:**

Firm name and/or Surveyor: Johansen & Tuttle Eng.  
 Address: 90 S. 100 E. Castle Dale, Utah 84513 Phone: (435) 381-2523

This is to certify that I was in responsible charge of the surveying work described in this record and that to the best of my knowledge the information presented herein is true and correct.

**Location Diagram:**

Section: 15  
 Township: 21S  
 Range: 6E

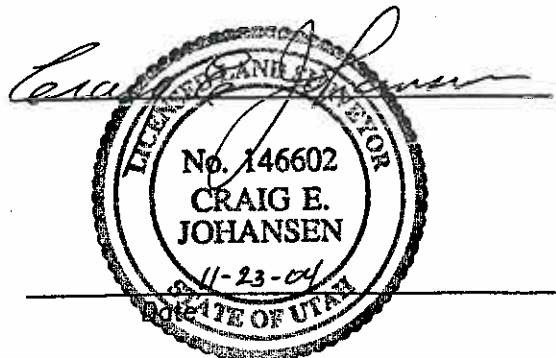
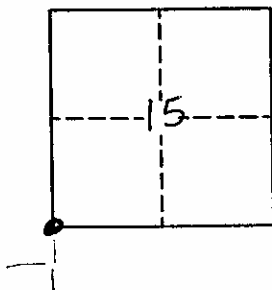

# EMERY COUNTY LAND SURVEY MONUMENT RECORD

Date of field work: 10-20-04

County Reference No. 2106440100

Type of Monument:            Section Corner   ✓   Quarter Corner  
           Bench Mark            Other           

Your Description and Observation of Monument Found ( Be Specific ):  
 1970 BLM CAP 6' ABOVE GROUND IN FENCELINE WITH A MOUND OF STONE  
 ON THE SOUTH SIDE OF CAP.

Description of Monument, Reference Monument or Accessories Established by You to Perpetuate the  
 Location of this Point: SET 4 #4 REBAR AS SHOWN BELOW.

Sketch showing Relative Location of Monument Accessories and Two Reference Points Stating Whether  
 Found or Set. Show Supporting and/or Contradictory Evidence where Applicable. Include North Arrow.

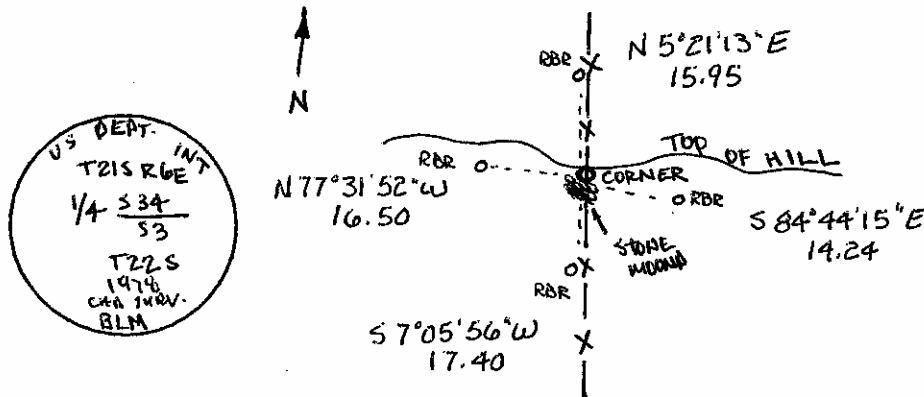

Certification:

Firm name and/or Surveyor: Johansen & Tuttle Eng.  
 Address: 90 S. 100 E. Castle Dale, Utah 84513 Phone: (435) 381-2523

This is to certify that I was in responsible charge of the surveying work described in this record and that to the best of my knowledge the information presented herein is true and correct.

Location Diagram:  
 Section: 34  
 Township: 21S  
 Range: 6E

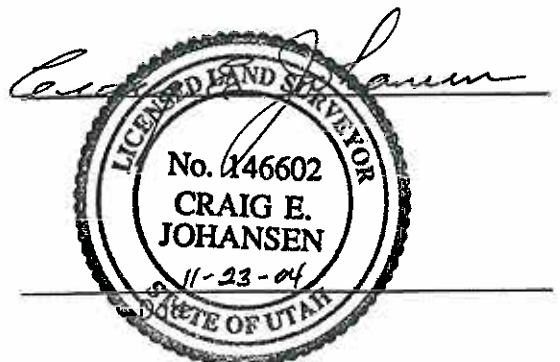
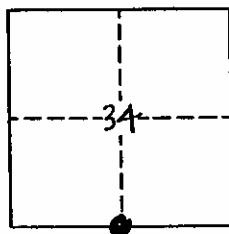



# EMERY COUNTY LAND SURVEY MONUMENT RECORD

Date of field work: 11-15-04

County Reference No. 2106440300

Type of Monument:  Section Corner  Quarter Corner  
 Bench Mark  Other \_\_\_\_\_

Your Description and Observation of Monument Found ( Be Specific ):  
1918 USGLOS CAP 10" ABOVE GROUND

Description of Monument, Reference Monument or Accessories Established by You to Perpetuate the Location of this Point: SET 4 #4 REBAR AS SHOWN BELOW

Sketch showing Relative Location of Monument Accessories and Two Reference Points Stating Whether Found or Set. Show Supporting and/or Contradictory Evidence where Applicable. Include North Arrow.

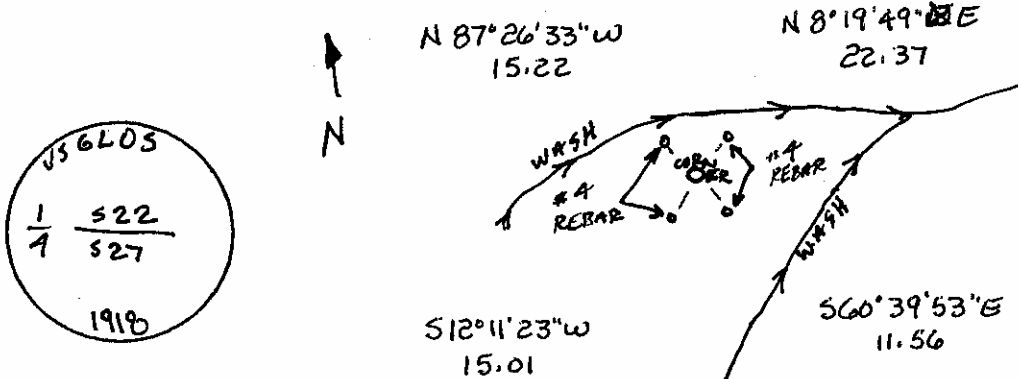

Certification:

Firm name and/or Surveyor: Johansen & Tuttle Eng.  
 Address: 90 S. 100 E. Castle Dale, Utah 84513 Phone: (435) 381-2523

This is to certify that I was in responsible charge of the surveying work described in this record and that to the best of my knowledge the information presented herein is true and correct.

Location Diagram:  
 Section: 22  
 Township: 21S  
 Range: 6E

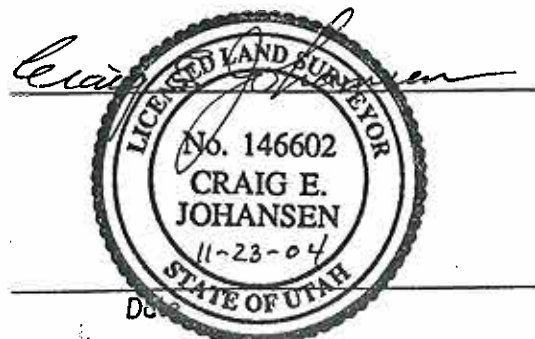
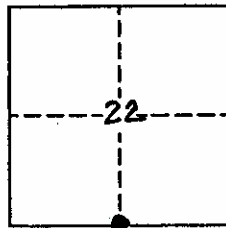



# EMERY COUNTY LAND SURVEY MONUMENT RECORD

Date of field work: 10-20-04

County Reference No. 2106500100

Type of Monument:       Section Corner       Quarter Corner  
                                   Bench Mark                       Other \_\_\_\_\_

Your Description and Observation of Monument Found ( Be Specific ):  
1978 BLM CAP BURIED 2" IN BOTTOM OF WASH WITH A CEDAR POST  
DRIVEN ALONGSIDE.

Description of Monument, Reference Monument or Accessories Established by You to Perpetuate the Location of this Point: SET 4 #4 REBAR AS SHOWN BELOW

Sketch showing Relative Location of Monument Accessories and Two Reference Points Stating Whether Found or Set. Show Supporting and/or Contradictory Evidence where Applicable. Include North Arrow.

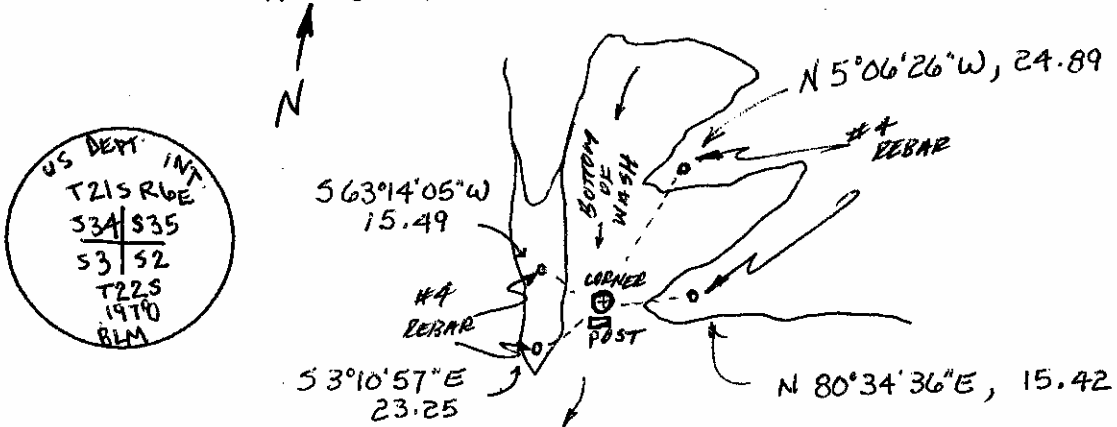

**Certification:**

Firm name and/or Surveyor: Johansen & Tuttle Eng.  
 Address: 90 S. 100 E. Castle Dale, Utah 84513 Phone: (435) 381-2523

This is to certify that I was in responsible charge of the surveying work described in this record and that to the best of my knowledge the information presented herein is true and correct.

Location Diagram:  
 Section: 35  
 Township: 21s  
 Range: 6E

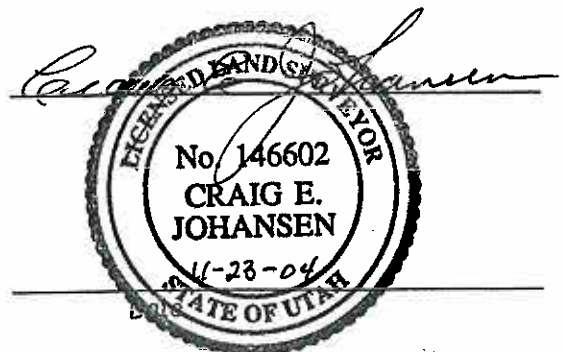
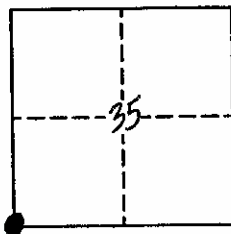

# EMERY COUNTY LAND SURVEY MONUMENT RECORD

Date of field work: 11-1-04

County Reference No. 2106500140

Type of Monument: \_\_\_\_\_ Section Corner  
 \_\_\_\_\_ Bench Mark

Quarter Corner  
 \_\_\_\_\_ Other \_\_\_\_\_

Your Description and Observation of Monument Found ( Be Specific ):

1979 BLM CAP 4" ABOVE GROUND WITH A CEDARPOST PLANTED ON NORTH SIDE

Description of Monument, Reference Monument or Accessories Established by You to Perpetuate the Location of this Point: SET 4 #4 REBAR AS SHOWN BELOW

Sketch showing Relative Location of Monument Accessories and Two Reference Points Stating Whether Found or Set. Show Supporting and/or Contradictory Evidence where Applicable. Include North Arrow.

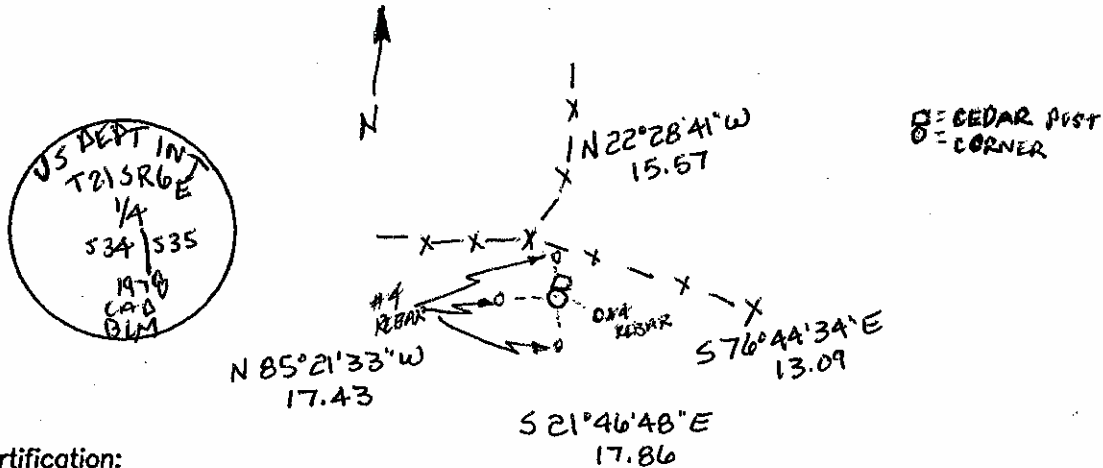

Certification:

Firm name and/or Surveyor: Johansen & Tuttle Eng.

Address: 90 S. 100 E. Castle Dale, Utah 84513 Phone: (435) 381-2523

This is to certify that I was in responsible charge of the surveying work described in this record and that to the best of my knowledge the information presented herein is true and correct.

Location Diagram:

Section: 34

Township: 21S

Range: 6E

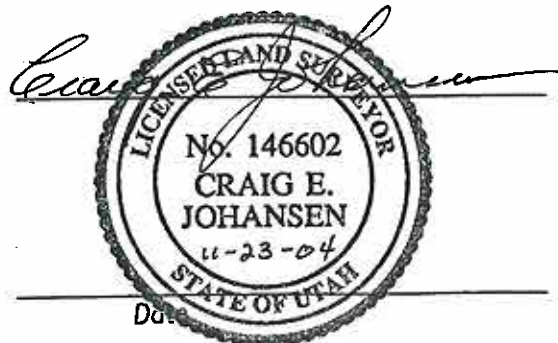
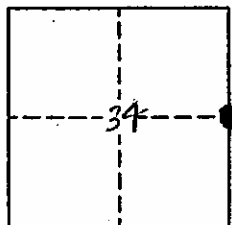

Date: \_\_\_\_\_

# EMERY COUNTY LAND SURVEY MONUMENT RECORD

Date of field work: 10-19-04

County Reference No. 210p50b200

Type of Monument:  Section Corner  Quarter Corner  
 Bench Mark  Other \_\_\_\_\_

Your Description and Observation of Monument Found ( Be Specific ):  
1919 USGLOS CAP 6" ABOVE GROUND @ FENCE INTERSECTION

Description of Monument, Reference Monument or Accessories Established by You to Perpetuate the Location of this Point: SET 4 #5 REBAR AS SHOWN BELOW.

Sketch showing Relative Location of Monument Accessories and Two Reference Points Stating Whether Found or Set. Show Supporting and/or Contradictory Evidence where Applicable. Include North Arrow.

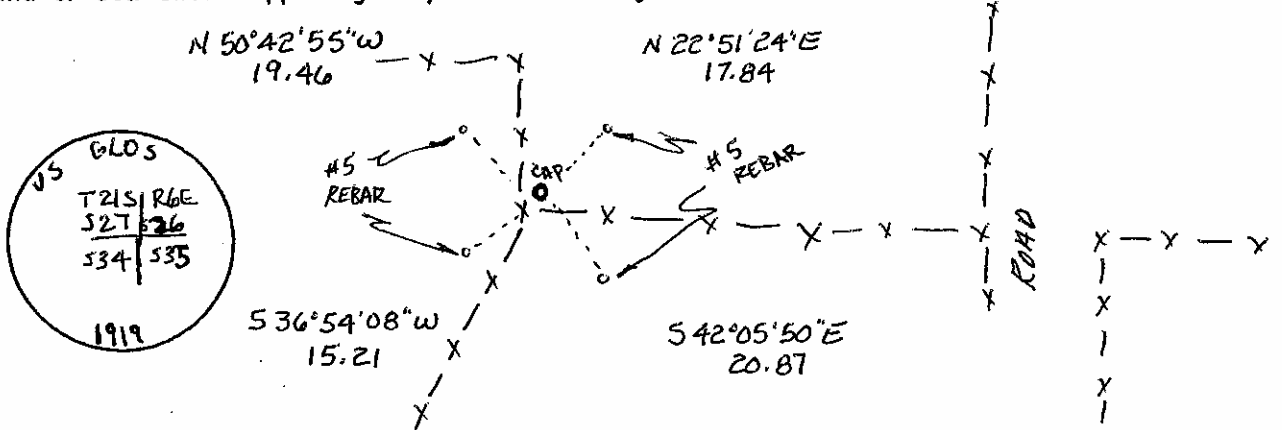

Certification:

Firm name and/or Surveyor: Johansen & Tuttle Eng.  
 Address: 90 S. 100 E. Castle Dale, Utah 84513 Phone: (435) 381-2523

This is to certify that I was in responsible charge of the surveying work described in this record and that to the best of my knowledge the information presented herein is true and correct.

Location Diagram:  
 Section: 26  
 Township: 21S  
 Range: 6E

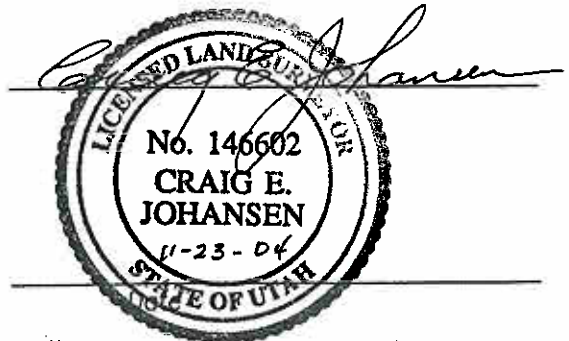
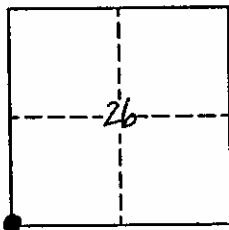



# EMERY COUNTY LAND SURVEY MONUMENT RECORD

Date of field work: 10-19-04

County Reference No. 2106500240

Type of Monument:  Section Corner  
 Bench Mark

Quarter Corner  
 Other \_\_\_\_\_

Your Description and Observation of Monument Found ( Be Specific ):

1918 GLD CAP 12" ABOVE GROUND IN FENCE LINE

Description of Monument, Reference Monument or Accessories Established by You to Perpetuate the Location of this Point: SET 4 #5 REBAR AS SHOWN BELOW

Sketch showing Relative Location of Monument Accessories and Two Reference Points Stating Whether Found or Set. Show Supporting and/or Contradictory Evidence where Applicable. Include North Arrow.

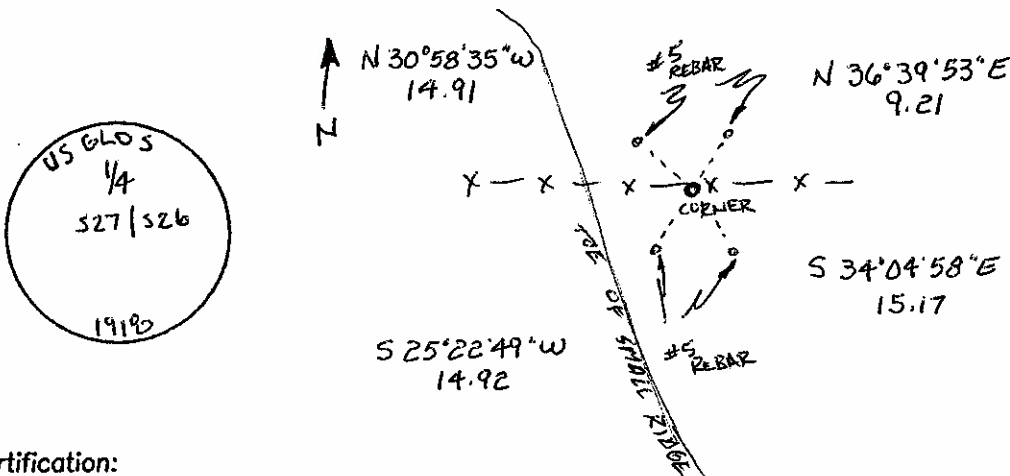

Certification:

Firm name and/or Surveyor: Johansen & Tuttle Eng.

Address: 90 S. 100 E. Castle Dale, Utah 84513 Phone: (435) 381-2523

This is to certify that I was in responsible charge of the surveying work described in this record and that to the best of my knowledge the information presented herein is true and correct.

Location Diagram:

Section: 26  
 Township: 21S  
 Range: 6E

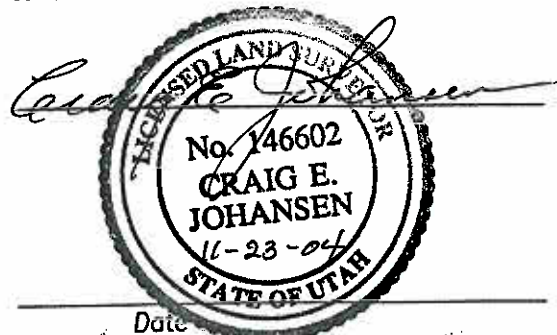
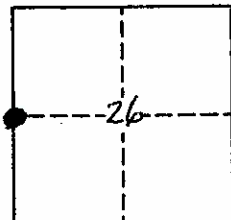

Date \_\_\_\_\_

# EMERY COUNTY LAND SURVEY MONUMENT RECORD

Date of field work: 10-19-04

County Reference No. 2106 500 300

Type of Monument:             Section Corner             Quarter Corner  
     Bench Mark                     Other \_\_\_\_\_

Your Description and Observation of Monument Found ( Be Specific ):  
1978 BLM CAP 4" ABOVE GROUND WITH A STONE MOUND ON THE SOUTH SIDE OF MONUMENT

Description of Monument, Reference Monument or Accessories Established by You to Perpetuate the Location of this Point: SET 4 #5 REBAR (RBR) AS SHOWN BELOW.

Sketch showing Relative Location of Monument Accessories and Two Reference Points Stating Whether Found or Set. Show Supporting and/or Contradictory Evidence where Applicable. Include North Arrow.

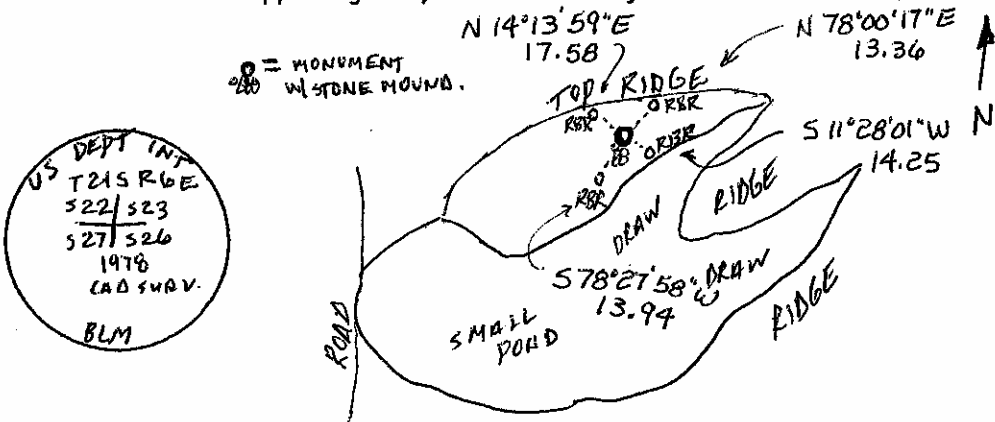

**Certification:**

Firm name and/or Surveyor: Johansen & Tuttle Eng.  
 Address: 90 S. 100 E. Castle Dale, Utah 84513 Phone: (435) 381-2523

This is to certify that I was in responsible charge of the surveying work described in this record and that to the best of my knowledge the information presented herein is true and correct.

Location Diagram:

Section: 22  
 Township: 21S  
 Range: 6E

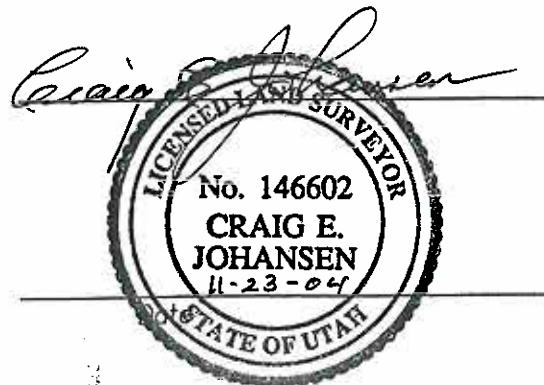
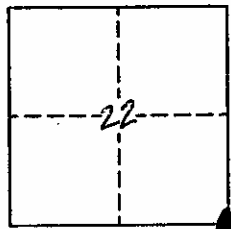

# EMERY COUNTY LAND SURVEY MONUMENT RECORD

Date of field work: 10-19-04

County Reference No. 2106500340

Type of Monument:  Section Corner  Quarter Corner  
 Bench Mark  Other \_\_\_\_\_

Your Description and Observation of Monument Found ( Be Specific ):  
 1918 USGLO CAP BURIED 8" UNDER GROUND WITH A STEEL FENCE POST  
 DRIVEN ALONG SIDE.

Description of Monument, Reference Monument or Accessories Established by You to Perpetuate the  
 Location of this Point: SET 4 #5 REBAR AS SHOWN BELOW.

Sketch showing Relative Location of Monument Accessories and Two Reference Points Stating Whether  
 Found or Set. Show Supporting and/or Contradictory Evidence where Applicable. Include North Arrow.

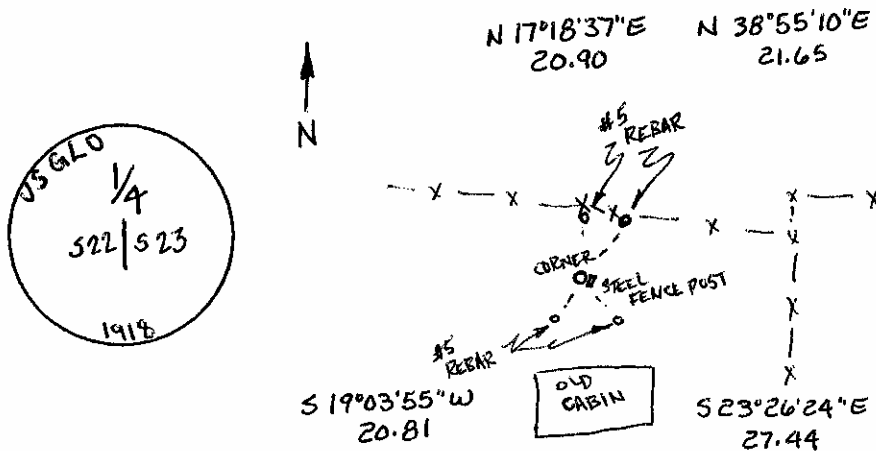

Certification:

Firm name and/or Surveyor: Johansen & Tuttle Eng.  
 Address: 90 S. 100 E. Castle Dale, Utah 84513 Phone: (435) 381-2523

This is to certify that I was in responsible charge of the surveying work described in this record and that to the best of my knowledge the information presented herein is true and correct.

Location Diagram:  
 Section: 22  
 Township: 21S  
 Range: 6E

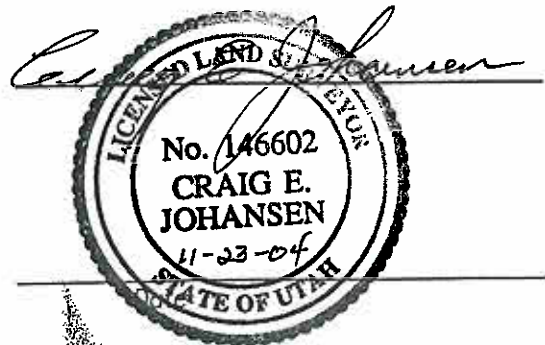
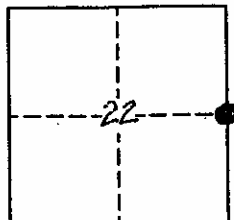

# EMERY COUNTY LAND SURVEY MONUMENT RECORD

Date of field work: 11-15-04

County Reference No. 2106500400

Type of Monument: X Section Corner  
 \_\_\_\_\_ Bench Mark

\_\_\_\_\_ Quarter Corner  
 \_\_\_\_\_ Other \_\_\_\_\_

Your Description and Observation of Monument Found ( Be Specific ):

1919 USGLOS CAP 10" ABOVE GROUND WITH A STONE MOUND AND A FOREST SIGN TO THE WEST.

Description of Monument, Reference Monument or Accessories Established by You to Perpetuate the Location of this Point: SET 4 #5 REBAR AS SHOWN BELOW

Sketch showing Relative Location of Monument Accessories and Two Reference Points Stating Whether Found or Set. Show Supporting and/or Contradictory Evidence where Applicable. Include North Arrow.

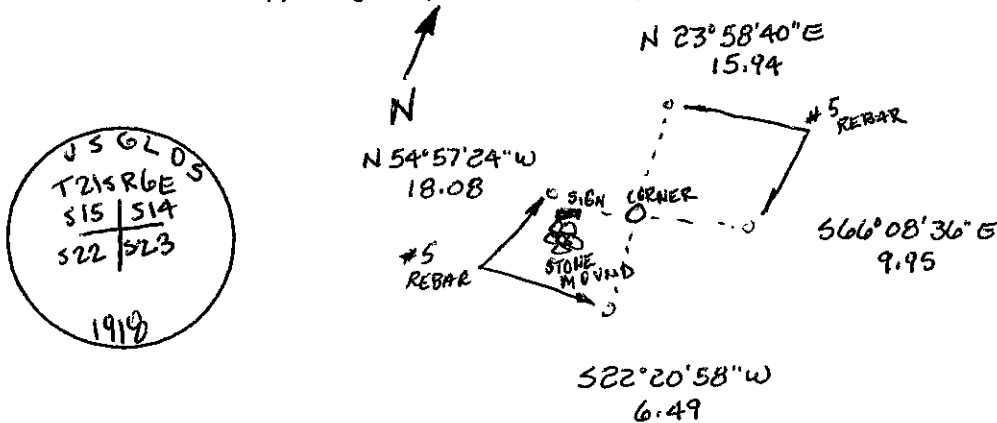

Certification:

Firm name and/or Surveyor: Johansen & Tuttle Eng.

Address: 90 S. 100 E. Castle Dale, Utah 84513 Phone: (435) 381-2523

This is to certify that I was in responsible charge of the surveying work described in this record and that to the best of my knowledge the information presented herein is true and correct.

Location Diagram:

Section: 15  
 Township: 21 S  
 Range: 6 E

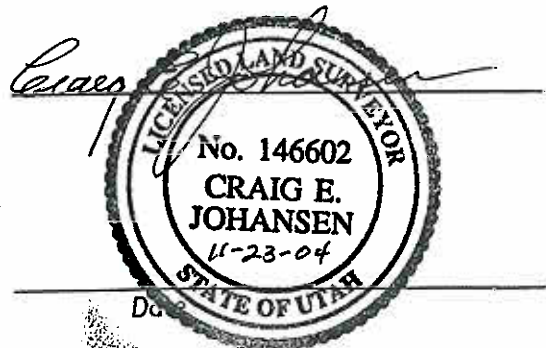
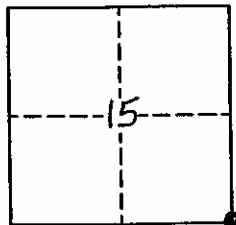

# EMERY COUNTY LAND SURVEY MONUMENT RECORD

Date of field work: 11-11-04

County Reference No. 2106520100

Type of Monument:  Section Corner  
 Bench Mark

Quarter Corner  
 Other 1/16

Your Description and Observation of Monument Found ( Be Specific ):

1978 BLM CAP 3" ABOVE GROUND WITH A CEDAR POST PLANTED ALONGSIDE

Description of Monument, Reference Monument or Accessories Established by You to Perpetuate the Location of this Point: SET A #4 REBAR AS SHOWN BELOW

Sketch showing Relative Location of Monument Accessories and Two Reference Points Stating Whether Found or Set. Show Supporting and/or Contradictory Evidence where Applicable. Include North Arrow.

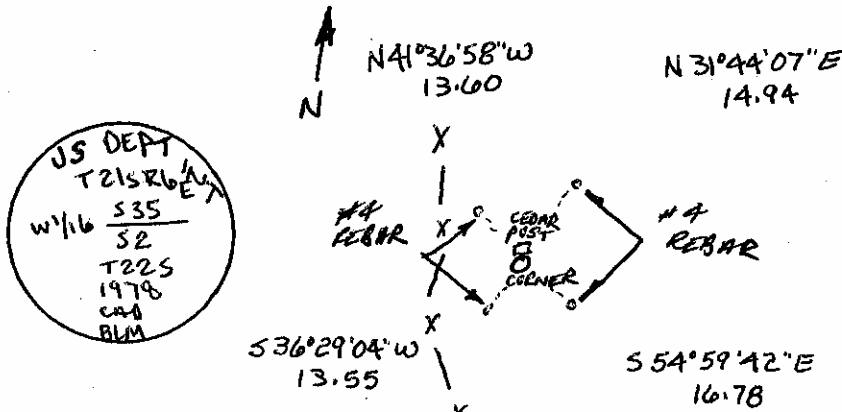

US DEPT  
 T215R6E  
 W1/16 S35  
 S2  
 T22S  
 1978  
 CAP  
 BLM

Certification:

Firm name and/or Surveyor: Johansen & Tuttle Eng.

Address: 90 S. 100 E. Castle Dale, Utah 84513 Phone: (435) 381-2523

This is to certify that I was in responsible charge of the surveying work described in this record and that to the best of my knowledge the information presented herein is true and correct.

Location Diagram:

Section: 35  
 Township: 215  
 Range: 6E

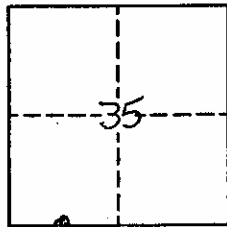

# EMERY COUNTY LAND SURVEY MONUMENT RECORD

Date of field work: 10-19-04 County Reference No. 2106520200

Type of Monument:            Section Corner            Quarter Corner  
           Bench Mark             Other 1/16

Your Description and Observation. of Monument Found ( Be Specific ):  
 1970 BLM CAP 10" ABOVE GROUND

Description of Monument, Reference Monument or Accessories Established by You to Perpetuate the Location of this Point: SET + #5 REBAR AS SHOWN BELOW.

Sketch showing Relative Location of Monument Accessories and Two Reference Points Stating Whether Found or Set. Show Supporting and/or Contradictory Evidence where Applicable. Include North Arrow.

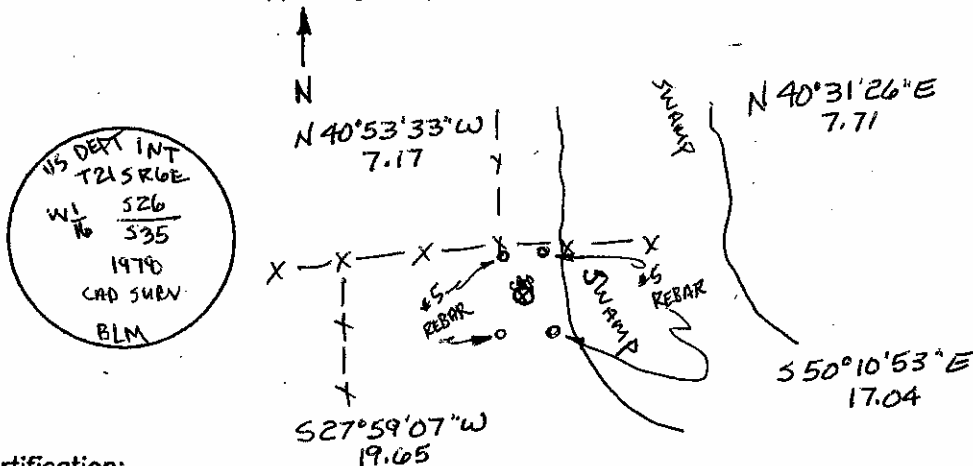

Certification:

Firm name and/or Surveyor: Johansen & Tuttle Eng.  
 Address: 90 S. 100 E. Castle Dale, Utah 84513 Phone: (435) 381-2523

This is to certify that I was in responsible charge of the surveying work described in this record and that to the best of my knowledge the information presented herein is true and correct.

Location Diagram:  
 Section: 35  
 Township: 21S  
 Range: 6E

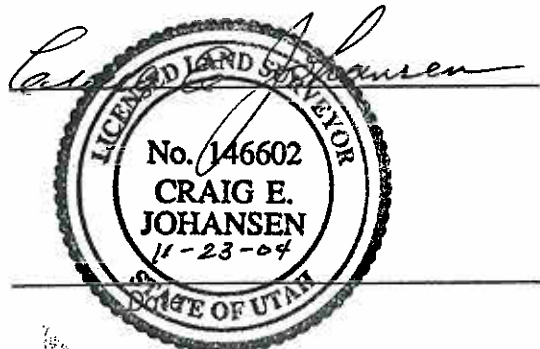
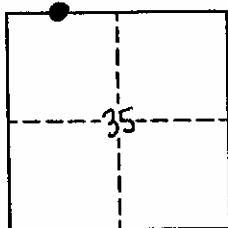

# EMERY COUNTY LAND SURVEY MONUMENT RECORD

Date of field work: 11-11-04

County Reference No. 2106540100

Type of Monument: \_\_\_\_\_ Section Corner  Quarter Corner  
 \_\_\_\_\_ Bench Mark \_\_\_\_\_ Other \_\_\_\_\_

Your Description and Observation of Monument Found ( Be Specific ):  
1978 BLM CAP 9" ABOVE GROUND IN A FENCELINE

Description of Monument, Reference Monument or Accessories Established by You to Perpetuate the Location of this Point: SET 4 #4 REBAR AS SHOWN BELOW

Sketch showing Relative Location of Monument Accessories and Two Reference Points Stating Whether Found or Set. Show Supporting and/or Contradictory Evidence where Applicable. Include North Arrow.

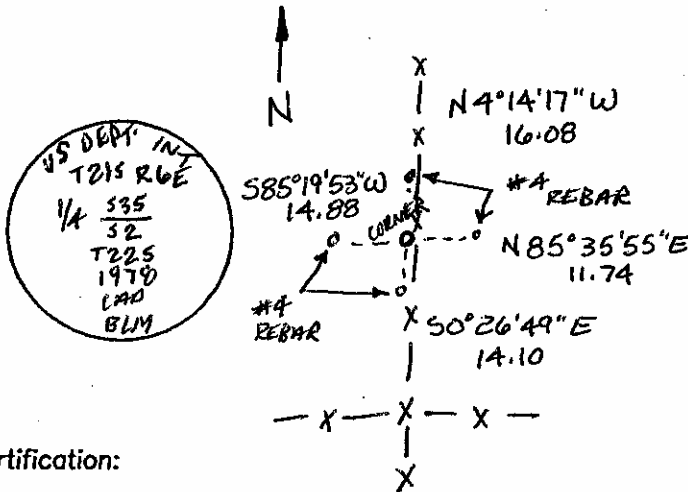

Certification:

Firm name and/or Surveyor: Johansen & Tuttle Eng.  
 Address: 90 S. 100 E. Castle Dale, Utah 84513 Phone: (435) 381-2523

This is to certify that I was in responsible charge of the surveying work described in this record and that to the best of my knowledge the information presented herein is true and correct.

Location Diagram:  
 Section: 35  
 Township: 21S  
 Range: 06E

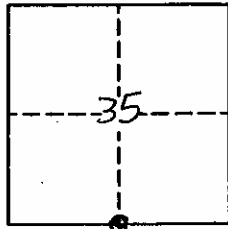

*Craig E. Johansen*  
 LICENSED SURVEYOR  
 No. 146602  
 CRAIG E. JOHANSEN  
 11-24-04  
 STATE OF UTAH

# EMERY COUNTY LAND SURVEY MONUMENT RECORD

Date of field work: 10-19-04

County Reference No. 2106540200

Type of Monument: \_\_\_\_\_ Section Corner  
 \_\_\_\_\_ Bench Mark

Quarter Corner  
 \_\_\_\_\_ Other \_\_\_\_\_

Your Description and Observation of Monument Found ( Be Specific ):

1978 BLM CAP 6" ABOVE GROUND

Description of Monument, Reference Monument or Accessories Established by You to Perpetuate the Location of this Point: SET 4 #5 REBAR AS SHOWN BELOW

Sketch showing Relative Location of Monument Accessories and Two Reference Points Stating Whether Found or Set. Show Supporting and/or Contradictory Evidence where Applicable. Include North Arrow.

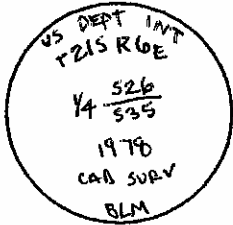
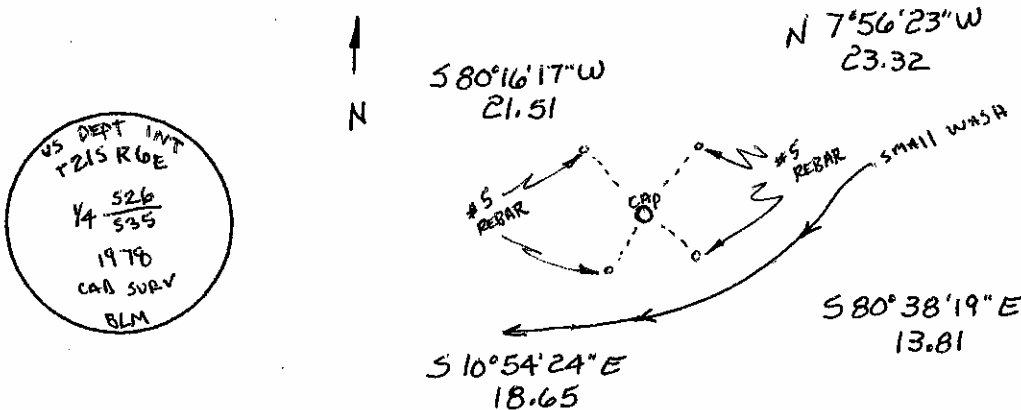

Certification:

Firm name and/or Surveyor: Johansen & Tuttle Eng.

Address: 90 S. 100 E. Castle Dale, Utah 84513 Phone: (435) 381-2523

This is to certify that I was in responsible charge of the surveying work described in this record and that to the best of my knowledge the information presented herein is true and correct.

Location Diagram:  
 Section: 26  
 Township: 21S  
 Range: 6E

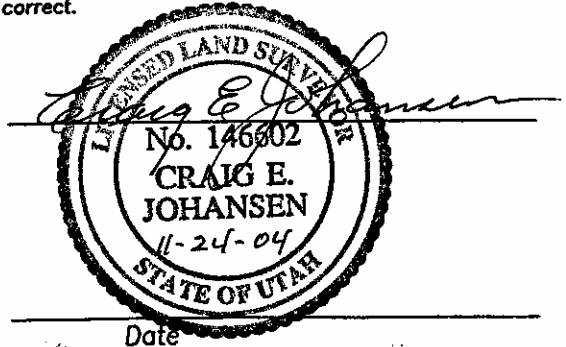
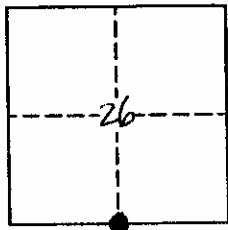

Date



# EMERY COUNTY LAND SURVEY MONUMENT RECORD

Date of field work: 10-19-04

County Reference No. 2106540300

Type of Monument: \_\_\_\_\_ Section Corner  
 \_\_\_\_\_ Bench Mark

Quarter Corner  
 \_\_\_\_\_ Other \_\_\_\_\_

Your Description and Observation of Monument Found ( Be Specific ):  
 1978 BLM CAP 8" ABOVE GROUND

Description of Monument, Reference Monument or Accessories Established by You to Perpetuate the Location of this Point: SET  $\uparrow$  #5 REBAR AS SHOWN BELOW

Sketch showing Relative Location of Monument Accessories and Two Reference Points Stating Whether Found or Set. Show Supporting and/or Contradictory Evidence where Applicable. Include North Arrow.

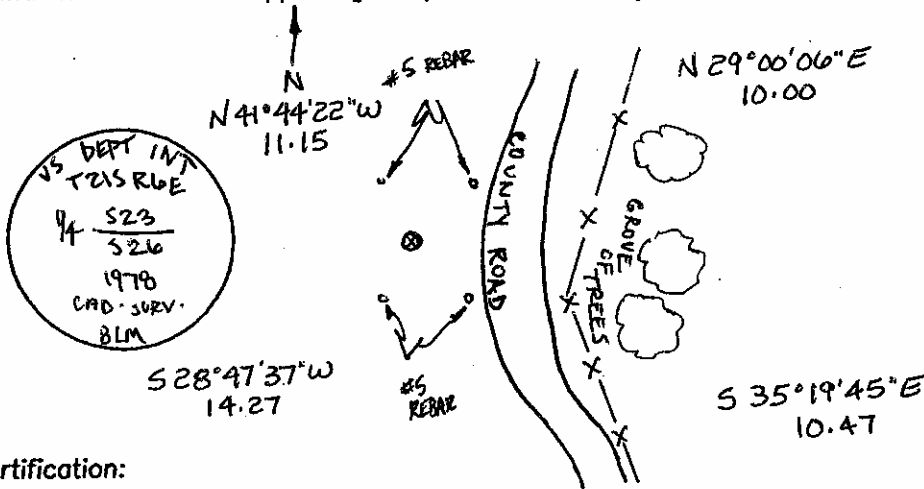

Certification:

Firm name and/or Surveyor: Johansen & Tuttle Eng.

Address: 90 S. 100 E. Castle Dale, Utah 84513 Phone: (435) 381-2523

This is to certify that I was in responsible charge of the surveying work described in this record and that to the best of my knowledge the information presented herein is true and correct.

Location Diagram:

Section: 23  
 Township: 21S  
 Range: 6E

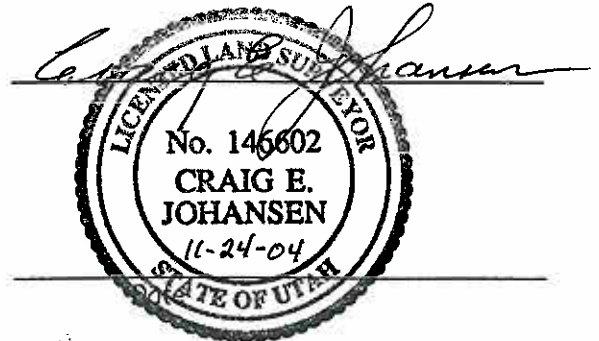
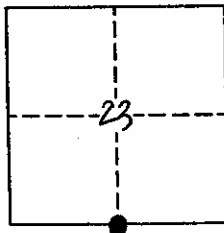

# EMERY COUNTY LAND SURVEY MONUMENT RECORD

Date of field work: 11-18-04

County Reference No. 2106540400

Type of Monument:          Section Corner  
         Bench Mark

Quarter Corner  
         Other                                 

Your Description and Observation of Monument Found ( Be Specific ):  
1918 USGLOS CAP 12" UNDER GROUND

Description of Monument, Reference Monument or Accessories Established by You to Perpetuate the Location of this Point: SET 4 #4 REBAR AS SHOWN BELOW  
BUILT STONE MOUND TO THE EAST OF MONUMENT

Sketch showing Relative Location of Monument Accessories and Two Reference Points Stating Whether Found or Set. Show Supporting and/or Contradictory Evidence where Applicable. Include North Arrow.

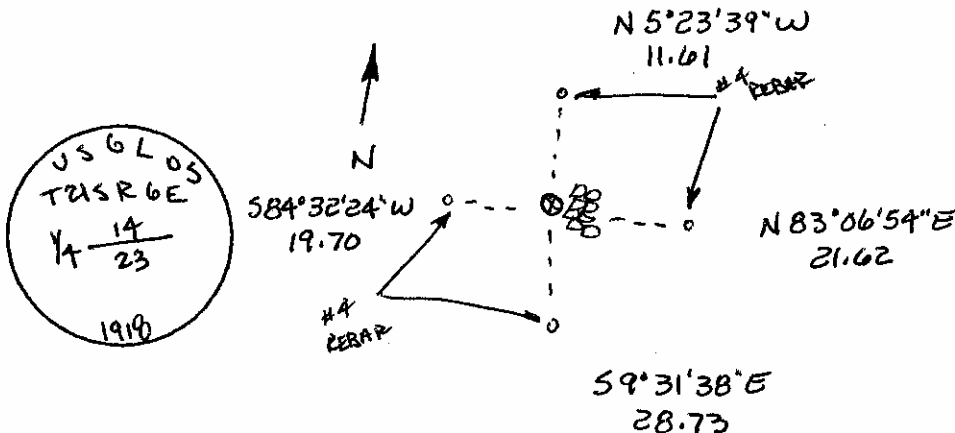

Certification:

Firm name and/or Surveyor: Johansen & Tuttle Eng.

Address: 90 S. 100 E. Castle Dale, Utah 84513 Phone: (435) 381-2523

This is to certify that I was in responsible charge of the surveying work described in this record and that to the best of my knowledge the information presented herein is true and correct.

Location Diagram:  
 Section: 23  
 Township: 21S  
 Range: 6E

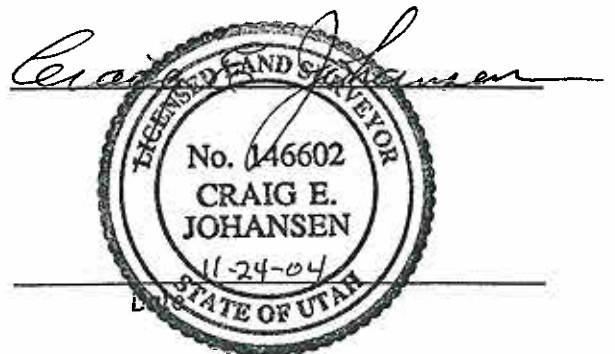
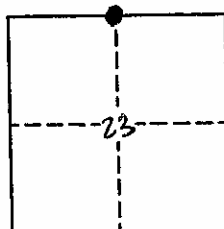

# EMERY COUNTY LAND SURVEY MONUMENT RECORD

Date of field work: 11-11-04

County Reference No. 2106560100

Type of Monument:            Section Corner  
           Bench Mark

           Quarter Corner  
 Other 1/16

Your Description and Observation of Monument Found ( Be Specific ):  
 1970 BLM CAP 8" ABOVE GROUND IN FENCE CORNER

Description of Monument, Reference Monument or Accessories Established by You to Perpetuate the Location of this Point: SET 4 #4 REBAR AS SHOWN BELOW

Sketch showing Relative Location of Monument Accessories and Two Reference Points Stating Whether Found or Set. Show Supporting and/or Contradictory Evidence where Applicable. Include North Arrow.

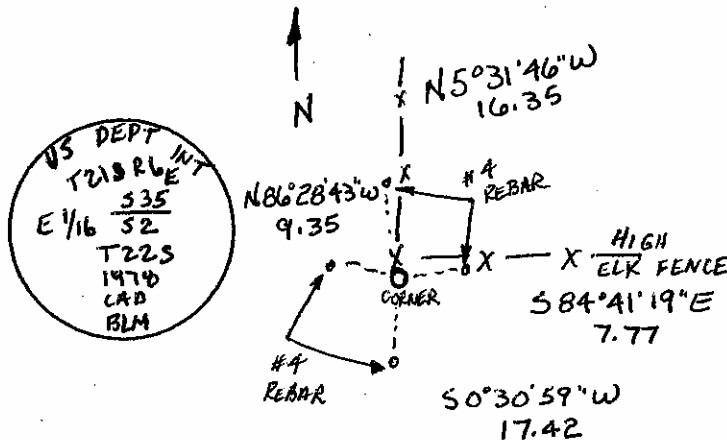

Certification:

Firm name and/or Surveyor: Johansen & Tuttle Eng.

Address: 90 S. 100 E. Castle Dale, Utah 84513 Phone: (435) 381-2523

This is to certify that I was in responsible charge of the surveying work described in this record and that to the best of my knowledge the information presented herein is true and correct.

Location Diagram:

Section: 35  
 Township: 21S  
 Range: 6E

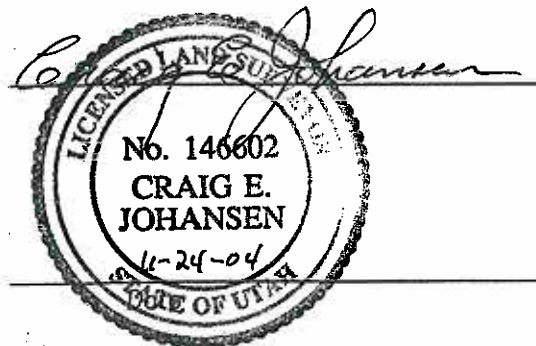
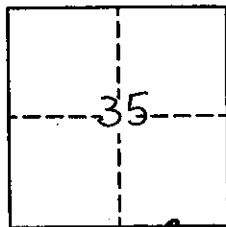

# EMERY COUNTY LAND SURVEY MONUMENT RECORD

Date of field work: 10-19-04

County Reference No. 2106600100

Type of Monument:  Section Corner  Quarter Corner  
 Bench Mark  Other \_\_\_\_\_

Your Description and Observation of Monument Found ( Be Specific ):  
 1970 BLM CAP 1' ABOVE GROUND WITH A WOODEN LATHE DRIVEN ALONGSIDE  
 A SMALL MOUND OF STONE IS ON THE WEST OF CAP.

Description of Monument, Reference Monument or Accessories Established by You to Perpetuate the Location of this Point: SET 4 #5 REBAR AS SHOWN BELOW

Sketch showing Relative Location of Monument Accessories and Two Reference Points Stating Whether Found or Set. Show Supporting and/or Contradictory Evidence where Applicable. Include North Arrow.

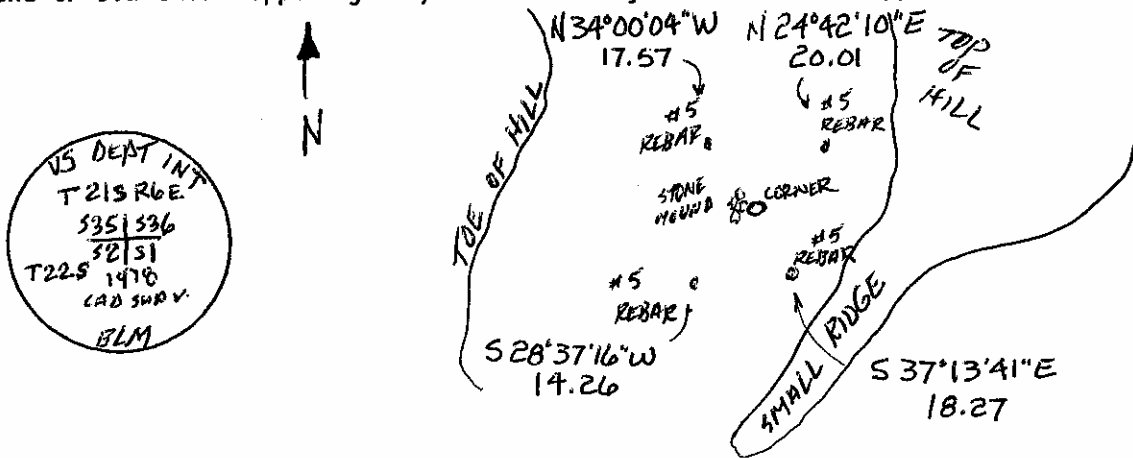

Certification:

Firm name and/or Surveyor: Johansen & Tuttle Eng.  
 Address: 90 S. 100 E. Castle Dale, Utah 84513 Phone: (435) 381-2523

This is to certify that I was in responsible charge of the surveying work described in this record and that to the best of my knowledge the information presented herein is true and correct.

Location Diagram:  
 Section: 35  
 Township: 21S  
 Range: 6E

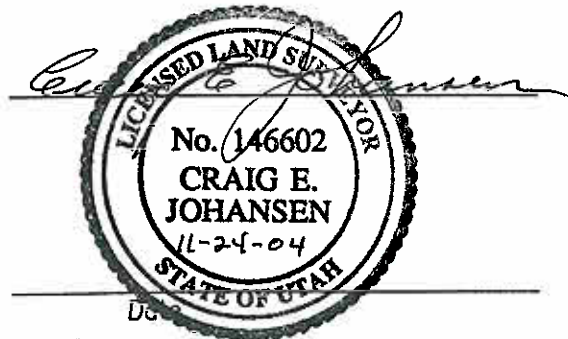
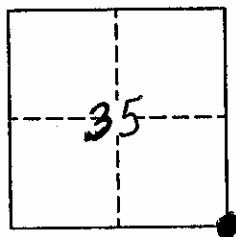

# EMERY COUNTY LAND SURVEY MONUMENT RECORD

Date of field work: 10-18-04

County Reference No. 2106600140

Type of Monument:            Section Corner   ✓   Quarter Corner  
           Bench Mark            Other           

Your Description and Observation of Monument Found ( Be Specific ):  
 1978 BLM CAP 12" OUT OF GROUND LEANING SLIGHTLY WEST

Description of Monument, Reference Monument or Accessories Established by You to Perpetuate the Location of this Point: SET A #5 REBAR AS SHOWN BELOW  
BUILT STONE MOUND AROUND MONUMENT

Sketch showing Relative Location of Monument Accessories and Two Reference Points Stating Whether Found or Set. Show Supporting and/or Contradictory Evidence where Applicable. Include North Arrow.

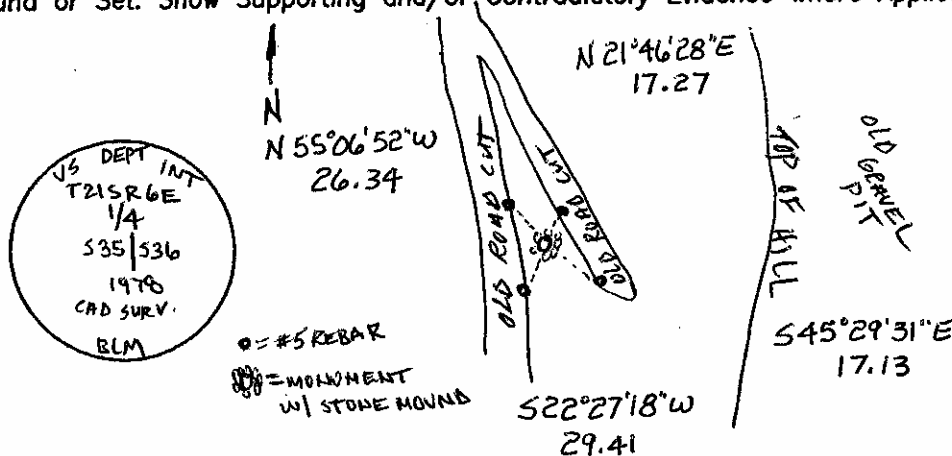

Certification:

Firm name and/or Surveyor: Johansen & Tuttle Eng.

Address: 90 S. 100 E. Castle Dale, Utah 84513 Phone: (435) 381-2523

This is to certify that I was in responsible charge of the surveying work described in this record and that to the best of my knowledge the information presented herein is true and correct.

Location Diagram:

Section: 35  
 Township: 21S  
 Range: 6E

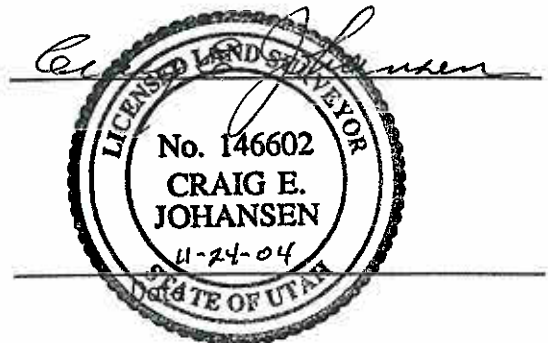
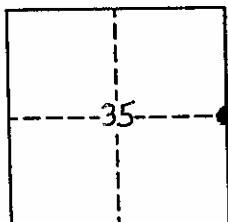

# EMERY COUNTY LAND SURVEY MONUMENT RECORD

Date of field work: 10-19-04

County Reference No. 2106600200

Type of Monument:  Section Corner  
 Bench Mark

Quarter Corner  
 Other \_\_\_\_\_

Your Description and Observation of Monument Found ( Be Specific ):

1978 BLM CAP BURIED 3" UNDERGROUND WITH A CEDAR POST PLANTED ALONGSIDE.

Description of Monument, Reference Monument or Accessories Established by You to Perpetuate the Location of this Point: SET 4 #5 REBAR AS SHOWN BELOW.

Sketch showing Relative Location of Monument Accessories and Two Reference Points Stating Whether Found or Set. Show Supporting and/or Contradictory Evidence where Applicable. Include North Arrow.

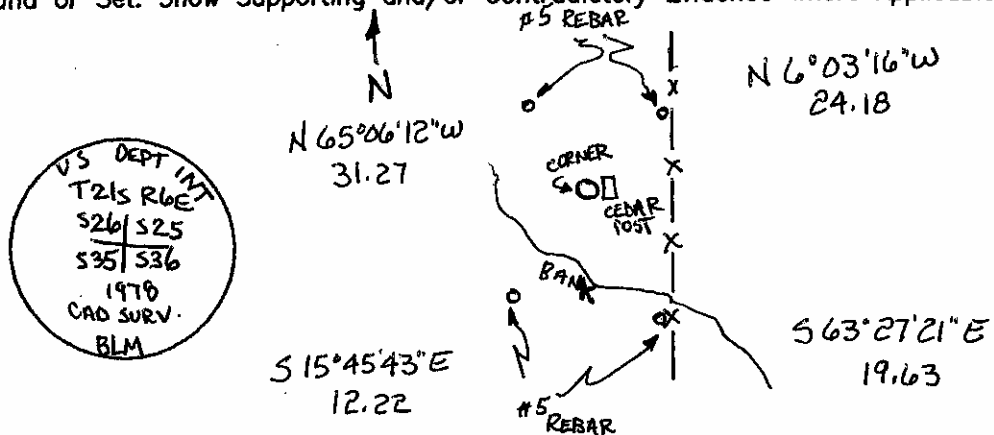

Certification:

Firm name and/or Surveyor: Johansen & Tuttle Eng.

Address: 90 S. 100 E. Castle Dale, Utah 84513 Phone: (435) 381-2523

This is to certify that I was in responsible charge of the surveying work described in this record and that to the best of my knowledge the information presented herein is true and correct.

Location Diagram:

Section: 26  
 Township: 21S  
 Range: 6E

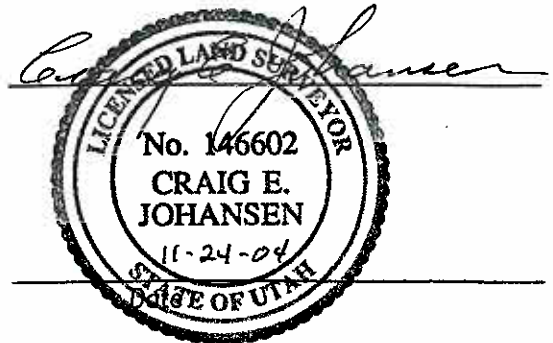
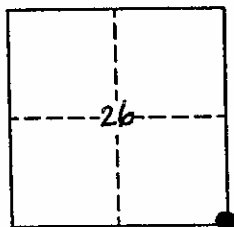

# EMERY COUNTY LAND SURVEY MONUMENT RECORD

Date of field work: 10-19-04

County Reference No. 2106600240

Type of Monument:            Section Corner   ✓   Quarter Corner  
           Bench Mark            Other                                   

Your Description and Observation of Monument Found ( Be Specific ):  
 1978 BLM CAP 8" ABOVE GROUND WITH A CEDAR POST PLANTED ON THE WEST SIDE OF CAP.  
 A SMALL STONE MOUND IS ON NORTH SIDE OF CAP  
 FOUND 4 #5 REBAR AS SHOWN BELOW

Description of Monument, Reference Monument or Accessories Established by You to Perpetuate the Location of this Point: FLAGGED

Sketch showing Relative Location of Monument Accessories and Two Reference Points Stating Whether Found or Set. Show Supporting and/or Contradictory Evidence where Applicable. Include North Arrow.

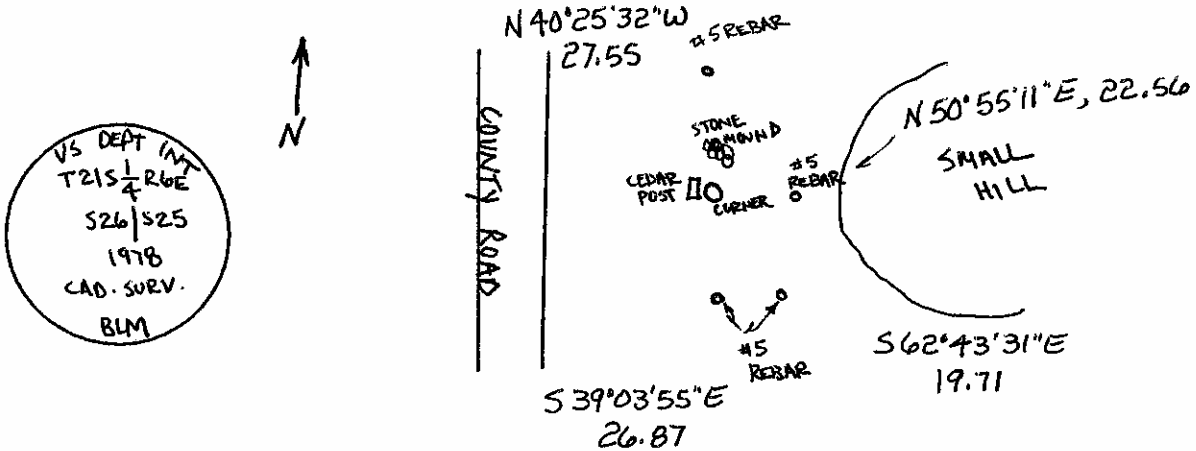

Certification:

Firm name and/or Surveyor: Johansen & Tuttle Eng.  
 Address: 90 S. 100 E. Castle Dale, Utah 84513 Phone: (435) 381-2523

This is to certify that I was in responsible charge of the surveying work described in this record and that to the best of my knowledge the information presented herein is true and correct.

Location Diagram:  
 Section: 26  
 Township: 21S  
 Range: 6E

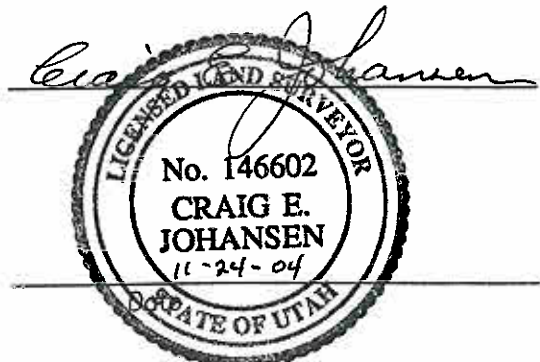
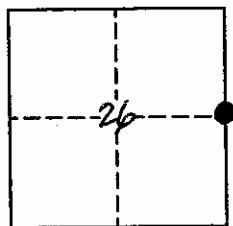

# EMERY COUNTY LAND SURVEY MONUMENT RECORD

Date of field work: 11-17-04

County Reference No. 2106600300

Type of Monument:             Section Corner                             Quarter Corner  
     Bench Mark                                     Other \_\_\_\_\_

Your Description and Observation of Monument Found ( Be Specific ):  
1918 USGLOS CAP 12" ABOVE GROUND WITH A STONE TO THE NORTHEAST

Description of Monument, Reference Monument or Accessories Established by You to Perpetuate the Location of this Point: SET A #4 REBAR AS SHOWN BELOW

Sketch showing Relative Location of Monument Accessories and Two Reference Points Stating Whether Found or Set. Show Supporting and/or Contradictory Evidence where Applicable. Include North Arrow.

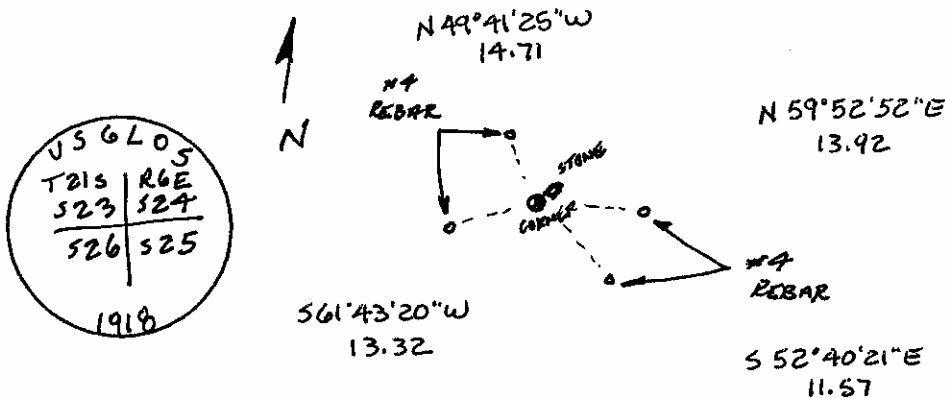

Certification:

Firm name and/or Surveyor: Johansen & Tuttle Eng.  
 Address: 90 S. 100 E. Castle Dale, Utah 84513 Phone: (435) 381-2523

This is to certify that I was in responsible charge of the surveying work described in this record and that to the best of my knowledge the information presented herein is true and correct.

Location Diagram:  
 Section: 23  
 Township: 21S  
 Range: 6E

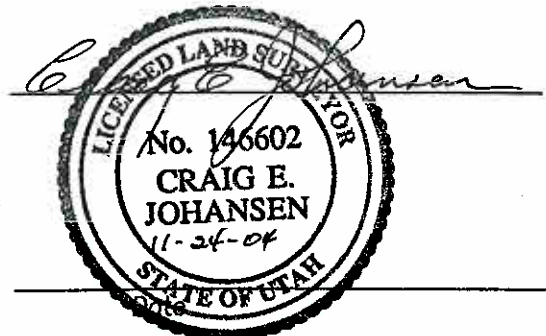
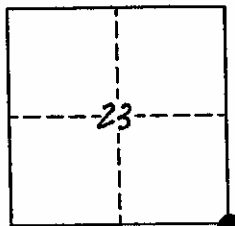



# EMERY COUNTY LAND SURVEY MONUMENT RECORD

Date of field work: 11-15-04

County Reference No. 2106600340

Type of Monument: \_\_\_\_\_ Section Corner  Quarter Corner  
 \_\_\_\_\_ Bench Mark \_\_\_\_\_ Other \_\_\_\_\_

Your Description and Observation of Monument Found ( Be Specific ):  
1918 USGLOS CAP 6" ABOVE GROUND

Description of Monument, Reference Monument or Accessories Established by You to Perpetuate the Location of this Point: SET 4 #4 REBAR AS SHOWN BELOW

Sketch showing Relative Location of Monument Accessories and Two Reference Points Stating Whether Found or Set. Show Supporting and/or Contradictory Evidence where Applicable. Include North Arrow.

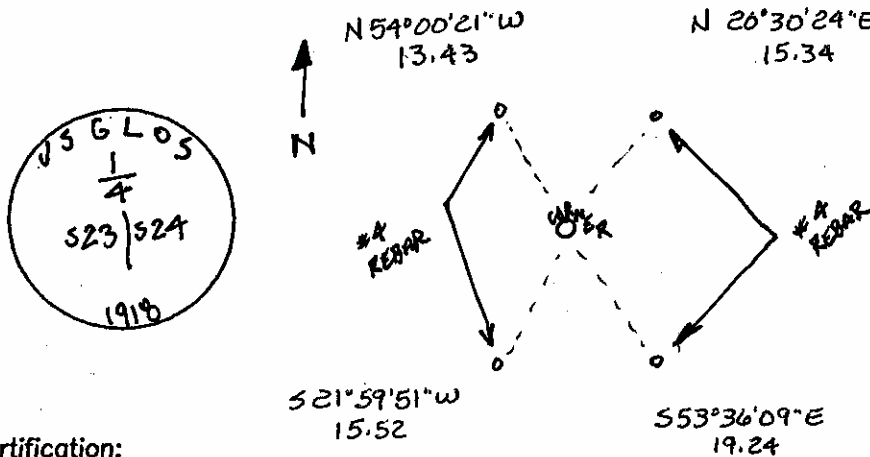

Certification:

Firm name and/or Surveyor: Johansen & Tuttle Eng.  
 Address: 90 S. 100 E. Castle Dale, Utah 84513 Phone: (435) 381-2523

This is to certify that I was in responsible charge of the surveying work described in this record and that to the best of my knowledge the information presented herein is true and correct.

Location Diagram:  
 Section: 23  
 Township: 21S  
 Range: 6E

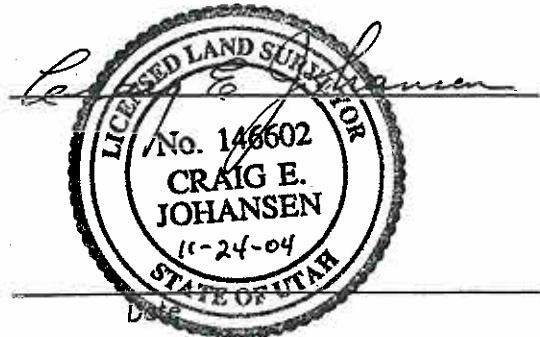
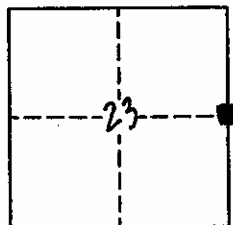

# EMERY COUNTY LAND SURVEY MONUMENT RECORD

Date of field work: 11-15-04

County Reference No. 2106600700

Type of Monument:  Section Corner  Quarter Corner  
 Bench Mark  Other \_\_\_\_\_

Your Description and Observation of Monument Found ( Be Specific ):  
 1918 USGLOS CAP 8" ABOVE GROUND IN A STONE MOUND  
 WITH A CEDAR POST PLANTED ON NORTH SIDE

Description of Monument, Reference Monument or Accessories Established by You to Perpetuate the Location of this Point: SET 4 #4 REBAR AS SHOWN BELOW

Sketch showing Relative Location of Monument Accessories and Two Reference Points Stating Whether Found or Set. Show Supporting and/or Contradictory Evidence where Applicable. Include North Arrow.

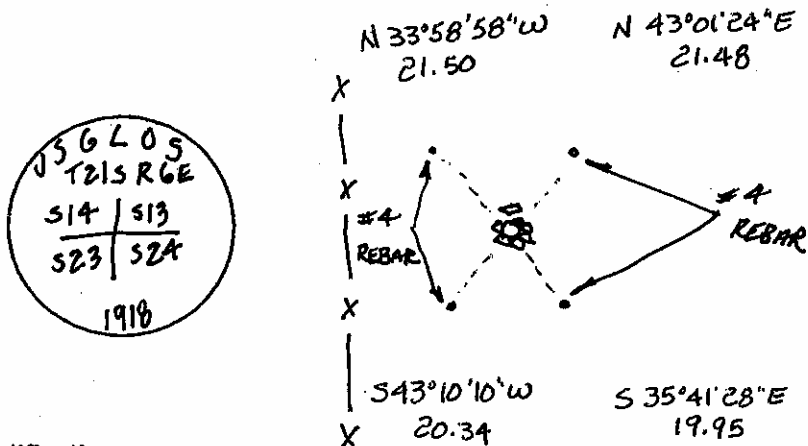

Certification:

Firm name and/or Surveyor: Johansen & Tuttle Eng.  
 Address: 90 S. 100 E. Castle Dale, Utah 84513 Phone: (435) 381-2523

This is to certify that I was in responsible charge of the surveying work described in this record and that to the best of my knowledge the information presented herein is true and correct.

Location Diagram:  
 Section: 23  
 Township: 21S  
 Range: 6E

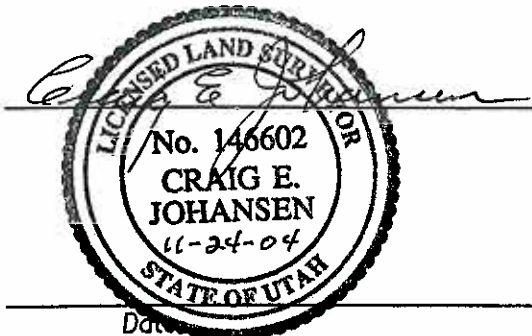
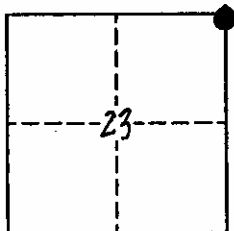

# EMERY COUNTY LAND SURVEY MONUMENT RECORD

Date of field work: 10-18-04

County Reference No. 2106612100  
~~2206620100~~

Type of Monument:          Section Corner  
         Bench Mark

     Quarter Corner  
 Other 7/16 AM  
AMMENDED MONUMENT

Your Description and Observation of Monument Found ( Be Specific ):

1978 BLM CAP 4" ABOVE GROUND WITH A CEDAR FENCEPOST BURIED ALONGSIDE.  
A MOUND OF STONE IS ON THE NORTH SIDE OF CAP

\* NOTE: THIS CAP WAS SET BY THE BLM AT THE WRONG LOCATION. THE BLM CADASTRAL SURVEY CHIEF INSTRUCTED ME TO LEAVE THE CAP IN PLACE AND STAMP "AM" ON THE CAP.

Description of Monument, Reference Monument or Accessories Established by You to Perpetuate the Location of this Point: SET 4 #5 REBAR AS SHOWN BELOW

Sketch showing Relative Location of Monument Accessories and Two Reference Points Stating Whether Found or Set. Show Supporting and/or Contradictory Evidence where Applicable. Include North Arrow.

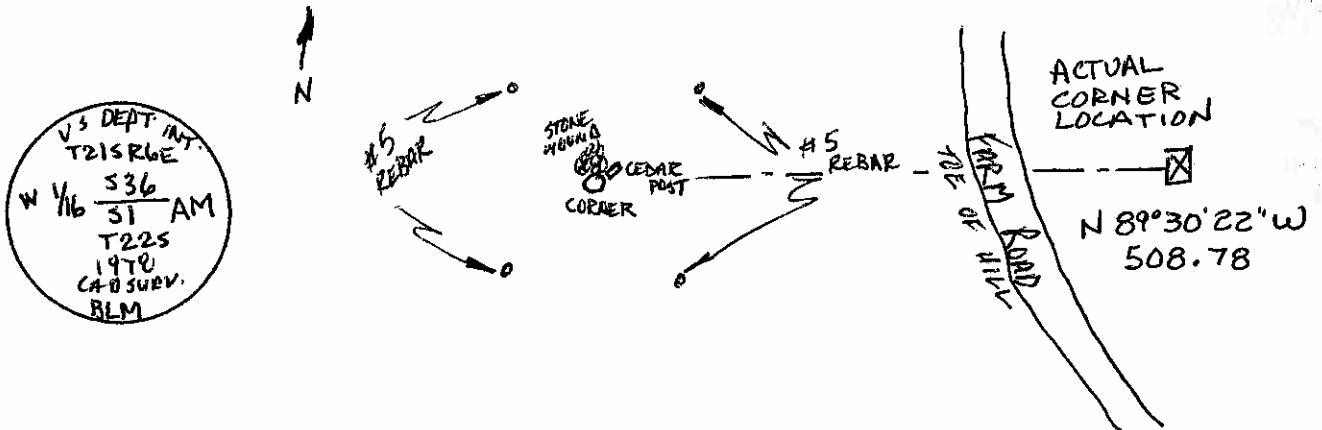

Certification:

Firm name and/or Surveyor: Johansen & Tuttle Eng.  
Address: 90 S. 100 E. Castle Dale, Utah 84513 Phone: (435) 381-2523

This is to certify that I was in responsible charge of the surveying work described in this record and that to the best of my knowledge the information presented herein is true and correct.

Location Diagram:  
Section: 1  
Township: 22S  
Range: 6E

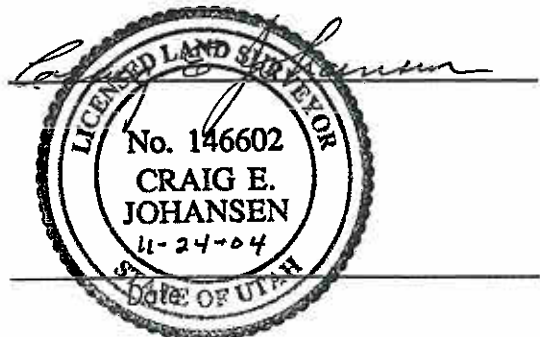
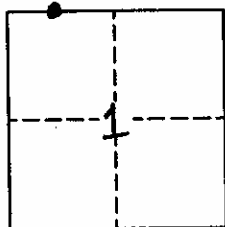

# EMERY COUNTY LAND SURVEY MONUMENT RECORD

Date of field work: 11-15-04 County Reference No. 2106620100

Type of Monument:            Section Corner            Quarter Corner  
           Bench Mark   ✓   Other 1/16

Your Description and Observation of Monument Found ( Be Specific ):  
 FOUND NO EVIDENCE OF MONUMENT

IN 1978 THE BLM SET A MONUMENT FOR THIS CORNER AT THE WRONG LOCATION  
 ( S 89° 30' 22" W, 508.78 FEET FROM THE ACTUAL 1/16 CORNER - SEE 210662100)

Description of Monument, Reference Monument or Accessories Established by You to Perpetuate the  
 Location of this Point: SET A #5 REBAR AND LAP WITH 4 #4 REBAR AS  
 SHOWN BELOW

Sketch showing Relative Location of Monument Accessories and Two Reference Points Stating Whether  
 Found or Set. Show Supporting and/or Contradictory Evidence where Applicable. Include North Arrow.

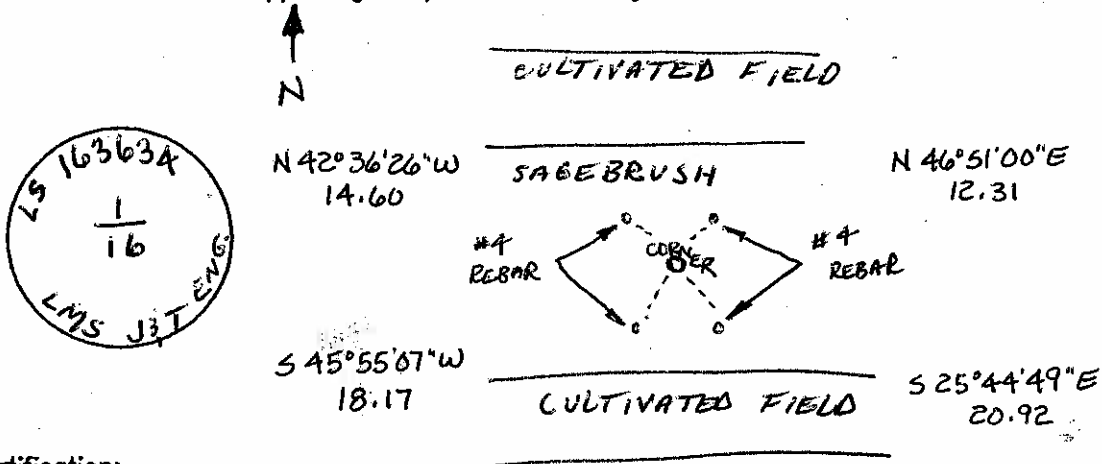

Certification:

Firm name and/or Surveyor: Johansen & Tuttle Eng.  
 Address: 90 S. 100 E. Castle Dale, Utah 84513 Phone: (435) 381-2523

This is to certify that I was in responsible charge of the surveying work described in this record and that to the best  
 of my knowledge the information presented herein is true and correct.

Location Diagram:  
 Section: 36  
 Township: 21s  
 Range: 6E

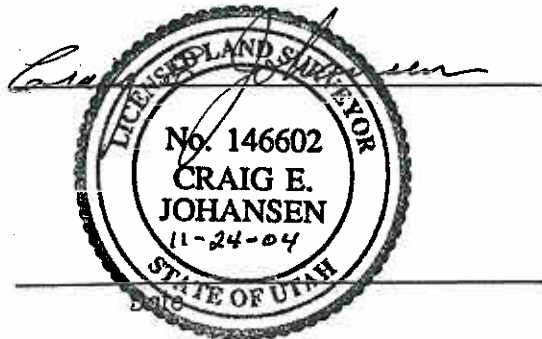
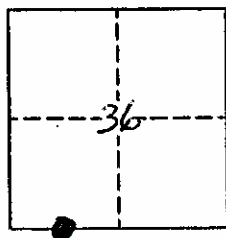

# EMERY COUNTY LAND SURVEY MONUMENT RECORD

Date of field work: 10-19-04

County Reference No. 2106620200

Type of Monument:            Section Corner            Quarter Corner  
           Bench Mark   ✓   Other   1/16  

Your Description and Observation of Monument Found ( Be Specific ):

1978 BLM CAP 6" ABOVE GROUND WITH A BURNT CEDAR POST ALONG SIDE .

Description of Monument, Reference Monument or Accessories Established by You to Perpetuate the Location of this Point: SET 4 #5 REBAR AS SHOWN BELOW

Sketch showing Relative Location of Monument Accessories and Two Reference Points Stating Whether Found or Set. Show Supporting and/or Contradictory Evidence where Applicable. Include North Arrow.

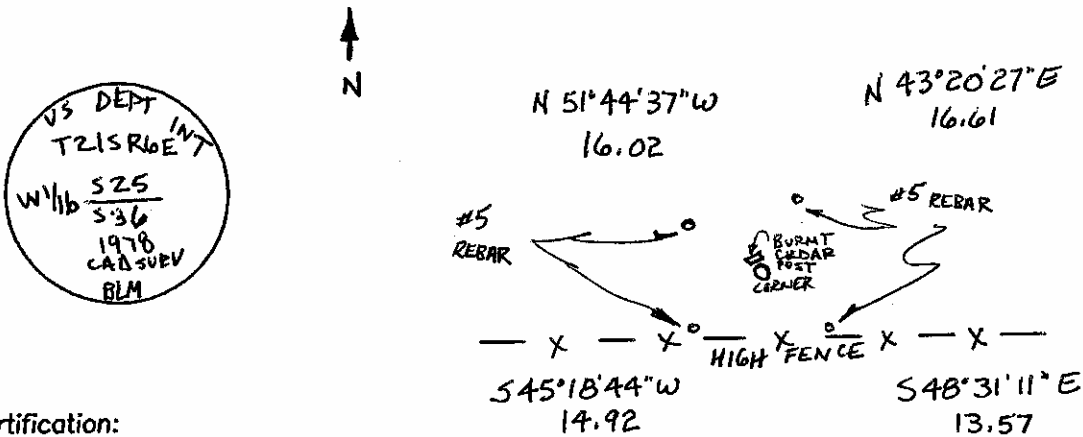

Certification:

Firm name and/or Surveyor: Johansen & Tuttle Eng.  
 Address: 90 S. 100 E. Castle Dale, Utah 84513 Phone: (435) 381-2523

This is to certify that I was in responsible charge of the surveying work described in this record and that to the best of my knowledge the information presented herein is true and correct.

Location Diagram:  
 Section: 36  
 Township: 21S  
 Range: 6E

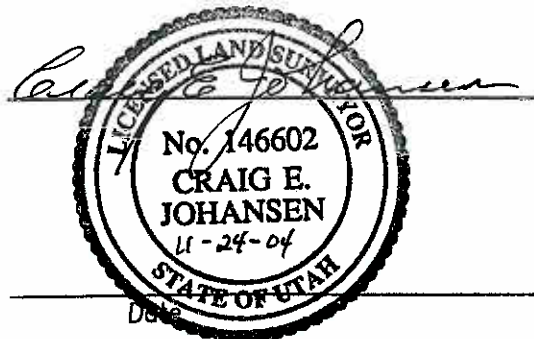
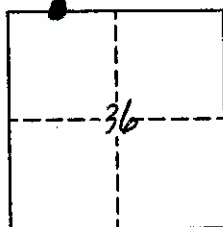

# EMERY COUNTY LAND SURVEY MONUMENT RECORD

Date of field work: 10-27-04

County Reference No. 2106640100

Type of Monument:                      Section Corner   ✓   Quarter Corner  
                     Bench Mark                      Other                     

Your Description and Observation of Monument Found ( Be Specific ):  
1978 BLM CAP 9" ABOVE GROUND WITH A STEEL FENCE POST DRIVEN ALONGSIDE AND A STONE MOUND TO THE NORTH

Description of Monument, Reference Monument or Accessories Established by You to Perpetuate the Location of this Point: SET 4 \*\* REBAR AS SHOWN BELOW

Sketch showing Relative Location of Monument Accessories and Two Reference Points Stating Whether Found or Set. Show Supporting and/or Contradictory Evidence where Applicable. Include North Arrow.

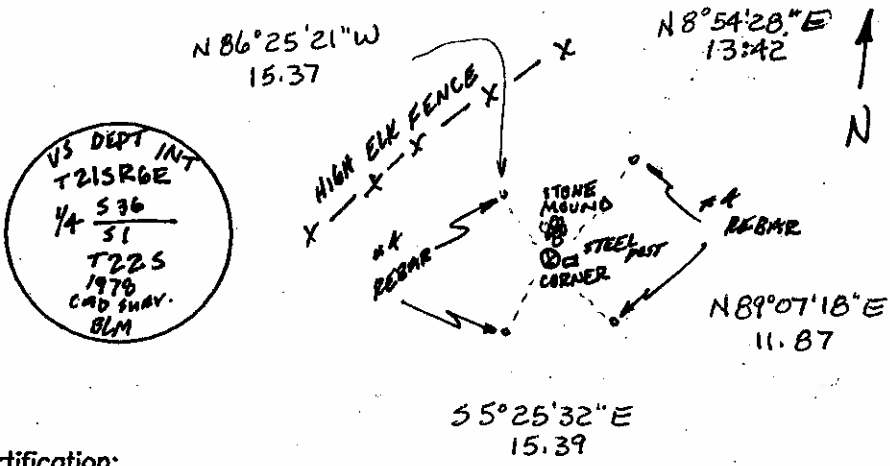

Certification:

Firm name and/or Surveyor: Johansen & Tuttle Eng.  
 Address: 90 S. 100 E. Castle Dale, Utah 84513 Phone: (435) 381-2523

This is to certify that I was in responsible charge of the surveying work described in this record and that to the best of my knowledge the information presented herein is true and correct.

Location Diagram:  
 Section: 36  
 Township: 21S  
 Range: 6E

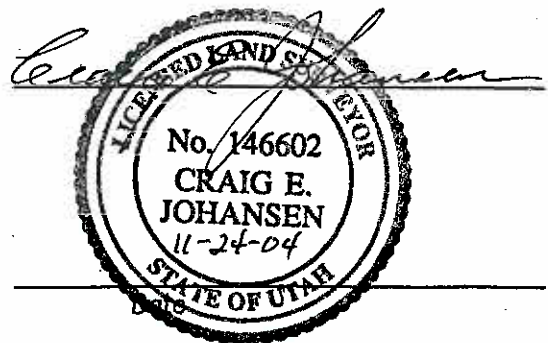
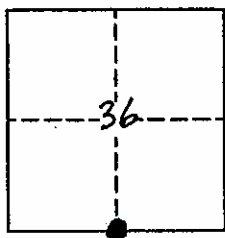

# EMERY COUNTY LAND SURVEY MONUMENT RECORD

Date of field work: 10-27-04

County Reference No. 2106640200

Type of Monument:            Section Corner   ✓   Quarter Corner  
           Bench Mark            Other           

Your Description and Observation of Monument Found ( Be Specific ):

1978 BLM CAP 6" ABOVE GROUND WITH 4 MOUND OF STONE TO THE NORTH

Description of Monument, Reference Monument or Accessories Established by You to Perpetuate the Location of this Point: SET 4 #4 REBAR AS SHOWN BELOW

Sketch showing Relative Location of Monument Accessories and Two Reference Points Stating Whether Found or Set. Show Supporting and/or Contradictory Evidence where Applicable. Include North Arrow.

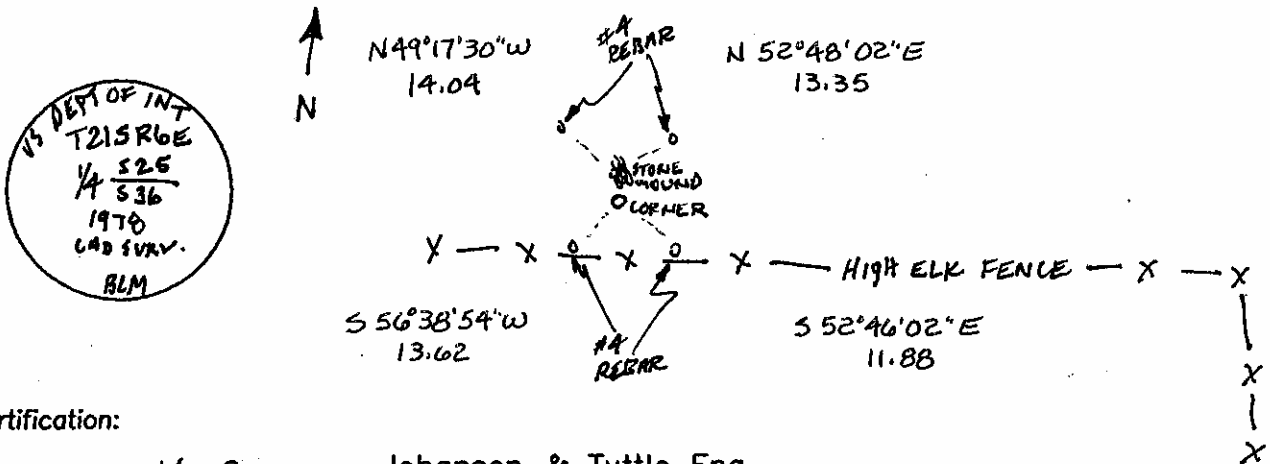

Certification:

Firm name and/or Surveyor: Johansen & Tuttle Eng.

Address: 90 S. 100 E. Castle Dale, Utah 84513 Phone: (435) 381-2523

This is to certify that I was in responsible charge of the surveying work described in this record and that to the best of my knowledge the information presented herein is true and correct.

Location Diagram:  
 Section: 25  
 Township: 21S  
 Range: 6E

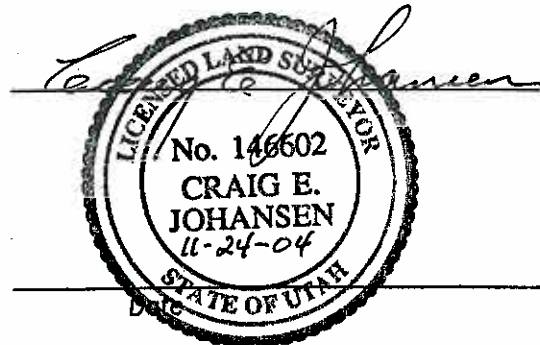
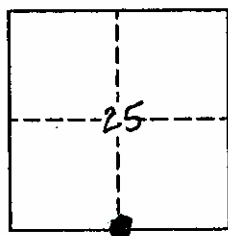

# EMERY COUNTY LAND SURVEY MONUMENT RECORD

Date of field work: 10-20-04

County Reference No. 2106660100

Type of Monument:            Section Corner  
           Bench Mark

           Quarter Corner  
  ✓   Other   1/16  

Your Description and Observation of Monument Found ( Be Specific ):  
 1978 BLM CAP 6' ABOVE GROUND WITH A CEDAR POST AND A STEEL FENCE POST PLANTED  
 ALONGSIDE ALSO A MOUND OF STONE TO THE NORTH

Description of Monument, Reference Monument or Accessories Established by You to Perpetuate the  
 Location of this Point: SET 4 #5 REBAR AS SHOWN BELOW.

Sketch showing Relative Location of Monument Accessories and Two Reference Points Stating Whether  
 Found or Set. Show Supporting and/or Contradictory Evidence where Applicable. Include North Arrow.

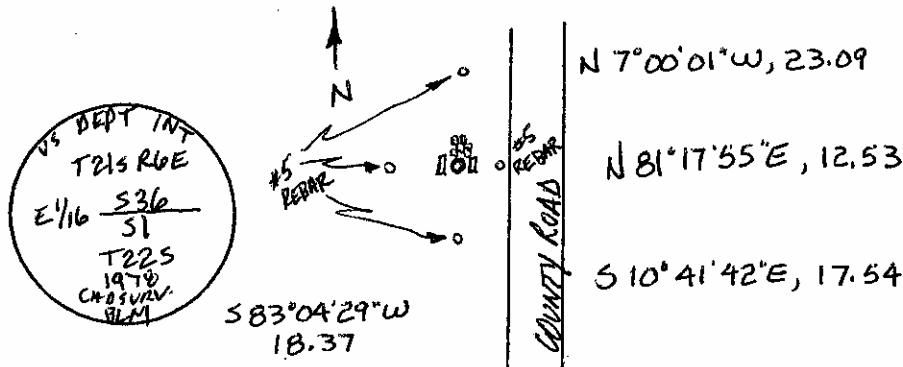

**Certification:**

Firm name and/or Surveyor: Johansen & Tuttle Eng.  
 Address: 90 S. 100 E. Castle Dale, Utah 84513 Phone: (435) 381-2523

This is to certify that I was in responsible charge of the surveying work described in this record and that to the best of my knowledge the information presented herein is true and correct.

Location Diagram:  
 Section: 36  
 Township: 21S  
 Range: 6E

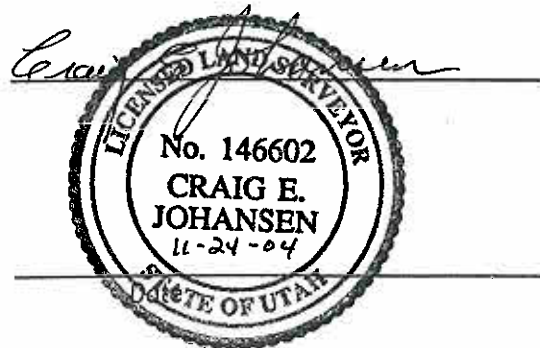
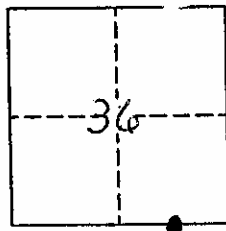



# EMERY COUNTY LAND SURVEY MONUMENT RECORD

Date of field work: 10-20-04

County Reference No. E106700100

Type of Monument:  Section Corner  Quarter Corner  
 Bench Mark  Other \_\_\_\_\_

Your Description and Observation of Monument Found ( Be Specific ):  
 1910 US LAND OFFICE CAP IN STONE MOUND AND IN FENCELINE

Description of Monument, Reference Monument or Accessories Established by You to Perpetuate the Location of this Point: SET 4 #5 REBAR AS SHOWN BELOW.

Sketch showing Relative Location of Monument Accessories and Two Reference Points Stating Whether Found or Set. Show Supporting and/or Contradictory Evidence where Applicable. Include North Arrow.

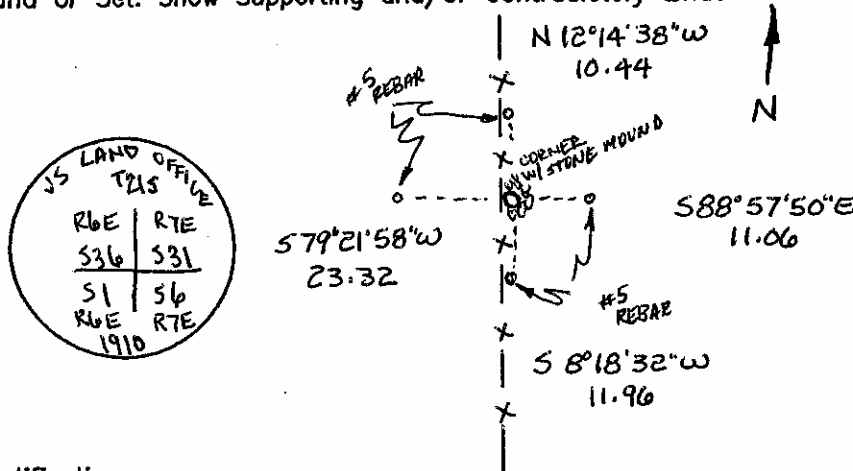

Certification:

Firm name and/or Surveyor: Johansen & Tuttle Eng.  
 Address: 90 S. 100 E. Castle Dale, Utah 84513 Phone: (435) 381-2523

This is to certify that I was in responsible charge of the surveying work described in this record and that to the best of my knowledge the information presented herein is true and correct.

Location Diagram:

Section: 36  
 Township: 21S  
 Range: 6E

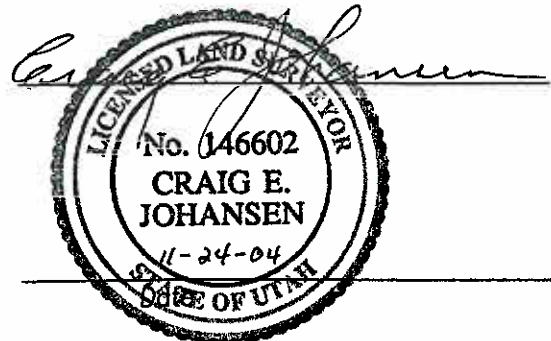
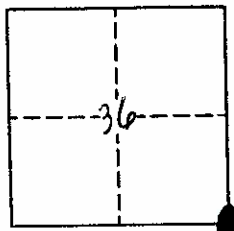

# EMERY COUNTY LAND SURVEY MONUMENT RECORD

Date of field work: 10-20-04

County Reference No. 2106700140

Type of Monument: \_\_\_\_\_

Section Corner \_\_\_\_\_

Quarter Corner \_\_\_\_\_

Bench Mark \_\_\_\_\_

Other  WITNESS CORNER

Your Description and Observation of Monument Found ( Be Specific ):

1962 BLM CAP IN FENCELINE ON EDGE OF WASH.

Description of Monument, Reference Monument or Accessories Established by You to Perpetuate the Location of this Point: SET  $\uparrow$  #4 REBAR AS SHOWN BELOW.

Sketch showing Relative Location of Monument Accessories and Two Reference Points Stating Whether Found or Set. Show Supporting and/or Contradictory Evidence where Applicable. Include North Arrow.

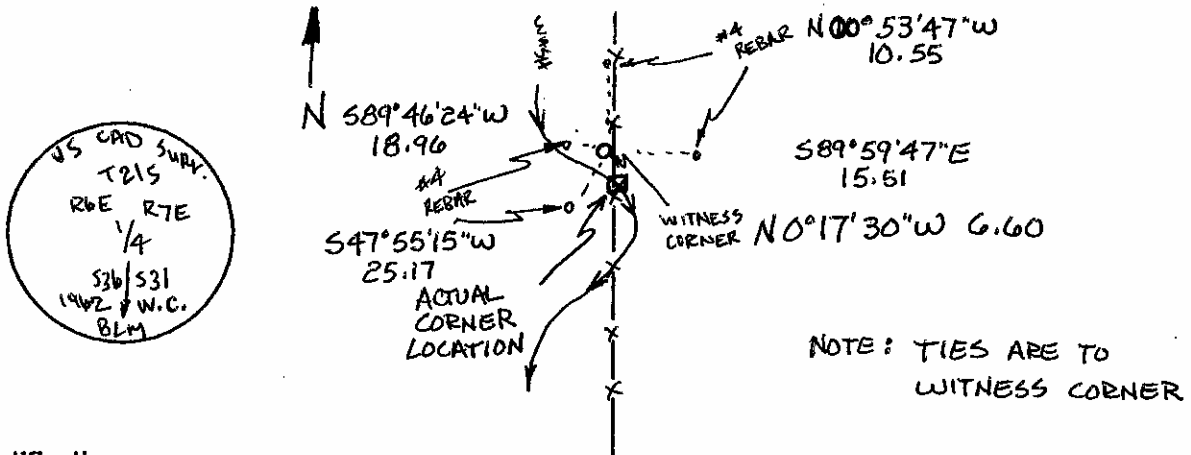

Certification:

Firm name and/or Surveyor: Johansen & Tuttle Eng.

Address: 90 S. 100 E. Castle Dale, Utah 84513 Phone: (435) 381-2523

This is to certify that I was in responsible charge of the surveying work described in this record and that to the best of my knowledge the information presented herein is true and correct.

Location Diagram:

Section: 36

Township: 21S

Range: 6E

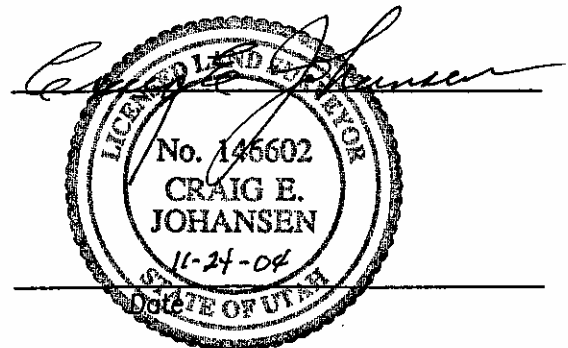
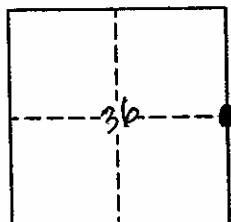

# EMERY COUNTY LAND SURVEY MONUMENT RECORD

Date of field work: 10-20-04

County Reference No. 2106700200

Type of Monument:  Section Corner  
 Bench Mark

Quarter Corner  
 Other \_\_\_\_\_

Your Description and Observation of Monument Found ( Be Specific ):  
 1962 BLM CAP 8" ABOVE GROUND AT FENCELINE INTERSECTION

Description of Monument, Reference Monument or Accessories Established by You to Perpetuate the Location of this Point: SET + #5 REBAR AS SHOWN BELOW

Sketch showing Relative Location of Monument Accessories and Two Reference Points Stating Whether Found or Set. Show Supporting and/or Contradictory Evidence where Applicable. Include North Arrow.

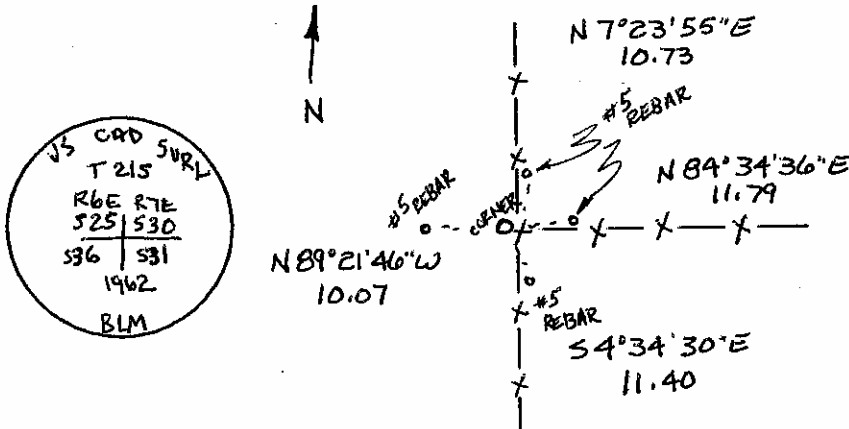

Certification:

Firm name and/or Surveyor: Johansen & Tuttle Eng.

Address: 90 S. 100 E. Castle Dale, Utah 84513 Phone: (435) 381-2523

This is to certify that I was in responsible charge of the surveying work described in this record and that to the best of my knowledge the information presented herein is true and correct.

Location Diagram:

Section: 25  
 Township: 21S  
 Range: 6E

