



STATE OF UTAH

MONUMENT RECORD SHEET



BLM Point Name		Contact Name	License Number	Date
Corner Of Section		Map View Photo or Sketch		
Township Range Section				
Base and Meridian				
State	County			
Geographic Coordinates				
Latitude (DMS)				
Longitude (DMS)				
Ellipsoid Height				
Grid Coordinates				
Northing				
Easting				
Horizontal Units				
Ortho Elevation				
Coordinate System	Zone			
Datum	NGS Adjustment	Monument Area Photo		Monument Close-up Photo
Vertical Units				
Vertical Datum				
Monument Status		Monument Description		
Disclaimer		Additional Notes		

The state of Utah makes no guarantees, representations, or warranties of any kind, expressed or implied, as to the content, accuracy, timeliness, or completeness of any of the data. Unless otherwise noted all images are oriented north and are not to scale. The data is provided on an "as is, where is" basis. The State assumes no obligation or liability for its use by any persons.

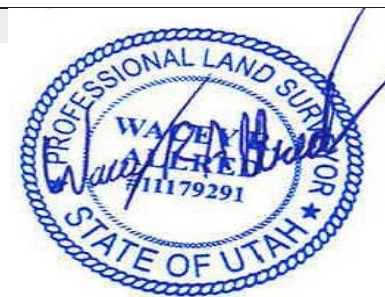

PLSS Monument Preservation Sheet

Township Range Section Meridian																					
BLM Point ID												Date	11/27/19								
U	T	2	6	0	2	0	0	S	0	1	6				0	E	0	_	2	0	0
Meridian				Township		N S	Range			E W	Section		Corner								
<input checked="" type="checkbox"/> Salt Lake <input type="checkbox"/> Uintah				2		0	S			1	6		E	1		8		<input type="checkbox"/> NW	<input type="checkbox"/> NE	<input type="checkbox"/> SE	<input type="checkbox"/> SW
Contact's Name				Wacey R. Allred				State		Utah				<input type="checkbox"/> N 1/4	<input checked="" type="checkbox"/> E 1/4	<input type="checkbox"/> S 1/4	<input type="checkbox"/> W 1/4				
Contact's Phone				435-381-2523						County		Emery				<input type="checkbox"/> WC	<input type="checkbox"/> RC	<input type="checkbox"/> MC	<input type="checkbox"/> 1/16		
License #				11179291-2201				Source Agency				Johansen & Tuttle Engineering Inc.									

PLSS Monument Coordinates																																																			
Datum						NGS National Spatial Reference System Adjustment																																													
<input type="checkbox"/> NAD27		<input checked="" type="checkbox"/> NAD83		<input type="checkbox"/> WGS84		<input type="checkbox"/> NAD83 1986		<input type="checkbox"/> NAD83 1994 (OPUS)		<input type="checkbox"/> NAD83 2007		<input checked="" type="checkbox"/> NAD83 1994 (HARN)																																							
Latitude (DMS)							Longitude (DMS)																																												
N	3	9	-	0	4	-	5	6	.	3	1	6	6	6	W	1	1	0	-	0	9	-	2	5	.	8	3	6	7	2																					
Northing							Easting																																												
6	8	3	7	3	4	9	.	4	4																									2	0	2	1	5	9	7	.	3	5								
Units				Coordinate Type																																															
<input type="checkbox"/> Survey Foot		<input checked="" type="checkbox"/> International Foot		<input type="checkbox"/> Meter		<input checked="" type="checkbox"/> State Plane		<input type="checkbox"/> UTM (Zone 12N)																																											
Zone				Vertical Datum																																															
<input type="checkbox"/> Utah North		<input checked="" type="checkbox"/> Utah Central		<input type="checkbox"/> Utah South		<input type="checkbox"/> NGVD29		<input checked="" type="checkbox"/> NAVD88																																											
Ellipsoid Height				Elevation																																															
M		4169.39		FT		M		4234.71		FT																																									

Monument and Markings			
Type / Size			
Stone	Pipe/Cap	Post	Other
Size 6"x7"x18"	Size	Size	Size
Material stone	Material	Material	Material

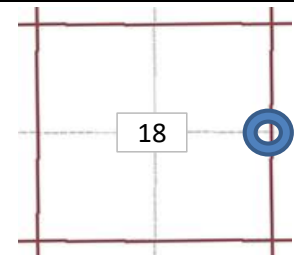
Surveyor Seal	Section Location Diagram	Monument Inscription
		
Signature & Date		

Description and Observation of Monument

Found Original Stone with 1/2" rebar along the side.
Set four 1/2" rebars for reference

S86°40'53"W, 14.46'; S02°47'07"E, 13.93'; N86°13'35"E, 12.23'; N03°07'43"W, 14.82'

Sketch/Rubbing or Attach Photo of GPS Station Occupied
Show rotation of stampings/markings relative to North and describe briefly



Looking North